

10996

Original

FORM C&GS-504	
U.S. DEPARTMENT OF COMMERCE ENVIRONMENTAL SCIENCE SERVICES ADMINISTRATION COAST AND GEODETIC SURVEY	
DESCRIPTIVE REPORT	
Type of Survey	Planimetric
Field No.	Office No. T-10996
LOCALITY	
State	Alabama
General locality	Mobile Bay
Locality	Gulf Shores
1957-1961 *	
CHIEF OF PARTY Joseph K. Wilson, Chief of Field Party William R. Kachel, Tampa District Office	
LIBRARY & ARCHIVES	
DATE	

USCOMM-DC 37022-P86

\* Refer to page 6 of this report.



DESCRIPTIVE REPORT - DATA RECORD

T- 10296

Project No. (II): Ph-5704

Quadrangle Name (IV):

Field Office (II): Fairhope, Alabama

Chief of Party: Joseph K. Wilson

Photogrammetric Office (III): Tampa District Office

Officer-in-Charge: William R. Kachel

Instructions dated (II) (III): (II) 23 June 1958 (Field)

Copy filed in Division of  
Photogrammetry (IV)

10 Feb. 1959 (Field Suppl. 1)

(III) 7 Apr. 1959 (Office)

9 Sept. 1959 (Stereo Bridging)

17 Aug. 1959 (Office Suppl. 1)

6 Oct. 1959 (Office Suppl. 1)

17 Aug. 1959 (Field Suppl. 2)

10 Nov. 1959 (Field and Office Suppl. 3)

Location of Aids to Navigation dated 7 Oct. 1959

Method of Compilation (III): Graphic

~~29 Aug 1962 (Office Suppl. 4)~~

Manuscript Scale (III): 1:10,000

Stereoscopic Plotting Instrument Scale (III): Inapplicable

Scale Factor (III): None

Date received in Washington Office (IV):

Date reported to Nautical Chart Branch (IV):

APRIL 15, 1968

Applied to Chart No.

Date:

Date registered (IV):

Publication Scale (IV):

Publication date (IV):

Geographic Datum (III): N. A. 1927

Vertical Datum (III): M.H.W.

Mean sea-level except as follows:

Elevations shown as (25) refer to mean high water

Elevations shown as (5) refer to sounding datum

i.e., mean low water or mean lower low water

Reference Station (III): HIGDON 1934

Lat.: 30°17'23.770" (731.9 m.)

Long.: 87°38'18.876" (504.4 m.)

Adjusted  
Unadjusted:

Plane Coordinates (IV):

State: Alabama

Zone: West

y= 105,464.61 ft.

x= 456,262.89 ft.

Roman numerals indicate whether the item is to be entered by (II) Field Party, (III) Photogrammetric Office,  
or (IV) Washington Office.

When entering names of personnel on this record give the surname and initials, not initials only.



DESCRIPTIVE REPORT - DATA RECORD

Field Inspection by (II):	M. A. Stewart	Date:	Jan. 1960
Planetable contouring by (II):	Inapplicable	Date:	
Completion Surveys by (II):	M. M. Reynolds	Date:	July 1961
Mean High Water Location (III) (State date and method of location): Air Photo Compilation Date of photography: 9 and 20 Nov. 1957			
Projection and Grids ruled by (IV):	J. E. T. (W. O.)	Date:	Dec. 1959
Projection and Grids checked by (IV):	P. J. Dempsey (W.O.)	Date:	Dec. 1959
Control plotted by (III):	V. P. Cackowski	Date:	July 1960
Control checked by (III):	R. E. Smith	Date:	July 1960
Radial Plot on Stereoscopic Control extension by (III):	R. R. Wagner	Date:	Aug. 1960
Stereoscopic Instrument compilation (III):	Planimetry Contours Inapplicable	Date:	
Manuscript delineated by (III):	R. Dossett <del>Revised by J. Richards</del>	Date:	Aug. 1960 <del>Oct. 1962</del>
of compilation Photogrammetric Office Review/by (III):	I. I. Saperstein	Date:	Sept. 1960
Elevations on Manuscript checked by (II) (III):	Inapplicable	Date:	

DESCRIPTIVE REPORT - DATA RECORD

U.S. DEPARTMENT OF COMMERCE  
COAST AND GEODETIC SURVEY

3 #

Camera (Kind or source) (III): USC&GS Nine-lens

Number	Date	PHOTOGRAPHS (III)		Scale	Stage of Tide
		Time			
57047	20 Nov. 1957	1204		1:10,000	+0.1
57048	"	1205		"	"
57049	"	1205		"	"
57102	"	1259		"	"
57103	"	1259		"	"
56775	9 Nov. 1957	1437		"	+0.2
<del>2 N 4161</del>	<del>7 May 1962</del>	<del>1450</del>		<del>"</del>	<del>1.6 above MLLW</del>

Predicted Tide (III)

Reference Station: MOBILE  
Subordinate Station: MOBILE POINT (FT. MORGAN)  
Subordinate Station:

Ratio of Ranges	Mean Range	Spring Range
Diurnal 1.2		

Washington Office Review by (IV): *Leo F. Beugnot, Atlantic Marine Control* Date: *March 1968*

Final Drafting by (IV): *scribed L.L. Graves*  
*Stickup L.L. Graves* Date: *Dec. 1961*  
*Feb. 1962*

Drafting verified for reproduction by (IV):

Date:

Proof Edit by (IV):

Date:

Land Area (Sq. Statute Miles) (III): 13  
Shoreline (More than 200 meters to opposite shore) (III): 16  
~~Shoreline (Less than 200 meters to opposite shore) (III):~~  
Control Levelling - Miles (II): None  
Number of Triangulation Stations searched for (II): 4\*  
Number of BMs searched for (II): None  
Number of Recoverable Photo Stations established (III): 2\*\*  
Number of Temporary Photo Hydro Stations established (III): None

Recovered: 2  
Identified: 3\*  
Recovered:  
Identified:

Remarks:

\* Including one station north of project

\*\* Including one station east of project



4

T-10996

COMPILATION RECORD	COMPLETION DATE	REMARKS
Compiled	August 1960	
Field Edit	July 1961	
Final Review	March 1968	



## Planimetric Mapping Scale 1:10,000

Mississippi Sound, Miss

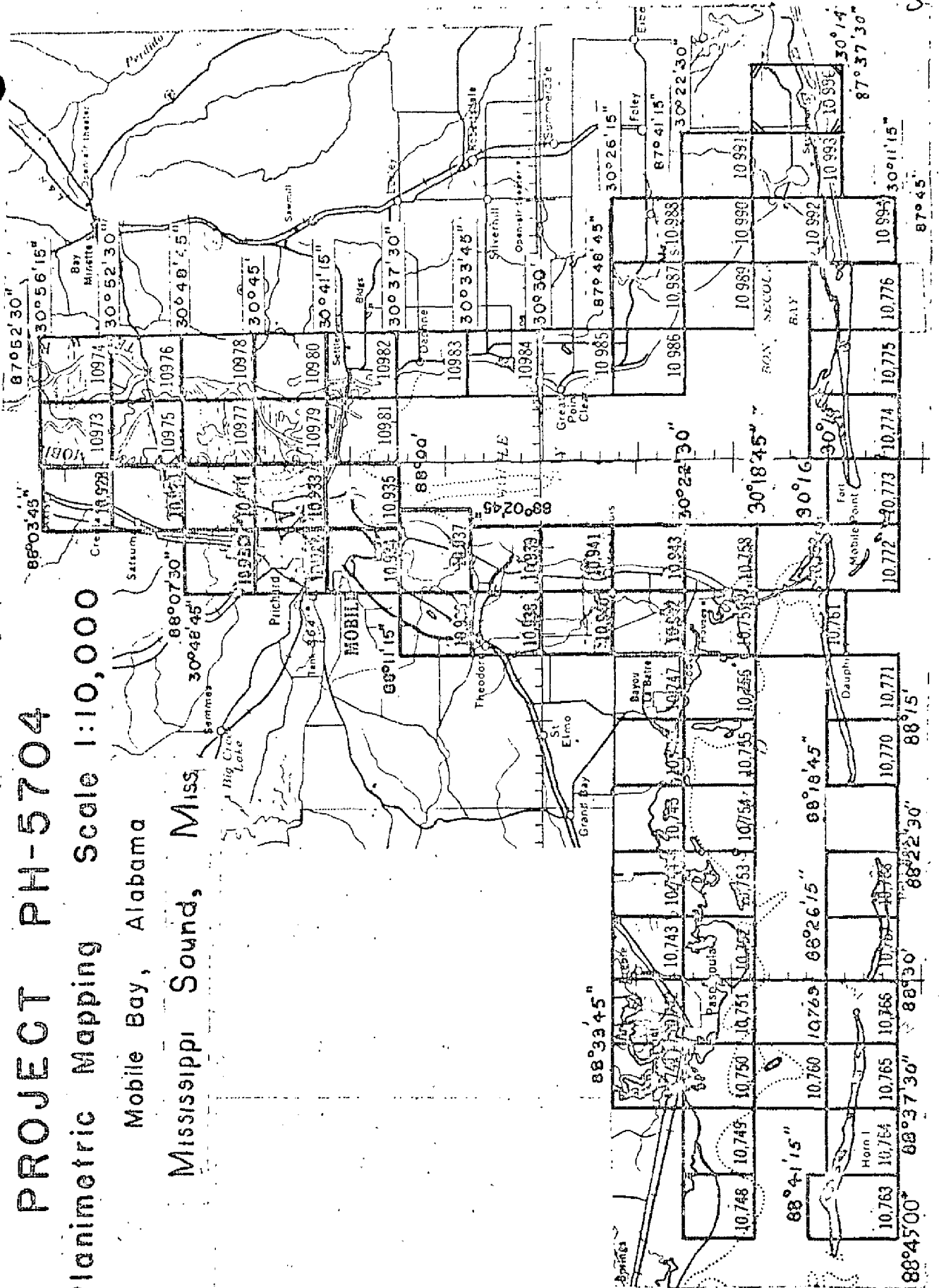



SUMMARY TO ACCOMPANY  
DESCRIPTIVE REPORT T-10996

Planimetric Survey T-10996 is one of seventy-four similar surveys in Project PH-5704. It covers Shelby Lakes, part of the Intracoastal Waterway and the MHWL along the Gulf of Mexico in the vicinity of the town of Gulf Shores.

Field work preceding compilation consisted of recovery and identification of horizontal control, shoreline and field inspection, Investigation of Geographic Names and Report on Boundaries.

Compilation was at 1:10,000 scale by graphic methods using the nine lens photography of November 1957. Cronaflex copies of the manuscript were provided along with specially prepared photographs and ozalid copies of the manuscript for preparation of the boat sheet, location of photo-hydro signals and field edit use.

The manuscript was a vinylite sheet 4 minutes 45 seconds in latitude by 3 minutes 45 seconds in longitude, which was scribed and reproduced on cronaflex. One cronaflex positive and one cronar negative are furnished for record and registry.

*\* This survey was revised in 1962. Refer to pages 24, 25 and 26.*



FIELD INSPECTION REPORT  
Project Ph-5704  
Maps T-10993, T-10994 and T-10996

2. Areal Field Inspection.

These maps are located in southwestern Alabama, along the southeastern side of Bon Secour Bay. The land area in general is low lying stretches of marsh, swamp and sand. The northeastern corner of map T-10993 and the northwestern corner of map T-10996 has some arable land. The cultivated land is planted in potatoes and soy beans.

The area is served by an adequate network of federal, state and county highways.

The area along the gulf, in all three maps, is primarily a summer resort and is developed with cottages and other tourist attractions.

Field inspection is believed complete and no items were deliberately left for field edit.

Photography was of fair to poor quality. The photographic tones were not consistent in the trees to swamp areas and in some of the marsh to grass areas. All doubtful areas were thoroughly checked in the field and the correct limits have been indicated on the photographs.

Field inspection notes have been made on the following nine-lens photographs; 56770 through 56776, 57044, 57045, 57049, 57102 and 57103.

3. Horizontal Control.

All Coast and Geodetic Survey and Alabama Geodetic Survey stations were searched for and where recovered were identified to aid in control of the plot.

Stations 359 and 489 of the Alabama Geodetic Survey were identified. These stations were established by third-order traverse.

No additional control was established by the field party.

Station MOON 1934 was reported lost and RM 2 was identified in lieu of the station.

The following stations were reported lost.

T-10993

MYER 1934

Pensacola-Mobile Beacon No. 12 1934

Pensacola-Mobile Beacon No. 14 1934

Pensacola-Mobile Beacon No. 95 1934

Pensacola-Mobile Beacon No. 105 1934



358, Ala. Geodetic Survey  
360, Ala. Geodetic Survey  
361, Ala. Geodetic Survey  
362, Ala. Geodetic Survey  
490, Ala. Geodetic Survey  
592, Ala. Geodetic Survey  
593, Ala. Geodetic Survey

T-10994

492, Ala. Geodetic Survey

T-10996

ROB 1934

MOON 1934

4. Vertical Control.

The only requirement for vertical control was the recovery of tidal bench marks. There are none within these maps.

5. Contours and Drainage.

Contours are inapplicable.

Drainage not self evident has been indicated on the photographs.

6. Woodland Cover.

All woodland was field inspected and classified on the photographs. See item 2 PP5.

7. Shoreline and Alongshore Features.

The mean high water line and apparent shoreline <sup>were</sup> inspected by skiff and walking along the shore. It has been symbolized on the photographs.

The low water line was not inspected.

There is little or no foreshore within these maps.

There are no bluffs or cliffs.

All docks, wharves, piers or landings have been indicated on the photographs.

Shore ends of submarine cables, where they exist, have been located on the photographs.

Shoreline inspection has been indicated on the following photographs 56770 through 56776, 57044, 57045 and 57103.

8. Offshore Features.

There are none.

9. Landmarks and Aids.

Form 567 covering maps T-10993 and T-10994 was submitted to Washington on 6 November 1959. Form 567 for map T-10996 is enclosed.

10. Boundaries, Monuments and Lines.

The entire area is within Baldwin County. A copy of the legal description of this county was included in a special report on boundaries. This report was submitted to Washington 2 March 1959.

A legal description of the corporate limits of Gulf Shores could not be obtained. The limits have been indicated on photographs 56774 and 56775. These limits were indicated in the field with the aid of Mr. J. O. Sims, Mayor, Gulf Shores, Alabama.

Legal descriptions and maps of the limits of Gulf State Park could not be obtained. The approximate limits have been indicated on photographs 56775 and 56776. It is suggested that these limits be compiled from the enclosed copy of U. S. G. S. FOLEY Quadrangle.

The west limits of Gulf State Park and the east limits of Gulf Shores are the same.

11. Other Control.

The following recoverable topographic stations were established.

<u>T-10993</u>	<u>T-10994</u>	<u>T-10996</u>
LONG 1959	JACK 1959	MOVE 1959
	KNOW 1959	NOON 1959

12. Other Interior Features.

All buildings and roads were inspected in accordance with Photogrammetry Instructions number 54 and 56.

Clearances for one bridge, in map T-10993, were requested. These clearances are horizontal 14.0 feet, vertical 5.6 feet. Clearances have been indicated on photograph 57045.

One airport is located in map T-10996. This is an auxiliary field for the U. S. Navy Pensacola facilities. The limits of the airport have been indicated on photograph 57049.

13. Geographic Names.

A systematic investigation of Geographic Names was not required. No discrepancies were noted during field inspection. No new names are recommended.



14. Special Reports and Supplemental Data.

Special Report Boundaries, Project Ph-5704, Alabama-Mississippi,  
submitted to Washington 2 March 1959.

Form 567 Submitted to Washington 6 November 1959.

Form 567 (enclosed)

Foley Quadrangle (enclosed)

Submitted,

*William M. Reynolds*  
William M. Reynolds  
Acting Chief of Party



MAP T	PROJECT NO.	SCALE OF MAP	SCALE FACTOR
10996	5704	1:10,000	

STATION	SOURCE OF INFORMATION (INDEX)	DATUM	LATITUDE OR Y-COORDINATE LONGITUDE OR X-COORDINATE	DISTANCE FROM GRID IN FEET, OR PROJECTION LINE IN METERS		DATUM CORRECTION	N.A. 1927-DATUM DISTANCE FROM GRID OR PROJECTION LINE IN METERS		FACTOR DISTANCE FROM GRID OR PROJECTION LINE IN METERS	
				FORWARD	(BACK)		FORWARD	(BACK)	FORWARD	(BACK)
ROB 1934	P.C. 30		101 765.14 ✓ 441.483.05 ✓	3 1018.1 ✓ 13 4564.3 ✓		REPORTED LOST		POORLY ADJUSTED		
MOON RM 2-1934	comp.		91.852.17 ✓ 450.524.25 ✓	2 7996.4 ✓ 13 7320.1 ✓		<del>REPORTED LOST</del>		"		
HIG DON 1934	" 29		105 464.61 ✓ 456 262.89 ✓	3 2145.7 ✓ 13 9069.2 ✓				"		
CLEAR 1934	P.C. 29		114 570.84 ✓ 455 419.03 ✓	3 4921.9 ✓ 13 8810.2 ✓		OUTSIDE LIMITS		"		

1 FT. = .3048006 METER  
COMPUTED BY:

1 FT. = .3048006 M  
COMPUTED BY:

DATE \_\_\_\_\_

20 Dec. 190

CHECKED BY:

DATE \_\_\_\_\_

COMM-DC-5704



PHOTOGRAMMETRIC PLOT REPORT NO.3

21. AREA COVERED

This plot covers the area bordering the south east part of Mobile Bay and Bon Secour Bay (manuscripts T-10985 through T-10992) and along the Gulf of Mexico from Pine Beach east to Romar Beach (manuscripts T-10993, T-10994 and T-10996).

The sketch on page 18 shows the arrangement of manuscripts, the identified control, index of control, photograph centers and the adjoining manuscripts.

22. METHOD

Radial Plot:

Map Manuscripts: The projections were mylar or vinylite and are 3'45" in latitude and longitude; with the two exceptions of T-10993 and T-10996, which are 4'45" in latitude.

The plot was run on the joined manuscripts.

Photographs: The nine-lens cronapaque photographs taken on 20 November 1957 at a scale 1:10,000 were used to run the plot.

Templets: Vinylite templets were made from nine-lens photographs using master templet 53605 (1956-1957) for correction of transforming errors and distortion.

Closure and adjustment to control: The plot was run from the north to the southeast with conventional methods being used.

All control was held.

Triangulation station POINT CLEAR, GRAND HOTEL WATER TANK 1960 (T-10985) was received after completion of the plot. The triangulation position coincided with the radial plot position.

23. ADEQUACY OF CONTROL

The control was adequate and the identification was good. SEYMOUR 2, 1960 was used in lieu of SEYMOUR 1935. See accompanying letter 3 June 1960 from Chief, Photogrammetry Division.

24. SUPPLEMENTAL DATA

None.



25. PHOTOGRAPHY

The cronapaque nine-lens photographs gave adequate coverage and the quality was good.

None of the photographs were sufficiently tilted to justify special measures.

26. GENERAL

Dates of completion of the photogrammetric plot by maps are as follows:

T-10985	25 May
T-10986	26 May
T-10987	27 May
T-10988	26 July
T-10989	27 July
T-10990	9 August
T-10991	8 August
T-10992	10 August
T-10993	12 August
T-10994	5 August
T-10996	11 August

Respectfully submitted,

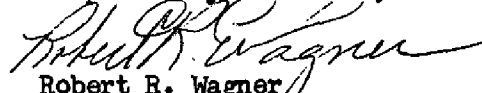
  
Robert R. Wagner  
Cartographer (photo)

Approved and Forwarded:

  
Arthur L. Wardwell  
Chief of Party

# Sketch For Report On Radial Plot No. 3 Ph 5704

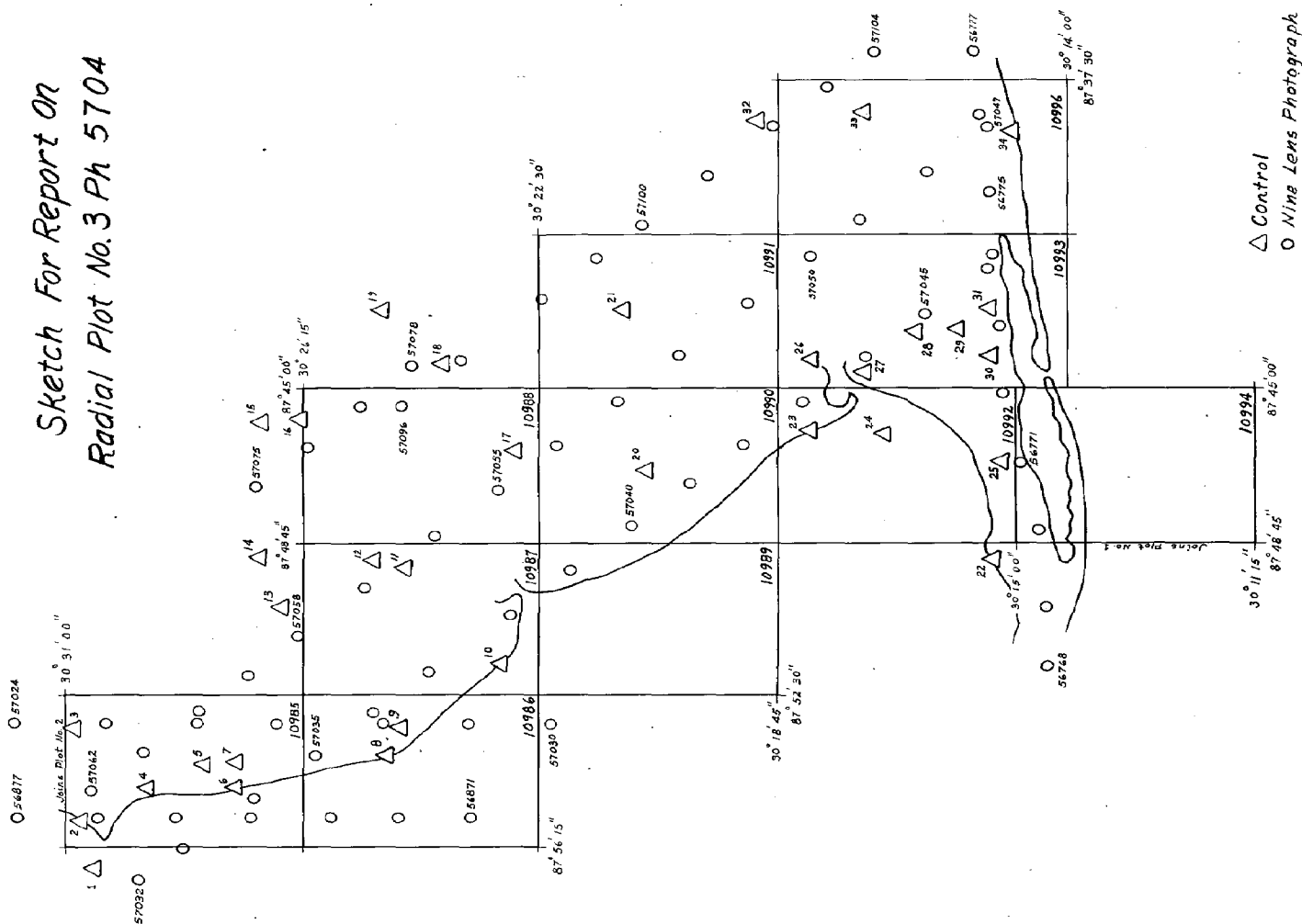

## CONTROL STATIONS

1. GREAT POINT CLEAR BEACON, 1935
2. SUB. STATION 87 (ALA. GEOD. SUR.)
3. " " 278 (ALA. GEOD. SUR.)
4. " " 84 (ALA. GEOD. SUR.)
5. " " SMILEY AZIMUTH MARK, 1930
6. " " 83 (ALA. GEOD. SUR.)
7. " " 82 (ALA. GEOD. SUR.)
8. " " MOULET R.M. 1, 1935
9. " " 703 (ALA. GEOD. SUR.)
10. " " MACK, 1934
11. " " YUFON, 1935
12. " " 215 (ALA. GEOD. SUR.)
13. " " 311 (ALA. GEOD. SUR.)
14. " " 310 (ALA. GEOD. SUR.)
15. " " 707 (ALA. GEOD. SUR.) 1941
16. " " 193 (ALA. GEOD. SUR.) 1941
17. " " 506 (ALA. GEOD. SUR.) 1938
18. " " 504 (ALA. GEOD. SUR.) 1938
19. " " FOLEY, R.M. 2, 1934
20. " " BENTON, 1935
21. " " KAISER, 1959
22. " " BANK, 1918-1940
23. " " STUNK 2, 1953
24. INTRACOASTAL WATERWAY, PENSACOLA - MOBILE LIGHT 152, 1959
25. SUB. STATION SEYMOUR 2, 1959
26. " " METT, 1934
27. 359 (ALA. GEOD. SUR.) 1936
28. PENSACOLA - MOBILE BEACON NO. 91, 1934
29. SUB. STATION BAY, 1934
30. " " SILVIA, 1934
31. " " 489 (ALA. GEOD. SUR.) 1939
32. " " CLEAR, 1934
33. " " HIGDON, 1934
34. " " MOON R.M. 2, 1934

154

COMPILATION REPORT T-10996

PHOTOGRAMMETRIC PLOT REPORT

Submitted with T-10994.

31. DELINEATION

The graphic method was used. The photographs were clear and of reasonably good scale. Some tilt was present in all photographs. Field inspection was adequate.

32. CONTROL

See photogrammetric plot report.

33. SUPPLEMENTAL DATA

None.

34. CONTOURS AND DRAINAGE

Contours are inapplicable.

The drainage including that in swamps was delineated by the field inspector, but when some of this delineation was disproved by the details on other photographs, particularly in the swamps, all the drainage that could not be seen was doubted. Only the drainage identified by thorough stereoscopic examination has been shown on the manuscript. Please refer to the letter date 10 Oct. 1960 on DRAINAGE, Ph-5704, to Chief, Photogrammetry Division, from Tampa District Officer for more information about this.

35. SHORELINE AND ALONGSHORE DETAILS

Shoreline and alongshore details have been delineated according to field inspection notes. No low-water line or shoals were shown. The shoreline inspection was adequate.

36. OFFSHORE DETAILS

None.



1640

37. LANDMARKS AND AIDS

There are no aids to navigation. Two landmarks have been shown and were submitted on Form 567 on 14 November 1960.

38. CONTROL FOR FUTURE SURVEYS

Two monumented topographic stations were established. They are listed under Item 49 and forms 524 are being submitted.

39. JUNCTIONS

A satisfactory junction has been secured with T-10993 on the west. There is no contemporary survey on the north, south or east. (FOLEY quadrangle, edition of 1943, lies to the east. See Item 46.)

40. HORIZONTAL AND VERTICAL ACCURACY

No statement.

41. CITY LIMITS AND BOUNDARIES

City limits of GULF SHORES was taken from the field inspection photographs.

The boundary of GULF STATE PARK was delineated from fence or cut lines appearing on the photographs and the USGS quadrangle FOLEY, ALA-FLA. was used as a guide in determining what lines to accept. The proportional method was used in areas where lines did not appear on the photographs. It is believed that the boundary as delineated is correct; however, it differs from the field inspection on photographs 56775 and 56776. See Item 10 in Descriptive Report for T-10993.

46. COMPARISON WITH EXISTING MAPS

A comparison has been made with USGS quadrangle FOLEY, edition of 1943, scale 1:62,500, surveyed in 1940-1941. The shoreline compares favorably. State Road 182 and other new roads and Canal Air Field have been added. It will be noted that the town of GULF SHORES has enlarged its area since the FOLEY quadrangle was published. The town now extends from the beach to the south edge of the Intra-Coastal Waterway.

17 4.  
Comparison has also been made with USC&GS Air Photo Compilation No. T-5498, scale 1:10,000, edition of 1934. T-5498 is older and more outdated than the quadrangle.

47. COMPARISON WITH NAUTICAL CHARTS

Comparison has been made with Chart 872, scale 1:40,000, edition of 11 May 1959.

The maps listed under item 46 are probably the source of topography for the chart and the same differences apply.

ITEMS TO BE APPLIED TO NAUTICAL CHARTS IMMEDIATELY

None.

ITEMS TO BE CARRIED FORWARD

None.

*Russolph Bossett*  
Russolph Bossett  
Carto Photo Aid

APPROVED AND FORWARDED

*William R. Kachel*  
William R. Kachel  
Tampa District Officer

49. NOTES FOR THE HYDROGRAPHER

The following is a list of topographic stations which may be of use to the hydrographer:

MOVE, 1959

NOON, 1959



48. GEOGRAPHIC NAME LIST

Names were taken from the FOLEY quadrangle and Nautical Chart  
No. 872.

ALABAMA  
ALLIGATOR ISLAND -  
  
BALDWIN COUNTY -  
  
CANAL AIRFIELD -  
  
GRASS ISLAND -  
GULF OF MEXICO -  
GULF SHORES -  
GULF STATE PARK -  
  
INTRACOASTAL WATERWAY -  
  
MIDDLE RIVER -  
  
OUR LADY OF THE GULF CHURCH -  
  
PORTAGE CREEK -  
  
ROMAR BEACH -  
  
SHELBY LAKES -  
SIBLEY HOLMES TRAIL -  
SOUTH ISLAND -  
STATE 59 -  
STATE 135 -  
STATE 180 -  
STATE 182 -

Names checked  
and approved  
12-10-65

A. J. Wright

19-13

50

PHOTOGRAMMETRIC OFFICE REVIEW  
OF ADVANCE COMPILED MANUSCRIPT  
T-10996

1. Projection and grids IIS 2. Title IIS 3. Manuscript numbers IIS 4. Manuscript size IIS

4a Classification label Unclassified

CONTROL STATIONS

5. Horizontal control stations of third-order or higher accuracy IIS 6. Recoverable horizontal stations of less than third-order accuracy (topographic stations) IIS 7. Photo hydro stations XX 8. Bench marks XX 9. Plotting of sextant fixes XX 10. Photogrammetric plot report IIS 11. Detail points IIS

ALONGSHORE AREAS

(Nautical Chart Data)

12. Shoreline IIS 13. Low-water line XX 14. Rocks, shoals, etc. XX 15. Bridges IIS 16. Aids to navigation XX 17. Landmarks IIS 18. Other alongshore physical features IIS 19. Other along-shore cultural features IIS

PHYSICAL FEATURES

20. Water features IIS 21. Natural ground cover IIS 22. Planetable contours XX 23. Stereoscopic instrument contours XX 24. Contours in general XX 25. Spot elevations XX 26. Other physical features IIS

CULTURAL FEATURES

27. Roads IIS 28. Buildings IIS 29. Railroads XX 30. Other cultural features IIS

BOUNDARIES

31. Boundary lines IIS 32. Public land lines XX

MISCELLANEOUS

33. Geographic names IIS 34. Junctions IIS 35. Legibility of the manuscript IIS 36. Discrepancy overlay IIS 37. Descriptive Report IIS 38. Field inspection photographs IIS 39. Forms IIS

40. I.I. Saperstein  
Reviewer

M.M. Slavney  
Supervisor, Review Section or Unit

41. Remarks (see attached sheet)

FIELD COMPLETION ADDITIONS AND CORRECTIONS TO THE MANUSCRIPT

42. Additions and corrections furnished by the field completion survey have been applied to the manuscript. The manuscript is now complete except as noted under item 43.

R.R. Wagner  
Compiler

M.M. Slavney  
Supervisor

43. Remarks:

20 18

FIELD EDIT REPORT  
MAPS T-10993, T-10994, T-10996  
PROJECT Fh-5704

51. METHODS

Field edit was confined to the shoreline and the area immediately adjacent thereto. The shoreline was traversed by skiff running close to the shore. The features shown on the manuscript were checked with the features on the ground. Corrections have been made on a field edit sheet for each manuscript and the following field photographs; 57043, 57045, 57049, and 56776. Additions or corrections have been noted in violet. Deletions have been noted in green. The field edit sheets and field photographs have been cross-referenced. The new roads and canals located on map T-10993 were located by standard planetable methods on the manuscript.

52. ADEQUACY OF COMPILATION

The compilation appears good and will be adequate after application of field edit information.

53. MAP ACCURACY

A check of the horizontal accuracy of the maps was not required.

54. RECOMMENDATIONS

None are offered.

55. EXAMINATION OF PROOF COPY

Mr. Harold W. Graham, Registered Engineer, Route 2, Box 120, Fairhope, Alabama and Mr. Claude W. Arnold, Registered Engineer, Fairhope, Alabama agreed to examine proof copies of any maps located in Baldwin County. Both men are long time residents and are qualified to make this examination.



A thorough investigation of the conflicts in geographic names was made. The recommended name for the point along the south side of Bon Secour River is "Steiners Point" and not Flashes Point. Local investigation revealed that the name of the entire Peninsula, before the Intercostal Waterway was cut, was "Flashes Island," but the point in question has always been Steiners Point." The following local residents were contacted and all of them agreed on the name "Steiners Point;" Andrew Calloway, resident 50 years, James Nelson, resident 50 years, O.D. Nelson, resident 74 years, and Harry Mund, resident 23 years. All of them are property owners and in the area and all the addresses are Route 3, Foley, Alabama.

The location of "Childress Point" was investigated for maps T-10993 and T-10994. "Childress Point" as mapped in T-10994 is correct. The point at the east limits of T-10994 is "Bill Childress Point". The point near the west limits of T-10993 is known locally as "Blind Point". The names "Trout Point," "Stantons Point", "Willet Point," and "White Point" are also recommended for mapping. All names have been placed correctly on the manuscripts. The following people agreed on the recommendations for names in this area; Mr. Lee Calloway, resident for 53 years, Mr. Sam Wallace, resident for 58 years, Mr. Dwight Steele, resident for 55 years, and Mr. J.O. Sims, resident for 10 years and mayor of Gulf Shores. The addresses of all the above people is Gulf Shores, Alabama. The first three people mentioned are or have been commercial fishermen.

Submitted,

*William M. Reynolds*  
William M. Reynolds

REVIEW REPORT T-10996  
PLANIMETRIC  
March 22, 1968

61. GENERAL STATEMENT:

See Summary accompanying the Descriptive Report.

62. COMPARISON WITH REGISTERED TOPOGRAPHIC SURVEYS:

Comparison was made with a copy of Air Photo Compilation T-5498, compiled from photography of July 1934. The many changes brought about by the passage of time have caused this survey to be obsolete.

Survey T-10996 supersedes T-5498 for nautical chart construction purposes.

63. COMPARISON WITH MAPS OF OTHER AGENCIES:

Comparison was made with USGS FOLEY, ALA. - FLA., 1:62,500 scale, 15 minute quadrangle, edition of 1943. Although the two surveys are in general agreement, many changes have taken place since 1943. The major changes consist of the construction of a Navy Auxiliary Field in the vicinity of latitude  $30^{\circ} 17' 30''$ , longitude  $87^{\circ} 40' 30''$ ; removal of a bridge over the Intracoastal Waterway (latitude  $30^{\circ} 17' 24''$ , longitude  $87^{\circ} 38' 24''$ ); new roads and general development of the area as a resort.

64. COMPARISON WITH CONTEMPORARY HYDROGRAPHIC SURVEYS:

There is no contemporary hydrographic survey that effects this map.

65. COMPARISON WITH NAUTICAL CHARTS:

Comparison was made with Chart 872-SC, 3rd edition, corrected thru NM 37-September 16, 1967 and Chart 1266, 21st edition, September 25, 1967. There are no major discrepancies, between the charts and survey T-10996.

66. ADEQUACY OF RESULTS AND FUTURE SURVEYS:

This survey complies with instructions and meets the National Standards of Map Accuracy.

Reviewed by:

Leo F. Beugnet  
Leo F. Beugnet

Approved by:

J. Bull  
J. Bull, RADM, USESSA  
Director, Atlantic Marine Center

Approved by:

Charles L. Hannon  
Chief, Photogrammetric Branch *CHB*

R. H. Hannon  
Chief, Photogrammetry Section

Charles A. Boyer  
Chief, ~~Nautical~~ Chart Division  
*Marine*



PH-5704  
Revision Data

RS-898 (T-10996)

This map was one of 18 project maps revised in 1962 with 1962 photography. Refer to project revision diagram on ~~the following~~ page. 26

Revision Survey information was not carried forward to the original shoreline surveys. The revised details have been applied to contemporary hydrographic surveys.

Copies of the revision surveys will be filed with other project (PH-5704) data in the Federal Records Center.

Compilation reports for some revision surveys are lost. Available reports are included in the Descriptive Reports for the registered shoreline surveys. (See page 25) JHS



REVISION COMPILATION REPORT  
T-10996  
October 1962

(See Descriptive Report T-10763 thru T-10768 \*  
for the revision compilation report covering this en-  
tire project.)

Detail north of 30° 17' was not revised as  
1962 photography was not available in that area.

A project layout sketch indicating the photo-  
graph coverage and the project limits has been included  
on the next page.

*John T. Gerlach*

John T. Gerlach

Report (revision survey) is Lost.

PROJECT PH-5704 (REVISION)

MOBILE BAY, ALABAMA - MISSISSIPPI SOUND, MISS.

SCALE - 1:10,000  
SEPTEMBER, 1962

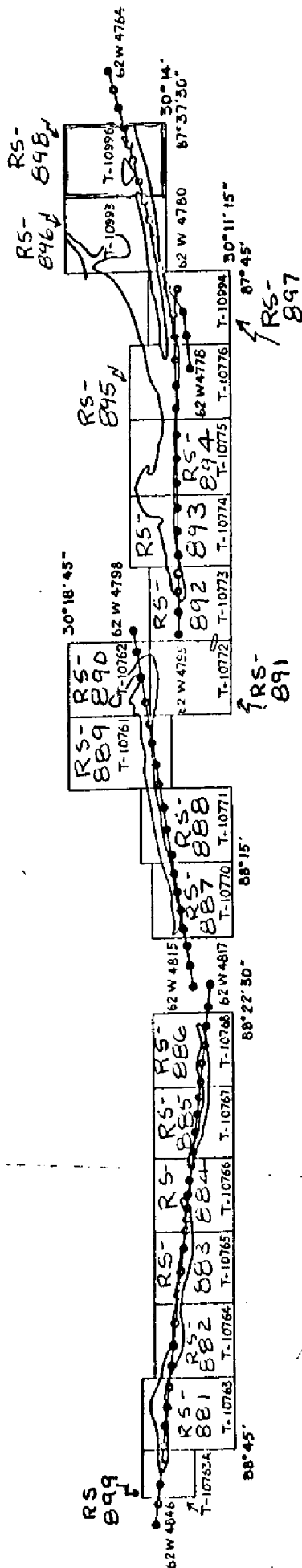

• 1:20,000 RC-8 (Pan.) Photographs. Photographs also 1:10,000 ratio prints for Hydro Support.