

Original

11815

11815

11815

Form 504

U. S. DEPARTMENT OF COMMERCE
COAST AND GEODETIC SURVEY

DESCRIPTIVE REPORT

Type of Survey SHORELINE (Photogrammetric)

Field No. _____ Office No. T-11815

LOCALITY

State Mississippi

General locality Mississippi Sound

Locality Davis Bayou

1966 - 1967 - -

CHIEF OF PARTY

J. Bull, Director, Atlantic Marine Center

LIBRARY & ARCHIVES

DATE _____

USCOMM-DC 5087

11815

DESCRIPTIVE REPORT - DATA RECORD

T - 11815

PROJECT NO. (II): PH-6625		
FIELD OFFICE (II): Atlantic Marine Center		CHIEF OF PARTY J. Bull, CAPT
PHOTOGRAMMETRIC OFFICE (III): Atlantic Marine Center		OFFICER-IN-CHARGE J. Bull, CAPT
INSTRUCTIONS DATED (II) (III): <i>Field: Dec. 1965</i> <i>" Suppl. #1: Mar. 11, 1966</i> <i>April 27, 1966 (Office)</i> <i>Field - Photo Hydro & Edit: Sept. 27, 1967</i> <i>Aerotriangulation: March 1, 1966</i>		
METHOD OF COMPILATION (III): Kelsh		
MANUSCRIPT SCALE (III): 1:10,000	STEREOSCOPIC PLOTTING INSTRUMENT SCALE (III): 1:6,000 pantographed to 1:10,000	
DATE RECEIVED IN WASHINGTON OFFICE (IV):	DATE REPORTED TO NAUTICAL CHART BRANCH (IV):	
APPLIED TO CHART NO.	DATE:	DATE REGISTERED (IV):
GEOGRAPHIC DATUM (III): N. A. 1927		VERTICAL DATUM (III): MHW MEANS EXCEPT AS FOLLOWS: Elevations shown as (25) refer to mean high water Elevations shown as (5) refer to sounding datum i.e., mean low water or mean lower low water
REFERENCE STATION (III): DAVIS 1935 ✓		
LAT.: 30° 22' 17."955(552.9m) ✓	LONG.: 88° 46' 53".778(1,436.0m) ✓	<input checked="" type="checkbox"/> ADJUSTED <input type="checkbox"/> UNADJUSTED
PLANE COORDINATES (IV): = 256,380.78 ft. ✓ x = 516,313.20 ft. ✓		STATE Mississippi ✓ ZONE East ✓
ROMAN NUMERALS INDICATE WHETHER THE ITEM IS TO BE ENTERED BY (II) FIELD PARTY, (III) PHOTOGRAMMETRIC OFFICE, OR (IV) WASHINGTON OFFICE. WHEN ENTERING NAMES OF PERSONNEL ON THIS RECORD GIVE THE SURNAME AND INITIALS, NOT INITIALS ONLY.		

DESCRIPTIVE REPORT - DATA RECORD

FIELD INSPECTION BY (II):		DATE:
None		
MEAN HIGH WATER LOCATION (III) (STATE DATE AND METHOD OF LOCATION):		
Air Photo Compilation		
Date of Photography January 27, 1966		
PROJECTION AND GRIDS RULED BY (IV):		DATE
A. E. Roundtree		5/2/66
PROJECTION AND GRIDS CHECKED BY (IV):		DATE
R. Glaser		5/2/66
CONTROL PLOTTED BY (III):		DATE
J. Place		August 1966
CONTROL CHECKED BY (III):		DATE
L. Graves		August 1966
RADIAL PLOT OR STEREOSCOPIC CONTROL EXTENSION BY (III):		DATE
P. Hawkins (WSC)		no date
STEREOSCOPIC INSTRUMENT COMPILATION (III):	PLANIMETRY	DATE
	A. Shands	8/17/66
Kelsh	CONTOURS	DATE
	Inapplicable	
MANUSCRIPT DELINEATED BY (III):		DATE
R. J. Pate		8/29/66
SCRIBING BY (III):		DATE
F. P. Margiotta		July 1967
PHOTOGRAMMETRIC OFFICE REVIEW BY (III): R.E. Smith (Appl. of Field Edit)		DATE May, 1967
" " (Scribing)		Aug. 1967
R. E. Smith (Compilation)		9/2/66
REMARKS: FIELD EDIT BY W.R. CAMERON IN JAN. 1967		

DESCRIPTIVE REPORT - DATA RECORD

CAMERA (KIND OR SOURCE) (III):

#S" Camera

PHOTOGRAPHS (III)

NUMBER	DATE	TIME	SCALE	** STAGE OF TIDE
66-S-1850 thru 1852	Jan. 27, 1966	09:20	1:30,000	0.0 M.L.W
66-S-1918 thru 1922	"	10:05	1:15,000	0.0 "
66-S-1944 thru 1948	"	10:15	1:15,000	0.0 "
66-S-2213 thru 2218 (color)	"	15:15	1:20,000	0.7 above MLW

** Predicted

TIDE (III)

Diurnal

	RATIO OF RANGES	XXXX RANGE	SPRING RANGE
REFERENCE STATION: Pensacola, Fla.		1.3	
ORDINATE STATION: Biloxi, Biloxi Bay, Miss.		1.8	
SUBORDINATE STATION:			

Atlantic Marine Center
WASHINGTON OFFICE REVIEW BY (IV):

W. M. Slarney

DATE:

Nov. 1968

PROOF EDIT BY (IV):

DATE:

NUMBER OF TRIANGULATION STATIONS SEARCHED FOR (II):

7*

RECOVERED:

6*

IDENTIFIED:

5*

NUMBER OF BM(S) SEARCHED FOR (II):

—

RECOVERED:

—

IDENTIFIED

—

NUMBER OF RECOVERABLE PHOTO STATIONS ESTABLISHED (III):

—

NUMBER OF TEMPORARY PHOTO HYDRO STATIONS ESTABLISHED (III):

—

REMARKS:

Δ Sta. HAMIL is about 2 1/2 miles east of Project Limits

COMPILATION RECORD

COMPLETION DATE

REMARKS

Compilation complete pending Field Edit	Sept. 1966	Superseded
Field Edit Applied Compilation complete	June 1967	<i>Superseded.</i>
<i>Final Review</i>	<i>Nov. 1968</i>	

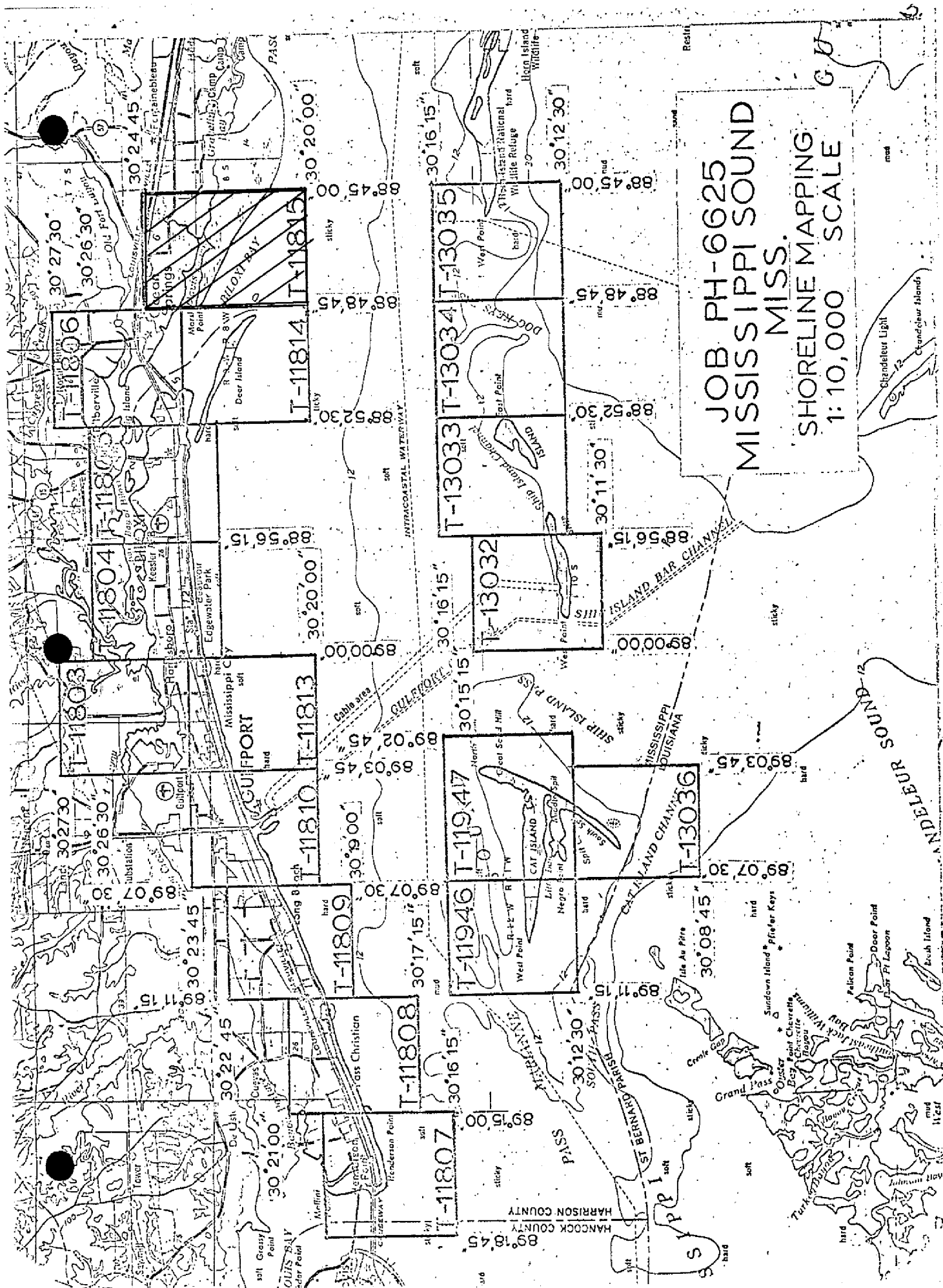

JOB PH-6625
MISSISSIPPI SOUND
MISS.
SHORELINE MAPPING
1:10,000 SCALE



6.

SUMMARY TO ACCOMPANY
DESCRIPTIVE REPORT T-11815

Shoreline manuscript T-11815 is one of the eighteen 1:10,000 scale maps that comprise Ph-6625. These maps are for Mississippi Sound, from Bay St. Louis through Gulfport and Biloxi to Belle Fontaine Point; and the offshore area of Cat Island through Ship Island and includes the west end of Horn Island. The sketch on page 5 of this report shows the position of T-11815 in Ph-6625.

This is a stereo-instrument job in advance of hydrographic surveys of the area. The only field work preceding compilation was that pertaining to control identification, and pre-marking of control stations before photography. The stereoplanigraph bridge was run in the Washington Office with 1:30,000 scale panchromatic photography taken January 27, 1966 with the "S" camera. Compilation was primarily by Kelsh Plotter with the same photographs used for bridging. Ratio prints at 1:10,000 scale ~~was~~ ^{were} processed and furnished for hydro support.

Additional photographic coverage along the shoreline was provided with 1:15,000 scale panchromatic "S" photographs, of January 27, 1966 enlarged to 1:10,000 for hydro support; these were fixed graphically and the centers are on the map. Color photographs at 1:20,000 scale of January 27, 1966 were provided for use in the offshore areas, particularly in the ship channels. The centers of these photographs are not on the map.

The map was field edit in January 1967. Field edit was done on an ozalid, a cronaflex, and on photographs 66-S-1850 and 1852. The map was scribed and stuck-up after applying the field edit.

Final review was done at the Atlantic Marine Center during **November** 1968. Please note paragraph 2 of Item 61 of the Final Review Report.

The compilation manuscript was a vinylite sheet 4 minutes 30 seconds in latitude and 3 minutes and 45 seconds in longitude. The smooth manuscript is on cronaflex for registry and record after final review.

FIELD INSPECTION REPORT

There was no field inspection prior to compilation.

PHOTOGRAMMETRIC PLOT REPORT
Job PH-6625
Mississippi Sound, Mississippi

Part I

21. Area Covered

Part I includes the mainland shore areas and the close, off-shore islands of Mississippi Sound. T-sheets 11803 through 11810 and 11813 through 11815 are included in this report.

22. Method

Three strips of photography were bridged on the stereoplanigraph and adjusted by IBM 1620 methods. All strips were joined by common control stations and/or tie points. All tie points between strips were averaged.

Strip #1 consisted of photographs 66-S-1849 through 1856. This strip was adjusted using five control stations with one additional station as a check.

Strip #2 consisted of photographs 66-S-1809 through 1827. This strip was adjusted using six control stations with fourteen additional stations as checks.

Strip #3 consisted of photographs 66-S-1830 through 1842. This strip was adjusted on four stations with six additional stations as checks.

23. Adequacy of Control

Control was adequate and complied with project instructions. The following stations could not be held during bridging operations.

#1. Bridge, 1935 (S.S.A.) This premarked station was observed in all strips but could not be held in the adjustment of bridges #2 and #3 by 15 to 20 feet. The station held within six feet in Strip #1, but this error was still large for a premarked station. No reasons could be determined for this error. It is possible the target could have been disturbed before photography since the station was in an area easily accessible to the public.

9

#2. Several office identified control stations were on the limits of standard map accuracy; however, due to the number of stations holding well within the limits, these stations were disregarded as having errors in office identification.

24. Supplemental Data

Local GS Quads were used for basic leveling during bridging operations.

25. Photography

Photography was adequate as to coverage, quality and definition.

Submitted by:

Paul Hawkins
Paul Hawkins

Approved by:

John D. Perrow Jr.
John D. Perrow, Jr.

NOTES TO COMPILER
Job PH-6625
Mississippi Sound, Mississippi

Part I

Attempts to extend Bridge #3 to include plate 66-S-1843 met with repeated, poor results due to the small land area available for clearing the stereomodel. This area must be compiled by graphic methods. Ratio prints (scale 1:10,000) for this area as well as the entire project will be provided to the Compilation Office.

Part II of this project will follow as soon as control is provided for the area.

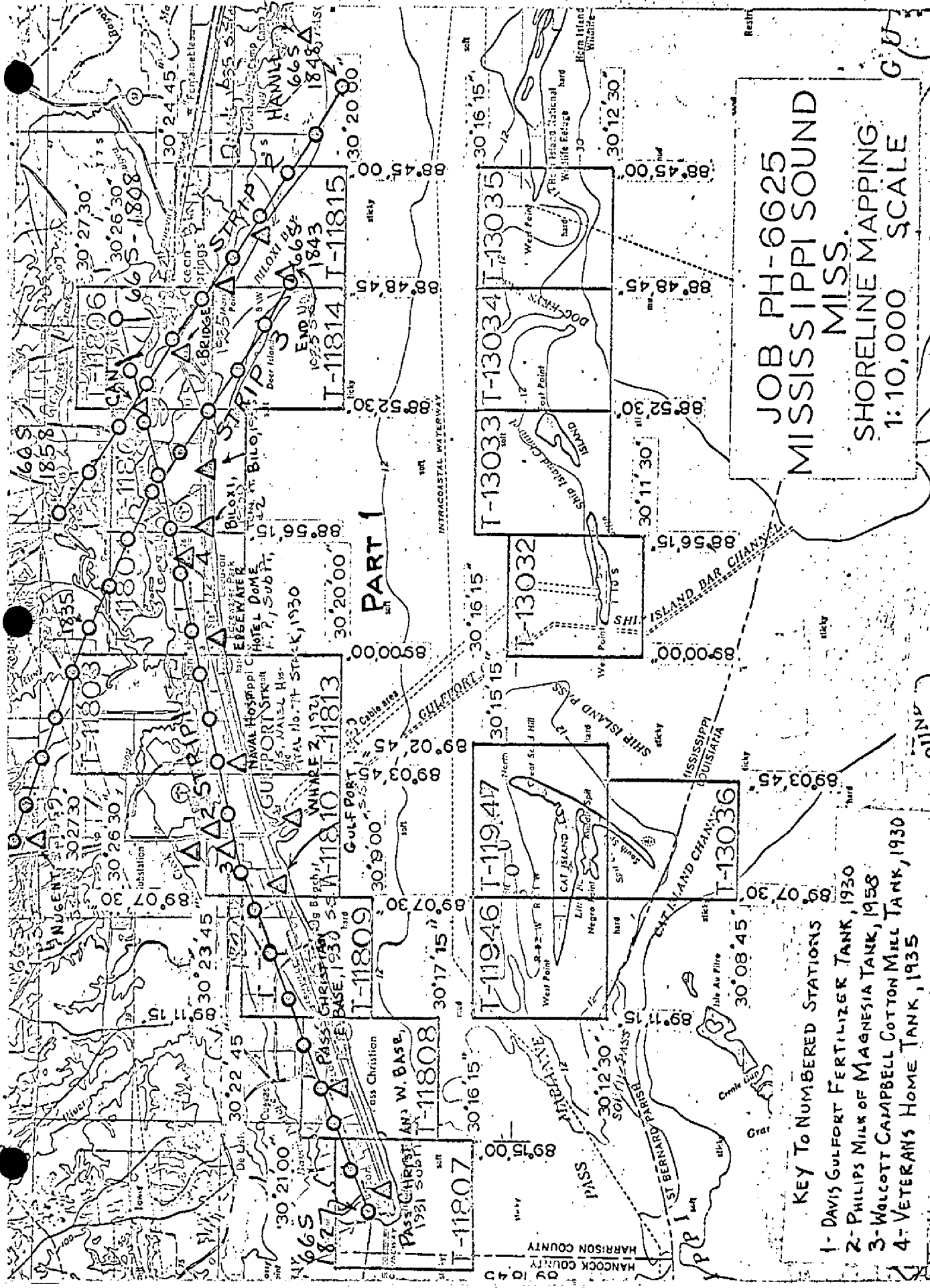

**JOB PH-6625
MISSISSIPPI SOUND
MISS.
SHORELINE MAPPING
1:10,000 SCALE**

- KEY TO NUMBERED STATIONS**
- 1- DAVIS GULFPORT FERTILIZER TANK, 1930
 - 2- PHILIPS MILK OF MAGNESIA TANK, 1958
 - 3- WALCOTT CAMPBELL COTTON MILL TANK, 1930
 - 4- VETERANS HOME TANK, 1935

PART 1

MAP T-11815

PROJECT NO. PH-6625

SCALE OF MAP 1:10,000

SCALE FACTOR

None

[illegible]

1 FT. = 3048006 METER
COMPUTED BY: A

A. C. Rauck, Jr.

DATE August 22, 1966

CHECKED BY: C. Blood

DATE _____

8/22/66

COMM. DC-57813

COMPILATION REPORT
T-11815

~~XX~~

31. DELINEATION

The Kelsh plotter was used. A small island on the west edge of the sheet at latitude 21°30" was delineated graphically from the ratioed photographs.

There was no field inspection.

Photography was satisfactory.

32. CONTROL

See Photogrammetric Plot Report.

33. SUPPLEMENTAL DATA

None.

34. CONTOURS AND DRAINAGE

Contours are inapplicable.

Drainage was delineated from office interpretation of the photographs.

35. SHORELINE AND ALONGSHORE DETAILS

Shallow limits, spoil areas, and the low water line were delineated from office interpretation of the photographs.

36. OFFSHORE DETAILS

No statement.

37. LANDMARKS AND AIDS

Appropriate copies of Form 567 for Landmarks and Aids to Navigation were forwarded to the Washington Office under date June 1967.

144

38. CONTROL FOR FUTURE SURVEYS

None.

39. JUNCTIONS

Junctions are in agreement with T-11806 and T-11814 to the west. There are no contemporary surveys to the north or east. Mississippi Sound is to the south.

40. HORIZONTAL AND VERTICAL ACCURACY

No statement.

46. COMPARISON WITH EXISTING MAPS

Comparison has been made with U.S.G.S. Quadrangles, OCEAN SPRINGS, MISS., scale 1:24,000 dated 1954 and DEER ISLAND, MISS., scale 1:24,000 dated 1954.

47. COMPARISON WITH NAUTICAL CHARTS

A comparison has been made with Chart No. 1267, 11th edition, scale 1:80,000 revised January 31, 1966 and Chart No. 876-SC, scale 1:40,000, 1st edition dated February 26, 1966.

ITEMS TO BE APPLIED TO NAUTICAL CHARTS IMMEDIATELY

None.

ITEMS TO BE CARRIED FORWARD

None.

R. E. Smith
R. E. Smith
Cartographer

Approved and forwarded:

For *J. Bull*
J. Bull, CAPT, USESSA
Director, Atlantic Marine Center

15.
May 22, 1968

48. GEOGRAPHIC NAMES

FINAL NAME SHEET

PH-6625 (Mississippi Sound, Miss.)

T-11815

Biloxi Bay

Cedar Point

Davis Bayou

Halstead Bayou

Heron Bayou

Hollingsworth Point

Marsh Point

Mississippi Sound

Ramsay Bayou

Red Bluff

Simmons Bayou

Stark Bayou

Weeks Bayou

Approved by:

A. Joseph Wraight
A. Joseph Wraight
Chief Geographer

Prepared by:

Frank W. Pickett
Frank W. Pickett
Cartographic Technician

T-11815

49. NOTES FOR THE HYDROGRAPHER

Refer to the field edit discrepancy ozalid.

PHOTOGRAMMETRIC OFFICE REVIEW

T-~~XXXX~~ 11815

1. PROJECTION AND GRIDS RES	2. TITLE RES	3. MANUSCRIPT NUMBERS RES	4. MANUSCRIPT SIZE RES
CONTROL STATIONS			
5. HORIZONTAL CONTROL STATIONS OF THIRD-ORDER OR HIGHER ACCURACY RES	6. RECOVERABLE HORIZONTAL STATIONS OF LESS THAN THIRD-ORDER ACCURACY (Topographic stations) XX		7. PHOTO HYDRO STATIONS XX
8. BENCH MARKS XX	9. PLOTTING OF SEXTANT FIXES XX	10. PHOTOGRAMMETRIC PLOT REPORT Bridge (WSC)	11. DETAIL POINTS Kelsh
ALONGSHORE AREAS (Nautical Chart Data)			
12. SHORELINE RES	13. LOW-WATER LINE RES	14. ROCKS, SHOALS, ETC. RES	15. BRIDGES XX
16. AIDS TO NAVIGATION RES	17. LANDMARKS RES	18. OTHER ALONGSHORE PHYSICAL FEATURES RES	19. OTHER ALONGSHORE CULTURAL FEATURES RES
PHYSICAL FEATURES			
20. WATER FEATURES RES	21. NATURAL GROUND COVER RES		22. PLANETABLE CONTOURS XX
23. STEREOSCOPIC INSTRUMENT CONTOURS XX	24. CONTOURS IN GENERAL XX	25. SPOT ELEVATIONS XX	26. OTHER PHYSICAL FEATURES RES
CULTURAL FEATURES			
27. ROADS RES	28. BUILDINGS RES	29. RAILROADS XX	30. OTHER CULTURAL FEATURES RES
BOUNDARIES			
31. BOUNDARY LINES XX		32. PUBLIC LAND LINES XX	
MISCELLANEOUS			
33. GEOGRAPHIC NAMES RES	34. JUNCTIONS RES		35. LEGIBILITY OF THE MANUSCRIPT RES
36. DISCREPANCY OVERLAY XX	37. DESCRIPTIVE REPORT RES	38. FIELD INSPECTION PHOTOGRAPHS XX	39. FORMS RES
40. REVIEWER P. E. Smith RES		SUPERVISOR, REVIEW SECTION OR UNIT ACR Albert C. Rauck Jr.	
41. REMARKS (See attached sheet)			
FIELD COMPLETION ADDITIONS AND CORRECTIONS TO THE MANUSCRIPT			
42. Additions and corrections furnished by the field completion survey have been applied to the manuscript. The manuscript is now complete except as noted under item 43.			
COMPILER RRW R. R. White		SUPERVISOR ACR Albert C. Rauck Jr.	
43. REMARKS Field Edit applied from cronaflex positive, Field Edit Ozalid, and field photographs Nos. 66-S-1850 and 66-S-1852.			

FIELD EDIT REPORT

SHEET T-11815

JOB PH-6625

JANUARY 1967

Respectfully submitted,

William R. Cameron

William R. Cameron

ENS, USESSA

Chief, Photo Party 61

18.

51 Methods

All field edit work was done in accordance with project instructions and photo instructions. Certain shoreline and offshore features were located by planetable and radial-plot methods and are shown on a cronaflex positive of the manuscript.

An inspection of alongshore features such as marsh areas, piers, pier ruins, etc. was made. Additions and corrections are shown on field ratio prints. Measurements from photo points to the MHWL were made and recorded on field ratio prints.

All landmarks and fixed aids to navigation were located or verified and a Form 567 was submitted.

All field edit notes were made in violet ink on the field ratio prints. Each correction or group of corrections was cross-referenced by appropriate photograph numbers on the field edit ozalid. This ozalid is an index and inventory of all corrections to be applied to the map manuscript.

52 Adequacy of Compilation

Compilation of the manuscript was adequate and complete considering there was no field inspection of the area prior to compilation.

54 Recommendations

None.

56 Additional Information

Field edit information concerning this manuscript appears on the following field ratio prints:

66S-1850
66S-1852.

The fixed aids to navigation marking the channel leading into and through Davis Bayou are privately-maintained piles. These were located by radial plot and planetable methods and are shown on a cronaflex positive of the manuscript.

56 Additional Information (continued)

The spoil areas shown in Davis Bayou are subject to frequent change due to dredging required to maintain the channel.

Objects such as duckblinds were inspected and found to be of a temporary nature. These should not be charted.

The note to verify shallow areas on the field edit ozalid is not applicable.

NONFLOATING AIDS ORIXANEMERKS FOR CHARTS

STRIKE OUT TWO

Atlantic Marine Center
June 27, 1967

I recommend that the following objects which have been inspected from seaward to determine their value as landmarks be charted on the charts indicated.

D. J. H. /

The positions given have been checked after listing-by

R. White

for J. Bull, RADM, USESSA
Director, A.M.C. CH

Director, A.M.C. *Chief of Party.*

[illegible]

This form shall be prepared in accordance with Hydrographic Manual, Publication 20.2, Sec. 6-36, Fig. 79. Positions of charted landmarks and non-floating aids to navigation, if redetermined, shall be reported on this form. Revisions shall show both the old and new positions. The data should be considered for the charts of the area and not by individual field survey sheets. Information under each column heading should be given.

* TABULATE SECONDS AND METERS

1. USCOMM-DC 25412-P61

STRIKE OUT TWO

NOTES ON THE CHARTS FOR CHARTS

Atlantic Marine Center

June 27

1967

I recommend that the following objects which have ~~(been)~~ been inspected from seaward to determine their value as landmarks be charted on ~~(the latest of these)~~ the charts indicated.

The positions given have been checked after listing by

R. White

for J. Bull, RADM, USESA +
Director. A.M.C. Chief

Chief of Party.

[illegible]

This form shall be prepared in accordance with Hydrographic Manual, Publication 20 2, Sec. 6-36, Fig. 79. Positions of charted landmarks and non-floating aids to navigation, if redetermined, shall be reported on this form. Revisions shall show both the old and new positions. The data should be considered for the charts of the area and not by individual field survey sheets. Information under each column heading should be given.

**** TABULATE SECONDS AND METERS**

USCOMM-DC 25412-501

REVIEW REPORT T-11815
SHORELINE
NOVEMBER 1968

61. GENERAL STATEMENT:

See Summary on page 6 of this Descriptive Report.

The delineation of most of the "spoil areas" as islands bare at high water, was questionable, and the photo-hydro support unit was asked to check this when they returned to the area in the fall of 1968. The 1967 field edit^{ors} is valid and this map now reflect the photo-hydro party observations.

An ozalid Comparison Print (pages 26 through 31), which shows the differences noted in Items 62, 64, and 65, is included with the original of this report.

62. COMPARISON WITH REGISTERED TOPOGRAPHIC SURVEYS:

Registered Survey T-9378 S/2; 1:10,000; Field Edit Sept. 1954.
Registered Survey T-9382 N/2; 1:10,000; Field Edit April 1954.

The registered survey differences with T-11815 are on the Comparison Print in blue.

(1) Many of the shoreline differences appear to be a difference in interpretation between the 1954 and 1967 field edits; the apparent shoreline of the area north of Marsh Point (page 26), and the outer coast from 30° 23.1', 88° 48.7' and southeast (pages 27 through 31).

(2) The island near 30° 21.45', 88° 48.5' (page 29) has eroded somewhat since 1954.

(3) Halstead Bayou, Simmons Bayou and some other areas have been altered by dredging, filling, etc.; these are apparent on the Comparison Print.

(4) A small marsh islet near $30^{\circ} 23.4'$, $88^{\circ} 48.32'$ (page 26) is not on T-9378; it may have been thrown up by dredging as spoil since 1954.

(5) Biloxi Channel Lights 10, 14, and 18 are not on T-9382 N/2.

(6) Most of the piles on T-11815 in Davis Bayou, and the mouth of the Bayou were not shown on T-9378.

(7) The previously registered surveys showed none of the spoil areas that appear on T-11815.

This map supersedes the previously registered surveys for nautical chart construction.

63. COMPARISON WITH MAPS OF OTHER AGENCIES:

OCEAN SPRINGS, MISS; USGS quadrangle; 1:24,000; Field Check 1954
DEER ISLAND, MISS; USGS quadrangle; 1:24,000; Field Check 1954

The quadrangles are reductions of Registered Surveys T-9378 and T-9382, and the same differences exist with T-11815, see Item 62.

64. COMPARISON WITH CONTEMPORARY HYDROGRAPHIC SURVEYS:

BOAT SHEET H-8922 (HFP 742 10-2-66); 1:10,000; 1966
BOAT SHEET H-8924 (HFP 742 20-2-66); 1:20,000; 1966

The boat sheet differences with T-11815 are on the Comparison Print in green.

(1) The marsh islet near $30^{\circ} 23.4'$, $88^{\circ} 48.34'$ (page 26) is not on Boat Sheet H-8922.

(2) Many of the "piling" in Davis Bayou on T-11815 (page 27) are labelled "private aids to navigation" on Boat Sheet H-8922. The field edit identified them as "piles".

(3) Boat Sheet H-8924 shows seven "private channel markers north of $30^{\circ} 22.5'$ near longitude $88^{\circ} 45'$ (page 31) that are not on T-11815. They are not visible on the photographs, and were not noted by the field editor.

(4) The "foul area" near $30^{\circ} 22.2'$, $88^{\circ} 46.8'$ (page 30) on H-8922 extends about 30 meters further offshore and is confined to about half the length along the shoreline compared to the area on the field edit ozalid.

65. COMPARISON WITH NAUTICAL CHARTS:

874 SC; 1:40,000; Nov. 1967, corrected to Notice to Mariners #41 of Oct. 14, 1967. 876 SC; 1:40,000; Jan. 1968; corrected to Notice to Mariners #41 of Oct. 14, 1967.

The chart differences with T-11815 are on the Comparison Print in red. Shoreline differences of up to 75 meters may be partially accounted for in the comparison with the 1:40,000 scale chart with T-11815.

(1) The inside areas of both Simmons Bayou (page 28) and Davis Bayou (pages 26 and 27) show differences.

(2) Chart 874 SC shows four islets near $30^{\circ} 20.2'$, $88^{\circ} 45.2'$ (page 31) that are not visible on any photographs and were not noted by the field editor.

66. ADEQUACY OF RESULTS AND FUTURE SURVEYS:

This survey complies with the project instructions, Bureau requirements, and the National Standards for Map Accuracy. No accuracy tests were run in the field.

Approved by:

Submitted by:

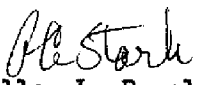
For 
Allen L. Powell, RADM USESSA
Director, Atlantic Marine Center

M. M. Slavney

Approved by:

Chief, Photogrammetric Branch

Chief, Photogrammetry Division

Chief, Nautical Chart Division

NOTES TO REVIEWER

T-11815, Ph-6625

BOAT SHEETS H-8922 (HFP 742 10-2-66) and H-8924 (HFP 742 20-2-66)

Please note items 62, 64, and 65 of the Descriptive Report.

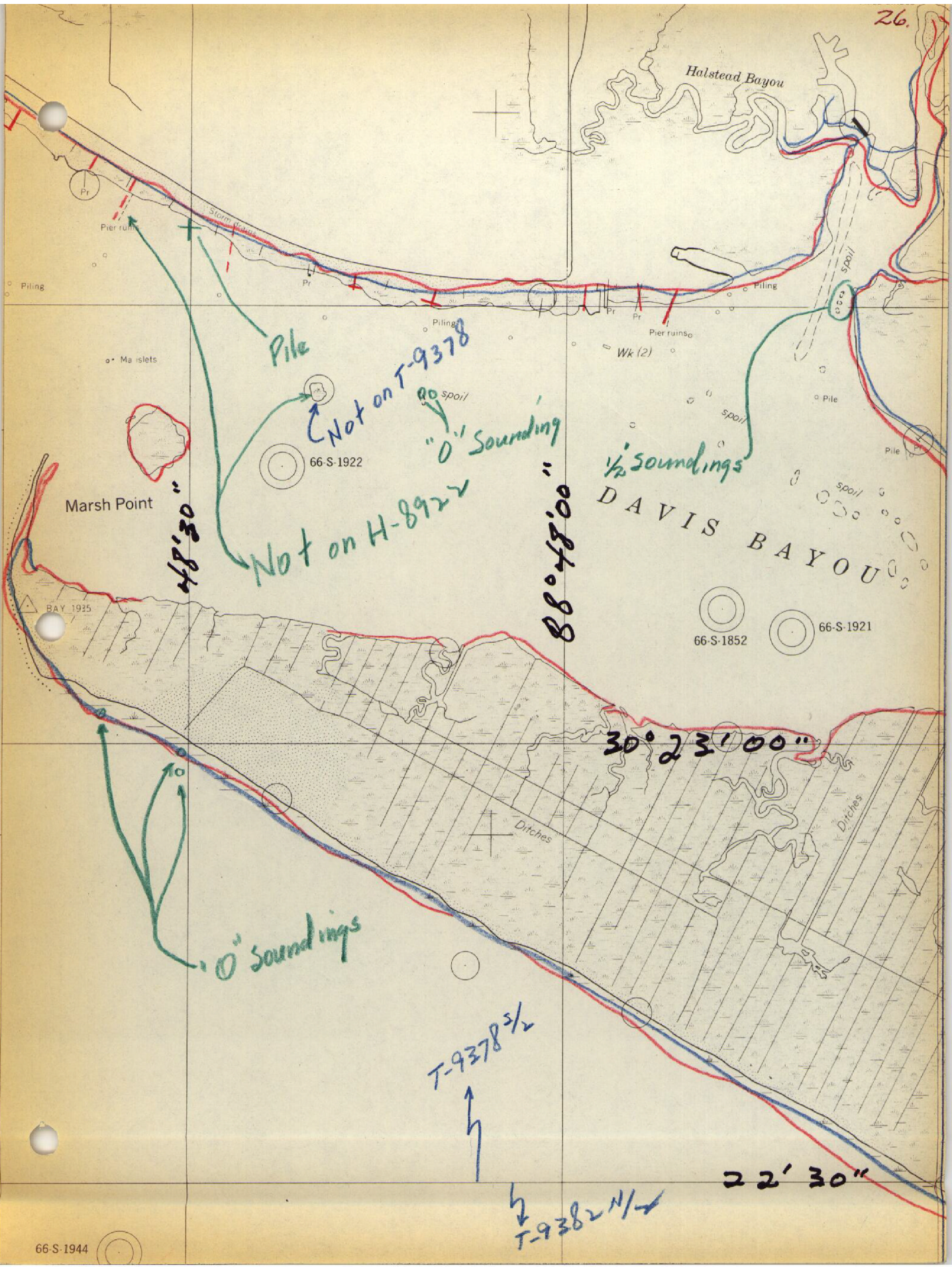

30° 23' 30"

Red Bluff

Duck's Bottom

Cedar Point

Hollingsworth Point

2300'

66-S-1920

66

Ditches

Ditches

Ramsay Branch

T-9378

T-9382



28

△ FONTAINE 1943

23' 30"

30° 23' 00"

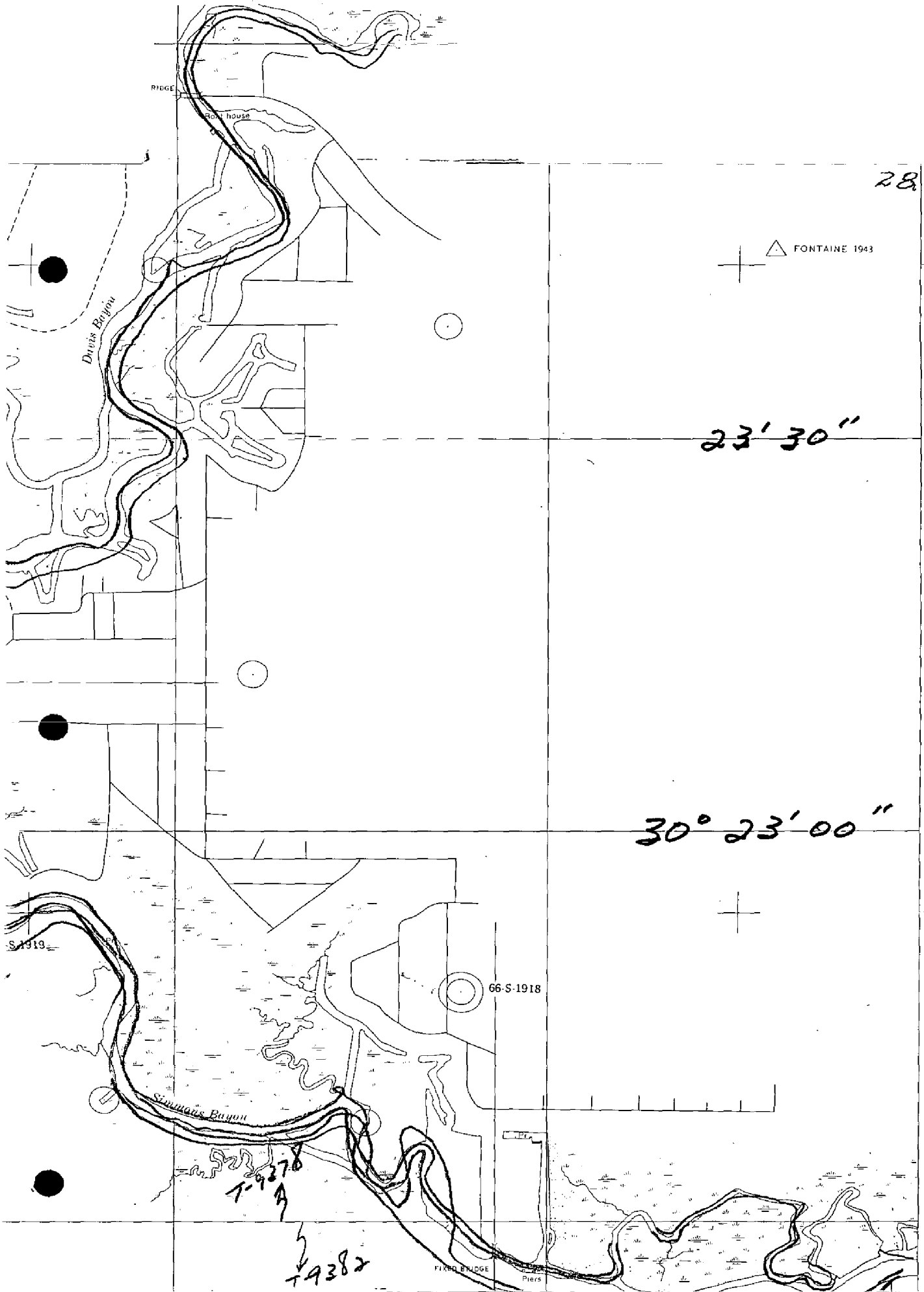

BILOXI EAST CHANNEL LIGHT 18 1967

Not on 66-S-1945 T-938 ✓

48' 30"

30° 22' 00"

88° 48' 00"

B
I
L

H-8922

21' 30"

END RM 1 1935

H-8924

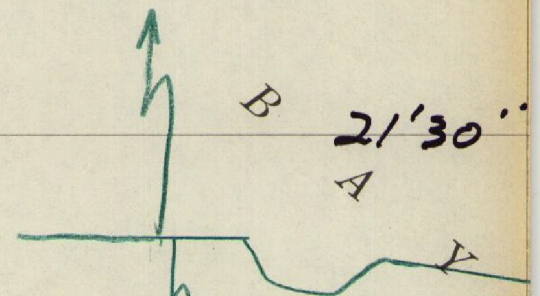
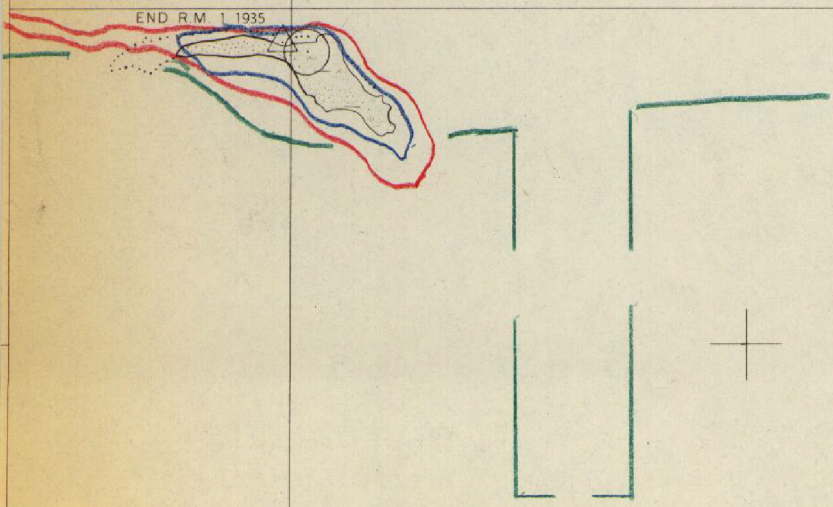

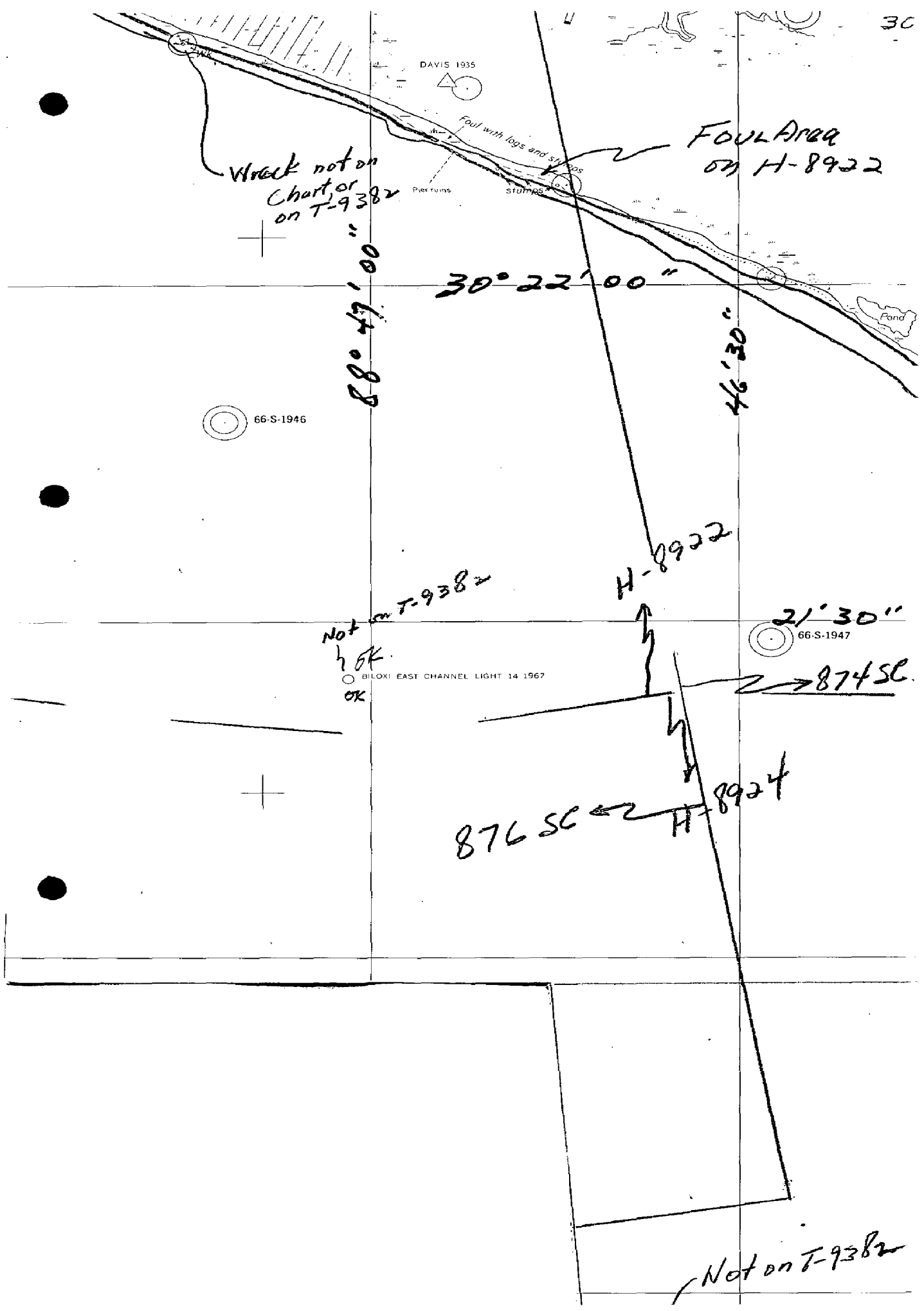

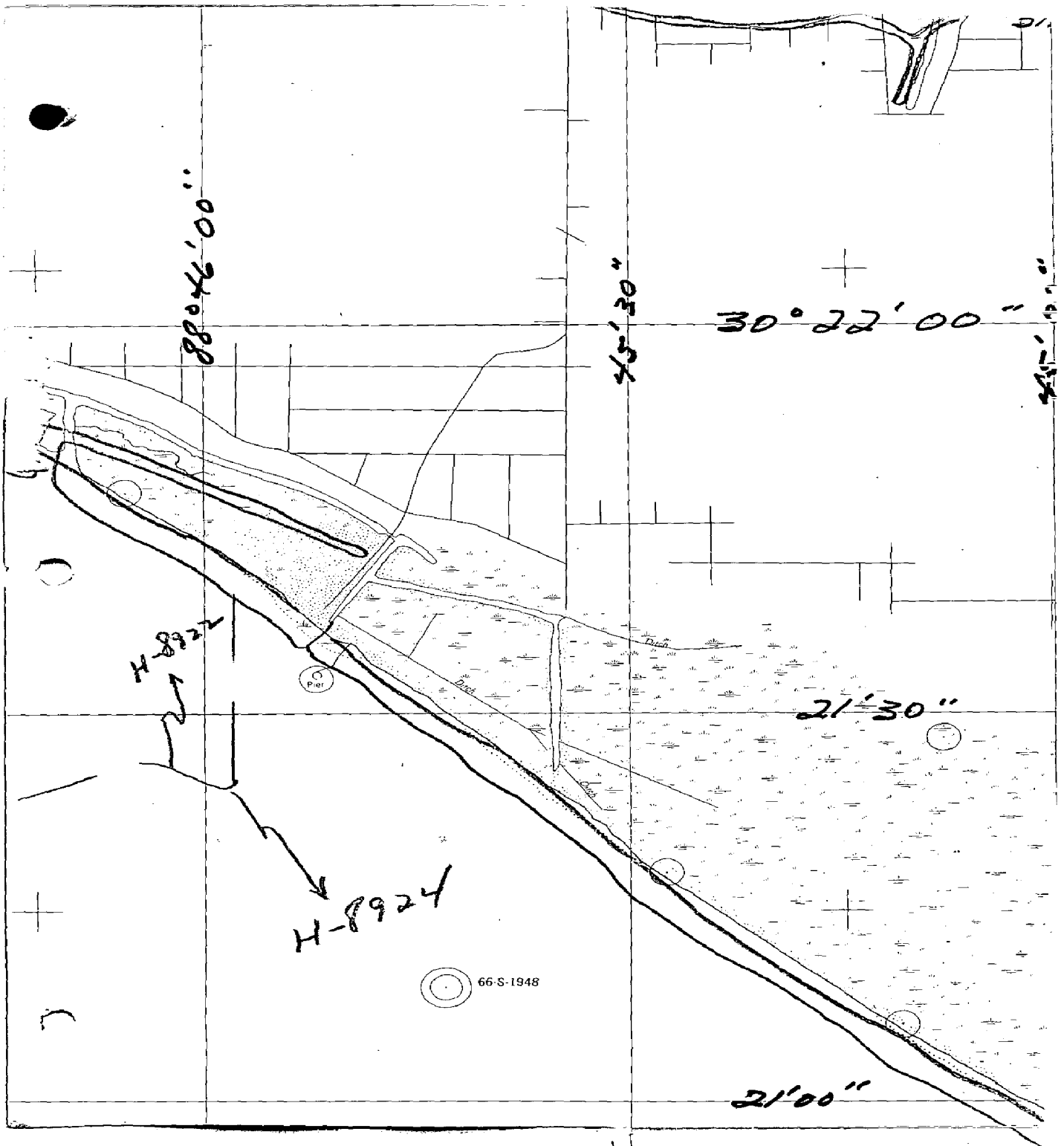

7 Private Aids
on H-8924

20'30"