

T- 12290 (2)

T-12290(2)

NOAA FORM 76-35

U.S. DEPARTMENT OF COMMERCE
NATIONAL OCEANIC AND ATMOSPHERIC ADMINISTRATION
NATIONAL OCEAN SURVEY

DESCRIPTIVE REPORT

Type of Survey Shoreline.....
 Job No. PH-7019 Map No. T-12290 (2)
 Classification No. Edition No. 2
 Field Edited Map

LOCALITY

State North Carolina
 General Locality Cape Fear, N. C. to
 Murrells Inlet, S. C.
 Locality Lockwoods Folly Inlet

 1969 TO 1973

REGISTRY IN ARCHIVES

DATE

MAP NOT INSPECTED IN QUALITY CONTROL PRIOR
TO REGISTRATION

NOAA FORM 76-36A (3-72)		U. S. DEPARTMENT OF COMMERCE NATIONAL OCEANIC AND ATMOSPHERIC ADMIN.	
DESCRIPTIVE REPORT - DATA RECORD		TYPE OF SURVEY <input type="checkbox"/> ORIGINAL <input checked="" type="checkbox"/> RESURVEY <input type="checkbox"/> REVISED	
PHOTOGRAMMETRIC OFFICE Coastal Mapping Division (Norfolk)		SURVEY <u>NE-T-1-290(2)</u> MAP EDITION NO. (2) MAP CLASS Final JOB PH. 7019	
OFFICER-IN-CHARGE Jeffrey G. Carlen, CDR, NOAA		LAST PRECEDING MAP EDITION TYPE OF SURVEY <input checked="" type="checkbox"/> ORIGINAL T-12290 <input type="checkbox"/> RESURVEY <input type="checkbox"/> REVISED	
JOB PH. 6217 MAP CLASS SURVEY DATES: 1964 TO 1965			
I. INSTRUCTIONS DATED			
1. OFFICE		2. FIELD	
Aerotriangulation Jan 15, 1971 Compilation Jan 21, 1972 Compilation, Supplement No. 1 Jan 25, 1972		Aug 26, 1970 Dec 8, 1970	
II. DATUMS			
1. HORIZONTAL: <input checked="" type="checkbox"/> 1927 NORTH AMERICAN		OTHER (Specify)	
2. VERTICAL: <input checked="" type="checkbox"/> MEAN HIGH-WATER <input checked="" type="checkbox"/> MEAN LOW-WATER <input type="checkbox"/> MEAN LOWER LOW-WATER <input type="checkbox"/> MEAN SEA LEVEL		OTHER (Specify)	
3. MAP PROJECTION Polyconic		4. GRID(S) STATE North Carolina ZONE	
5. SCALE 1:20,000		STATE ZONE	
III. HISTORY OF OFFICE OPERATIONS			
OPERATIONS		NAME	DATE
1. AEROTRIANGULATION BY METHOD: <u>Stenoplanigraph</u> LANDMARKS AND AIDS BY		J. Perrow, Jr.	Sep 1971
2. CONTROL AND BRIDGE POINTS PLOTTED BY METHOD: CHECKED BY		D. Phillips D. Phillips	Oct 1971 Oct 1971
3. STEREOSCOPIC INSTRUMENT PLANIMETRY BY COMPILATION CHECKED BY INSTRUMENT: CONTOURS BY SCALE: CHECKED BY		H. Gann L. Neterer, A. Shands NA NA	Mar 1971 Mar 1972
4. MANUSCRIPT DELINEATION PLANIMETRY BY CHECKED BY CONTOURS BY METHOD: CHECKED BY SCALE: HYDRO SUPPORT DATA BY CHECKED BY		H. Gann B. Wilson NA NA H. Gann B. Wilson	Mar 1972 Mar 1972 Mar 1972 Mar 1972
5. OFFICE INSPECTION PRIOR TO FIELD EDIT BY		B. Wilson	Mar 1972
6. APPLICATION OF FIELD EDIT DATA BY		C. Blood	Mar 1975
7. COMPILATION SECTION REVIEW BY		F. Margiotta	Mar 1975
8. FINAL REVIEW BY		C. Bishop	Jan 1976
9. DATA FORWARDED TO PHOTOGRAMMETRIC BRANCH BY		C. Bishop	Mar 1976
10. DATA EXAMINED IN PHOTOGRAMMETRIC BRANCH BY			
11. MAP REGISTERED - COASTAL SURVEY SECTION BY		R. CATDR	MAY 1976

NOAA FORM 76-36B
(3-72)

U. S. DEPARTMENT OF COMMERCE
NATIONAL OCEANIC AND ATMOSPHERIC ADMINISTRATION
NATIONAL OCEAN SURVEY

T-12290 (2)

COMPILATION SOURCES

1. COMPILATION PHOTOGRAPHY

CAMERA(S) Wild RC-8 E & K	TYPES OF PHOTOGRAPHY LEGEND (C) COLOR X (P) PANCHROMATIC (I) INFRARED X	TIME REFERENCE <table style="width: 100%;"> <tr> <td style="width: 50%;"> ZONE Eastern </td> <td style="width: 50%;"> <input checked="" type="checkbox"/> STANDARD </td> </tr> <tr> <td> MERIDIAN 75th </td> <td> <input type="checkbox"/> DAYLIGHT </td> </tr> </table>	ZONE Eastern	<input checked="" type="checkbox"/> STANDARD	MERIDIAN 75th	<input type="checkbox"/> DAYLIGHT
ZONE Eastern	<input checked="" type="checkbox"/> STANDARD					
MERIDIAN 75th	<input type="checkbox"/> DAYLIGHT					
TIDE STAGE REFERENCE <input checked="" type="checkbox"/> PREDICTED TIDES <input type="checkbox"/> REFERENCE STATION RECORDS <input checked="" type="checkbox"/> TIDE CONTROLLED PHOTOGRAPHY						
NUMBER AND TYPE	DATE	TIME	SCALE	STAGE OF TIDE		
70E(C) 8719 thru 8722	Dec 6, 1970	10:12	1:40,000	1.9 ft. above MLW		
69E(C) 3740 thru 3742	Dec 4, 1969	10:10	1:20,000	1.0 ft. above MLW		
69E(C) 3723 thru 3729	Dec 4, 1969	9:47	1:20,000	0.8 ft. above MLW		
*70K 5154R thru 5158R	Apr 3, 1970	11:25	1:20,000	±0.2 ft. of MLW		
*70K 5144 thru 5152	Apr 3, 1970	11:10	1:20,000	±0.2 ft. of MLW		

REMARKS**MEAN RANGE**

Reference Station - Charleston, South Carolina 5.2 ft.
 Subordinate Station, Lockwoods Folly Inlet, North Carolina .. 4.2 ft.

2. SOURCE OF MEAN HIGH-WATER LINE:

Office interpretation of color photography taken Dec 6, 1970 (Photo centers not mapped), and ground survey methods. See Addendum to Compilation Report, which is page 15 of this descriptive report.

3. SOURCE OF MEAN LOW-WATER OR MEAN LOWER LOW-WATER LINE:

MLWL in vicinity of Lockwoods Folly Inlet compiled from Bridge and compilation photography of Dec 6, 1970.

*Tide controlled at MLW, used for MLWL, except in vicinity of Lockwoods Folly Inlet.

4. CONTEMPORARY HYDROGRAPHIC SURVEYS (List only those surveys that are sources for photogrammetric survey information.)

SURVEY NUMBER	DATE(S)	SURVEY COPY USED	SURVEY NUMBER	DATE(S)	SURVEY COPY USED

5. FINAL JUNCTIONS

NORTH	EAST	SOUTH	WEST
No contemp. survey	T-12291(2)	No contemp. survey	T-12289(2)

REMARKS

NOAA FORM 76-36C
(3-72)U. S. DEPARTMENT OF COMMERCE
NATIONAL OCEANIC AND ATMOSPHERIC ADMINISTRATION
NATIONAL OCEAN SURVEYT-12290(2)
HISTORY OF FIELD OPERATIONSI. ☒ FIELD INSPECTION OPERATION☐ FIELD EDIT OPERATION

OPERATION	NAME	DATE
1. CHIEF OF FIELD PARTY	J. K. Wilson	Nov. 1970
2. HORIZONTAL CONTROL	RECOVERED BY R. E. Kesselring	Nov. 1970
	ESTABLISHED BY NA	
	PRE-MARKED OR IDENTIFIED BY R. E. Kesselring	Nov. 1970
3. VERTICAL CONTROL	RECOVERED BY NA	
	ESTABLISHED BY NA	
	PRE-MARKED OR IDENTIFIED BY NA	
4. LANDMARKS AND AIDS TO NAVIGATION	RECOVERED (Triangulation Stations) BY None	
	LOCATED (Field Methods) BY None	
	IDENTIFIED BY None	
5. GEOGRAPHIC NAMES INVESTIGATION	TYPE OF INVESTIGATION <input type="checkbox"/> COMPLETE <input type="checkbox"/> SPECIFIC NAMES ONLY <input checked="" type="checkbox"/> NO INVESTIGATION	
6. PHOTO INSPECTION	CLARIFICATION OF DETAILS BY NA	
7. BOUNDARIES AND LIMITS	SURVEYED OR IDENTIFIED BY NA	

II. SOURCE DATA

1. HORIZONTAL CONTROL IDENTIFIED

Premark

2. VERTICAL CONTROL IDENTIFIED

PHOTO NUMBER

STATION NAME

PHOTO NUMBER

STATION DESIGNATION

70E(C) 8720

BONHAN R. M. 1, 1934

(Photo lost)

3. PHOTO NUMBERS (Clarification of details)

NA

4. LANDMARKS AND AIDS TO NAVIGATION IDENTIFIED

NA

PHOTO NUMBER

OBJECT NAME

PHOTO NUMBER

OBJECT NAME

5. GEOGRAPHIC NAMES:

☐ REPORT☒ NONE

6. BOUNDARY AND LIMITS:

☐ REPORT☒ NONE

7. SUPPLEMENTAL MAPS AND PLANS

None

8. OTHER FIELD RECORDS (Sketch books, etc. DO NOT list data submitted to the Geodesy Division)

1 Form 76-53 Control Station Identification

NOAA FORM 76-36C
(3-72)

T-12290(2)

U. S. DEPARTMENT OF COMMERCE
NATIONAL OCEANIC AND ATMOSPHERIC ADMINISTRATION
NATIONAL OCEAN SURVEY

HISTORY OF FIELD OPERATIONS

I. ☐ FIELD INSPECTION OPERATION☒ FIELD EDIT OPERATION

OPERATION	NAME	DATE
1. CHIEF OF FIELD PARTY	R. S. Tibbetts	Jan, 1973
2. HORIZONTAL CONTROL	RECOVERED BY NA ESTABLISHED BY NA PRE-MARKED OR IDENTIFIED BY NA	
3. VERTICAL CONTROL	RECOVERED BY NA ESTABLISHED BY NA PRE-MARKED OR IDENTIFIED BY NA	
4. LANDMARKS AND AIDS TO NAVIGATION	RECOVERED (Triangulation Stations) BY NA LOCATED (Field Methods) BY T. J. Bulfer IDENTIFIED BY NA	Jan, 1973
5. GEOGRAPHIC NAMES INVESTIGATION	TYPE OF INVESTIGATION <input type="checkbox"/> COMPLETE <input type="checkbox"/> SPECIFIC NAMES ONLY <input checked="" type="checkbox"/> NO INVESTIGATION	
6. PHOTO INSPECTION	CLARIFICATION OF DETAILS BY T. J. Bulfer	Jan, 1973
7. BOUNDARIES AND LIMITS	SURVEYED OR IDENTIFIED BY NA	

II. SOURCE DATA

1. HORIZONTAL CONTROL IDENTIFIED

None

2. VERTICAL CONTROL IDENTIFIED

PHOTO NUMBER

STATION NAME

PHOTO NUMBER

STATION DESIGNATION

3. PHOTO NUMBERS (Clarification of details)

69 E(0) 3723, 3725, 3726; 70 K(1) 5157 (lost) (Identification of photo-points for sextant fixes only)

4. LANDMARKS AND AIDS TO NAVIGATION IDENTIFIED

Data for objects located by field methods or verified by field editor are listed under 8. below.

PHOTO NUMBER

OBJECT NAME

PHOTO NUMBER

OBJECT NAME

5. GEOGRAPHIC NAMES:

☐ REPORT☐ NONE

6. BOUNDARY AND LIMITS:

☐ REPORT☐ NONE

7. SUPPLEMENTAL MAPS AND PLANS

None

8. OTHER FIELD RECORDS (Sketch books, etc. DO NOT list data submitted to the Geodesy Division)

2 Field Edit Ozalids (1 paper, 1 film)

1 Field Edit Report

RECORD OF SURVEY USE

I. MANUSCRIPT COPIES

COMPILATION STAGES			DATE MANUSCRIPT FORWARDED	
DATA COMPILED	DATE	REMARKS	MARINE CHARTS	HYDRO SUPPORT
Compilation complete pending field edit	Feb 1972	Class III manuscript superceded	None	May 16, 1972
Field edit applied compilation complete	Mar 1975	Class I superseded	Mar 13, 1975	
Final Review	Jan 1976		2-27-76	

II. LANDMARKS AND AIDS TO NAVIGATION

1. REPORTS TO MARINE CHART DIVISION, NAUTICAL DATA BRANCH

NUMBER	CHART LETTER NUMBER ASSIGNED	DATE FORWARDED	REMARKS
11	None	Mar 17, 1975	Aids to be charted
2		Mar 17, 1975	Aids to be deleted

2. ☐ REPORT TO MARINE CHART DIVISION, COAST PILOT BRANCH. DATE FORWARDED: Mar 17, 19753. ☐ REPORT TO AERONAUTICAL CHART DIVISION, AERONAUTICAL DATA SECTION. DATE FORWARDED: _____

III. FEDERAL RECORDS CENTER DATA

1. ☒ BRIDGING PHOTOGRAPHS; ☒ DUPLICATE BRIDGING REPORT; ☒ COMPUTER READOUTS.
2. ☒ CONTROL STATION IDENTIFICATION CARDS; ☐ FORM NOS 567 SUBMITTED BY FIELD PARTIES.
3. ☒ SOURCE DATA (except for Geographic Names Report) AS LISTED IN SECTION II, NOAA FORM 76-36C.
ACCOUNT FOR EXCEPTIONS: *Not submitted by field party

4. ☐ DATA TO FEDERAL RECORDS CENTER. DATE FORWARDED: _____

IV. SURVEY EDITIONS (This section shall be completed each time a new map edition is registered)

SECOND EDITION	SURVEY NUMBER TP - _____ (2)	JOB NUMBER PH - _____	TYPE OF SURVEY <input type="checkbox"/> REVISED <input type="checkbox"/> RESURVEY	
	DATE OF PHOTOGRAPHY	DATE OF FIELD EDIT	MAP CLASS <input type="checkbox"/> II. <input type="checkbox"/> III. <input type="checkbox"/> IV. <input type="checkbox"/> V. <input type="checkbox"/> FINAL	
THIRD EDITION	SURVEY NUMBER TP - _____ (3)	JOB NUMBER PH - _____	TYPE OF SURVEY <input type="checkbox"/> REVISED <input type="checkbox"/> RESURVEY	
	DATE OF PHOTOGRAPHY	DATE OF FIELD EDIT	MAP CLASS <input type="checkbox"/> II. <input type="checkbox"/> III. <input type="checkbox"/> IV. <input type="checkbox"/> V. <input type="checkbox"/> FINAL	
FOURTH EDITION	SURVEY NUMBER TP - _____ (4)	JOB NUMBER PH - _____	TYPE OF SURVEY <input type="checkbox"/> REVISED <input type="checkbox"/> RESURVEY	
	DATE OF PHOTOGRAPHY	DATE OF FIELD EDIT	MAP CLASS <input type="checkbox"/> II. <input type="checkbox"/> III. <input type="checkbox"/> IV. <input type="checkbox"/> V. <input type="checkbox"/> FINAL	

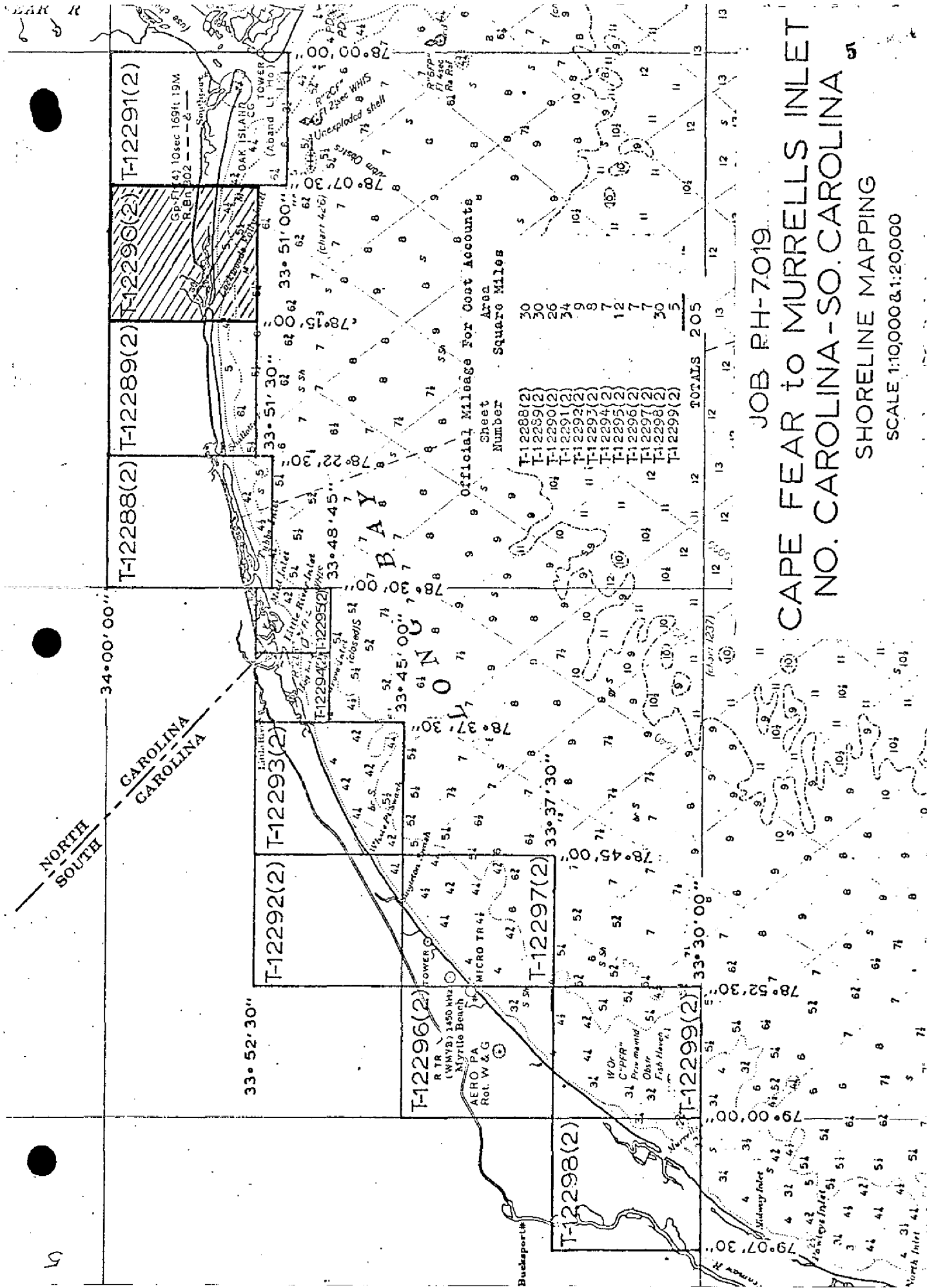

JOB RH-7019

CAPE FEAR to MURRELLS INLET NO. CAROLINA-SO. CAROLINA

SHORELINE MAPPING

SCALE 1:10,000 & 1:20,000

SUMMARY TO ACCOMPANY

DESCRIPTIVE REPORTS T-12288 (2) through T-12299 (2)

Project PH-7019 is one of several projects that comprise the Seaward Coastal Plains Expedition (SCOPE). It is a resurvey most of Project PH-6217 and consists of ten 1:20,000 scale and two 1:10,000 scale shoreline manuscripts. The project extends from Cape Fear, NC to Murrells Inlet, SC. Only the Atlantic Ocean shoreline and shoreline adjacent to inlets was mapped.

The only field work prior to compilation was the identification and premarking of horizontal control required for bridging.

Bridging was done in the Rockville Science Center in Sept., 1971, using the stereoplanigraph with 1:40,000 scale photography taken in December, 1970. The Bald Head Island area was bridged as part of Project CM-7219 in 1973, using 1:40,000 scale color photography taken in October, 1972.

Compilation was done at the Atlantic Marine Center in February and March, 1972.

Field edit was done as follows:

<u>Map</u>	<u>Field Edit Performed by:</u>		<u>Date</u>
	Experienced	Trainee	
	Photogrammetrist		
T-12288 (2)	x		Feb., 1975
T-12289 (2)		x	Feb., 1973
T-12290 (2)		x	Jan., 1973
T-12291 (2)		x	Jan., 1973
T-12292 (2)	x		June, 1974
T-12293 (2)	x		June, 1974

<u>Map</u>	<u>Field Edit Performed by:</u>		<u>Date</u>
	Experienced	Trainee	
	Photogrammetrist		
T-12294 (2)	x		Aug., 1972
T-12295 (2)	x		Aug., 1972
T-12296 (2)	x		May, 1974
T-12297 (2)	x		June, 1974
T-12298 (2)	x		May, 1974
T-12299 (2)	x		May, 1974

The original manuscripts were stabilene sheets. The 1:20,000 scale maps are $7\frac{1}{2}$ minutes in latitude by $7\frac{1}{2}$ minutes in longitude, except T-12288 (2) which is $8\frac{1}{2}$ minutes in latitude by $7\frac{1}{2}$ minutes in longitude, and T-12291 (2) which is 9 minutes in latitude by $7\frac{1}{2}$ minutes in longitude. The 1:10,000 scale maps, T-12294 (2), and T-12295 (2), are each $3\frac{3}{4}$ minutes in latitude by $3\frac{3}{4}$ minutes in longitude.

A cronaflex positive copy and a negative of each final reviewed map were forwarded for record and registry.

PHOTOGRAMMETRIC PLOT REPORT
Job PH-7019
Cape Fear to Murrells Inlet
North Carolina and South Carolina

Sept. 1971

21. Area Covered

This project covers the shoreline from Cape Fear, North Carolina, to just south of Murrells Inlet, South Carolina. Included are 12 T-sheets (T-12288(2) thru T-12299(2)). All sheets are 1:20,000 scale with the exceptions of T-12294(2) and T-12295(2) which are 1:10,000 scale.

22. Method

Five strips of photography were bridged on the Zeiss Stereoplanigraph C-8 in order to obtain pass point positions and exact scale ratios (for Strips #5 thru #13) to be used during compilation. All bridging was performed using color positives rather than glass plates.

Strip #1 (70-E(C)-8716 thru 8725) was adjusted on four triangulation stations with tie points as checks. Strip #2 (70-E(C)-8731 thru 8742) was adjusted on four triangulation stations with companion points, ties with Strips #1 and #3, and one other station as checks. Strip #3 (70-E(C)-8647 thru 8664) was adjusted on nine triangulation points with companion points, ties with Strip #2, and three additional triangulation stations as checks. Strip #5 (69-E(C)-3754 thru 3761) and Strip #6 (69-E(C)-3715 thru 3720) were both adjusted to tie points from Strip #2. Both strips were adjusted on four tie points with additional ties between the two strips as checks. All tie points between strips were averaged. All adjustments were performed on the IBM 1620. All sheets were ruled and plotted on the Coradomat.

23. Adequacy of Control

Horizontal control complied with project instructions; however, it was not adequate in the area of junction of Strips 2 and 3. Vaught RM6, 1962, due to its placement, was visible, in stereo, only on Strip #3. Office identified control provided a substitute in this area.

Although all control held within National Map Accuracy the adjustments of these strips are very weak. No attempt should be made in the future to produce 1:10,000 scale sheets from

- 2 -

the material provided for the 1:20,000 scale sheets. The two short bridges (5 and 6), which were bridged on points from 1:40,000 scale photography, seem to be adequate for the 1:10,000 scale delineation but are only as good as the bridging for the 1:20,000 scale sheets.

All strips in this project were photogrammetrically weak due to the large water areas in the models.

24. Supplemental Data

Vertical control used for bridging only was obtained from local USGS quads.

25. Photography

Photography was adequate as to overlap and definition. Coverage was adequate with the exception of a small land area in the lower right hand edge of T-12291(2).

Respectfully submitted:

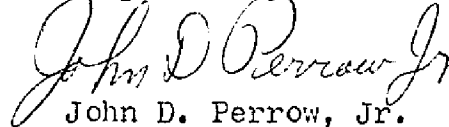

John D. Perrow, Jr.

Approved and Forwarded:

Henry P. Eichert, Chief
Aerotriangulation Section

JOB H-7019
CAPE FEAR to MURRELLS INLET
NO. CAROLINA-50. CAROLINA

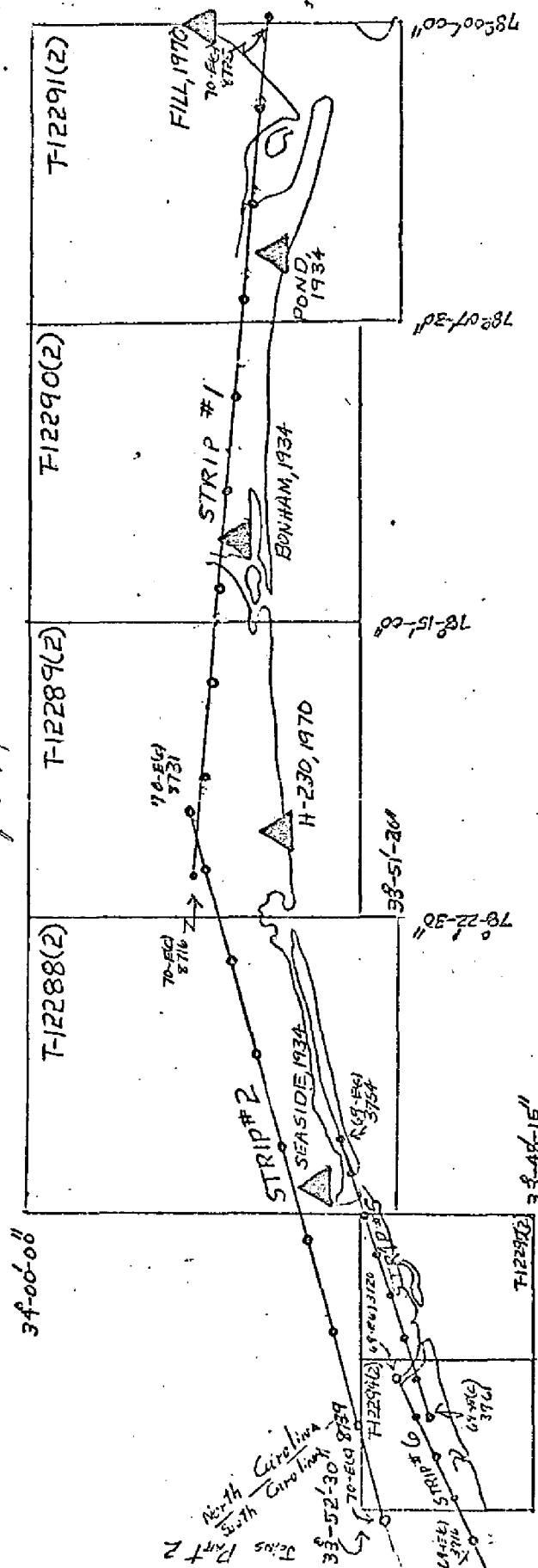
PART I
Sept 71



DE-43-30

TO: PH-7019

JOB PH-7019 CAPE FEAR TO MURRELLS INLET NO. CAROLINA-SO. CAROLINA PART 2

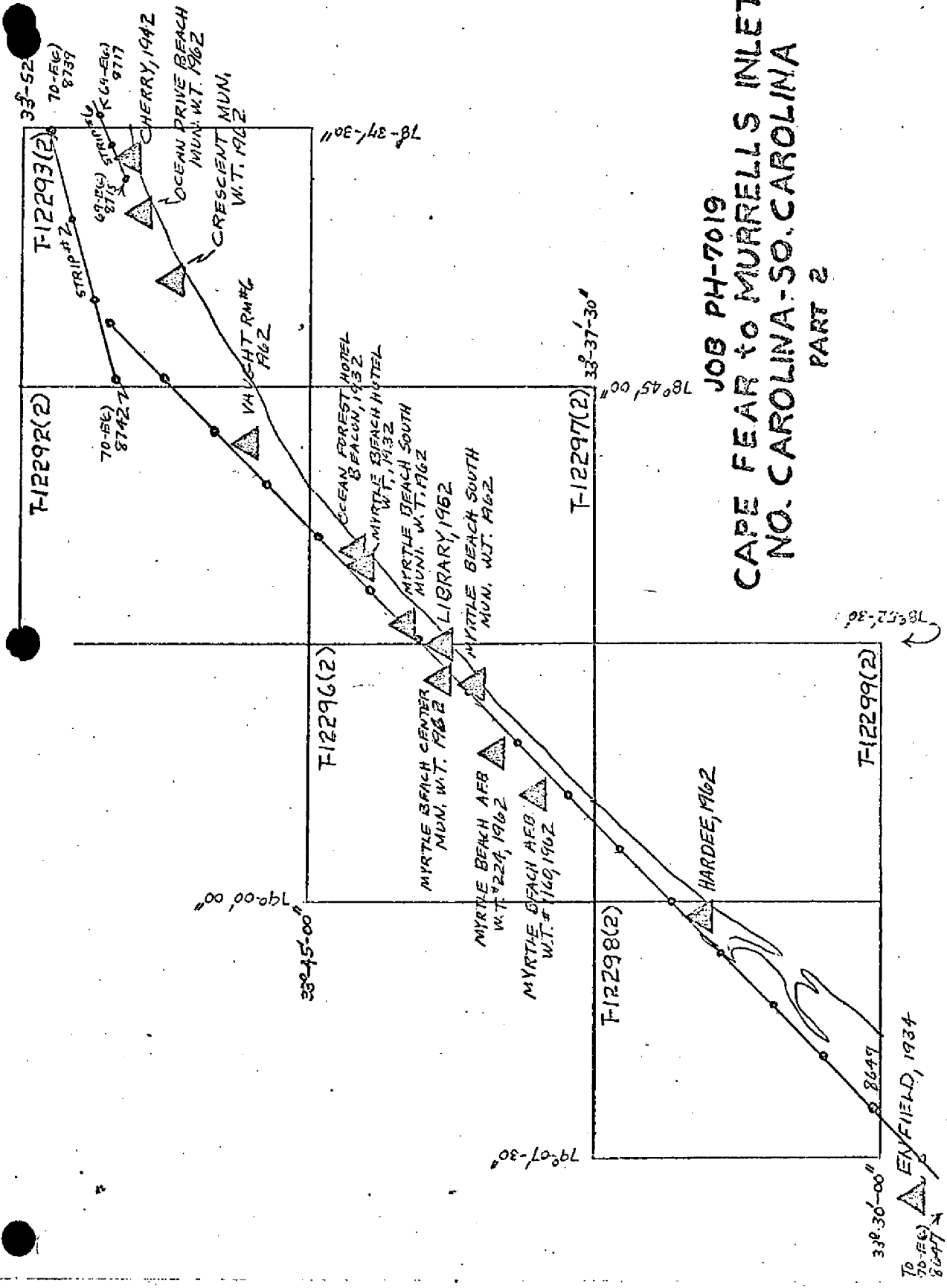

DESCRIPTIVE REPORT CONTROL RECORD

MAP NO.	JOB NO.	STATION NAME	SOURCE OF INFORMATION (Index)	AEROTRI- ANGULATION POINT NUMBER	GEODETTIC DATUM		ORIGINATING ACTIVITY		
					COORDINATES IN FEET STATE ZONE	N.A. 1927	GEOGRAPHIC POSITION ϕ LATITUDE λ LONGITUDE	Coastal Mapping Div. (Norfolk)	
T-12290(2)	PH-7019	BONHAM, 1934	G-1929 Pg. 216		X=		ϕ 33° 55' 19.544"	602.2	(1246.4)
					Y=		λ 78° 12' 43.874"	1126.9	(414.2)
		BIG HILL, 1905	G-5445 Pg. 568		X=		ϕ 33° 54' 52.589"	1620.3	(228.3)
					Y=		λ 78° 12' 08.573"	220.2	(1321.1)
					X=		ϕ		
					Y=		λ		
					X=		ϕ		
					Y=		λ		
					X=		ϕ		
					Y=		λ		
					X=		ϕ		
					Y=		λ		
					X=		ϕ		
					Y=		λ		
					X=		ϕ		
					Y=		λ		
					X=		ϕ		
					Y=		λ		
					X=		ϕ		
					Y=		λ		
					X=		ϕ		
					Y=		λ		
					X=		ϕ		
					Y=		λ		
COMPUTED BY	A. C. Rauck, Jr.				DATE	Jan 10, 1972	COMPUTATION CHECKED BY		DATE
LISTED BY	F. Margiotta				DATE	Jan 11, 1972	LISTING CHECKED BY		DATE
HAND PLOTTING BY					DATE		HAND PLOTTING CHECKED BY		DATE

COMPILATION REPORT

T-12290(2)

31. DELINEATION

1:40,000 scale diapositives were used on the Wild B-8 stereoplotter to delineate all details. Pass points were dropped to 1:20,000 scale ratios which were processed for hydro support.

Photographic coverage was adequate. There was no field inspection prior to compilation.

32. CONTROL

See Photogrammetric Plot Report dated September 1971, and bound with this report.

33. SUPPLEMENTAL DATA

None

34. CONTOURS AND DRAINAGE

Contours are inapplicable.

Drainage was delineated from office interpretation of the photographs.

35. SHORELINE AND ALONGSHORE DETAILS

The shoreline, low water line and alongshore details were delineated from office interpretation of the photographs.

36. OFFSHORE DETAILS

None

37. LANDMARKS AND AIDS

Forms 76-40 for 11 Non-floating aids to navigation for charting and 2 Non-floating aids to navigation to be deleted were sent to the Rockville Maryland Office on March 13, 1975.

38. CONTROL FOR FUTURE SURVEYS

None

39. JUNCTIONS

See Form 76-36b, Item 5.

40. HORIZONTAL AND VERTICAL ACCURACY

No statement

41-45.

Not used.

46. COMPARISON WITH EXISTING MAPS

Comparison was made with U.S.G.S. Quadrangle LOCKWOODS FOLLY, N.C., scale 1:24,000, dated 1943 and with shoreline manuscript T-12290 of which this manuscript is a revision.

47. COMPARISON WITH NAUTICAL CHARTS

Comparison was made with Chart 1236, scale 1:80,000, 6th edition, dated February 17, 1969, and with Chart 835-SC, scale 1:40,000, 8th edition dated January 23, 1971.

ITEMS TO BE APPLIED TO CHARTS IMMEDIATELY

None.

ITEMS TO BE CARRIED FORWARD

None.

Submitted by:

Charles H Bishop

for Harold Gann, Cartographer
March 8, 1972

Approved:

Albert C. Rauck, Jr.

Albert C. Rauck, Jr.
Chief of Coastal Mapping Section

ADDENDUM TO THE COMPILATION REPORT

T-12290(2)

FIELD EDIT

1. No Form 76-40 was submitted with the field work.
2. There is no evidence that existing navigation lights were verified. It is assumed that they were, at least, visually verified without putting check marks by the position on the Field Edit Ozalid.
3. Daybeacons, which were not visible on the mapping photographs, were located by sextant fixes in January 1973. No sextant angles for location of daybeacons were submitted with the field work. The only existing record is the field plotted position of these objects on the film ozalid submitted by the field editor.
4. The mean high water line between longitude $78^{\circ} 12'$ and $78^{\circ} 13.5'$ and at latitude $33^{\circ} 55'$, longitude $78^{\circ} 14.3'$ was revised using field measurements from a photo-identifiable point and a temporary traverse point.

Charles H. Bishop

Charles H. Bishop
Final Reviewer
Jan. 21, 1976

29 Sept. 1975

GEOGRAPHIC NAMES

FINAL NAME SHEET

PH-7019 (Cape Fear to Murrells Inlet, N.C.)

T-12290 (2)

Atlantic Ocean

Davis Creek

Eastern Channel

Holden Beach

Horse Island

Howells Point

Intracoastal Waterway

Lockwoods Folly Inlet

Long Bay

Long Beach

Sheep Island

Sunset Harbor

Approved by



Chas. E. Harrington

Staff Geographer--C51x2

NOAA FORM 75-74 (2-74)		U.S. DEPARTMENT OF COMMERCE NOAA NATIONAL OCEAN SURVEY	
PHOTOGRAMMETRIC OFFICE REVIEW T-12290 (2)			
1. PROJECTION AND GRIDS BW	2. TITLE BW	3. MANUSCRIPT NUMBERS BW	4. MANUSCRIPT SIZE BW
CONTROL STATIONS			
5. HORIZONTAL CONTROL STATIONS OF THIRD-ORDER OR HIGHER ACCURACY BW	6. RECOVERABLE HORIZONTAL STATIONS OF LESS THAN THIRD-ORDER ACCURACY (Topographic stations) BW		7. PHOTO HYDRO STATIONS BW
8. BENCH MARKS BW	9. PLOTTING OF SEXTANT FIXES BW	10. PHOTOGRAMMETRIC PLOT REPORT BW	11. DETAIL POINTS BW
ALONGSHORE AREAS (Nautical Chart Data)			
12. SHORELINE BW	13. LOW-WATER LINE BW	14. ROCKS, SHOALS, ETC. BW	15. BRIDGES BW
16. AIDS TO NAVIGATION BW	17. LANDMARKS BW	18. OTHER ALONGSHORE PHYSICAL FEATURES BW	19. OTHER ALONGSHORE CULTURAL FEATURES BW
PHYSICAL FEATURES			
20. WATER FEATURES BW	21. NATURAL GROUND COVER BW		22. PLANETABLE CONTOURS NA
23. STEREOSCOPIC INSTRUMENT CONTOURS NA	24. CONTOURS IN GENERAL NA	25. SPOT ELEVATIONS NA	26. OTHER PHYSICAL FEATURES
CULTURAL FEATURES			
27. ROADS BW	28. BUILDINGS BW	29. RAILROADS BW	30. OTHER CULTURAL FEATURES BW
BOUNDARIES			
31. BOUNDARY LINES NA		32. PUBLIC LAND LINES NA	
MISCELLANEOUS			
33. GEOGRAPHIC NAMES BW	34. JUNCTIONS BW		35. LEGIBILITY OF THE MANUSCRIPT BW
36. DISCREPANCY OVERLAY BW	37. DESCRIPTIVE REPORT BW	38. FIELD INSPECTION PHOTOGRAPHS BW	39. FORMS BW
40. REVIEWER Compilation for <i>Charles H. Bishop</i> B. Wilson		SUPERVISOR, REVIEW SECTION OR UNIT <i>Albert C. Rauck, Jr.</i> Albert C. Rauck, Jr.	
41. REMARKS (See attached sheet)			
FIELD COMPLETION ADDITIONS AND CORRECTIONS TO THE MANUSCRIPT			
42. Additions and corrections furnished by the field completion survey have been applied to the manuscript. The manuscript is now complete except as noted under item 43.			
COMPILER <i>E. Blood</i> C. Blood Reviewer <i>Frank Margiotta</i> Mar 1975		SUPERVISOR <i>Albert C. Rauck, Jr.</i> Albert C. Rauck, Jr.	
43. REMARKS Field Edit was applied from Field Edit Ozalid & film overlay. Identified sextant fix points on Photos 69E(C) 3723, 3725, 3726 & 70K(I) 5157			

FIELD EDIT REPORT
Job PH-7019
Lockwoods Folly Inlet
North Carolina
Map TP-12290(2)

Field Edit was applied to this map in January, 1973.

51. METHODS

Methods used to locate and verify salient features were resection, intersection, planetable, sextant fix, and taping. Deletions, additions, and corrections to the manuscript have been noted on the field edit ozalid and the film ozalid. Ozalid notations have been made in violet pencil and the field notes on the film ozalid are orange.

52. ADEQUACY OF COMPILATION

The compilation appears to be good. After the application of field edit corrections, compilation will be adequate.

53. MAP ACCURACY

No accuracy test was made on this map.

54. RECOMMENDATIONS

None

55. GEOGRAPHIC NAMES

A complete geographic names investigation was made of this map in January, 1964. That special report covered an area from Winyah Bay, South Carolina to Cape Fear, North Carolina, project PH-21059. No discrepancies were found on this map.

56. SHORELINE AND ALONGSHORE FEATURES

Distances were measured to the mean high water line from photo identifiable points, all referenced on the field edit ozalid. The shoreline in exposed areas is almost exclusively fast.

57. OFFSHORE FEATURES

Offshore hydrography was completed in 1970. The wrecks at Lockwood Folly Inlet have been found and located by the hydrographic party in 1969-70.

58. LANDMARKS AND AIDS

Numerous fixed aids to navigation have been located by sextant fix. These fixes have been plotted on the field edit film ozalid and appropriate data has been submitted. These corrections, as well as others noted on the ozalid, will yield an adequate representation of the navigational aids and landmarks within this map limit.

59. GENERAL STATEMENT

There was no National Ocean Survey Ship operating in the area at the time of field edit.

January 31, 1973

Submitted by,

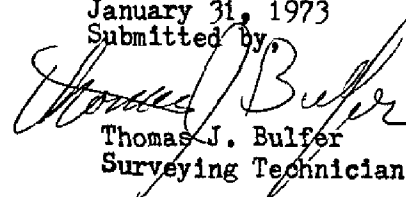

Thomas J. Bulfer

Surveying Technician

orig. to charts
3/13/75

NOAA FORM 76-40 (8-74) Replaces C&GS Form 567.				U.S. DEPARTMENT OF COMMERCE NATIONAL OCEANIC AND ATMOSPHERIC ADMINISTRATION				ORIGINATING ACTIVITY			
NONFLOATING AIDS TO NAVIGATION FOR CHARTS				LOCALITY				HYDROGRAPHIC PARTY			
REPORTING UNIT (If field party, ship or office) Coastal Mapping Div. AMC- Norfolk, Va.				STATE North Carolina				GEOGETIC PARTY			
TO BE CHARTED <input checked="" type="checkbox"/> TO BE REVISED <input type="checkbox"/> TO BE DELETED <input type="checkbox"/>				DATE Mar. 1975				PHOTO FIELD PARTY			
The following objects HAVE <input checked="" type="checkbox"/> BEEN INSPECTED from seaward to determine their value as landmarks.				DATE Mar. 1975				COMPILED BY			
OPR PROJECT NO. 437				JOB NUMBER Ph-7019				FINAL REVIEWER			
SURVEY NUMBER T-12290(2)				DATUM N.A. 1927				QUALITY CONTROL & REVIEW GRP.			
DESCRIPTION (Record reason for deletion of landmark or aid to navigation. Show triangulation station names, where applicable, in parentheses)				POSITION				METHOD AND DATE OF LOCATION (See instructions on reverse side)			
				LATITUDE				OFFICE			
				LONGITUDE				FIELD			
				D.M. Meters				CHARTS AFFECTED			
				D.P. Meters							
LIGHT	Cape Fear-Little River Light 48	33-55	13.05	78-11	30.40	69E(C)3724	Dec. 4, 1969	F-3-8-L	Jan. 1973	835SC	1236
DAY-BEACON	Cape Fear-Little River Daybeacon 46	33-55	18.31	78-13	56.65			F-3-8-L	Jan. 1973	"	"
LIGHT	Cape Fear-Little River Light 44	33-55	19.05	78-13	1152	69E(C)3724	Dec. 4, 1969	F-3-8-L	Jan. 1973	"	"
DAY-BEACON	Cape Fear-Little River Daybeacon 42	33-55	23.21	78-13	34.38			F-3-8-L	Jan. 1973	"	"
DAY-BEACON	Cape Fear-Little River Daybeacon 41	33-55	26.42	78-13	22.46			F-3-8-L	Jan. 1973	"	"
LIGHT	Cape Fear-Little River Light 40	33-55	31.26	78-13	12.89	69E(C)3724	Dec. 4, 1969	F-3-8-L	Jan. 1973	"	"
DAY-BEACON	Cape Fear-Little River Daybeacon 39	33-55	25.87	78-13	05.26			F-3-8-L	Jan. 1973	"	"
LIGHT	Cape Fear-Little River Light 33	33-55	15.77	78-12	46.44	69E(C)3724	Dec. 4, 1969	F-3-8-L	Jan. 1973	"	"
DAY-BEACON	Cape Fear-Little River Daybeacon 32	33-55	13.63	78-12	17.60			F-3-8-L	Jan. 1973	"	"
LIGHT	Cape Fear-Little River Light 29	33-55	08.54	78-11	52.40	69E(C)3725	Dec. 4, 1969	F-3-8-L	Jan. 1973	"	"
DAY-BEACON	Cape Fear-Little River Daybeacon 32	33-55	420	78-12	452			F-3-8-L	Jan. 1973	"	"
LIGHT	Cape Fear-Little River Light 29	33-55	263	78-11	1346			F-3-8-L	Jan. 1973	"	"

2000000

3/13/75

[illegible]

[illegible]

REVIEW REPORT T-12290(2)

SHORELINE

January 21, 1976

61. GENERAL STATEMENT:

This survey is a resurvey of T-12290. See Summary, which is page six (6) of this Descriptive Report, and Addendum to Compilation Report, which is page 15.

A comparison print showing differences noted in Paragraph 62 through 65 is bound with the original of this report.

62. COMPARISON WITH REGISTERED TOPOGRAPHIC SURVEYS:

A comparison was made with Survey T-12290, 1:20,000 scale, dated 1965. Numerous changes to fixed aids to navigation have been made since 1965. Significant differences are shown on the comparison print in blue.

In the area compared, T-12290(2) supersedes T-12290 for nautical chart construction purposes. T-12290 is the latest registered prior survey of the area.

63. COMPARISON WITH MAPS OF OTHER AGENCIES:

A comparison was made with U.S.G.S. Quadrangle LOCKWOODS FOLLY, N. C., scale 1:24,000, dated 1943. Significant differences are shown in brown on the comparison print.

64. COMPARISON WITH CONTEMPORARY HYDROGRAPHIC SURVEYS:

A comparison was made with a copy of the verified smooth Sheet for H-9115 (WH 20-1-70). Significant differences are shown in purple on the comparison print. Wrecks located by the hydrographer on H-9096 are not visible on the compilation photographs.

65. COMPARISON WITH NAUTICAL CHARTS:

A comparison was made with Chart 11534, 1:40,000 scale, 12th edition, dated March 9, 1975. Significant differences are shown in red on the comparison print.

66. ADEQUACY OF RESULTS AND FUTURE SURVEYS:

This map complies with Project Instructions and meets the requirements for Bureau Standards and National Standards of Map Accuracy.

Submitted by:

Charles H. Bishop

Charles H. Bishop
Cartographer
January 21, 1976

Approved for forwarding:

Joseph W. Vonasek

Joseph W. Vonasek
Acting Chief, Photogrammetric Branch, AMC

Approved:

Chief, Photogrammetric Branch

Chief, Coastal Mapping Division

y=70,000 FT.

56'

a.	Cape Fear - Little River	Lt 48
h.	" " " "	Dbn 46
d.	" " " "	Lt 44
j.	" " " "	Dbn 42
k.	" " " "	" 41
e.	" " " "	Lt 40
m.	" " " "	Dbn 39

69E(C) 3723

69E(C) 3741

Lt 40

69E(C) 3742

Daybn 46A

Lt 46

69E(C) 3724

Daybn 41

INTRACOASTAL

Daybn 44A

Sheep Island

Marsh

Sand

Ma Marsh

Channel

Piers

Dunes

Sand

sand

Holden Beach

Dunes

Lockwoods

Folly Inlet

33°55'

y=60,000 FT

Also on
T-12290Both wks. on
chart 11534 Area subject to frequent
changeNeither wreck is visible
on the photographs.

COMPARISON PRINT

Blue = T-12290
 Brown = USGS
 Red = Chart 11534
 Purple = H-9096

78°15'

14'

T-12290 (2)
 1:20,000

COMPARISON PRINT

Blue = T-12290

Brown = USGS

Red = Chart 11534

Purple = H-9096

69 E(C) 3740

p. Lockwoods Folly River Dbn 2
 f. Cape Fear-Little River Lt 33
 n. " " " Dbn 32
 g. " " " Lt 29

54'

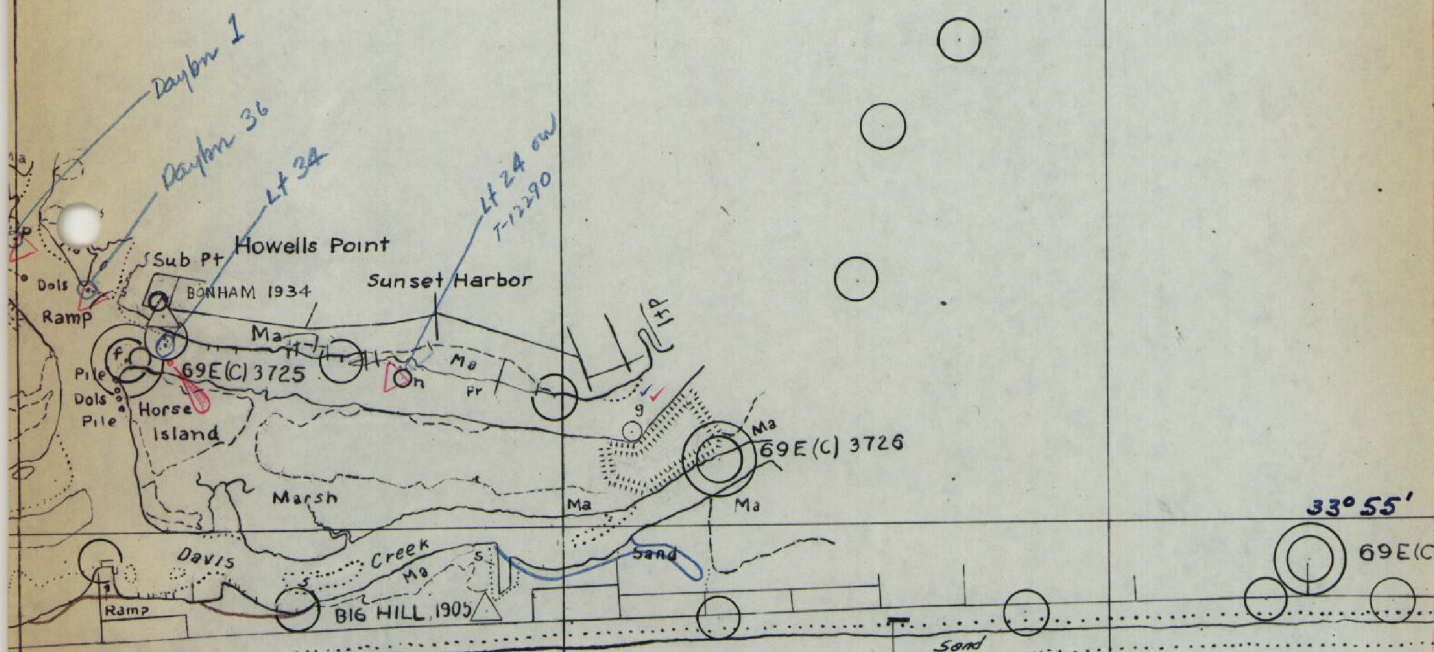

33° 55'

69 E(C)

L O N G

L O N G

B A

13'

12'

78° 11'

T-12290 (2)
 1:20,000