

12293

ORIGINAL

12293

Form 504	
U. S. DEPARTMENT OF COMMERCE	
COAST AND GEODETIC SURVEY	
DESCRIPTIVE REPORT	
Type of Survey Shoreline (Photogrammetric)	
Field No.	Office No. T-12293
LOCALITY	
State	South Carolina
General locality	Long Bay
Locality	Crescent Beach
<del>1963</del> 1965 1962-65	
CHIEF OF PARTY	
J. K. Wilson, Chief of Field Party	
Allen L. Powell, Director, AMC	
LIBRARY & ARCHIVES	
DATE	

USCOMM-OC 5087

## DESCRIPTIVE REPORT - DATA RECORD

T -12293

PROJECT NO. (II):

Job PH-6217

FIELD OFFICE (III):

Myrtle Beach, South Carolina

CHIEF OF PARTY

Joseph K. Wilson

PHOTOGRAMMETRIC OFFICE (III):

Atlantic Marine Center

OFFICER-IN-CHARGE

J. C. Bull, Director, Atlantic  
Marine Center

INSTRUCTIONS DATED (II) (III):

11 September 1963

Field

14 October 1963

Office

10 January 1964

Amendment #1 Office

METHOD OF COMPILATION (III):

Kelsh

MANUSCRIPT SCALE (III):

1:20,000

STEREOSCOPIC PLOTTING INSTRUMENT SCALE (III):

1:6,000 pantographed to 1:20,000

DATE RECEIVED IN WASHINGTON OFFICE (IV):

DATE REPORTED TO NAUTICAL CHART BRANCH (IV):

APPLIED TO CHART NO.

DATE:

DATE REGISTERED (IV):

GEOGRAPHIC DATUM (III):

N.A. 1927

VERTICAL DATUM (III):

~~MEAN SEA LEVEL EXCEPT AS FOLLOWS:~~ MHW

Elevations shown as (25) refer to mean high water

Elevations shown as (5) refer to sounding datum

i.e., mean low water or mean lower low water

REFERENCE STATION (III):

FIRE 1934 ✓

LAT.:

33° 50' 34.914 (1075.7m) ✓

LONG.:

78° 42' 08."379 (215.4m) ✓

☒ ADJUSTED☐ UNADJUSTED

PLANE COORDINATES (IV):

Y = 314,680.56 Ft. ✓

X = 2,697,647.80 Ft. ✓

STATE

South Carolina

ZONE

North ✓

ROMAN NUMERALS INDICATE WHETHER THE ITEM IS TO BE ENTERED BY (II) FIELD PARTY, (III) PHOTOGRAMMETRIC OFFICE,  
OR (IV) WASHINGTON OFFICE.

WHEN ENTERING NAMES OF PERSONNEL ON THIS RECORD GIVE THE SURNAME AND INITIALS, NOT INITIALS ONLY.

## DESCRIPTIVE REPORT - DATA RECORD

FIELD INSPECTION BY (II): Matthew A. Stewart Harvey G. Lucas		DATE: Jan-Mar 1964 Nov-Dec 1963
MEAN HIGH WATER LOCATION (III) (STATE DATE AND METHOD OF LOCATION):  Air Photo Compilation - Date of photographs Aug. 24, 1962 and Feb. 21, 1963		
PROJECTION AND GRIDS RULED BY (IV):  A. E. Roundtree		DATE  Feb. 3, 1965
PROJECTION AND GRIDS CHECKED BY (IV):  R. Glaser		DATE  Feb. 11, 1965
CONTROL PLOTTED BY (III):  H. Cordell		DATE  March 1965
CONTROL CHECKED BY (III):  A. Santillan		DATE March 1965
RADIAL PLOT OR STEREOSCOPIC CONTROL EXTENSION BY (III):  W. Heinbaugh		DATE  Nov. 1964
STEREOSCOPIC INSTRUMENT COMPILATION (III):	PLANIMETRY K. Boyle	DATE March 1965
	CONTOURS Inapplicable	DATE
MANUSCRIPT DELINEATED BY (III):  K. Boyle		DATE March 1965
SCRIBING BY (III):  A. Santillan		DATE Dec. 29, 1965
PHOTOGRAMMETRIC OFFICE REVIEW BY (III):  R. E. Smith		DATE March 1966
REMARKS:  FIELD EDIT 1965		

FORM C&GS-181c  
(12-61)U.S. DEPARTMENT OF COMMERCE  
COAST AND GEODETIC SURVEY

## DESCRIPTIVE REPORT - DATA RECORD

CAMERA (KIND OR SOURCE) (III):

"S" and "W" Cameras

## PHOTOGRAPHS (III)

NUMBER	DATE	TIME	SCALE	STAGE OF TIDE
62 S 850	Aug. 24, 1962	0824	1:30,000	0.3 above MLW
851	"	"	"	"
852	"	0825	"	"
853	"	"	"	"
854	"	"	"	"
855	"	0826	"	"
63 W 3038	Feb. 21, 1963	0955	1:30,000	1.4 above MLW

## Predicted TIDE (III)

	RATIO OF RANGES	MEAN RANGE	SPRING RANGE
REFERENCE STATION: CHARLESTON, SOUTH CAROLINA		5.1	6.0
SUBORDINATE STATION: Little River (town), Little River		5.2	6.1
SUBORDINATE STATION:			
WASHINGTON OFFICE REVIEW BY (IV): <i>Leo F. Beugnot, RMC</i>	DATE: <i>Aug 1966</i>		
PROOF EDIT BY (IV):	DATE:		
NUMBER OF TRIANGULATION STATIONS SEARCHED FOR (III): 14	RECOVERED: 11	IDENTIFIED: 2	
NUMBER OF BM(S) SEARCHED FOR (III): None	RECOVERED:	IDENTIFIED:	

NUMBER OF RECOVERABLE PHOTO STATIONS ESTABLISHED (III):

None

NUMBER OF TEMPORARY PHOTO HYDRO STATIONS ESTABLISHED (III):

None

REMARKS:



T-12293

COMPILATION RECORD

COMPLETION DATE

REMARKS

Alongshore area for hydro	March 1965	Superseded
Manuscript complete	Dec. 1965	

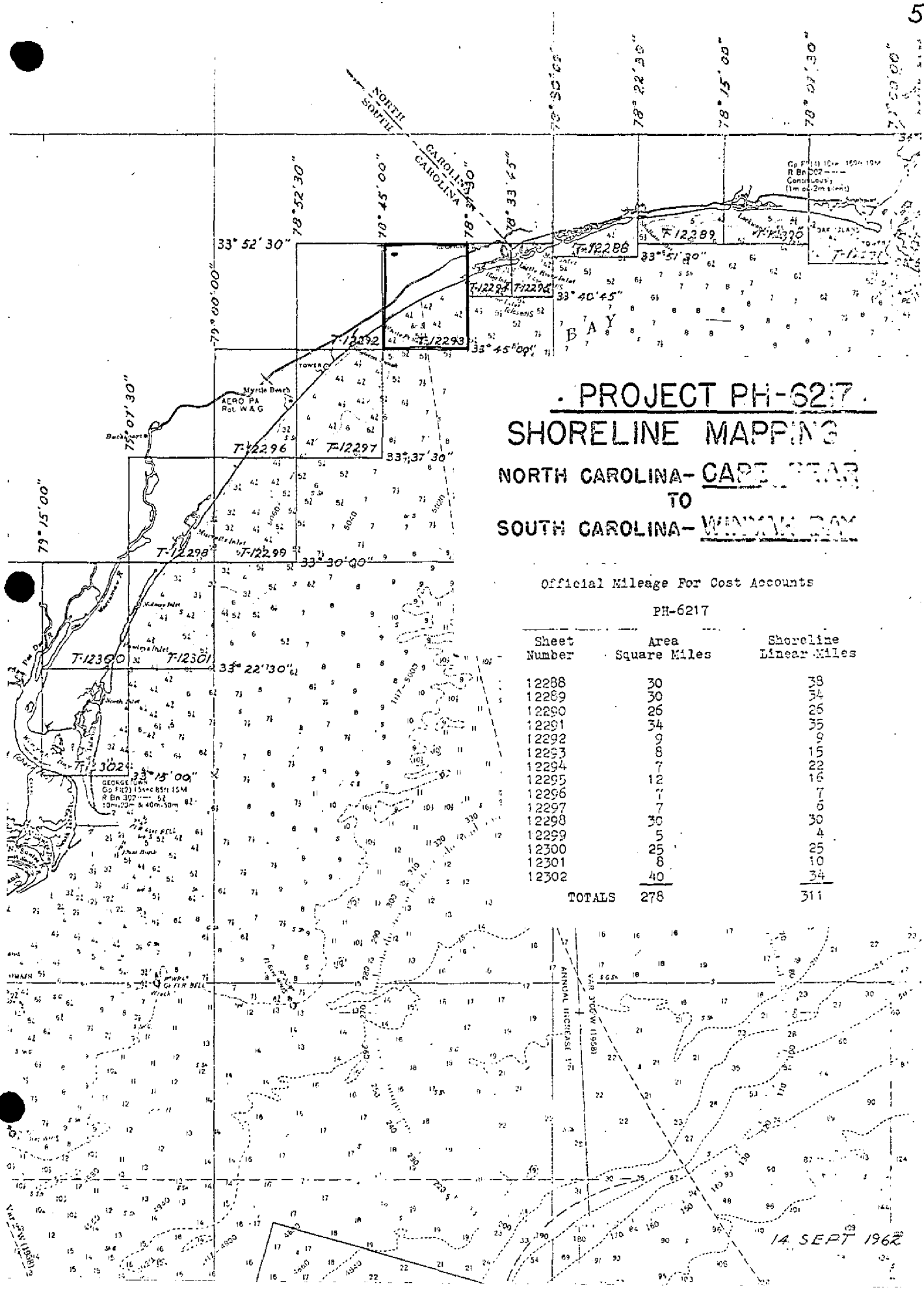

**PROJECT PH-6217**  
**SHORELINE MAPPING**  
**NORTH CAROLINA-CAPE FEAR**  
**TO**  
**SOUTH CAROLINA-WINYAH BAY**

Official Mileage For Cost Accounts

PH-6217

Sheet Number	Area Square Miles	Shoreline Linear Miles
12288	30	38
12289	30	34
12290	26	26
12291	34	35
12292	9	9
12293	8	15
12294	7	22
12295	12	16
12296	7	7
12297	7	6
12298	30	30
12299	5	4
12300	25	25
12301	8	10
12302	40	34
<b>TOTALS</b>	<b>278</b>	<b>311</b>

14 SEPT 1962

6

SUMMARY TO ACCOMPANY  
DESCRIPTIVE REPORT T-12293

Shoreline manuscript T-12293 is one of fifteen similar maps in Project 21059 (PH-6217). The sketch on page 5 of this report shows the location of this map in the project.

The primary purpose of the project is to furnish modern shoreline for nautical chart revision and photogrammetric hydro-support data for hydrographic surveys to be made in the same area.

Field operations preceding compilation, by Kelsh instrument methods, included recovery and identification of horizontal control, field inspection, and identification of landmarks and fixed aids to navigation.

The Kelsh compilation was at 1:20,000 scale using the 1:30,000 scale panchromatic photography obtained in August 1962 and February 1963.

A cronar positive of the map manuscript will be furnished for preparation of the hydrographer's boat sheet along with specially prepared ratio photographs for the location of hydrographic signals by photogrammetric methods.

The compilation manuscript is a vinylite sheet  $7\frac{1}{2}$  minutes in latitude by  $7\frac{1}{2}$  minutes in longitude from which the smooth sheet was drafted and reproduced on cronaflex. One cronar positive and one cronar negative are provided for record and registry.

FIELD INSPECTION REPORT  
Project 21059  
Maps T-12288 thru T-12291  
and T-12293 thru T-12295

This report is submitted for seven maps since there is no great difference in terrain, natural or cultural features which would require special treatment.

## 2. AREAL FIELD INSPECTION

The area lies between the North portion of Myrtle Beach, South Carolina to the Cape Fear River in North Carolina. It includes the Intracoastal Waterway and is bordered on the Southeast by the Atlantic Ocean. The photograph coverage is not complete for each map, therefore in accordance with Instructions from Washington, field inspection has been completed to the limits of the photographs with the exception of a few places where photograph coverage extends beyond the map limits.

The area along the Atlantic Ocean is a summer resort. The portion from Myrtle Beach to the North Carolina line is built up almost solid while the area from the North Carolina line to the Cape Fear River is more sparsely settled.

There are several small villages along and near U. S. Highway 17. Some of the larger are: Crescent Beach, Little River, Shallotte and Southport.

The photographic quality was good for the entire area. Photographic tones were found to be similar to other areas along the South Atlantic Coast. The photographs used were flown in both 1962 and 1963, therefore, causing some areas to photograph slightly different. The field inspector has used the more recent photography where possible.

Photographs used for field inspection are listed below for individual maps:

<u>T-12293</u>	<u>T-12294</u>	<u>T-12295</u>	<u>T-12288</u>	<u>T-12289</u>	<u>T-12290</u>	<u>T-12291</u>
62 S 851A	62 S 849A	62 S 847A	62 S 832A	62 S 831A	62 S 908A	63 W 3027
62 S 1061A	62 S 850A	62 S 846A	62 S 843A	62 S 827A	62 S 909A	63 W 3025
62 S 1062A	63 W 3036	63 W 3034	62 S 845A	62 S 829A	62 S 910A	63 W 3024
62 S 1063A	63 W 3037	63 W 3035	63 W 3029	62 S 841A	62 S 911A	62 S 903A
62 S 1064A	63 W 3038		63 W 3030	63 W 3029	62 S 912A	62 S 904A
62 S 851A			63 W 3031		62 S 913A	62 S 905A
62 S 852A			63 W 3032		62 S 914A	62 S 906A
62 S 853A			63 W 3033		62 S 827A	62 S 907A
62 S 854A						
62 S 855A						

## 3. HORIZONTAL CONTROL

Horizontal control recovery and identification has been completed in accordance with project instructions.

The identification of horizontal control was accomplished on 15 February 1964 and forms 152 and 526 (in duplicate) were forwarded to Washington at that time.

PRICE AZIMUTH MARK, 1962 was moved to a new location by this party. See 1964 description and new G.P.

Horizontal control stations reported "lost", "destroyed", or "not recovered" are listed below by maps:

T-12293

SANDY, 1934  
INTRACOASTAL WATERWAY STA. 730/84.60, 1934  
NIXON, 1923

T-12294

INTRACOASTAL WATERWAY BEACON NO. 46, 1934  
LITTLE RIVER BEACON NO. 8, 1934

T-12295

INTRACOASTAL WATERWAY BEACON NO. 77, 1934  
BIRD, 1962

T-12288

SAUCE, 1934  
TUBBS, 1934  
SYLVIA, 1934  
BALD BEACH, 1962  
INTRACOASTAL WATERWAY BEACON NO. 38, 1934  
INTRACOASTAL WATERWAY BEACON NO. 36, 1934  
INTRACOASTAL WATERWAY BEACON NO. 42, 1934  
INTRACOASTAL WATERWAY BEACON NO. 55, 1934  
INTRACOASTAL WATERWAY BEACON NO. 57, 1934  
INTRACOASTAL WATERWAY BEACON NO. 59, 1934  
INTRACOASTAL WATERWAY BEACON NO. 61, 1934  
INTRACOASTAL WATERWAY BEACON NO. 71, 1934  
INTRACOASTAL WATERWAY BEACON NO. 73, 1934  
INTRACOASTAL WATERWAY BEACON NO. 75, 1934

T-12289

HEWETT, 1934  
LOCKWOOD, 1934  
FISH, 1923  
CHADWICK, 1934  
TAR, 1934  
INTRACOASTAL WATERWAY BEACON NO. 29, 1934  
INTRACOASTAL WATERWAY BEACON NO. 30, 1934

INTRACOASTAL WATERWAY BEACON NO. 32, 1934  
INTRACOASTAL WATERWAY BEACON NO. 34, 1934  
INTRACOASTAL WATERWAY BEACON NO. 35, 1934  
INTRACOASTAL WATERWAY BEACON NO. 45, 1934  
INTRACOASTAL WATERWAY BEACON NO. 51, 1934

T-12290

WATERWAY, 1934  
BIG HILL, 1905  
INTRACOASTAL WATERWAY BEACON NO. 23, 1934

T-12291

A. L. (U.S.E.), 1923  
CORNCAKE, 1962  
FUZZY, 1933  
3 (U.S.E.), 1933  
BRIDGE, 1933  
ROAD, 1933  
OAK, 1933  
R. B., 1923

4. VERTICAL CONTROL

A search was made for all tidal bench marks within the limits of these maps. Form 685A is submitted for each mark.

5. CONTOURS AND DRAINAGE

Contours are inapplicable.

Drainage is almost entirely composed of tidal streams. Normal drainage is generally by direct run-off into marsh or swamp.

6. WOODLAND COVER

Woodland Cover was classified in accordance with the Topographic Manual.

7. SHORELINE AND ALONGSHORE FEATURES

The high-water line has been indicated on the photographs by symbol in accordance with current instructions. No attempt was made to delineate the low-water line. The delineation of the high-water line was accomplished by several methods: Measurements from identifiable points of detail; by visual inspection from skiff; and by walking the shoreline.

All other shoreline features are adequately covered by field inspection notes on the photographs. There have been few developments since photography. Included with the map data for T-12289 is a tracing of a surveyors map of a new development along the Intracoastal Waterway. The field inspector has located several common points of detail photogrammetrically.

The field inspector has delineated the shoreline on the 1963 photographs where possible. The compiler will note, along the Intracoastal Waterway, a mud bank where the 1963 photographs were flown at a lower tide than the 1962 ones.

8. OFFSHORE FEATURES

A letter-size section of the chart is submitted with Map T-12291. Several piling, wrecks, etc. were located by sextant or theodolite cuts.

9. LANDMARKS AND AIDS

A thorough inspection of Nautical Landmarks was made. Form 567 is submitted for each. A few have been shown for deletion and a few new ones are recommended.

All fixed aids to navigation are reported on form 567 for charting. There was only a few changes. A few new daybeacons and one rear range light have been added at the Oak Island Entrance in Map T-12291. The aids were located by several photogrammetric methods, namely: direct method, theodolite cuts from triangulation stations and photo points, and by sextant.

10. BOUNDARIES, MONUMENTS AND LINES

There have been no boundary lines shown.

11. OTHER CONTROL

There were no marked topographic stations established.

12. OTHER INTERIOR FEATURES

All roads were classified in accordance with Photogrammetric Instructions No. 56.

Field Inspection of buildings was done in accordance with Photogrammetric Instructions No. 54, revised September 22, 1961.

There were no bridge or cable clearances measured during this survey.

Marsh and swamp limits have been shown on the photographs where coverage was available.

13. GEOGRAPHIC NAMES

See Special Report of Geographic Names, Project 21059, which was submitted to Washington on 5 February 1964.

14. SPECIAL REPORTS AND SUPPLEMENTAL DATA

Control Identification to Washington 10-16-63.  
Control Identification to Washington 10-24-63.  
Map Data T-12300 thru T-12302 to Tampa 1-17-64.  
Geographic Names Report to Washington 2-10-64.  
Control Identification to Washington 2-13-64.  
Map Data T-12298 to Tampa 2-25-64.  
Map Data T-12292, T-12296, T-12297 and T-12299 to Tampa 3-4-64.

23 April 1964

Submitted by:

*Joseph K. Wilson*  
Joseph K. Wilson  
Chief, Photo Party 6420



MAP T. 12293 PROJECT NO. PH-21059 SCALE OF MAP 1:20,000 SCALE FACTOR

STATION	SOURCE OF INFORMATION (INDEX)	DATUM	LATITUDE OR LONGITUDE OR X-COORDINATE	DISTANCE FROM GRID OR PROJECTION LINE IN METERS FORWARD (BACK)	DATUM CORRECTION	N.A. 1927 - DATUM DISTANCE FROM GRID OR PROJECTION LINE IN METERS FORWARD (BACK)	FACTOR DISTANCE FROM GRID OR PROJECTION LINE IN METERS FORWARD (BACK)
BENCH MARK 34 RESET, 1962	HORIZONTAL CONTROL DATA SC VOL III p. 92		297,354.04 2,684,361.21	✓			
BRYANT, 1932	HORIZONTAL CONTROL DATA SC VOL III p. 88		308,631.11 2,704,524.80	✓			
CHERRY, 1962	HORIZONTAL CONTROL DATA S.C. VOL III p. 87		309,084.41 2,714,182.56	✓			
CRESCENT, 1962	HORIZONTAL CONTROL DATA SC VOL III p. 89		302,230.30 2,691,877.78	✓			
CRESCENT BEACH MUNICIPAL WATER TANK 1962	HORIZONTAL CONTROL DATA S.C. VOL III p. 114		302,386.44 2,697,111.96	✓			
FTRE, 1934	GP II p. 152 PC N p. 198 Desc 203 pp. 72, 171		314,680.56 2,697,647.80	✓			
INTRACASTAL WATER-GP II p. 166			298,793.55	✓			
WAY STA. 730+84.60 PC -N-p. 104 1934			2,684,085.04	✓			
KIT, 1962	HORIZONTAL CONTROL DATA SC VOL III p. 93		295,090.34 2,687,494.02	✓			
NIXON, 1923	GP I p. 55 PC N p. 99 DESC 222 pp. 122		309,416.32 2,715,713.67	✓			
OCEAN DRIVE BEACH MUNICIPAL WATER TANK 1962	HORIZONTAL CONTROL DATA SC VOL III p. 113		307,018.76 2,706,812.72	✓			
PRICE, 1934	HORIZONTAL CONTROL DATA SC VOL III p. 91		298,506.49 2,683,689.30	✓			
PRICE AZIMUTH MARK RESET, 1962	HORIZONTAL CONTROL DATA SC VOL III		297,406.02 2,684,829.66	✓			

SCALE FACTOR:

FACTOR DISTANCE GRID OR PROJECTION LINE IN METERS	RWARD (BACK)
1	1
2	2
3	3
4	4
5	5
6	6
7	7
8	8
9	9
10	10
11	11
12	12
13	13
14	14
15	15
16	16
17	17
18	18
19	19
20	20
21	21
22	22
23	23
24	24
25	25
26	26
27	27
28	28
29	29
30	30
31	31
32	32
33	33
34	34
35	35
36	36
37	37
38	38
39	39
40	40
41	41
42	42
43	43
44	44
45	45
46	46
47	47
48	48
49	49
50	50
51	51
52	52
53	53
54	54
55	55
56	56
57	57
58	58
59	59
60	60
61	61
62	62
63	63
64	64
65	65
66	66
67	67
68	68
69	69
70	70
71	71
72	72
73	73
74	74
75	75
76	76
77	77
78	78
79	79
80	80
81	81
82	82
83	83
84	84
85	85
86	86
87	87
88	88
89	89
90	90
91	91
92	92
93	93
94	94
95	95
96	96
97	97
98	98
99	99
100	100

1 FT. = 3048006 METER

COMPUTED BY:...

DATE:

**CHECKED BY:**

DATE \_\_\_\_\_

L-2388-12

14

# AEROTRIANGULATION REPORT

Project No. 21059

Cape Fear to North Carolina

Winyah Bay to South Carolina

## 21. Area Covered

This report covers aerotriangulation bridging of the Atlantic Coast from Myrtle Beach, South Carolina to Cape Fear, North Carolina (T-Sheets T-12288 thru T-12295 and T-12297).

## 22. Method

Three strips were bridged on the stereoplanigraph and adjusted by IBM 1620 methods. All stations held within National Map Accuracy Standards, with the exceptions of Corncake RM #1, 1962 (Strip #3) and Goat, 1934, SS"A". All tie points were averaged. Plotting coordinates are furnished at 1:10,000 scale.

## 23. Adequacy of Control

Horizontal control provided was adequate in quality and coverage, with the exception of Corncake RM # 1, 1962, which could not be held in strip #3. It is believed that the RM #1 has been disturbed (see Form 526 Recovery Note). Another station should be identified in the area to complete T-Sheet No. T-12291, Goat 1934, SSA could not be clearly identified in strip #1 and was eliminated from the bridge.

## 24. Supplemental Data

None

## 25. Photography

Photography was adequate as to coverage, overlap, and definition.

Submitted by:

*W. Reinbaugh*  
W. Reinbaugh

Approved by:

*John D. Perrow Jr.*  
JOHN D. PERROW, JR.

75  
15

COMPILATION REPORT  
T-12293

PHOTOGRAMMETRIC PLOT REPORT

Submitted with sheet T-12297.

31. DELINEATION

The Kelsh Plotter was used.

Field Inspection was adequate.

32. CONTROL

See Photogrammetric Plot Report.

33. SUPPLEMENTAL DATA

None

34. CONTOURS AND DRAINAGE

Contours are inapplicable.

Drainage was delineated as inspected or from office interpretation.

35. SHORELINE AND ALONGSHORE DETAILS

Shoreline Inspection was adequate. The low water line was delineated from office interpretation.

36. OFFSHORE DETAILS

None

37. LANDMARKS AND AIDS

Appropriate copies of form 567 for Aids to Navigation and Landmarks were forwarded to the Washington Office under date March 10, 1966.

38. CONTROL FOR FUTURE SURVEY

None

39. JUNCTIONS

Junctions are in agreement with T-12292 to the west and T-12294 to the east. The Atlantic Ocean is to the south.

There is no contemporary survey to the north.

40. HORIZONTAL AND VERTICAL ACCURACY.

No statement

46. COMPARISON WITH EXISTING MAPS

Comparison has been made with U.S.G.S. Quadrangle WAMPEE, SOUTH CAROLINA scale 1:24,000 dated 1947.

47. COMPARISON WITH NAUTICAL CHARTS

Comparison has been made with chart No. 1237 scale 1:80,000 revised 11-5-62.

ITEMS TO BE APPLIED TO NAUTICAL CHARTS IMMEDIATELY

None

ITEMS TO BE CARRIED FORWARD

None

*R. J. Pate*  
R. J. Pate  
Cartographic Technician

Approved and forwarded:

*Allen L. Powell*  
Allen L. Powell, RADM, NOAA  
Director, Atlantic Marine Center

GEOGRAPHIC NAMES  
Ph 6217 (Cape Fear, N.C.-Winyah Bay, S.C.)  
T-12293 (Shoreline)

Atlantic Beach  
Cherry Grove Beach  
Cherry Grove Inlet  
Crescent Beach  
Futch Beach  
House Creek  
Ingram Beach  
Little River  
Little River Neck  
Little River Swamp  
Long Bay  
Myrtle Beach Airport  
Nixon Creek  
Nixon Crossroads  
Ocean Drive Beach  
Prices Swamp  
Prices Swamp Run  
Salt Flat Creek  
Wampee  
White Point Swash  
Williams Creek  
Windy Hill Beach

A. J. Wraight  
A. J. Wraight  
Geographic Names

T - 12293

49. NOTES FOR THE HYDROGRAPHER

None.



## PHOTOGRAMMETRIC OFFICE REVIEW

T-10383 T-12293

1. PROJECTION AND GRIDS RES	2. TITLE RES	3. MANUSCRIPT NUMBERS RES	4. MANUSCRIPT SIZE RES
CONTROL STATIONS			
5. HORIZONTAL CONTROL STATIONS OF THIRD-ORDER OR HIGHER ACCURACY RES	6. RECOVERABLE HORIZONTAL STATIONS OF LESS THAN THIRD-ORDER ACCURACY (Topographic stations) XX		7. PHOTO HYDRO STATIONS XX
8. BENCH MARKS XX	9. PLOTTING OF SEXTANT FIXES XX	10. PHOTOGRAMMETRIC PLOT REPORT BRIDGE (WO)	11. DETAIL POINTS KELSH
ALONGSHORE AREAS (Nautical Chart Data)			
12. SHORELINE RES	13. LOW-WATER LINE RES	14. ROCKS, SHOALS, ETC. XX	15. BRIDGES RES
16. AIDS TO NAVIGATION RES	17. LANDMARKS RES	18. OTHER ALONGSHORE PHYSICAL FEATURES RES	19. OTHER ALONGSHORE CULTURAL FEATURES RES
PHYSICAL FEATURES			
20. WATER FEATURES XX	21. NATURAL GROUND COVER RES		22. PLANETABLE CONTOURS XX
23. STEREOSCOPIC INSTRUMENT CONTOURS XX	24. CONTOURS IN GENERAL XX	25. SPOT ELEVATIONS XX	26. OTHER PHYSICAL FEATURES RES
CULTURAL FEATURES			
27. ROADS RES	28. BUILDINGS RES	29. RAILROADS XX	30. OTHER CULTURAL FEATURES RES
BOUNDARIES			
31. BOUNDARY LINES XX		32. PUBLIC LAND LINES XX	
MISCELLANEOUS			
33. GEOGRAPHIC NAMES RES	34. JUNCTIONS RES		35. LEGIBILITY OF THE MANUSCRIPT RES
36. DISCREPANCY OVERLAY XX	37. DESCRIPTIVE REPORT RES	38. FIELD INSPECTION PHOTOGRAPHS RES	39. FORMS RES
40. REVIEWER RES R.E. Smith		SUPERVISOR, REVIEW SECTION OR UNIT ACR Albert C. Rauch, Jr.	
41. REMARKS (See attached sheet)			
FIELD COMPLETION ADDITIONS AND CORRECTIONS TO THE MANUSCRIPT			
42. Additions and corrections furnished by the field completion survey have been applied to the manuscript. The manuscript is now complete except as noted under item 43.			
COMPILER KB H. Doyle		SUPERVISOR ACR Albert C. Rauch, Jr.	
43. REMARKS			

## REVIEW REPORT T-12293

## SHORELINE

August 29, 1966

61. GENERAL STATEMENT

See Summary accompanying Descriptive Report.

62. COMPARISON WITH REGISTERED TOPOGRAPHIC SURVEYS

Comparison was made with Registered Survey T-5244, 1:20,000 scale. Two major changes have occurred along the outer coast, one near the western limits of the manuscript in the area of White Point Swash, the other near the eastern limits in the area of Cherry Grove Inlet. These changes have been shown on the comparison print along with the change which would normally be expected by erosion.

Major changes have taken place in the interior of the map with the addition of roads, buildings on airport and the completion of the Intracoastal waterway.

This survey supersedes the prior survey and should be used for all future nautical chart construction.

63. COMPARISON WITH MAPS OF OTHER AGENCIES

Comparison was made with U.S.G.S. quadrangle - WAMPEE, SOUTH CAROLINA, 1:24,000 scale, edition of 1947.

The same differences in the shoreline, at White Point Swash and Cherry Grove Inlet, that exist with T-5244, also exist with the WAMPEE quadrangle. The interior of the two surveys are in good general agreement with the exception of the addition of roads and buildings which is expected with development of the area.

64. COMPARISON WITH CONTEMPORARY HYDROGRAPHIC SURVEYS

Contemporary hydrographic surveys had not been started, in the area of this manuscript, at the time of final review.

65. COMPARISON WITH NAUTICAL CHARTS

Comparison was made with charts 835-SC, 1:40,000 scale, 3rd edition, March 1966, corrected thru Notice to Mariners No. 11, March 12, 1966 and 1237, 1:80,000 scale, 3rd edition, June 21, 1965, corrected thru Notice to Mariners No. 12, March 19, 1966.

Charts 1237 and 835-SC both show Cherry Grove Pier Obstruction Light, latitude  $33^{\circ}49'45''$ , longitude  $78^{\circ}38'00''$ , as a single light well inshore from the end of the pier. Field inspection indicates that there are two lights and they are on the end of the pier. (See field inspection photograph 63-W-3038).

Both charts also show pier ruins (or piling) at the following positions:

Latitude	Longitude
$33^{\circ}47.5'$	$78^{\circ}43.8'$
$33^{\circ}48.1'$	$78^{\circ}42.6'$
$33^{\circ}48.2'$	$78^{\circ}42.4'$
$33^{\circ}49.1'$	$78^{\circ}40.1'$

Close examination of photographs 62-S-851A thru 62-S-856A failed to disclose any evidence of the ruins. The approximate positions of these features have been shown on the comparison print.

#### 66. ADEQUACY OF RESULTS AND FUTURE SURVEYS

This survey complies with instructions and meets the National Standards of Map Accuracy.

Reviewed by:

*Leo F. Beugnot*  
Leo F. Beugnot  
Cartographer

Approved:

*Allen L. Powell*  
Allen L. Powell, RADM, NOAA  
Director, Atlantic Marine Center

Approved:

*Charles H. Hearn*  
Chief, Photogrammetric Branch

*Jack E. Guth*  
Chief, Photogrammetry Division





*shoreline in blue from Registered  
Survey T-5244*

*33° 49' 00"*

*78° 38' 00"*

*T-12293*

*78° 39' 00"*



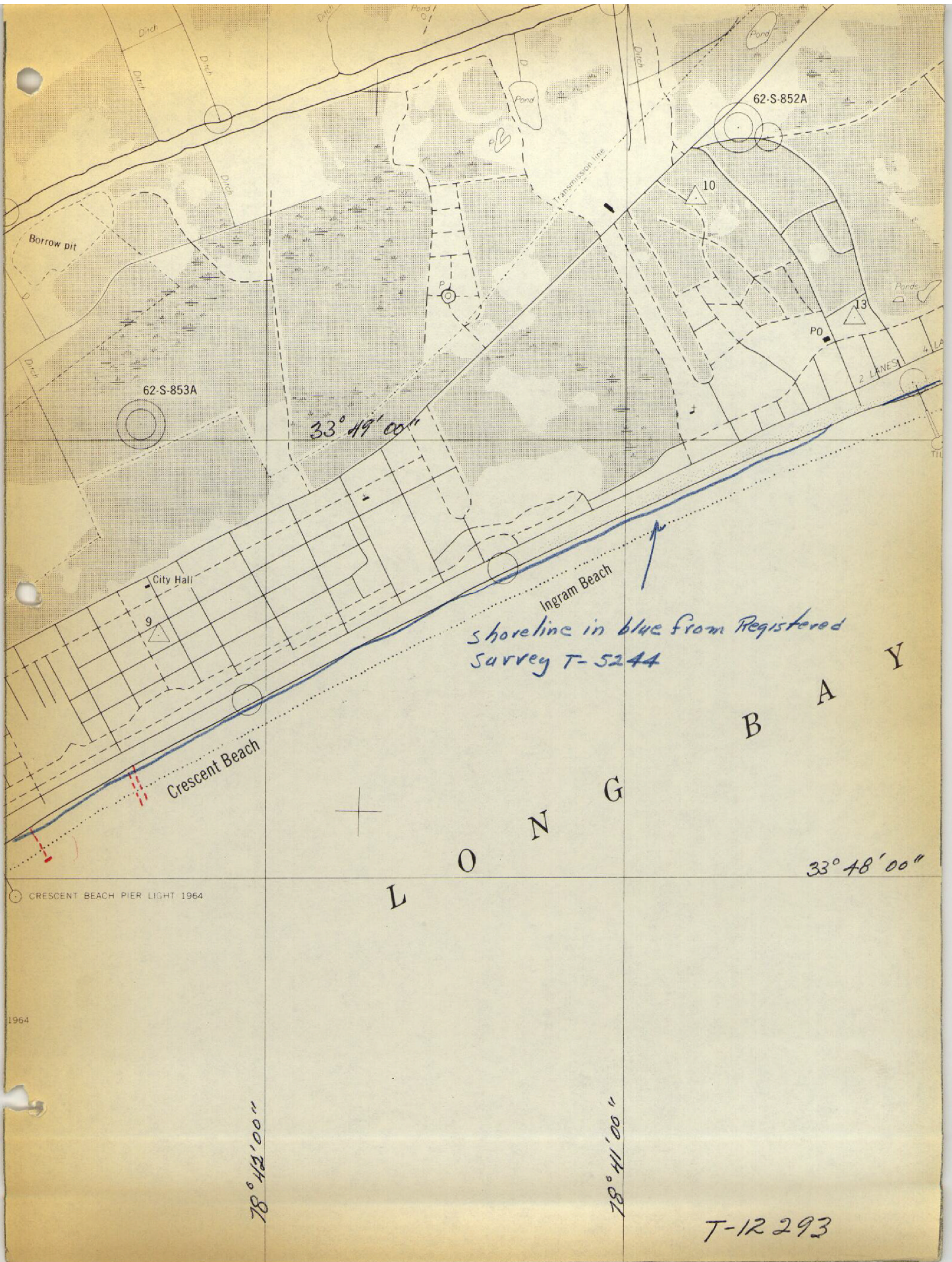



y = 300.000 FT.

48'

47'

y = 290.000 FT.

78°45'00"

78°44'00"

78°43'00"

T-12293

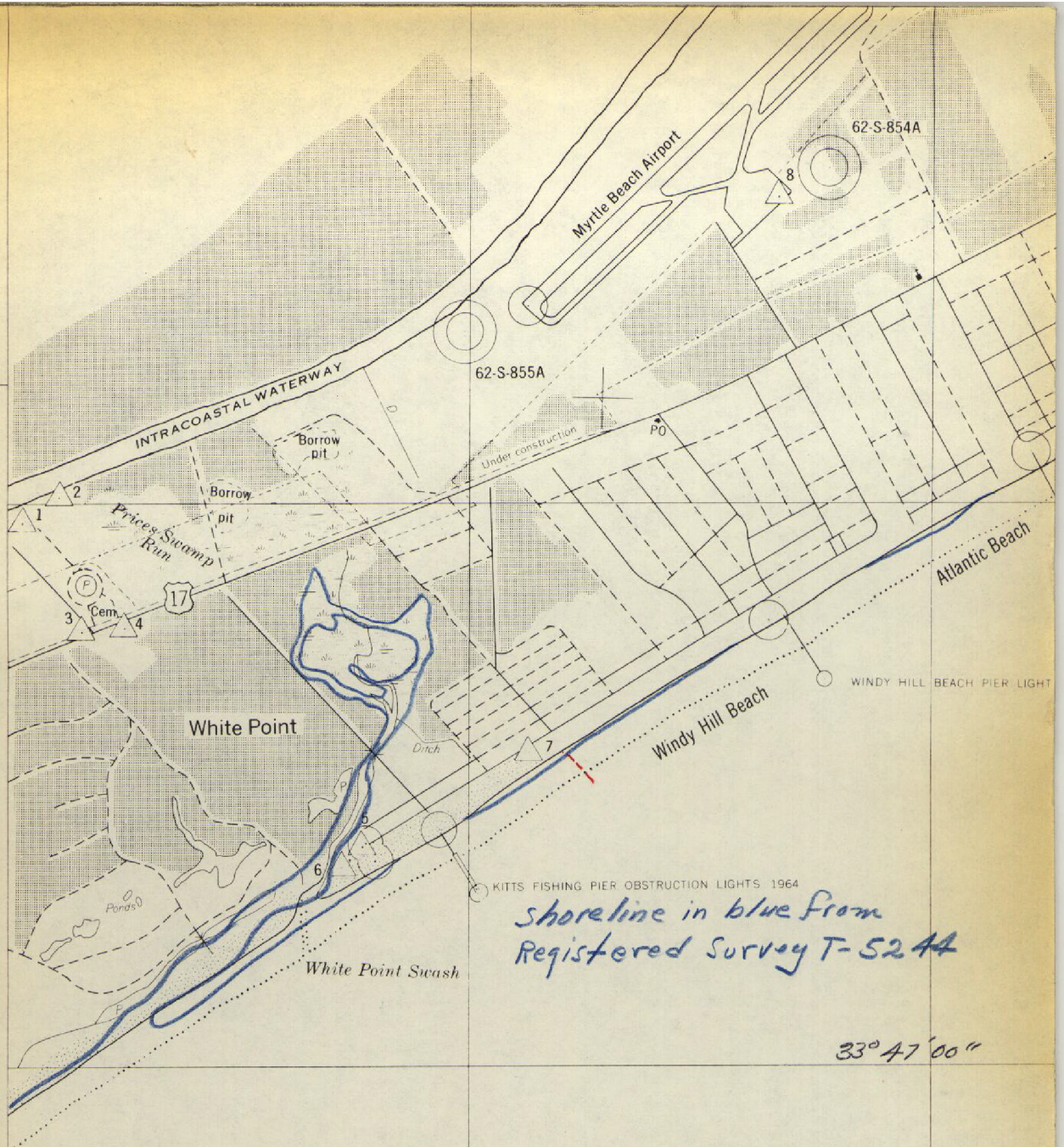

shoreline in blue from  
Registered Survey T-5244

33°47'00"

A



U.S. DEPARTMENT OF COMMERCE  
COAST AND GEODETIC SURVEY

## NONFLOATING AIDS OR LANDMARKS FOR CHARTS

TO BE CHARTED  
~~TO BE REVISED~~  
~~TO BE DELETED~~

STRIKE OUT TWO

Atlantic Marine Center

March 2, 1966

I recommend that the following objects which have *(have not)* been inspected from seaward to determine their value as landmarks be charted on *(deleted from)* the charts indicated.

The positions given have been checked after listing by \_\_\_\_\_

K. Boyle

J. C. Bull, Director, Atlantic Marine Center  
Chief of Party

STATE			SOUTH CAROLINA			Marine Center			INTRACOASTAL			CHARTS AFFECTED		
CHARTING NAME	DESCRIPTION	SIGNAL NAME	POSITION						METHOD OF LOCATION AND SURVEY NO.	DATE OF LOCATION	HARBOR CHART	INSHORE CHART	OFFSHORE CHART	
			LATITUDE *		LONGITUDE *		DATUM							
			°	'	D.M. METERS	°		'	D.M. METERS					
LOOKOUT TOWER	CAPE FEAR - LITTLE RIVER		33°	50	35".76	78°	42	07.65	N.A.	Photo #	Feb. 1964	X	X	1237
	Lookout tower ht. = 114 (174)				1102			236	1924	T-12293		X	X	835
TANK	Cherry Grove Beach Municipal Water Tank ht=132 (153)		33	49	57.7713	78	38	13.891	"	"	"	X	X	1237
	Municipal Water Tank ht=131 (160)				1780			128		"	"	X	X	835
TANK	(GLOSCENT BEACH MUNICIPAL WATER TANK, 1962)		33	48	33.4913	78	42	18.025	"	Triang.	"	X	X	1237
					1031.9			555.3		T-12293	Feb. 1964	X	X	835
TANK	Municipal Water Tank ht = 137 (157) (OCEAN DRIVE BEACH MUNICIPAL WATER TANK, 1962)		33	49	17.070	78	40	21.836	"	"	"	X	X	1237
					525.9			672.7						835
SEE L-5/67														
L-493/66														
* Date taken from field photographs, day of month not given														

This form shall be prepared in accordance with Hydrographic Manual, Publication 20.2, Sec. 6-36, Fig. 79. Positions of charted landmarks and non-floating aids to navigation, if redetermined, shall be reported on this form. Revisions shall show both the old and new positions. The data should be considered for the charts of the area and not by individual field survey sheets. Information under each column heading should be given.

\* TABULATE SECONDS AND METERS

USCOMM-DC 25412-P01



U.S. DEPARTMENT OF COMMERCE  
COAST AND GEODETIC SURVEY

## NONFLOATING AIDS OR LANDMARKS FOR CHARTS

TO BE CHARTED  
TO BE REVISED  
TO BE DELETED

STRIKE OUT TWO

March 2, 1966

Atlantic Marine Center

I recommend that the following objects which have *(have not)* been inspected from seaward to determine their value as landmarks be charted on *(deleted from)* the charts indicated.

The positions given have been checked after listing by \_\_\_\_\_

K. Boyle

J. C. Bull, Director, Atlantic Marine Chief of Party.

STATE SOUTH CAROLINA		DESCRIPTION	SIGNAL NAME	POSITION					METHOD OF LOCATION AND SURVEY NO.	DATE OF LOCATION	HARBOR CHART	INSHORE CHART	OFFSHORE CHART	CHARTS AFFECTED	
CHARTING NAME	LATITUDE*			LONGITUDE*			DATUM								
				° ' "	D.P. METERS	° ' "		D.P. METERS							
		INTRACOASTAL WATERWAY													
		CAPE FEAR - LITTLE RIVER													
DAYBN 19	33° 51'	32° 74'	78° 38'	07° 65'	N.A. 1927 T-12293	Photo 2-28-64								X	835
LIGHT 20	33° 51'	22° 49'	78° 39'	00° 29'	"	"								X	835
		SEACOAST													
LIGHT	33° 47'	18° 57'	78° 43'	58° 66'	N.A. 1927	"	* Feb. 1964								1237
LIGHT	33° 47'	18° 31'	78° 43'	59° 05'	"	"									"
LIGHT	33° 47'	11° 25'	78° 43'	14° 03'	"	"									"
LIGHT	33° 47'	17° 64'	78° 42'	41° 99'	"	"									"
LIGHT	33° 48'	59° 88'	78° 40'	07° 19'	"	"									"
LIGHT	33° 48'	18° 45'	78° 40'	18° 5'	"	"									"
LIGHT	33° 48'	59° 66'	78° 40'	07° 74'	"	"									"
LIGHT	33° 49'	40° 31'	78° 37'	57° 43'	"	"									"

This form shall be prepared in accordance with Hydrographic Manual, Publication 20.2, Sec. 1-55, 2-39, 6-36, 7-18 to 22 inclusive, and Fig. 79. Positions of charted landmarks and nonfloating aids to navigation, if redetermined, shall be reported on this form. Revisions shall show both the old and new positions. The data should be considered for the charts of the area and not by individual field survey sheets. Information under each column heading should be given.

\* TABULATE SECONDS AND METERS

USCOMNAVDC 18234-P81



# NONFLOATING AIDS ORCANDMARKS FOR CHARTS

STRIKE OUT TWO

Atlantic Marine Center  
January 3, 1967

I recommend that the following objects which have *(been)* been inspected from seaward to determine their value as landmarks be charted on *(delisted)* the charts indicated.

The positions given have been checked after listing by

R. E. Smith, Jr.

Director, AEC

U. Bull, Adm.

Chief of Party.

[illegible]

This form shall be prepared in accordance with Hydrographic Manual, Publication 20.2, Sec. 1-55, 2-39, 6-36, 7-18 to 22 inclusive, and Fig. 79. Positions of charted landmarks and *nonfloating aids* to navigation, if redetermined, shall be reported on this form. Revisions shall show both the old and new positions. The data should be considered for the charts of the area and not by individual field survey sheets. Information under each column heading should be given.

### # TABULATE SECONDS AND METERS

