

T-12294 (2)

T-12294 (2)

NOAA FORM 76-35

U.S. DEPARTMENT OF COMMERCE
NATIONAL OCEANIC AND ATMOSPHERIC ADMINISTRATION
NATIONAL OCEAN SURVEY

DESCRIPTIVE REPORT

Type of Survey Shoreline

Job No. PH-7019 Map No. T-12294 (2)

Classification No. Edition No. ...²

Field Edited Map.

LOCALITY

State ... North Carolina - South Carolina

General Locality ... Cape Fear to Murrells Inlet

Locality ... Hog Inlet, SC

 1969 TO 1972

REGISTRY IN ARCHIVES

DATE

MAP NOT INSPECTED IN QUALITY CONTROL PRIOR
TO REGISTRATION

NOAA FORM 76-36A (3-72)		U. S. DEPARTMENT OF COMMERCE NATIONAL OCEANIC AND ATMOSPHERIC ADMIN.		TYPE OF SURVEY		SURVEY <u>TR-T-12294(2)</u>	
DESCRIPTIVE REPORT - DATA RECORD				<input type="checkbox"/> ORIGINAL		MAP EDITION NO. <u>(2)</u>	
				<input checked="" type="checkbox"/> RESURVEY		MAP CLASS <u>Final</u>	
				<input type="checkbox"/> REVISED		JOB <u>PH. 7019</u>	
PHOTOGRAMMETRIC OFFICE				LAST PRECEDING MAP EDITION			
Coastal Mapping Division (Norfolk)				TYPE OF SURVEY		JOB <u>PH. 6217</u>	
OFFICER-IN-CHARGE				<input checked="" type="checkbox"/> ORIGINAL <u>7-12294</u>		MAP CLASS <u>Final</u>	
Jeffrey G. Carlen				<input type="checkbox"/> RESURVEY		SURVEY DATES:	
				<input type="checkbox"/> REVISED		<u>1964</u> TO <u>1965</u>	
I. INSTRUCTIONS DATED							
1. OFFICE				2. FIELD			
Aerotriangulation - Jan. 15, 1971				Aug. 26, 1970			
Compilation - Jan. 21, 1972				Dec. 8, 1970			
Office Supplement I - Jan. 25, 1972							
II. DATUMS							
1. HORIZONTAL: <input checked="" type="checkbox"/> 1927 NORTH AMERICAN				OTHER (Specify)			
2. VERTICAL: <input checked="" type="checkbox"/> MEAN HIGH-WATER <input type="checkbox"/> MEAN LOW-WATER <input checked="" type="checkbox"/> MEAN LOWER LOW-WATER <input type="checkbox"/> MEAN SEA LEVEL				OTHER (Specify)			
3. MAP PROJECTION				4. GRID(S)			
Polyconic				STATE		ZONE	
				South Carolina		North	
5. SCALE				STATE		ZONE	
1:10,000				North Carolina			
III. HISTORY OF OFFICE OPERATIONS							
OPERATIONS				NAME		DATE	
1. AEROTRIANGULATION BY				J.D. Perrow, Jr.		Sept. 1971	
METHOD: <u>Stereoplanigraph</u> LANDMARKS AND AIDS BY							
2. CONTROL AND BRIDGE POINTS PLOTTED BY				D. Phillips		Oct. 5/1971	
METHOD: <u>Coradamat</u> CHECKED BY				D. Phillips		Oct. 5/1971	
3. STEREOSCOPIC INSTRUMENT PLANIMETRY BY				T.J. Bulfer		Feb. 16/1972	
COMPILATION CHECKED BY				L.O. Neterer		Feb. 16/1972	
INSTRUMENT: <u>Wild B-8</u> CONTOURS BY				NA			
SCALE: <u>1:10,000</u> CHECKED BY				NA			
4. MANUSCRIPT DELINEATION PLANIMETRY BY				C.E. Blood			
CHECKED BY				R.J. Pate		Feb. 28/1972	
METHOD: <u>Wild B-8 & Graphic</u> CONTOURS BY				NA			
CHECKED BY				NA			
SCALE: <u>1:10,000</u> HYDRO SUPPORT DATA BY				C.E. Blood		Feb. 18/1972	
CHECKED BY				R.J. Pate		Feb. 28/1972	
5. OFFICE INSPECTION PRIOR TO FIELD EDIT BY				R.J. Pate		Feb. 28/1972	
6. APPLICATION OF FIELD EDIT DATA BY				R.R. White		Aug. 1974	
CHECKED BY				Frank Margiotta		Apr. 1975	
7. COMPILATION SECTION REVIEW BY				Frank Margiotta		Apr. 1975	
8. FINAL REVIEW BY				C.H. Bishop		Feb. 1976	
9. DATA FORWARDED TO PHOTOGRAMMETRIC BRANCH BY				C.H. Bishop		Mar. 1976	
10. DATA EXAMINED IN PHOTOGRAMMETRIC BRANCH BY							
11. MAP REGISTERED - COASTAL SURVEY SECTION BY				K. CATOR		MAY 1976	

NOAA FORM 76-36B
(3-72)U. S. DEPARTMENT OF COMMERCE
NATIONAL OCEANIC AND ATMOSPHERIC ADMINISTRATION
NATIONAL OCEAN SURVEYT-12294 (2)
COMPILATION SOURCES

1. COMPILATION PHOTOGRAPHY

CAMERA(S) Wild RC-8 E & K		TYPES OF PHOTOGRAPHY LEGEND (C) COLOR X (P) PANCHROMATIC (I) INFRARED X		TIME REFERENCE	
TIDE STAGE REFERENCE <input checked="" type="checkbox"/> PREDICTED TIDES <input type="checkbox"/> REFERENCE STATION RECORDS <input checked="" type="checkbox"/> TIDE CONTROLLED PHOTOGRAPHY				ZONE Eastern	<input checked="" type="checkbox"/> STANDARD
				MERIDIAN 75th	<input type="checkbox"/> DAYLIGHT
NUMBER AND TYPE	DATE	TIME	SCALE	STAGE OF TIDE	
69 E(C) 3717 - 3719	4 DEC 1969	09:36	1:20,000	+ 0.8 ft. above MLW	
69 E(C) 3760 & 3761	4 DEC 1969	10:12	1:20,000	+ 1.0 ft. above MLW	
*70 K 5417R - 5420R	8 APR 1970	14:28	1:20,000	± 0.0 ft. of MLW	
				M.R.	M.T.L.

REMARKS Reference Station - Charleston, SC 5.2 2.6
Subordinate Station - Little River, SC(1 mi. above mouth) 5.0 2.5

2. SOURCE OF MEAN HIGH-WATER LINE:

Office interpretation of color photography taken Dec. 4, 1969, except at Hog Inlet and from longitude $78^{\circ} 34.4'$ to $78^{\circ} 35.5'$. In these two areas the mean high water line was clarified on Photos 69 E(C) 3717 and 3718 by the field editor.

3. SOURCE OF MEAN LOW-WATER OR MEAN LOWER LOW-WATER LINE:

*Tide controlled infrared photography of April 8, 1970. Photo centers not mapped.

4. CONTEMPORARY HYDROGRAPHIC SURVEYS (List only those surveys that are sources for photogrammetric survey information.)

SURVEY NUMBER	DATE(S)	SURVEY COPY USED	SURVEY NUMBER	DATE(S)	SURVEY COPY USED

5. FINAL JUNCTIONS

NORTH No Contemp. Survey	EAST T-12295 (2)	SOUTH No Contemp. Survey	WEST T-12293 (2)
-----------------------------	---------------------	-----------------------------	---------------------

REMARKS

NOAA FORM 76-36C
(3-72)

U. S. DEPARTMENT OF COMMERCE
NATIONAL OCEANIC AND ATMOSPHERIC ADMINISTRATION
NATIONAL OCEAN SURVEY

T-12294 (2)

HISTORY OF FIELD OPERATIONS

I. ☒ FIELD INSPECTION OPERATION

☐ FIELD EDIT OPERATION

OPERATION	NAME	DATE
1. CHIEF OF FIELD PARTY	J.K. Wilson	Nov. 1970
2. HORIZONTAL CONTROL	RECOVERED BY	None
	ESTABLISHED BY	None
	PRE-MARKED OR IDENTIFIED BY	None
3. VERTICAL CONTROL	RECOVERED BY	NA
	ESTABLISHED BY	NA
	PRE-MARKED OR IDENTIFIED BY	NA
4. LANDMARKS AND AIDS TO NAVIGATION	RECOVERED (Triangulation Stations) BY	None
	LOCATED (Field Methods) BY	None
	IDENTIFIED BY	None
5. GEOGRAPHIC NAMES INVESTIGATION	TYPE OF INVESTIGATION	
	<input type="checkbox"/> COMPLETE <input type="checkbox"/> SPECIFIC NAMES ONLY <input checked="" type="checkbox"/> NO INVESTIGATION	
6. PHOTO INSPECTION	CLARIFICATION OF DETAILS BY	None
7. BOUNDARIES AND LIMITS	SURVEYED OR IDENTIFIED BY	NA

II. SOURCE DATA

1. HORIZONTAL CONTROL IDENTIFIED

None

2. VERTICAL CONTROL IDENTIFIED

NA

PHOTO NUMBER	STATION NAME	PHOTO NUMBER	STATION DESIGNATION

3. PHOTO NUMBERS (Clarification of details)

4. LANDMARKS AND AIDS TO NAVIGATION IDENTIFIED

None

PHOTO NUMBER	OBJECT NAME	PHOTO NUMBER	OBJECT NAME

5. GEOGRAPHIC NAMES: ☐ REPORT ☒ NONE

6. BOUNDARY AND LIMITS: ☐ REPORT ☒ NONE

7. SUPPLEMENTAL MAPS AND PLANS

None

8. OTHER FIELD RECORDS (Sketch books, etc. DO NOT list data submitted to the Geodesy Division)

None

NOAA FORM 76-36C
(3-72)U. S. DEPARTMENT OF COMMERCE
NATIONAL OCEANIC AND ATMOSPHERIC ADMINISTRATION
NATIONAL OCEAN SURVEYT-12294(2)
HISTORY OF FIELD OPERATIONSI. ☐ FIELD INSPECTION OPERATION☒ FIELD EDIT OPERATION

OPERATION	NAME	DATE
1. CHIEF OF FIELD PARTY	R. E. Kesselring	Aug. 1972
2. HORIZONTAL CONTROL	RECOVERED BY NA ESTABLISHED BY NA PRE-MARKED OR IDENTIFIED BY NA	
3. VERTICAL CONTROL	RECOVERED BY NA ESTABLISHED BY NA PRE-MARKED OR IDENTIFIED BY NA	
4. LANDMARKS AND AIDS TO NAVIGATION	RECOVERED (Triangulation Stations) BY NA LOCATED (Field Methods) BY NA IDENTIFIED BY R. E. Kesselring	Aug. 1972
5. GEOGRAPHIC NAMES INVESTIGATION	TYPE OF INVESTIGATION <input type="checkbox"/> COMPLETE <input type="checkbox"/> SPECIFIC NAMES ONLY BY <input checked="" type="checkbox"/> NO INVESTIGATION	
6. PHOTO INSPECTION	CLARIFICATION OF DETAILS BY R. E. Kesselring	Aug. 1972
7. BOUNDARIES AND LIMITS	SURVEYED OR IDENTIFIED BY NA	

II. SOURCE DATA

1. HORIZONTAL CONTROL IDENTIFIED

NA

2. VERTICAL CONTROL IDENTIFIED

NA

PHOTO NUMBER

STATION NAME

PHOTO NUMBER

STATION DESIGNATION

3. PHOTO NUMBERS (Clarification of details)

69 E(C) 3714, 3718, 3720

4. LANDMARKS AND AIDS TO NAVIGATION IDENTIFIED

PHOTO NUMBER

OBJECT NAME

PHOTO NUMBER

OBJECT NAME

69E(C) 3718

Cherry Grove Inlet Pier
Obstruction Lights

5. GEOGRAPHIC NAMES:

☐ REPORT☒ NONE

6. BOUNDARY AND LIMITS:

☐ REPORT☒ NONE

7. SUPPLEMENTAL MAPS AND PLANS

None

8. OTHER FIELD RECORDS (Sketch books, etc. DO NOT list data submitted to the Geodesy Division)

1 Form 76-40 Nonfloating Aids or Landmarks for Charts

7 Form 76-53 Control Station Identification

5 Sketches (field)

2 Pages Accuracy Test results

1 Field Edit Report

1 Field Edit Ozalid (paper)

NOAA FORM 76-36C
(3-72)

NOAA FORM 76-36D
(3-72)U. S. DEPARTMENT OF COMMERCE
NATIONAL OCEANIC AND ATMOSPHERIC ADMINISTRATIONT-12294(2)
RECORD OF SURVEY USE

I. MANUSCRIPT COPIES

COMPILATION STAGES			DATE MANUSCRIPT FORWARDED	
DATA COMPILED	DATE	REMARKS	MARINE CHARTS	HYDRO SUPPORT
Compilation Complete Pending Field Edit	Feb. 1972	Class III Manuscript Superseded	None	May 16, 1972
Field edit applied Compilation complete	Aug. 1974	Class I Manuscript Superseded	Apr. 7, 1975	
Final Review	Feb. 1976		2-27-76	

II. LANDMARKS AND AIDS TO NAVIGATION

1. REPORTS TO MARINE CHART DIVISION, NAUTICAL DATA BRANCH

NUMBER	CHART LETTER NUMBER ASSIGNED	DATE FORWARDED	REMARKS
1		Apr. 9, 1975	Non-floating Aid for Charting (two pier lights)

2. ☐ REPORT TO MARINE CHART DIVISION, COAST PILOT BRANCH. DATE FORWARDED: Apr. 9, 1975
3. ☐ REPORT TO AERONAUTICAL CHART DIVISION, AERONAUTICAL DATA SECTION. DATE FORWARDED: _____

III. FEDERAL RECORDS CENTER DATA

1. ☒ BRIDGING PHOTOGRAPHS; ☒ DUPLICATE BRIDGING REPORT; ☒ COMPUTER READOUTS.
2. ☒ CONTROL STATION IDENTIFICATION CARDS; ☒ FORM NOS. ~~76-40~~ ⁷⁶⁻⁴⁰ SUBMITTED BY FIELD PARTIES.
3. ☐ SOURCE DATA (except for Geographic Names Report) AS LISTED IN SECTION II, NOAA FORM 76-36C.
ACCOUNT FOR EXCEPTIONS:
4. ☐ DATA TO FEDERAL RECORDS CENTER. DATE FORWARDED: _____

IV. SURVEY EDITIONS (This section shall be completed each time a new map edition is registered)

SECOND EDITION	SURVEY NUMBER TP - _____ (2)	JOB NUMBER PH - _____	TYPE OF SURVEY <input type="checkbox"/> REVISED <input type="checkbox"/> RESURVEY MAP CLASS <input type="checkbox"/> II. <input type="checkbox"/> III. <input type="checkbox"/> IV. <input type="checkbox"/> V. <input type="checkbox"/> FINAL
	DATE OF PHOTOGRAPHY	DATE OF FIELD EDIT	
THIRD EDITION	SURVEY NUMBER TP - _____ (3)	JOB NUMBER PH - _____	TYPE OF SURVEY <input type="checkbox"/> REVISED <input type="checkbox"/> RESURVEY MAP CLASS <input type="checkbox"/> II. <input type="checkbox"/> III. <input type="checkbox"/> IV. <input type="checkbox"/> V. <input type="checkbox"/> FINAL
	DATE OF PHOTOGRAPHY	DATE OF FIELD EDIT	
FOURTH EDITION	SURVEY NUMBER TP - _____ (4)	JOB NUMBER PH - _____	TYPE OF SURVEY <input type="checkbox"/> REVISED <input type="checkbox"/> RESURVEY MAP CLASS <input type="checkbox"/> II. <input type="checkbox"/> III. <input type="checkbox"/> IV. <input type="checkbox"/> V. <input type="checkbox"/> FINAL
	DATE OF PHOTOGRAPHY	DATE OF FIELD EDIT	

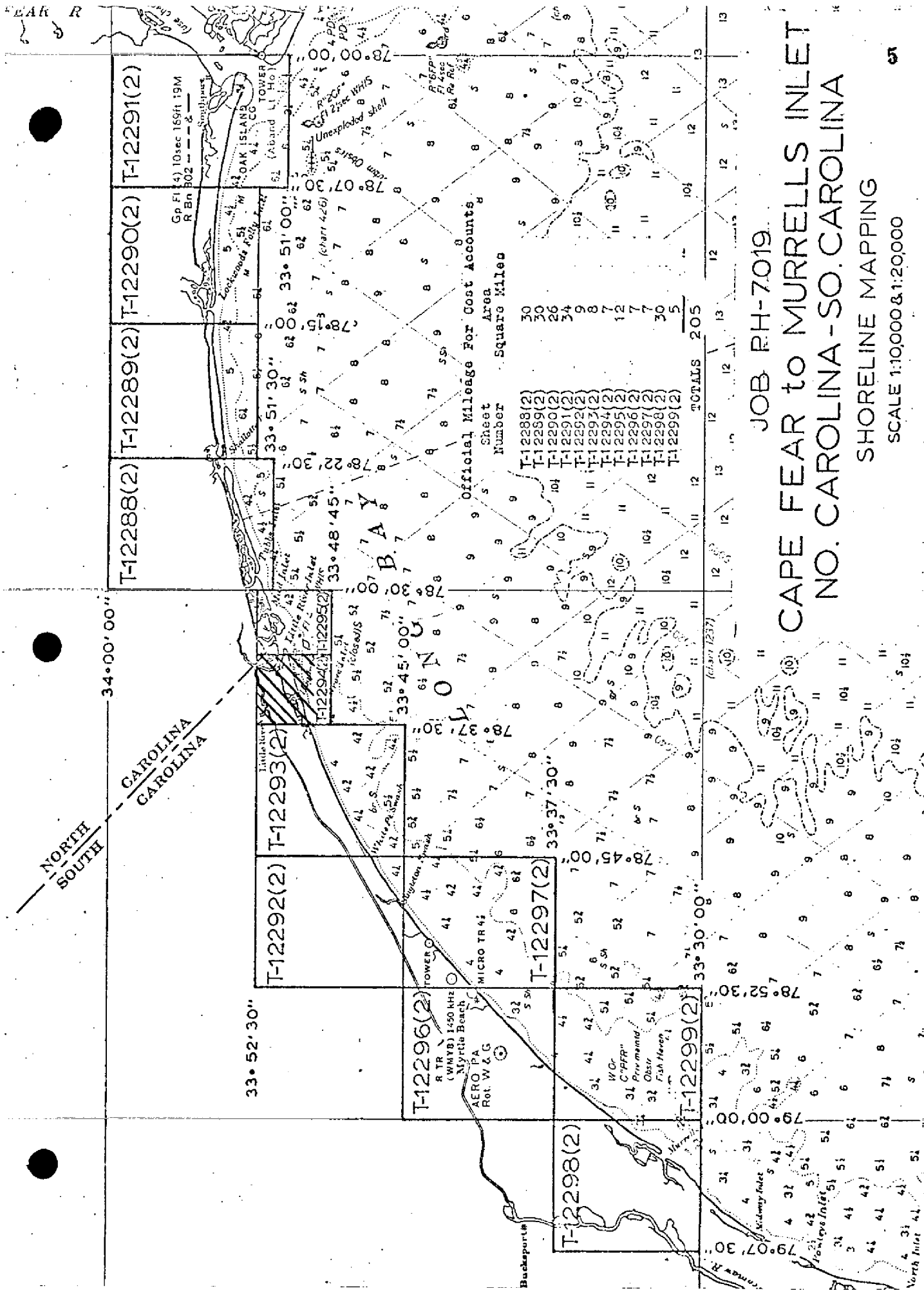

JOB RH-7019

CAPE FEAR to MURRELLS INLET
NO. CAROLINA-SO. CAROLINA

SHORELINE MAPPING

SCALE 1:100,000 & 1:200,000

SUMMARY TO ACCOMPANY

DESCRIPTIVE REPORTS T-12288 (2) through T-12299 (2)

Project PH-7019 is one of several projects that comprise the Seaward Coastal Plains Expedition (SCOPE). It is a resurvey most of Project PH-6217 and consists of ten 1:20,000 scale and two 1:10,000 scale shoreline manuscripts. The project extends from Cape Fear, NC to Murrells Inlet, SC. Only the Atlantic Ocean shoreline and shoreline adjacent to inlets was mapped.

The only field work prior to compilation was the identification and premarking of horizontal control required for bridging.

Bridging was done in the Rockville Science Center in Sept., 1971, using the stereoplanigraph with 1:40,000 scale photography taken in December, 1970. The Bald Head Island area was bridged as part of Project CM-7219 in 1973, using 1:40,000 scale color photography taken in October, 1972.

Compilation was done at the Atlantic Marine Center in February and March, 1972.

Field edit was done as follows:

<u>Map</u>	<u>Field Edit Performed by:</u>		<u>Date</u>
	<u>Experienced</u> Photogrammetrist	<u>Trainee</u>	
T-12288 (2)	x		Feb., 1975
T-12289 (2)		x	Feb., 1973
T-12290 (2)		x	Jan., 1973
T-12291 (2)		x	Jan., 1973
T-12292 (2)	x		June, 1974
T-12293 (2)	x		June, 1974

<u>Map</u>	<u>Field Edit Performed by:</u>		<u>Date</u>
	Experienced	Trainee	
	Photogrammetrist		
T-12294 (2)	x		Aug., 1972
T-12295 (2)	x		Aug., 1972
T-12296 (2)	x		May, 1974
T-12297 (2)	x		June, 1974
T-12298 (2)	x		May, 1974
T-12299 (2)	x		May, 1974

The original manuscripts were stabilene sheets. The 1:20,000 scale maps are $7\frac{1}{2}$ minutes in latitude by $7\frac{1}{2}$ minutes in longitude, except T-12288 (2) which is $8\frac{1}{2}$ minutes in latitude by $7\frac{1}{2}$ minutes in longitude, and T-12291 (2) which is 9 minutes in latitude by $7\frac{1}{2}$ minutes in longitude. The 1:10,000 scale maps, T-12294 (2), and T-12295 (2), are each $3\frac{3}{4}$ minutes in latitude by $3\frac{3}{4}$ minutes in longitude.

A cronaflex positive copy and a negative of each final reviewed map were forwarded for record and registry.

PHOTOGRAMMETRIC PLOT REPORT
Job PH-7019
Cape Fear to Murrells Inlet
North Carolina and South Carolina

Sept. 1971

21. Area Covered

This project covers the shoreline from Cape Fear, North Carolina, to just south of Murrells Inlet, South Carolina. Included are 12 T-sheets (T-12288(2) thru T-12299(2)). All sheets are 1:20,000 scale with the exceptions of T-12294(2) and T-12295(2) which are 1:10,000 scale.

22. Method

Five strips of photography were bridged on the Zeiss Stereoplanigraph C-8 in order to obtain pass point positions and exact scale ratios (for Strips #5 thru #13) to be used during compilation. All bridging was performed using color positives rather than glass plates.

Strip #1 (70-E(C)-8716 thru 8725) was adjusted on four triangulation stations with tie points as checks. Strip #2 (70-E(C)-8731 thru 8742) was adjusted on four triangulation stations with companion points, ties with Strips #1 and #3, and one other station as checks. Strip #3 (70-E(C)-8647 thru 8664) was adjusted on nine triangulation points with companion points, ties with Strip #2, and three additional triangulation stations as checks. Strip #5 (69-E(C)-3754 thru 3761) and Strip #6 (69-E(C)-3715 thru 3720) were both adjusted to tie points from Strip #2. Both strips were adjusted on four tie points with additional ties between the two strips as checks. All tie points between strips were averaged. All adjustments were performed on the IBM 1620. All sheets were ruled and plotted on the Coradomat.

23. Adequacy of Control

Horizontal control complied with project instructions; however, it was not adequate in the area of junction of Strips 2 and 3. Vaught RM6, 1962, due to its placement, was visible, in stereo, only on Strip #3. Office identified control provided a substitute in this area.

Although all control held within National Map Accuracy the adjustments of these strips are very weak. No attempt should be made in the future to produce 1:10,000 scale sheets from

- 2 -

the material provided for the 1:20,000 scale sheets. The two short bridges (5 and 6), which were bridged on points from 1:40,000 scale photography, seem to be adequate for the 1:10,000 scale delineation but are only as good as the bridging for the 1:20,000 scale sheets.

All strips in this project were photogrammetrically weak due to the large water areas in the models.

24. Supplemental Data

Vertical control used for bridging only was obtained from local USGS quads.

25. Photography

Photography was adequate as to overlap and definition. Coverage was adequate with the exception of a small land area in the lower right hand edge of T-12291(2).

Respectfully submitted:

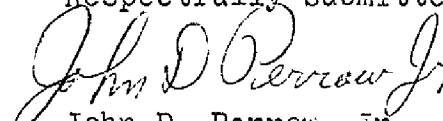
John D. Perrow, Jr.

Approved and Forwarded:

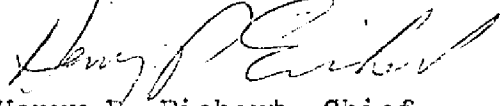
Henry P. Eichert, Chief
Aerotriangulation Section

JOB H-7019
CAPE FEAR & MURRELLS INLET
NO. CAROLINA--SO. CAROLINA

PART I

Sept 71

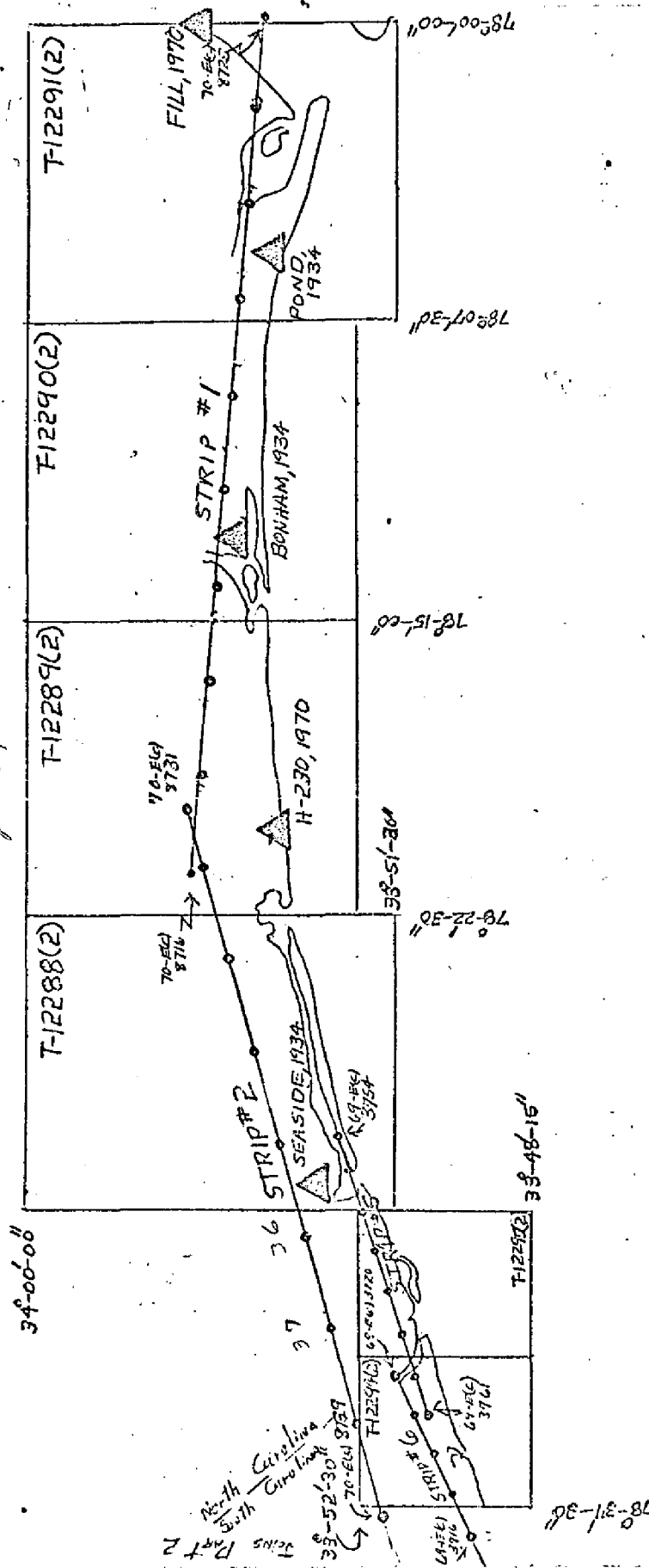

U.S. PART 1

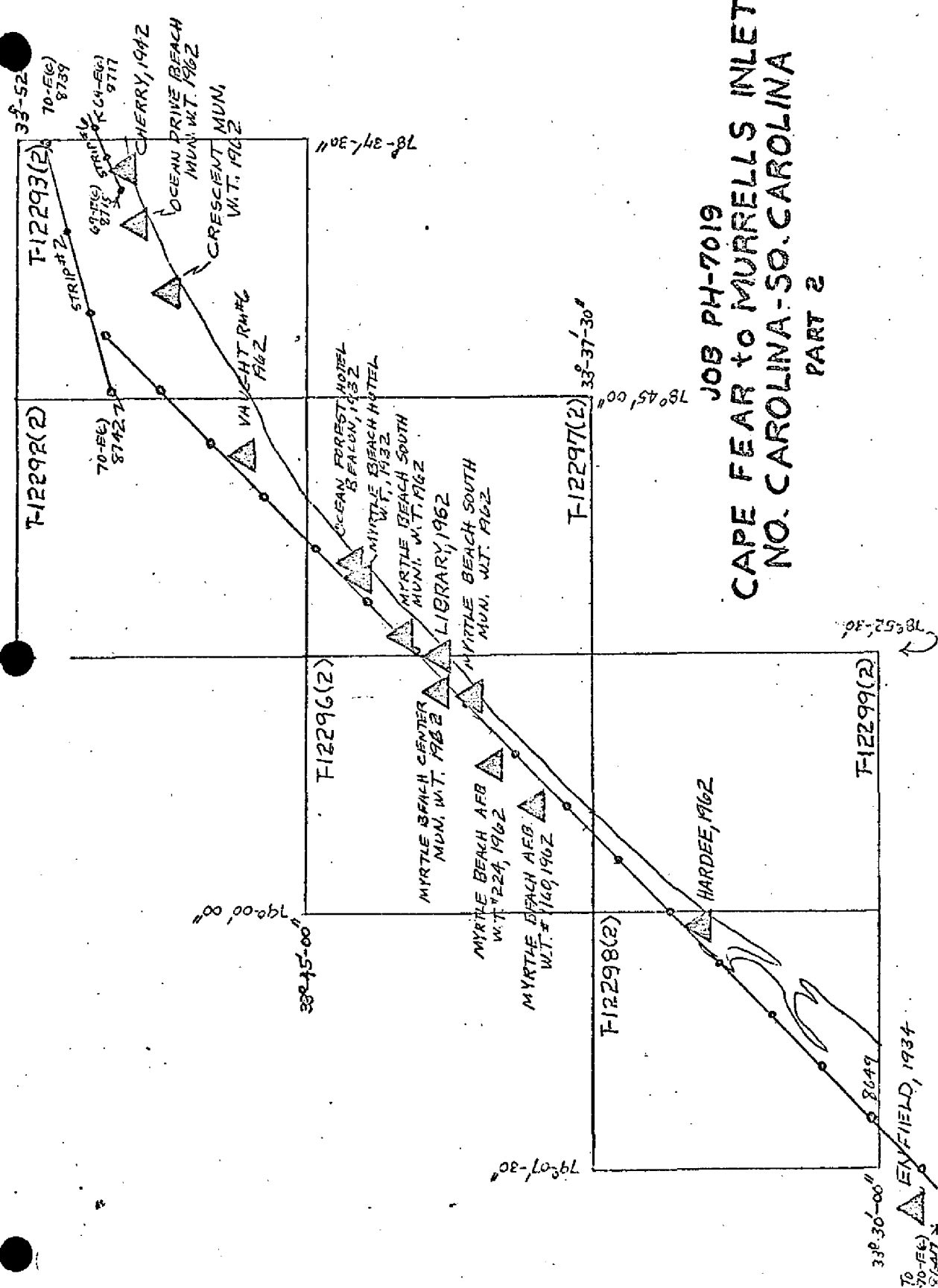

COMPILATION REPORT

T-12294(2) PH-7019

31. DELINEATION

All detail with the exception of the mean low water line was compiled on the Wild B-8 stereoplotter using 1:20,000 scale color diapositives taken on Dec. 4, 1969. The mean low water line was delineated graphically from tide controlled infrared photography taken at mean low water on April 8, 1970. Photo coverage was adequate. 1:20,000 scale color ratios were processed for hydro support.

There was no field inspection prior to compilation.

32. CONTROL

See "Photogrammetric Plot Report", dated Sept., 1971.

33. SUPPLEMENTAL DATA

None

34. CONTOURS AND DRAINAGE

Contours are inapplicable.

Drainage was shown from office interpretation of the tide controlled infrared photographs.

35. SHORELINE AND ALONGSHORE DETAILS

The mean high water line, low water line and foreshore areas were delineated from office interpretation of the photographs.

36. OFFSHORE DETAILS

None

37. LANDMARKS AND AIDS

One Form 76-40 for Nonfloating Aids for Charting, was forwarded to the Rockville Office on April 7, 1975.

38. CONTROL FOR FUTURE SURVEYS

None

39. JUNCTIONS

See Form 76-36b, Item #5.

40. HORIZONTAL AND VERTICAL ACCURACY

No Statement

41. - 45. Not Used.

46. COMPARISON WITH EXISTING MAPS

A comparison was made with AMS Quadrangle LITTLE RIVER, SC, NC, scale 1:24,000, dated 1947 and with Shoreline Manuscript T-12294 of which this manuscript is a revision.

Significant changes were noted in "Hog Inlet" and "Cherry Grove Beach" areas. There was also noted a slight shift in road positions when the projection lines are matched.

47. COMPARISON WITH NAUTICAL CHARTS

Comparison was made with Chart 835-SC, 8th edition, dated January 23, 1971, scale 1:40,000 and with Chart 1237, scale 1:80,000 4th edition, dated Sept. 16, 1968.

ITEMS TO BE APPLIED TO NAUTICAL CHARTS IMMEDIATELY

None

ITEMS TO BE CARRIED FORWARD

None

Submitted:

C.E. Blood

C.E. Blood, Carto. Tech., Feb. 24, 1972

Approved:

Albert C. Rauck, Jr.

Albert C. Rauck, Jr.

Chief, Coastal Mapping Section, AMC

ADDENDUM TO THE COMPILATION REPORT

T-12294 (2)

FIELD EDIT

On the east side of Hog Inlet, the distance given by the field editor from a wreck to the MHWL is not compatible with the identification of the MHWL on Field Photo 69 E(C) 6917. The photo identification was used for compilation.

All other field edit of this map is satisfactory.

*Charles H. Bishop**Final reviewer**2 - 19 - 76*

29 Sept. 1975

GEOGRAPHIC NAMES

FINAL NAME SHEET

PH-7019 (Cape Fear to Murrells Inlet, N.C.)

T-12294 (2)

Atlantic Ocean

Cherry Grove Beach

Hog Inlet

Hog Island

House Creek

Long Bay

Waties Island

Approved by

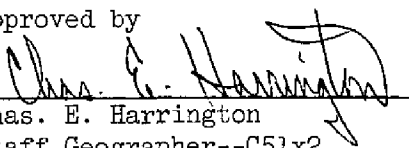
Chas. E. Harrington
Staff Geographer--C51x2

NOAA FORM 75-74
(2-74)U.S. DEPARTMENT OF COMMERCE
NOAA
NATIONAL OCEAN SURVEY

PHOTOGRAMMETRIC OFFICE REVIEW

T-12294 (2)

1. PROJECTION AND GRIDS RJP	2. TITLE RJP	3. MANUSCRIPT NUMBERS RJP	4. MANUSCRIPT SIZE RJP
CONTROL STATIONS			
5. HORIZONTAL CONTROL STATIONS OF THIRD-ORDER OR HIGHER ACCURACY RJP	6. RECOVERABLE HORIZONTAL STATIONS OF LESS THAN THIRD-ORDER ACCURACY (Topographic stations) X X		7. PHOTO HYDRO STATIONS X X
8. BENCH MARKS X X	9. PLOTTING OF SEXTANT FIXES X X	10. PHOTOGRAMMETRIC PLOT REPORT RJP	11. DETAIL POINTS RJP
ALONGSHORE AREAS (Nautical Chart Data)			
12. SHORELINE RJP	13. LOW-WATER LINE RJP	14. ROCKS, SHOALS, ETC. X X	15. BRIDGES X X
16. AIDS TO NAVIGATION RJP	17. LANDMARKS X X	18. OTHER ALONGSHORE PHYSICAL FEATURES RJP	19. OTHER ALONGSHORE CULTURAL FEATURES RJP
PHYSICAL FEATURES			
20. WATER FEATURES RJP	21. NATURAL GROUND COVER RJP		22. PLANETABLE CONTOURS NA
23. STEREOSCOPIC INSTRUMENT CONTOURS NA	24. CONTOURS IN GENERAL NA	25. SPOT ELEVATIONS NA	26. OTHER PHYSICAL FEATURES RJP
CULTURAL FEATURES			
27. ROADS RJP	28. BUILDINGS RJP	29. RAILROADS X X	30. OTHER CULTURAL FEATURES X X
BOUNDARIES			
31. BOUNDARY LINES NA		32. PUBLIC LAND LINES NA	
MISCELLANEOUS			
33. GEOGRAPHIC NAMES RJP		34. JUNCTIONS RJP	35. LEGIBILITY OF THE MANUSCRIPT RJP
36. DISCREPANCY OVERLAY RJP	37. DESCRIPTIVE REPORT RJP	38. FIELD INSPECTION PHOTOGRAPHS X X	39. FORMS X X
40. REVIEWER <i>Charles Bishop</i> Compilation by R.J. Pate Feb. 28, 1972		SUPERVISOR, REVIEW SECTION OR UNIT <i>Albert C. Rausch Jr.</i>	
41. REMARKS (See attached sheet)			
FIELD COMPLETION ADDITIONS AND CORRECTIONS TO THE MANUSCRIPT			
42. Additions and corrections furnished by the field completion survey have been applied to the manuscript. The manuscript is now complete except as noted under item 43.			
COMPILER <i>R.R. White</i> Aug. 1974		SUPERVISOR <i>Albert C. Rausch Jr.</i>	
Reviewer: F. Margiotta Apr. 1975			
43. REMARKS <i>Field Edit</i> Field Edit applied from: Field edit ozalid T-12294 (2) and photos 69 E(C) 3717, 3718 and 3720 - 1 Form 76-40.			

FIELD EDIT REPORT
CAPE FEAR, N.C. TO MURRELLS INLET, S.C.
JOB PH-7019
MAP T-12294 (2)

52. Adequacy of Compilation

Compilation was adequate. No major shoreline changes were noted, except at the southwest tip of Hog Island where an entire point was deleted. Numerous piers, bulkheads and "grass in water" areas were overlooked. These were indicated on the field edit ozalid and cross-referenced to the appropriate photograph. The "pipeline" at the northeast end of Cherry Grove Beach is, in reality, a wooden groin in ruins. Another wooden groin to the east of this one was not delineated. It was indicated on the field edit ozalid and cross-referenced to photo 69 E 3717. A new bridge has been constructed at lat $33^{\circ} 50.9$, long $78^{\circ} 37.0$. It is a fixed bridge and is to be mapped by extending the centerline of the existing street. A wreck was located in Hog Inlet as were several new piers and bulkheads. These are indicated on the field edit ozalid and the methods of location attached to this report.

53. Map Accuracy

A short accuracy test was requested for this map. Street intersections along Ocean Blvd. were selected as the only well-defined points available. No error between scaled positions and traverse positions was found to exceed the standards of National Map Accuracy. See the attached list for these comparisons.

54. Recommendations

There are no recommendations.

55. Examination of Proof Copy

Geographic Names

No investigation of geographic names was requested or made.

56. Landmarks and Non-Floating Aids for Navigation

There are no landmarks within the limits of this sheet. Two fixed aids for navigation, Cherry Grove Inlet Pier Obstruction Lights, were identified photogrammetrically, entered on form 76-40 and enclosed with this report.

57. Rocks, Reefs, and Shoals

There are no rocks, reefs, or shoals, as defined, within the limits of this map.

58. Photography

Photography consisted of 1:10,000 ratio color photographs and was excellent.

59. Disposition of Data

The field edit ozalid, field prints containing field edit information and all pertinent field edit data were forwarded to the Director, Atlantic Marine Center.

Richard E. Kesselring
Surveying Technician
Photo Party 62

ACCURACY TEST
SHEET T-12294 (2)
CAPE FEAR, N.C. TO MURRELLS INLET, S.C.
JOB PH-7019

POINT

Int. of Ocean Blvd. & 45th Ave.	SCALED COMPUTED	2,721,510.00 ✓ 2,721,522.43 ✓ 12.43 ✓	311,982.00 ✓ 311,972.53 ✓ 9.47 ✓
		E = 15.63	
Int. of Ocean Blvd. & 46th Ave.	SCALED COMPUTED	2,721,847.00 ✓ 2,721,845.49 ✓ 1.51 ✓	312,100.00 ✓ 312,101.51 ✓ 1.51 ✓
		E = 2.14	
Int. of Ocean Blvd. & 47th Ave.	SCALED COMPUTED	2,722,175.000 ✓ 2,722,171.034 ✓ 3.966 ✓	312,236.00 ✓ 312,232.37 ✓ 3.63 ✓
		E = 5.38	
Int. of Ocean Blvd. & 48th Ave.	SCALED COMPUTED	2,722,506.00 ✓ 2,722,496.37 ✓ 9.63 ✓	312,367.00 ✓ 312,363.16 ✓ 3.84 ✓
		E = 10.37	
Int. of Ocean Blvd. & 49th Ave.	SCALED COMPUTED	2,722,815.00 ✓ 2,722,824.92 ✓ 9.92 ✓	312,499.00 ✓ 312,495.24 ✓ 3.76 ✓
		E = 10.61	
Int. of Ocean Blvd. & 50th Ave.	SCALED COMPUTED	2,723,150.00 ✓ 2,723,139.39 ✓ 10.61 ✓	312,627.00 ✓ 312,622.55 ✓ 4.45 ✓
		E = 11.51	
Int. of Ocean Blvd. & 51st Ave.	SCALED COMPUTED	2,723,471.00 ✓ 2,723,462.60 ✓ 8.40 ✓	312,750.00 ✓ 312,746.13 ✓ 3.87 ✓
		E = 9.25	
Int. of Ocean Blvd. & 52nd Ave.	SCALED COMPUTED	2,723,802.00 ✓ 2,723,792.08 ✓ 9.92 ✓	312,875.00 ✓ 312,872.76 ✓ 2.24 ✓
		E = 10.17	
Int. of Ocean Blvd. & 53rd Ave.	SCALED COMPUTED	2,724,128.00 ✓ 2,724,116.83 ✓ 11.17 ✓	313,000.00 ✓ 312,997.58 ✓ 2.42 ✓
		E = 11.43	
Int. of Ocean Blvd. & 54th Ave.	SCALED COMPUTED	2,724,458.00 ✓ 2,724,443.08 ✓ 14.92 ✓	313,125.00 ✓ 313,122.96 ✓ 2.04 ✓
		E = 15.06	

		x	y
Int. of Ocean	SCALED	2,724,775.00 ✓	313,246.00 ✓
Blvd. & 55th Ave.	COMPUTED	<u>2,724,773.92 ✓</u>	<u>313,250.12 ✓</u>
		1.08	4.12
		E = 4.26	
Int. of Ocean	SCALED	2,725,106.00 ✓	313,377.00 ✓
Blvd. & 56th Ave.	COMPUTED	<u>2,725,097.74 ✓</u>	<u>313,374.57 ✓</u>
		8.26	2.43
		E = 8.61	
Int. of Ocean	SCALED	2,725,427.00 ✓	313,499.00 ✓
Blvd. & 57th Ave.	COMPUTED	<u>2,725,427.65 ✓</u>	<u>313,501.37 ✓</u>
		.65	2.37
		E = 2.46	
Int. of Ocean	SCALED	2,725,760.00 ✓	313,630.00 ✓
Blvd. & 58th Ave.	COMPUTED	<u>2,725,752.36 ✓</u>	<u>313,626.16 ✓</u>
		7.64	3.84
		E = 8.55	
Int. of Ocean	SCALED	2,726,087.00 ✓	313,749.00 ✓
Blvd. & 59th Ave	COMPUTED	<u>2,726,080.65 ✓</u>	<u>313,745.77 ✓</u>
		6.35	3.23
		E = 7.12	

[illegible]

REVIEW REPORT T-12294(2)

SHORELINE

February 4, 1976

61. GENERAL STATEMENT:

This map is a resurvey of Survey T-12294. See Summary, which is page 6 of this Descriptive Report.

A comparison print, showing differences noted in Par. 62, 63, and 65, is bound with the original of this report.

62. COMPARISON WITH REGISTERED TOPOGRAPHIC SURVEYS:

A comparison was made with Survey T-12294, 1:10,000 scale, dated 1965. Several new canals have been added west of Hog Inlet. Land development is still in progress. Significant differences are shown on the comparison print in blue.

63. COMPARISON WITH MAPS OF OTHER AGENCIES:

A comparison was made with AMS Quadrangle LITTLE RIVER, SC, NC, 1:24,000 scale, dated 1947. Significant differences are shown in brown on the comparison print.

In the area compared, T-12294 (2) supersedes T-12294 for nautical chart construction purposes. T-12294 is the latest registered prior survey of the area.

64. COMPARISON WITH CONTEMPORARY HYDROGRAPHIC SURVEYS:

A comparison was made with a copy of the verified smooth sheet for Survey H-9229 (WH-20-1-71). No significant differences were noted.

65. COMPARISON WITH NAUTICAL CHARTS:

A comparison was made with Chart 11534, 1:40,000 scale, 12th edition, dated March, 1975. Significant differences are shown on the comparison print in red.

66. ADEQUACY OF RESULTS AND FUTURE SURVEYS:

An accuracy test was run in the vicinity of Cherry Grove Beach. The results follow the Field Edit Report which is part of this Descriptive Report.

This map complies with Project Instructions and meets the requirements for Bureau Standards and the National Standards of Map Accuracy.

Reviewed by:

Charles H. Bishop
Charles H. Bishop
Cartographer
February 4, 1976

Approved for forwarding:

Albert C. Rauck, Jr.
Albert C. Rauck, Jr.
Acting Chief, Photogrammetric Branch, AMC

Approved:

Chief, Photogrammetric Branch

Chief, Coastal Mapping Division

33°
51'

Y = 35,000 ft. N.C. —

Y=315,000ft. S.C.

50'30"

33°
50'

$Y = 30,000 \text{ ft. N.C.}$

$$Y = 310,000 \text{ ft. S.C.}$$
 $78^{\circ}37'30''$

37'

COMPARISON PRINT

Blue = T-12294
Brown = AMS Quad
Red = Chart 11534

T-12294 (2)
1:10,000

△
LEWIS 1934

33° 51'

69-E(C)-

69-E(C)-3718

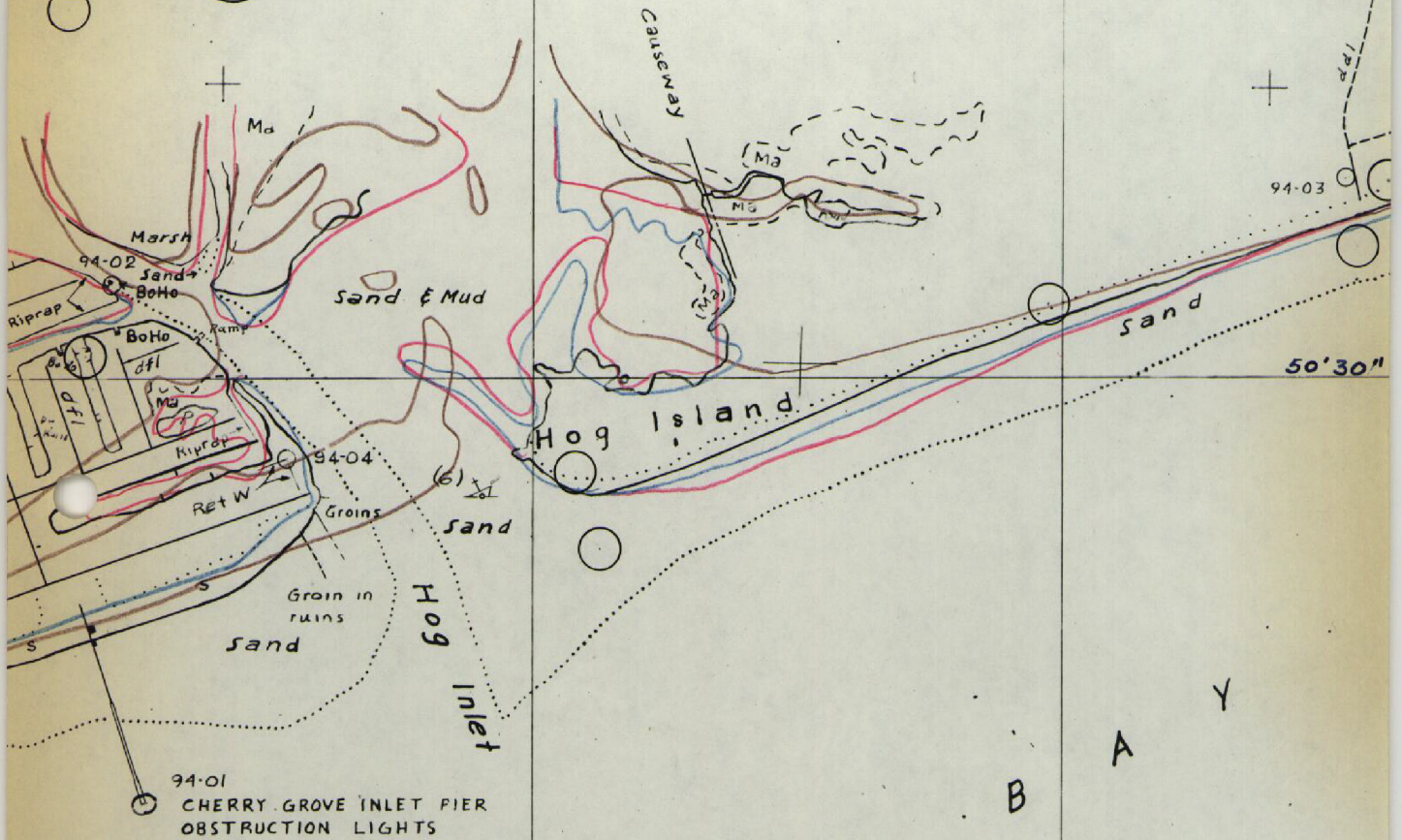

COMPARISON PRINT

Blue = T-12294
Brown = AMS Quad
Red = Chart 11534

T-12294 (2)
1:10,000

69-E(C)-3760

S ISLAND

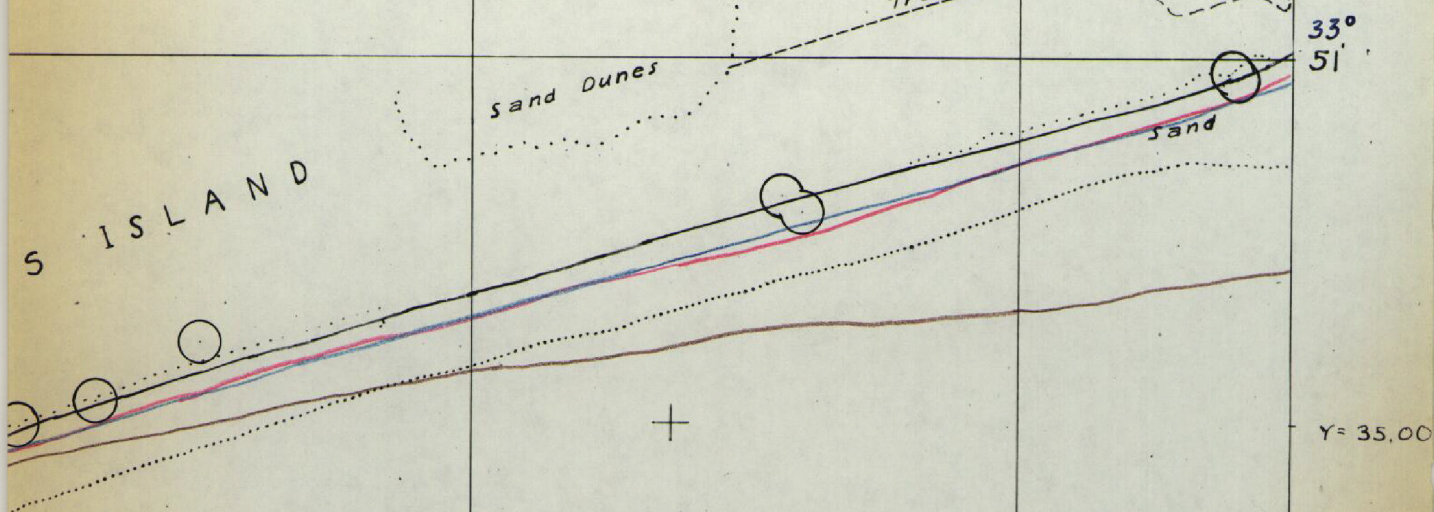

COMPARISON PRINT

Blue = T-12294
Brown = AMS Quad
Red = Chart 11534

T-12294 (2)
1:10,000

33°
50'

Y = 30,0

78°33'45"