

ORIG

12398

12398

Form 504	
U. S. DEPARTMENT OF COMMERCE	
COAST AND GEODETIC SURVEY	
DESCRIPTIVE REPORT	
<i>Type of Survey</i> SHORELINE	
<i>Field No.</i>	<i>Office No.</i> T-12398
LOCALITY	
<i>State</i>	NEW YORK
<i>General locality</i>	LONG ISLAND SOUND
<i>Locality</i>	HEROD POINT
<u>1965 - 1969</u>	
CHIEF OF PARTY	
Allen L. Powell, Director, AMC	
LIBRARY & ARCHIVES	
DATE	

USCOMM-DC 5087

DESCRIPTIVE REPORT - DATA RECORD

T- 12398

SUBJECT NO. (II):

Job PH-6603

FIELD OFFICE (III):

Riverhead (L.I.), N.Y.

CHIEF OF PARTY

Joseph K. Wilson

PHOTOGRAMMETRIC OFFICE (III):

Photogrammetric Branch
Atlantic Marine Center

OFFICER-IN-CHARGE

Allen L. Powell
Director, AMC

INSTRUCTIONS DATED (II) (III):

FIELD - January 24, 1966 - Supplement I
OFFICE - May 27, 1966 - AerotriangulationOFFICE - September 15, 1966 Compilation
OFFICE - AMENDMENT I - April 25, 1967

METHOD OF COMPILATION (III):

Kelsh Plotter

MANUSCRIPT SCALE (III):

1:20,000

STEREOSCOPIC PLOTTING INSTRUMENT SCALE (III):

1:8000 Pantographed to 1:20,000

DATE RECEIVED IN WASHINGTON OFFICE (IV):

DATE REPORTED TO NAUTICAL CHART BRANCH (IV):

APPLIED TO CHART NO.

DATE:

DATE REGISTERED (IV):

GEOGRAPHIC DATUM (III):

NA 1927

VERTICAL DATUM (III):

MEAN SEA LEVEL EXCEPT AS FOLLOWS:

Elevations shown as (25) refer to mean high water

Elevations shown as (5) refer to sounding datum

i.e., mean low water or mean lower low water
XXXXXXXXXXXXXXX

REFERENCE STATION (III):

CAMP GRANT 1939

LAT.:

40°57'46.636" (1438.6m)

LONG.:

72°45'42.028" (982.8m)

☒ ADJUSTED☐ UNADJUSTED

PLANE COORDINATES (IV):

STATE

New York

ZONE

Long Island

Y =

X =

NUMERALS INDICATE WHETHER THE ITEM IS TO BE ENTERED BY (II) FIELD PARTY, (III) PHOTOGRAMMETRIC OFFICE,
OR (IV) WASHINGTON OFFICE.

WHEN ENTERING NAMES OF PERSONNEL ON THIS RECORD GIVE THE SURNAME AND INITIALS, NOT INITIALS ONLY.

DESCRIPTIVE REPORT - DATA RECORD

T-12398

FIELD INSPECTION BY (II): Matthew A. Stewart Erwest W. Hartford		DATE: June-July 1966
MEAN HIGH WATER LOCATION (III) (STATE DATE AND METHOD OF LOCATION): 2 October 1965 Kelsh Plotter		
PROJECTION AND GRIDS RULED BY (IV): A. E. Roundtree		DATE 10-24-66
PROJECTION AND GRIDS CHECKED BY (IV): L. F. Van Scoy		DATE 10-25-66
CONTROL PLOTTED BY (III): L. L. Graves		DATE 10-31-66
CONTROL CHECKED BY (III): R. J. Pate		DATE 10-31-66
RADIAL PLOT OR STEREOSCOPIC CONTROL EXTENSION BY (III): P. Hawkins		DATE 8-30-66
STEREOSCOPIC INSTRUMENT COMPILATION (III):	PLANIMETRY W. S. Davis	DATE 7-15-67
	CONTOURS Inapplicable	DATE
MANUSCRIPT DELINEATED BY (III): C. H. Bishop		DATE 7-20-67
SCRIBING BY (III): R. E. Smith		DATE 11-4-70
PHOTOGRAMMETRIC OFFICE REVIEW BY (III): COMPILATION C. H. Bishop FIELD EDIT APPLICATION R. E. Smith SCRIBING AND STICKUP E. Pursell		DATE 7-24-67 10-21-70 2-3-71
REMARKS: FIELD EDIT BY R. S. Tibbetts 11-22-68		

DESCRIPTIVE REPORT - DATA RECORD

T-12398

ERA (KIND OR SOURCE) (III):

Wild "L"

PHOTOGRAPHS (III)

NUMBER	DATE	TIME	SCALE	STAGE OF TIDE
65L 6761 R thru 65L 6763 R	2 Oct. 1965	16:32	1:40,000	5.3 ft. above MLW (from Predicted Tables)
66 L 2869 Thru 66 L 2871	26 April 1966	08:46	1:40,000	0.2 ft. above MLW (from Staff reading)

TIDE (III)

	RATIO OF RANGES	MEAN RANGE	SPRING RANGE
REFERENCE STATION: BRIDGEPORT		6.8	8.0
SUBORDINATE STATION: Herod Point		5.9	7.0
SUBORDINATE STATION:			

WASHINGTON OFFICE REVIEW BY (IV): Leo F. Beugnet, AMC

DATE:
February, 1971

PROOF EDIT BY (IV):

DATE:

NUMBER OF TRIANGULATION STATIONS SEARCHED FOR (II): 2

RECOVERED:
2IDENTIFIED:
1

NUMBER OF BM(S) SEARCHED FOR (II): NONE

RECOVERED:

IDENTIFIED

NUMBER OF RECOVERABLE PHOTO STATIONS ESTABLISHED (III):

NUMBER OF TEMPORARY PHOTO HYDRO STATIONS ESTABLISHED (III):

REMARKS:

T-12398

COMPILATION RECORD	COMPLETION DATE	REMARKS
Compilation complete pending field edit		
INCOMPLETE MANUSCRIPT	July, 1967	Superseded
Field edit applied	July, 1968	Superseded
MHWL revised from 1969 photo- graphy and a third order tra- verse. Rocks and foul areas		
are from a field edit crona- flex dated 1968	Sept. 1969	

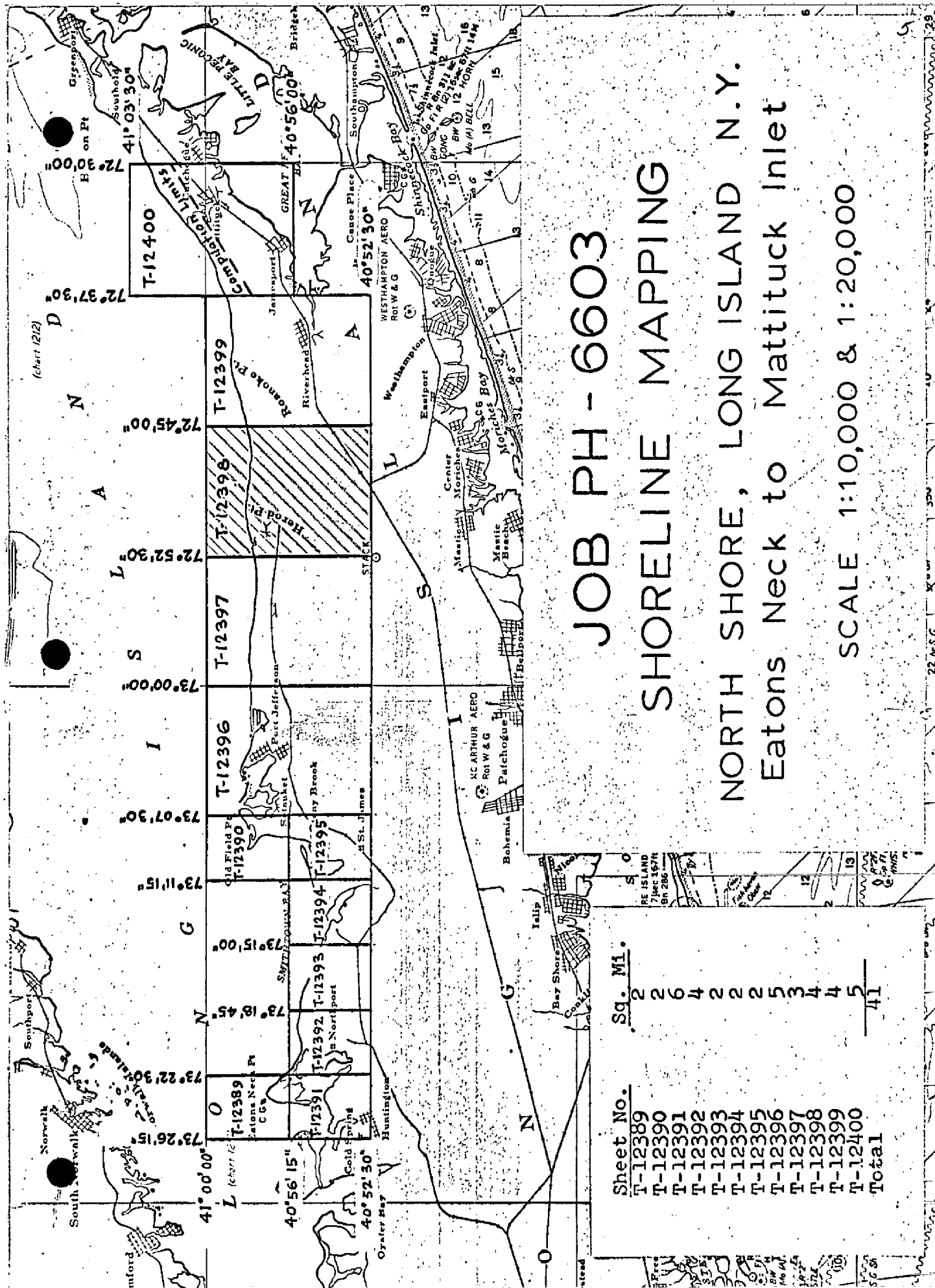

SUMMARY TO ACCOMPANY
DESCRIPTIVE REPORT T-12398

Shoreline survey T-12398 is one of twelve similar surveys in project PH-6603. These surveys cover that part of the north shore of Long Island extending from Eatons Neck to Mattituck Inlet. This survey covers the area from Wading River to Woodcliff Park. See page 5 of the descriptive report for the area within the project.

Field work preceded compilation. This consisted of recovery and identification of horizontal control, shoreline and interior field inspection, location of fixed aids to navigation and selection of landmarks for charts.

Compilation was at 1:20,000 scale by Kelsh Plotter methods using the photography of October 2, 1965. Cronaflex copies of the manuscript along with specially prepared photographs and ozalids were subsequently provided for transfer of the shoreline to the boat sheet, photo-hydro support use and field edit.

The manuscript was a vinylite sheet $7\frac{1}{2}$ minutes in latitude by $7\frac{1}{2}$ minutes in longitude. After application of field edit data it was scribed and reproduced on cronaflex. Final review was in the Atlantic Marine Center in February 1971. A cronaflex positive and a negative of the final reviewed survey are forwarded for record and registry.

FIELD INSPECTION REPORT
JOB PH-6603
MAPS T-12396 Thru T-12400

This report covers the easterly five maps of Job PH-6603. Since the terrain, methods of surveying, and features are common throughout the area, no special treatment of information or data pertaining to individual maps are needed except as noted herein.

2. AREAL FIELD INSPECTION

This area lies along the north shore of Long Island, New York from Old Field Point east to Duck Pond Point. The field work was accomplished during the months of July and August.

Field Inspection was completed in accordance with instructions for shoreline mapping, therefore the entire maps were not field inspected. The inspection was done on several types of photographs. The 1966 color photographs were much clearer than the ones taken in 1965. Some inland field inspection was done on the infrared high water photographs but generally they were poor for this purpose.

The area consists of sand beaches, bluffs, cultivated fields, wooded hills with very little marsh and no swamps. Most of the shoreline is accessible by truck.

Photographs used for field inspection are listed below by maps:

T-12396

65-L-6548 - Ratio Prints 1:10,000 Scale
65-L-6530 - " " " "
65-L-6528 - " " " "
65-L-6755R - 2 X Ratio Matte Prints (high water photographs)
66-L-2865 - Color transparencies
66-L-2864 - " "
66-L-2863 - " "
66-L-2862 - " "

T-12397

65-L-6759R - 2 X Ratio Matte Prints (high water photographs)
66-L-2866 - Color transparencies
66-L-2867(2) " "
66-L-2868 " "

T-12398

65-L-6761R - 2 X Ratio Matte Prints (high water photographs)
65-L-6763R - 2 X Ratio Matte Prints (high water photographs)
66-L-2868 - Color transparencies
66-L-2869 - Color transparencies
66-L-2870 - Color transparencies
66-L-2871 - Color transparencies

T-12399

65-L-6765R - 2 X Ratio Matte Prints (high water photographs)
 66-L-2856R - Ratio Matte Prints
 66-L-2873 - Color transparencies
 66-L-2874 - Color transparencies
 66-L-2875 - Color transparencies
 66-L-2886 - Color transparencies

T-12400

66-L-2847R - Ratio Matte Photographs
 66-L-2848R - " " "
 66-L-2850R - " " "
 66-L-2852R - " " "
 66-L-2853R - " " "
 66-L-2854R - " " "
 66-L-2876 - Color transparencies
 66-L-2889 - " "
 66-L-2890 - " "

3. HORIZONTAL CONTROL

Horizontal Control recovery and identification has been completed in accordance with project instructions.

No new control was established.

Only one horizontal control station was reported destroyed within the five maps, namely, OLD FIELD POINT LIGHT (NEW) 1939. It is located in map T-12396.

4. VERTICAL CONTROL

All tidal bench marks in the area were searched for and reported on form 685A.

Identification of the marks on the photograph was in accordance with the topographic manual.

5. CONTOURS AND DRAINAGE

Contours are inapplicable.

Drainage is composed mostly of a few tidal streams. Normal drainage is run off into recharge basins distributed throughout the area. Recharge basins are used to maintain and replenish the level and source of the underground water table. These basins are indicated on the photographs as borrow pits.

6. WOODLAND COVER

Classified in accordance with the topographic manual.

7. SHORELINE AND ALONGSHORE FEATURES

No inspection was made of the mean high and low water lines as these are to be compiled from tide controlled infrared and color photography.

The foreshore ~~shore~~, generally consists of sand and gravel with a liberal sprinkling of rocks and boulders in the bluff areas. Many of these rocks cover and uncover at various stages of the tide. A number of these were called to the compilers attention but no particular effort was made to indicate all of them.

Bluffs were indicated on the color photographs in black ink. The compiler will note that in certain instances bluffs are recommended for chart 361 only. All other bluffs are to be shown on chart 1212, 361 and 363 where applicable.

Docks, piers, wharves, boat ramps etc have been shown on the photographs.

Only one submerged pipeline crossing was encountered. It is approximately 2 miles east of Roanoke Point and is marked on the color photographs.

There are no other shoreline features that warrant mention.

8. OFFSHORE FEATURES

Except for a wreck, which is indicated on the color photographs, and a few sand bars in the various harbors, the only offshore features encountered were rocks. Rock areas were carefully inspected at both high and low water and individual rocks were marked on the color photographs. Attention was given to all rocks, but a particular effort was made to locate rocks at the extreme outside of rocky areas. One out-lying rock was located by sextant fix with check angle. In a few areas where there were numerous sunken rocks the area was indicated by a dashed line. Hatch Rock, between Port Jefferson Harbor and Mt. Sinai Harbor, was searched for on two separate occasions without success. However, on both occasions the field inspector had a plus tide. This rock should definitely be searched for by the field editor, as it is a named feature on the charts of the area. Rocks marked on the photographs are awash unless otherwise indicated.

9. LANDMARKS AND AIDS

All landmarks for nautical charts were visited and reported on form 567. Two new landmarks were recommended and one was deleted. Particular attention is called to the several landmarks that were recommended for deletion from chart 1212 but are to be retained on charts 361 and 363. Two chart letters are enclosed with the report, one for deletion of a landmark building and another one indicating a landmark feature which is misleading. This is the "tanks" between Roanoke Point and Jacobs Hills. The number indicating the contour surrounding the tanks has been placed adjacent to "tanks" making it appear as "170 tanks". It is recommended that the number either be moved further from the name, placed outside the contour or below the name.

Fixed aids to navigation were located on the infrared photographs and

reported on form 567. Floating aids to navigation were not a subject of the investigation.

10. BOUNDARIES, MONUMENTS AND LINES

In accordance with project instructions.

11. OTHER CONTROL

None established.

12. OTHER INTERIOR FEATURES

Classified according to current instructions.

13. GEOGRAPHIC NAMES

A complete investigation of geographic names was made by Mr. Philip B. Walbolt for all of Job PH-6603 and part of Job PH-6602.

14. SPECIAL REPORTS AND SUPPLEMENTAL DATA

Field Inspection Data to Norfolk, transmittal letter dated 6/23/66, reference # 40.

Horizontal Control Identification Data to Rockville, transmittal letter dated 7/8/66, reference # 62-1 and transmittal letter dated 6/24/66, reference # 42.

Geographic Names Investigation Report to Rockville, transmittal letter dated 8/1/66, reference # 62-3.

Submitted:
August 15 August 1966

Joseph K. Wilson
Joseph K. Wilson
Chief, Photo Party 62

11

PHOTOGRAMMETRIC PLOT REPORT
Job PH-6603
North Shore Long Island, New York

August 30, 1966

21. Area Covered

The area covered in this report extends from Eatons Neck to Mattituck Inlet, along the North Shore of Long Island, New York. Included in this area are T-sheets 12390 thru 12400.

22. Method

Five strips of photography (A thru E) were bridged on the stereo-planigraph and adjusted by IBM 1620 methods. Strip "A" was adjusted on six control stations, with three control stations as checks. Strip "B" was adjusted on five control stations. Strip "C" was adjusted on four stations with two stations as checks. Strip "D" was adjusted on seven stations with three stations as checks. Strip "E" was adjusted on two stations with three stations as checks. All points were drilled by PUG methods. Tie points between strips were averaged.

23. Adequacy of Control

Horizontal control was adequate and complied with project instructions. All control held within National Map Accuracy Standards with the following exceptions:

- (1) OLD FIELD PT. LT. (new) 1939, held in Strip "C" but could not be seen clearly in Strip "D" and as a result could not be held in Strip "D".
- (2) INDIANA 1933, SS "A" and SS "B" could not be held in either Strips "D" or "E" due to poor images and deep shadows which resulted in the inability of the stereoplanigraph operator to identify the substations with any degree of accuracy.

24. Supplemental Data

Local USGS quads were used for vertical control during bridging adjustment. Vertical elevations obtained by the bridge should not be used to obtain exact vertical datum.

25. Photography

Photography was adequate as to coverage and overlap. Definition and quality of diapositives were not up to usual standards in that they were very dark. However, all photography was usable.

Submitted by:

Paul Hawkins
Paul Hawkins *by JDP*

Approved by:

John D. Perrow Jr.
John D. Perrow, Jr.

DESCRIPTIVE REPORT CONTROL RECORD

MAP T- 12398

PROJECT NO. PH-6603

SCALE OF MAP 1:20,000

SCALE FACTOR NONE

STATION	SOURCE OF INFORMATION (INDEX)	DATUM	LATITUDE OR Y COORDINATE LONGITUDE OR X COORDINATE	N.A. 1927 - DATUM DISTANCE FROM GRID OR PROJECTION LINE IN METERS (1 Ft. = 3048006 meter)	
				FORWARD	(BACK)
WAUWEPEX, 1939	G. P. 194	N. A. 1927	40°55'14.570"	449.4	(1401.4)
			72°49'23.816"	557.3	(846.7)
CAMP GRANT, 1939	G. P. 195	"	40°57'46.636"	1438.6	(412.3)
			72°45'42.028"	982.8	(420.3)
WILDWOOD STATE PARK, ELEVATED TANK, 1939	" 203	"	40°57'48.953"	1510.1	(340.8)
			72°48'23.638"	552.8	(850.3)
COMPUTED BY A. C. RAUCK, JR.	DATE OCT. 3, 1966	CHECKED BY L. O. NETERER, JR.	DATE OCT. 5, 1966	13	

COMPILATION REPORT

Map Manuscript T-12398

Job PH-6603

31. DELINEATION:

Delineation was done with the Kelsh Plotter, using infrared photography taken when the trees were in foliage.

Cultural features that were missed when the Kelsh models were set were mapped graphically from black and white prints of color photographs taken in the spring before leaves were on the trees.

32. CONTROL:

See Photogrammetric Plot Report, dated August 30, 1966.

33. SUPPLEMENTAL DATA:

None.

34. CONTOURS AND DRAINAGE:

Contours not applicable. Two drains from marsh areas were mapped.

35. SHORELINE AND ALONGSHORE DETAILS:

The mean high water line was delineated from office interpretation of photographs taken within 0.5 foot of mean high water.

The low water line was not mapped.

36. OFFSHORE DETAILS:

There are no offshore details other than rocks. Nautical Chart 1212 and U.S.G.S. Quadrangle WADING RIVER show numerous offshore rocks, many of which are not identifiable on the photographs. None were located by the field inspector. The rocks shown on the map manuscript were compiled from office interpretation of the photographs and should be verified by field edit.

37. LANDMARKS AND AIDS:

Forms 567 for LANDMARKS FOR CHARTS were forwarded to the Rockville Office under date March 3, 1971.

There are no fixed aids to navigation in this map area.

38. CONTROL FOR FUTURE SURVEYS:

None.

39. JUNCTIONS:

Satisfactory junctions have been made with T-12397 on the west and T-12399 on the east. There are no contemporary surveys on the north or south.

40. HORIZONTAL AND VERTICAL ACCURACY:

No statement.

46. COMPARISON WITH EXISTING MAPS:

Comparison was made with U.S.G.S. Quadrangle WADING RIVER, N. Y., scale 1:24,000 dated 1957.

47. COMPARISON WITH NAUTICAL CHARTS:

Comparison was made with C&GS Chart 1212, scale 1:80,000, 10th Edition, dated March 7, 1966.

ITEMS TO BE APPLIED TO NAUTICAL CHARTS IMMEDIATELY:

None.

ITEMS TO BE CARRIED FORWARD:

None.

Approved:

Allen L. Powell

Allen L. Powell
Director, Atlantic Marine Center

Submitted:

Charles H. Bishop

Charles H. Bishop
Cartographer
7-27-67

GEOGRAPHIC NAMES

FINAL NAME SHEET

PH-6603 (New York)

T-12398

Albany Rock

Fresh Pond Landing

Herod Point

Hulse Landing

Little Flower School

Long Island

Long Island Sound

New York

St. Josephs Villa

Wading River

Wading River Landing

Woodcliff Park

Approved:

A. Joseph Wraight
Chief Geographer

Prepared by:

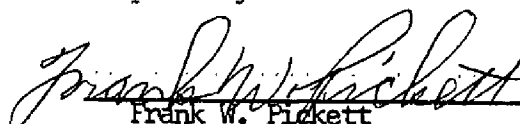
Frank W. Pickett
Cartographic Technician

T- 12398

49- NOTES FOR THE HYDROGRAPHER:

Refer to those notes found on the Field Edit Ozalid

FORM C&GS-1002
(9-66)U.S. DEPARTMENT OF COMMERCE
ESSA
COAST AND GEODETIC SURVEY

PHOTOGRAMMETRIC OFFICE REVIEW

T- 12398

1. PROJECTION AND GRIDS CHB		2. TITLE CHB		3. MANUSCRIPT NUMBERS CHB		4. MANUSCRIPT SIZE CHB	
CONTROL STATIONS							
5. HORIZONTAL CONTROL STATIONS OF THIRD-ORDER OR HIGHER ACCURACY CHB				6. RECOVERABLE HORIZONTAL STATIONS OF LESS THAN THIRD-ORDER ACCURACY (Topographic stations) XX		7. PHOTO HYDRO STATIONS XX	
8. BENCH MARKS XX		9. PLOTTING OF SEXTANT FIXES XX		10. PHOTOGRAMMETRIC PLOT REPORT Rockville Office		11. DETAIL POINTS CHB	
ALONGSHORE AREAS (Nautical Chart Data)							
12. SHORELINE CHB		13. LOW-WATER LINE XX		14. ROCKS, SHOALS, ETC. CHB		15. BRIDGES XX	
16. AIDS TO NAVIGATION XX		17. LANDMARKS CHB		18. OTHER ALONGSHORE PHYSICAL FEATURES CHB		19. OTHER ALONGSHORE CULTURAL FEATURES CHB	
PHYSICAL FEATURES							
20. WATER FEATURES CHB				21. NATURAL GROUND COVER XX		22. PLANETABLE CONTOURS XX	
23. STEREOSCOPIC INSTRUMENT CONTOURS XX		24. CONTOURS IN GENERAL XX		25. SPOT ELEVATIONS XX		26. OTHER PHYSICAL FEATURES CHB	
CULTURAL FEATURES							
27. ROADS CHB		28. BUILDINGS CHB		29. RAILROADS XX		30. OTHER CULTURAL FEATURES CHB	
BOUNDARIES							
31. BOUNDARY LINES XX				32. PUBLIC LAND LINES XX			
MISCELLANEOUS							
33. GEOGRAPHIC NAMES CHB				34. JUNCTIONS CHB		35. LEGIBILITY OF THE MANUSCRIPT CHB	
36. DISCREPANCY OVERLAY CHB		37. DESCRIPTIVE REPORT CHB		38. FIELD INSPECTION PHOTOGRAPHS CHB		39. FORMS CHB	
40. REVIEWER C. H. Bishop 7/24/67				SUPERVISOR, REVIEW SECTION OR UNIT A. C. Rauck, Jr.			
41. REMARKS (See attached sheet)							
FIELD COMPLETION ADDITIONS AND CORRECTIONS TO THE MANUSCRIPT							
42. Additions and corrections furnished by the field completion survey have been applied to the manuscript. The manuscript is now complete except as noted under item 43.							
COMPILER A. Shands 12/13/68 R. Smith 9/10/70				SUPERVISOR A. C. Rauck, Jr.			
REVIEWER L. F. Beugnet 10/21/70							
43. REMARKS FIELD EDIT APPLIED FROM: Field edit ozalid. Cronaflex copy Field ratio 66L-2871 DATE: 12/13/68 9/10/70							

FIELD EDIT REPORT
JOB PH-6603
MAPS T-12396 thru T-12398

51. The mean high waterline along the sound was verified by visual inspection from a small boat. Requests for correction, additions and deletion are indicated on the Field Edit Sheet with reference to the photograph by number or cronaflex on which the information is shown.

Streets and roads were traveled to verify existence and classification.

No new landmark buildings were noted during Field Edit.

Landmarks and aids to navigation were visually verified as to existence. No new landmarks or aids were noted.

52. ADEQUACY OF COMPILATION:

After application of field edit correction, additions and deletions, compilation will be adequate.

53. MAP ACCURACY:

No test were specified, however, hydro-signals for the most part were located by a traverse along the beach, and whenever possible traverse stations were put over passpoints, these all checked well, the greatest error was approximately three tenths millimeter.

54. RECOMMENDATIONS:

None offered.

55. EXAMINATION OF PROOF COPY:

Not required.

Submitted 11/22/68

Robert S. Tibbetts
Surveying Technician

REVIEW REPORT T-12398

SHORELINE

FEBRUARY 16, 1971

61. GENERAL STATEMENT

See Summary, which is page 6 of the descriptive report.

62. COMPARISON WITH REGISTERED TOPOGRAPHIC SURVEYS

Comparison was made with copies of registered surveys Nos. 1727 and 1728, both 1:10,000 scale surveys made in 1885. Many of the rocks shown on these two surveys are not visible on the photographs of the area. These and the difference in the shoreline have been indicated on the comparison print in blue.

The passage of time has made surveys Nos. 1727 and 1728 obsolete. They are superseded by T-12398 for nautical chart construction purposes.

63. COMPARISON WITH MAPS OF OTHER AGENCIES

Comparison was made with U.S.G.S. WADING RIVER, N.Y., 7½ minute quadrangle, 1:24,000 scale, edition of 1957. The two surveys are in good general agreement with the exception of the rocks. Those rocks, shown on the U.S.G.S. quadrangle, which are not visible on the photographs have been indicated on the comparison print in purple.

A comparison of the U.S.G.S. quadrangle and Chart 1212 indicates that the source of the rocks for the U.S.G.S. quadrangle was Chart 1212.

64. COMPARISON WITH CONTEMPORARY HYDROGRAPHIC SURVEYS

There was no contemporary hydrographic survey available for comparison purposes at the time of final review.

65. COMPARISON WITH NAUTICAL CHARTS

Comparison was made with chart 1212, 13th edition, January 31, 1970, corrected thru N.M. 5-1970. This is the only chart that covers this area. Many of the rocks shown on the chart are not visible on the photographs. As stated in item 63 the source for the rocks for the U.S.G.S. quadrangle was chart 1212, therefore, all differences that exist between the U.S.G.S. quadrangle and T-12398 also exist between the chart and T-12398.

66. ADEQUACY OF RESULTS AND FUTURE SURVEYS

This survey complies with instructions and meets the National Standards of Map Accuracy.

Reviewed by:

Leo F. Beugnet
Leo F. Beugnet
Cartographer

Approved for forwarding:

Melvin J. Umbach
Melvin J. Umbach, CDR, NOAA
Chief, Photogrammetry Division, AMC

Approved:

Allen L. Powell
Allen L. Powell, RADM, NOAA
Director, Atlantic Marine Center

Approved:

Charles L. Hemen *Jack E. Luth*
Chief, Photogrammetric Branch, ^{US} Chief, Photogrammetry Division

L O N G I S L A N D

40° 59' 00"

Rocks & Shoreline in blue from
Surveys 1727 & 1728
Rocks in purple from USGS
WADING RIVER quadrangle

Survey 1727 ← → Survey 1728

SETTLERS
Not on USGS
quadrangle

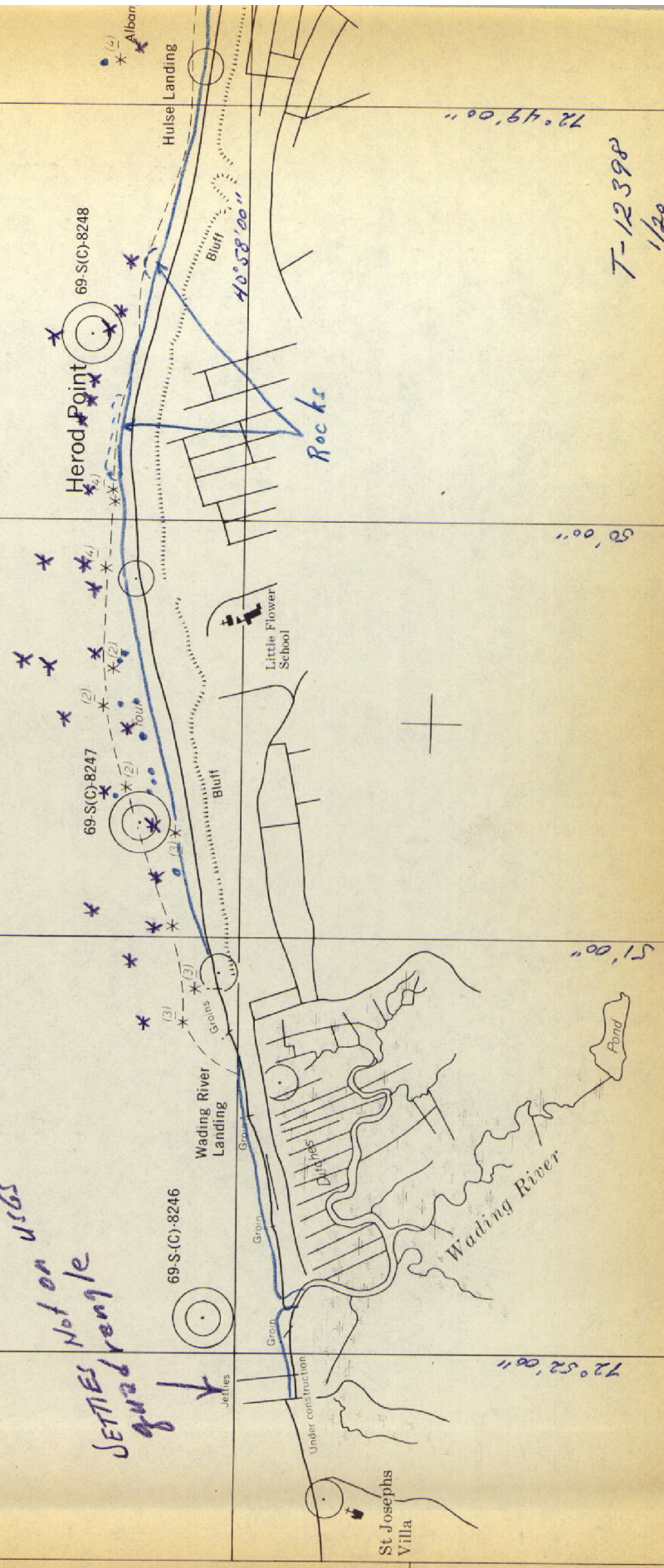

T-12398
1/20

72° 49' 00"

100, 20

5' 00"

72° 52' 00"

D

S

O

U

N

D

40° 59' 00"

Rocks in blue shoreline in blue
from Registered Survey 1728
Rocks in purple from USGS
WADING RIVER QUAD RONG K

69-S(C)-8249

69-S(C)-8250

69-S(C)-8251



Rock

WILDWOOD STATE PARK
ELEVATED TANK 1939
LOMK (steel) ht=148(273)



Bluff

Rocks

Fresh Pond Landing

Gut

Woodcliff Park

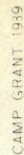

CAMP GRANT 1939

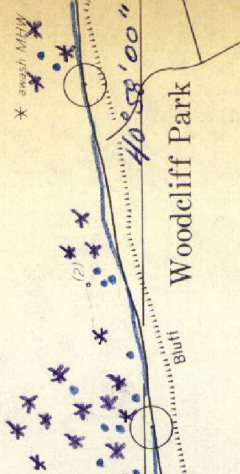

72° 48' 00"

47° 00"

46° 00"

T-12398
1/20

STRIKE OUT TWO

AGENT-LOCATING AIDS-OR: LANDMARKS FOR CHARTS

Atlantic Marine Center

March 3 1971

I recommend that the following objects which have ~~XXXXXX~~ been inspected from seaward to determine their value as landmarks be charted on ~~XXXXXX~~ the charts indicated.

The positions given have been checked after listing by

B. Wilson

B. Wilson

Mr. Allen L. Powell, Director, AMC

XXXXXXXXXXXXXXXXXXXX

[illegible]

This form shall be prepared in accordance with Hydrographic Manual, Publication 20.2, Sec. 1-55, 2-39, 6-36, 7-18 to 22 inclusive, and Fig. 79. Positions of charted landmarks and *nonfloating aids* to navigation, if redetermined, shall be reported on this form. Revisions shall show both the old and new positions. The data should be considered for the charts of the area and not by individual field survey sheets. Information under each column heading should be given.

* TABULATE SECONDS AND METERS

