

8979

Diag. Cht. No. 537 81110

Form 504

U. S. COAST AND GEODETIC SURVEY

DEPARTMENT OF COMMERCE.

DESCRIPTIVE REPORT

Type of Survey TOPOGRAPHIC

Field No. Ph-20(47) Office No. T-8979

LOCALITY

State NORTH CAROLINA

General locality PAMLICO RIVER

Locality BATH

194

CHIEF OF PARTY

E.R. McCarthy, Chief of Field Party.

A.L. Wardwell, Tampa Photogrammetric Office.

LIBRARY & ARCHIVES

DATE April 1, 1953

8979  
6268

# DATA RECORD

T - 8979

Project No. (II): Ph-20(47)

Quadrangle Name (IV):

Field Office (II): Washington, N. C.

Chief of Party: E. R. McCarthy

Photogrammetric Office (III): Tampa, Florida

Officer-in-Charge: Arthur L. Wardwell

Instructions dated (II) (III): 23 July 1948

Copy filed in Division of  
Photogrammetry (IV)

Office Files

Method of Compilation (III): Graphic

Manuscript Scale (III): 1:20,000

Stereoscopic Plotting Instrument Scale (III): In applicable

Scale Factor (III): None

Date received in Washington Office (IV): 7-3-50 Date reported to Nautical Chart Branch (IV): 7-7-50

Applied to Chart No.

Date:

Date registered (IV): 9 Jan 1953

Publication Scale (IV): 1:24,000

Publication date (IV):

Geographic Datum (III): N.A. 1927

Vertical Datum (III):

Mean sea level except as follows:

Elevations shown as (25) refer to mean high water

Elevations shown as (5) refer to sounding datum

i.e., mean low water or mean lower low water

Reference Station (III): BAYVIEW, 1933

Lat.: 35° 26' 08".433 (259.9m)

Long.: 76° 47' 34".770 (877.0m)

Adjusted

~~0.000000~~

Plane Coordinates (IV): Lambert

State: North Carolina Zone:

Y = 620,781.62 Ft.

X = 2,657,359.93

Roman numerals indicate whether the item is to be entered by (II) Field Party, (III) Photogrammetric Office, or (IV) Washington Office.

When entering names of personnel on this record give the surname and initials, not initials only.

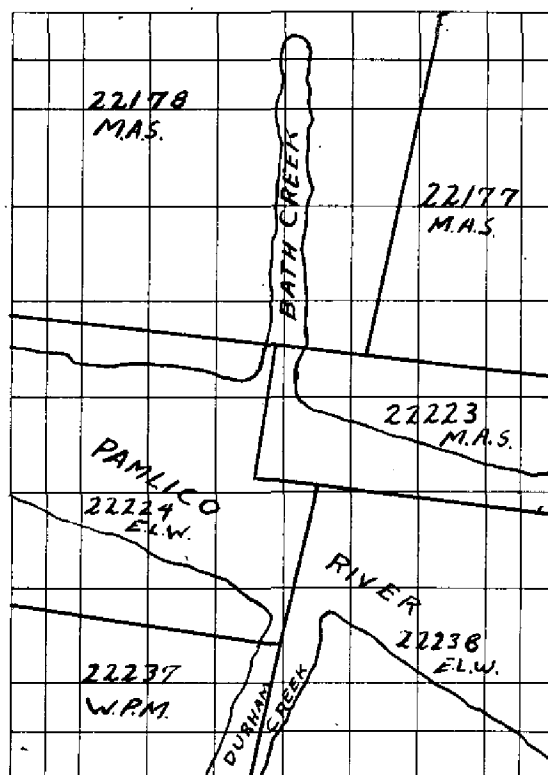

Areas contoured by various personnel  
 (Show name within area)  
 (II) (III)

Elmer L. Williams, Cartographer

Matthew A. Stewart, Cartographic Survey Aid

Walter P. Massie, Cartographic Survey Aid

## DATA RECORD

Field Inspection by (II): **E. L. Williams**  
**M. A. Stewart**

Date: **16 Dec. 48**  
**3 Mar. 49**

Planetable contouring by (II): **E. L. Williams**  
**M. A. Stewart**  
**W. P. Massie**

Date: **16 Dec. 48**  
**22 Mar. 49**

Completion Surveys by (II): **J. E. Hundley**

Date: **JAN 51**

Mean High Water Location (III) (State date and method of location):  
**Date of photographs, Aerial Photo. Compilation**

Projection and Grids ruled by (IV): **W.E.W. (Washington Office)**

Date: **28 June 48**

Projection and Grids checked by (IV): **W.E.W. ( " " )**

Date: **28 June 48**

Control plotted by (III): **R. R. Wagner**

Date: **12 Oct. 48**

Control checked by (III): **B. F. Lampton**

Date: **20 Oct. 48**

Radial Plot ~~of Stereoscopic~~

Date: **30 Dec. 49**

~~Control checked by (III):~~ **M. M. Slavney**

Planimetry  
 Stereoscopic Instrument compilation (III): **In applicable**  
 Contours

Date:

Date:

Manuscript delineated by (III): **R. A. Reece**

Date: **Mar. 1950**

Photogrammetric Office Review by (III): **J. A. Giles**

Date: **May 1950**

Elevations on Manuscript **J. A. Giles**  
 checked by (II) (III):

Date: **May 1950**

Camera (kind or source) (III): C. & G. S. ~~164~~ lens

Number	Date	Time	Scale	Stage of Tide
22177	29 Mar. 48	13:33	1:20,000	No
22223	29 Mar. 48	15:16	"	Periodic
22224	29 Mar. 48	15:17	"	Tide
22337	30 Mar. 48	-	"	

Tide (III)

Reference Station: appreciable  
Subordinate Station: No periodic tide  
Subordinate Station: A

Ratio of Ranges	Mean Range	Spring Range

Washington Office Review by (IV):

Jack L. Rihn

Date: 30 Aug 1951

Final Drafting by (IV): USGS

Date:

Drafting verified for reproduction by (IV):

Date:

Proof Edit by (IV):

Date:

Land Area (Sq. Statute Miles) (III): 39

Shoreline (More than 200 meters to opposite shore) (III): 31.3 Mi

Shoreline (Less than 200 meters to opposite shore) (III): 33.1 Mi

Control Leveling - Miles (II): 34

Number of Triangulation Stations searched for (II): 18

Recovered: 13

Identified: 9

Number of BMs searched for (II): 3

Recovered: 3

Identified: 1

Number of Recoverable Photo Stations established (III): 7

Number of Temporary Photo Hydro Stations established (III): None

Remarks:

# TOPOGRAPHIC MAPPING PROJECT PH-20 (17)

NORTH CAROLINA, Vicinity of Pamlico River

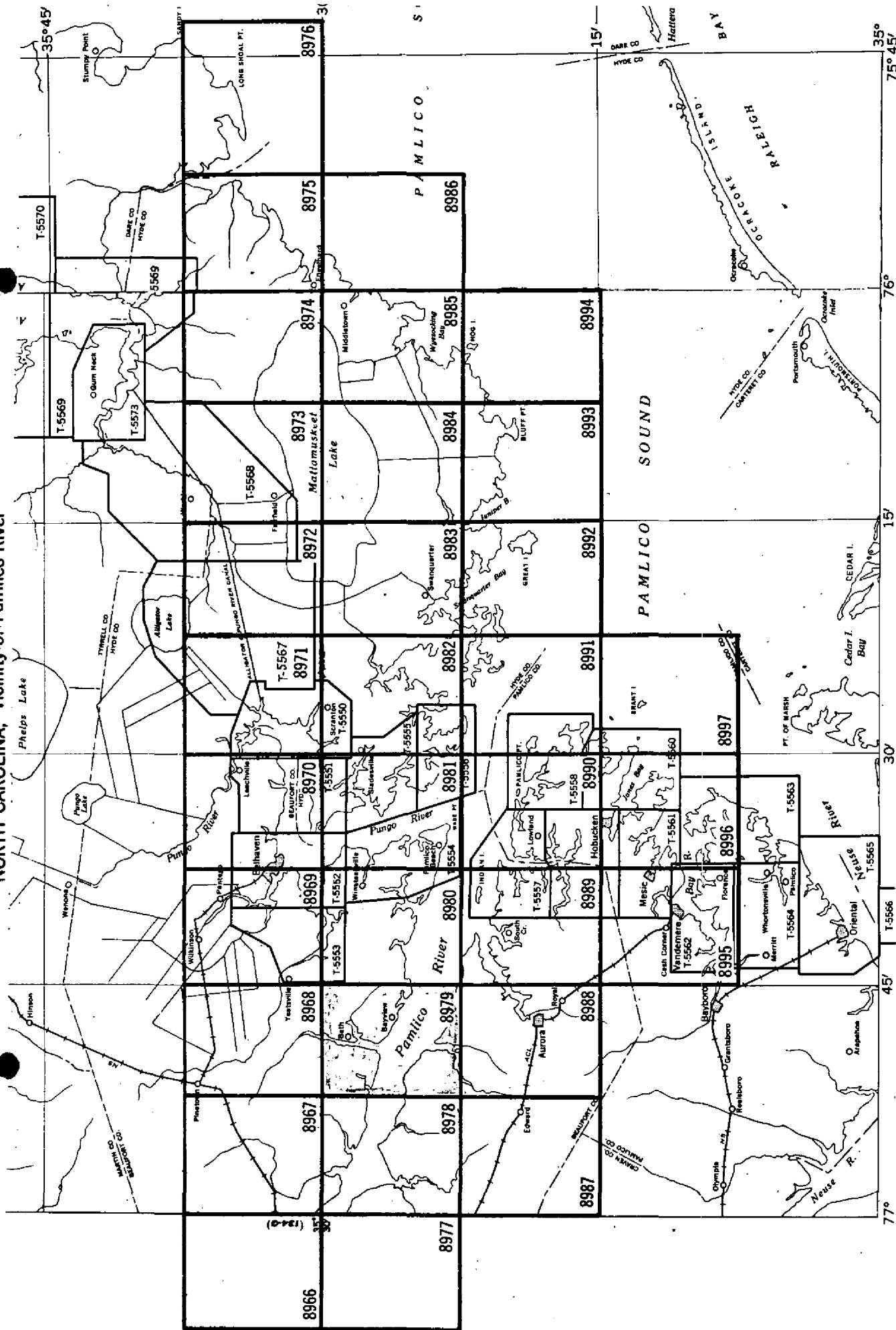

## Summary to Accompany T-8979

Topographic map T-8979 is one of a series of 32 maps in Project Ph-20(47). The field operations included complete field inspection and planetable contouring on 1:20,000 scale nine-lens photos. A manuscript was graphically compiled and completely field edited.

This map is to be published by the U. S. Geological Survey at a scale of 1:24,000 as a standard  $7\frac{1}{2}$  minute quadrangle. The registered copies under T-8979 will include the original descriptive report, a cloth mounted print of the manuscript at a scale of 1:20,000 and a cloth mounted print of the published map at a scale of 1:24,000.

## FIELD INSPECTION REPORT

Quadrangle T-8979

35-22.5/76-45/07.5

Project Ph-20(47)

E. R. McCarthy, Chief of Party

The field work for this quadrangle was done in accordance with the Director's Instructions, Project Ph-20(47), Field, dated 23 July 1948 and other instructions as noted herein. The report is submitted under instructions dated 30 September 1942. The field work was accomplished by the following personnel:

<u>Name and Title</u>	<u>Phase</u>	<u>Started</u>	<u>Completed</u>
M. A. Stewart Cart. Sur. Aid	Levels	12-16-48	2-8-49
E. L. Williams Cartographer (Photo)	Contours Levels Shoreline Field Inspection	10-15-48	12-16-49
M. A. Stewart Cart. Sur. Aid	Contours Field Inspection	12-16-48	3-22-49
W. P. Massie Cart. Sur. Aid	Contours Field Inspection	12-16-48	1-16-49

1. DESCRIPTION OF THE AREA

This quadrangle is located in Beaufort County, North Carolina, and is bisected by the Pamlico River. South of the river the land is mostly wooded. North of the river, the western section is cultivated and the eastern is wooded.

There are one incorporated town and several incorporated villages in the area. Bath, the incorporated town is the oldest permanent settlement in the state. The villages are scattered along the Pamlico River.

The area is adequately served by roads. The main route (State Highway #92) traverses the northern part of the quadrangle in an east-west direction.

2. COMPLETENESS OF FIELD INSPECTION

Field inspection is believed to be adequate and complete.

3. INTERPRETATION OF THE PHOTOGRAPHS

No difficulties were encountered in interpretation of the



photographs.

4. HORIZONTAL CONTROL

A search was made for all known horizontal control and a report for each triangulation station submitted on Form 526. A sufficient number of stations was identified to control the radial plot.

No supplemental control was established. See item 38

5. VERTICAL CONTROL

There are no third order bench marks. There are three tidal bench marks located in the town of Bath which were recovered, identified, and reported on Form 685A. Thirty-four miles of fly levels were run to furnish supplemental control for contouring.

6. CONTOURS AND DRAINAGE

Contouring was done on nine lens photographs of 1:20,000 scale at an interval of 5 ft. Elevations range from 0 to ~~10~~ <sup>36</sup> feet. The higher elevations are <sup>near</sup> the southwest corner. approximately 36

A tributary of Pamlico River, Bath Creek, and its tributaries Back and Duck Creeks drain the northern part of the quadrangle. Durham Creek, an arm of the Pamlico River, serves as the drainage artery for the southern part.

7. MEAN HIGH-WATER LINE

Mean high-water line shows clearly on the photographs.

8. MEAN LOW-WATER LINE

Mean low-water line <sup>closely</sup> coincides with the mean high-water line as there is no <sup>appreciable</sup> periodic tide.

9. WHARVES AND SHORELINE STRUCTURES

Most of the shoreline structures in the area are near the villages of Bath and Bayview. All structures have been shown on the photographs. Many of the piers are in ruins.

10. DETAILS OFFSHORE FROM THE HIGH-WATER LINE

There are no details offshore, except for a few temporary duck blinds.

11. LANDMARKS AND AIDS TO NAVIGATION

There are two landmarks, Bath Tank and Bayview Tank. These

- 8 -

Bath Cr. Lt.

features were identified on the photographs and are reported on Form 567. There are ~~two~~ <sup>three</sup> aids to Navigation; Durham Creek Light and Rumley Marsh Light which are submitted on Form 567; a copy of which is attached to this report.

## 12. HYDROGRAPHIC CONTROL

Control was identified in accordance with the Director's Instructions, Project Ph-20(47), Field dated 23 July 1948.

## 13. LANDING FIELD AND AERONAUTICAL AIDS

There are no landing fields or aeronautical aids in this quadrangle.

## 14. ROAD CLASSIFICATION

All roads were classified in accordance with Photogrammetry Instructions No. 10, dated 14 April 1947 as amended 24 October 1947.

## 15. BRIDGES

All bridge information for the area covered by this report as listed in the U. S. Engineers "List of Bridges Over Navigable Waters in the U. S." dated 1 July 1941 was verified in the field. All clearances were carefully measured with a steel tape. The published descriptions and clearances were found to be correct.

## 16. BUILDINGS AND STRUCTURES

The field inspection of buildings and structures was completed in accordance with Photogrammetry Instructions No. 29 dated 1 October 1948.

## 17. BOUNDARY MONUMENTS AND LINES

For description of all boundary monuments and lines in this project see Special Boundary Report which was submitted on 14 February 1949 by Mr. Wilbur H. Nelson, and supplement boundary report by Mr. A.J. Wraight, which will be submitted. *Filed in Div of Photogrammetry*

## 18. GEOGRAPHIC NAMES

This will be the subject of a special report which will be submitted by Mr. A. J. Wraight. *Filed in Geographic Name Section, Div of Charts*

Approved  
25 July 1949

*E. R. McCarthy*  
E. R. McCarthy  
Chief of Party

20 June 1949  
Submitted by:

*Matthew A. Stewart* by Joseph H. Wilson  
Matthew A. Stewart  
Cartographic Survey Aid

MAP T-6979

PROJECT NO. PM-20(47)

SCALE OF MAP 1: 20,000

SCALE FACTOR

STATION	SOURCE OF INFORMATION (INDEX)	DATUM	LATITUDE OR Y-COORDINATE LONGITUDE OR X-COORDINATE	DISTANCE FROM GRID IN FEET. OR PROJECTION LINE IN METERS		N.A. 1927 - DATUM DISTANCE FROM GRID OR PROJECTION LINE IN METERS		FACTOR DISTANCE FROM GRID OR PROJECTION LINE IN METERS
				FORWARD	(BACK)	FORWARD	(BACK)	FORWARD (BACK)
BATH TANK 1935	G.P. P. 264	N.A. 1927	35 28 38.193			1277.0	( 672.0)	
			76 48 53.630			1352.0	( 160.6)	
DRAKE, 1933	" P. 424	"	35 27 11.772			262.8	(1486.3)	
			76 51 33.373			811.6	( 671.5)	
BATH, 1933	" P. 423	"	35 27 02.000			86.3	(1762.8)	
			76 50 58.938			1486.4	( 26.8)	
BAYVIEW, 1933	" P. 423	"	35 26 08.133			259.9	(1589.2)	
			76 47 34.770			677.0	( 636.4)	
BEACH, 1933	" P. 424	"	35 25 30.588			942.7	( 906.4)	
			76 50 58.584			1477.8	( 33.7)	
CORES ECO, 1931	S. P. 218 P. 13	"	35 25 25.339			780.9	(1068.2)	
			76 50 43.010			1085.0	( 428.6)	
CORE, 1914	G. P. P. 424	"	35 25 25.985			800.8	(1018.3)	
			76 50 43.477			1016.3	( 467.3)	
FULL, 1933	" P. 423	"	35 24 37.982			1170.5	( 678.6)	
			76 49 35.129			886.3	( 627.5)	
WHITLEY, 1933	" P. 263	"	35 25 05.303			163.5	(1685.6)	
			76 48 50.562			1276.1	( 238.2)	
DURHAM, 1933	" P. 423	"	35 23 12.679			390.7	(1458.3)	
			76 47 00.779			19.7	(1494.7)	
DURHAM, 1933	" P. 263	"	35 22 27.584			850.1	( 999.0)	S. of map area
			76 50 15.446			389.9	(1124.7)	
LEES CR., 2, 1914	" P. 421	"	35 23 13.187			406.4	(1442.7)	
			76 46 59.556			1503.1	( 11.2)	

1 FT. = 3048006 METER D.P. Layton

22 September 1948

H.R. Wagner

CHECKED BY

DATE

24 September, 1948

2388-12

5

[illegible]

## COMPILATION REPORT, T-8979

PHOTOGRAMMETRIC PLOT REPORT

This report will be submitted with T-8967.

31. DELINEATION

The manuscript was delineated by the graphic method.

Due to the poor scale of the photographs, it was necessary to use the projector in transferring much of the detail, particularly contours.

Areas that are left for the completion survey, either for corrections or verification, have been noted on the discrepancy overlay.

As a whole, the field inspection is considered adequate.

32. CONTROL

A sufficient number of secondary control points were established and so placed that no difficulty was encountered in cutting in detail points.

33. SUPPLEMENTAL DATA

None.

34. CONTOURS AND DRAINAGE

Many contours that were questionable, that is, did not conform to the drainage pattern, were omitted from the manuscript until further investigation by the field editor.

Drainage has been applied to the manuscript after careful study under the stereoscope. Some discrepancies were noted in the field interpretation of drainage.

Minor contour changes have been made to conform more closely to the drainage and relief in general.

All major variances in contour and drainage interpretation have been shown on the discrepancy overlay.

35. SHORELINE AND ALONGSHORE DETAILS

No difficulty was encountered in the interpretation or delineation of the shoreline, the inspection of which was adequate.

All alongshore features have been shown according to the field inspector's notes.

### 35. SHORELINE AND ALONGSHORE DETAILS (Continued)

The limits of Core Point Shoal could not be discerned on the photographs and was therefore omitted from the manuscript. However, investigation should be made by the hydrographer to define the limits of the shoal.

Feature Name  
shown on  
manuscript  
for location  
purposes.

The limits of Beacham Slough is probably an undefinable feature and need not be further investigated by the hydrographer. The geographic name has therefore been retained on the manuscript.

### 36. OFFSHORE DETAILS

No difficulty was encountered in delineating offshore details that were noted by the Field Inspector. However, numerous offshore features shown on Chart 537 as piles and logs have not been recovered by the Field Inspector. These features may be found as shown on the Chart, in Bath Creek, in Durham Creek and offshore from the town of Bayview. If any of these features are still in existence and above the plane of MHW the field editor should locate them so that a position can be determined in the office.

See item 58  
|

### 37. LANDMARKS AND AIDS

Reference Item 11 concerning landmarks.

The Field Inspection Report is in error in stating that two aids to navigation fall within the quadrangle, when there are actually three. BATH CREEK LT. was cut in radially. RUMLEY MARSH LT. and DURHAM CREEK LT. was located by a combination of radial cuts, theodolite cuts and a sextant fix. The theodolite cuts were not too strong in some instances and there is some doubt if these two aids are in their correct position. They should be checked by the completion survey.

### 38. CONTROL FOR FUTURE SURVEYS

Seven recoverable topographic stations have been established and Form 524 submitted for each.

A list of these stations has been prepared and listed under Item 49.

14

39. JUNCTIONS

T-8968 to the north: in agreement  
T-8988 to the south: in agreement  
T-8978 to the west: in agreement  
T-8980 to the east: not compiled

40. HORIZONTAL AND VERTICAL ACCURACY

No statement.

46. COMPARISON WITH EXISTING MAPS

There are no topographic or planimetric maps available for comparison.

47. COMPARISON WITH NAUTICAL CHARTS

Comparison has been made with U.S.C.&G.S. Chart No. 537, scale 1:40,000, edition of Sept. 1937, bearing a print date of 12 Jan. 1948.

The chart and map manuscript appear to be in good agreement with the following exceptions:

A pond shown on the chart at approximate latitude  $35^{\circ} 28'$  longitude  $76^{\circ} 51'$  is now non-existent.

Numerous road changes and additions have occurred.

ITEMS TO BE APPLIED TO NAUTICAL CHARTS IMMEDIATELY.

None.

ITEMS TO BE CARRIED FORWARD

None.

*Richard A. Reece*  
Richard A. Reece  
Cartographic Survey Aid

Approved and Forwarded

*Arthur L. Wardwell*  
Arthur L. Wardwell  
Chief of Party

*V. S. M.*

## 50 PHOTOGRAMMETRIC OFFICE REVIEW

T. 8979

1. Projection and grids JG 2. Title JG 3. Manuscript numbers JG 4. Manuscript size JG

## CONTROL STATIONS

5. Horizontal control stations of third-order or higher accuracy MMS 6. Recoverable horizontal stations of less than third-order accuracy (topographic stations) JG ~~XXXXXXXXXXXXXXXXXXXX~~ 8. Bench marks JG  
9. Plotting of sextant fixes JG 10. Photogrammetric plot report JG 11. Detail points JG

## ALONGSHORE AREAS

(Nautical Chart Data)

12. Shoreline JG 13. Low-water line JG 14. Rocks, shoals, etc. JG 15. Bridges JG 16. Aids to navigation JG 17. Landmarks JG 18. Other alongshore physical features JG 19. Other along-shore cultural features JG

## PHYSICAL FEATURES

20. Water features JG 21. Natural ground cover JG 22. Planetable contours JG ~~XXXXXXXXXXXX~~  
~~XXXXXXXXXXXXXXXXXXXX~~ 24. Contours in general JG 25. Spot elevations JG 26. Other physical features JG

## CULTURAL FEATURES

27. Roads JG 28. Buildings JG ~~XXXXXXXXXXXX~~ 30. Other cultural features JG

## BOUNDARIES

31. Boundary lines JG ~~XXXXXXXXXXXX~~

## MISCELLANEOUS

33. Geographic names JG 34. Junctions JG 35. Legibility of the manuscript JG 36. Discrepancy overlay JG 37. Descriptive Report JG 38. Field inspection photographs JG 39. Forms JG  
40. Jesse A. Giles William A. Rasure  
Reviewer Supervisor, Review Section or Unit

41. Remarks (see attached sheet)

## FIELD COMPLETION ADDITIONS AND CORRECTIONS TO THE MANUSCRIPT

42. Additions and corrections furnished by the field completion survey have been applied to the manuscript. The manuscript is now complete except as noted under item 43.

\_\_\_\_\_  
Compiler\_\_\_\_\_  
Supervisor

43. Remarks:

M-2623-12



## FIELD EDIT REPORT T-8979

### 51. METHODS

The field edit of this quadrangle was accomplished by traversing, via truck, all passable roads, and walking to other areas in which the reviewer requested information, or for a general check on the adequacy of the map compilation. The entire shoreline in this area was inspected from a skiff.

Corrections and additions were made with standard survey instruments in conjunction with visual inspection.

All deletions have been noted on the field edit sheet. Additions and corrections have been noted on the field edit sheet and field photograph number 22223. All work shown on the photograph is properly referenced on the discrepancy print or field edit sheet.

The reviewer's questions are answered on the discrepancy prints whenever possible.

A legend appears on the field edit sheet indicating the different colored inks used for the various additions, corrections and deletions.

Geographic names revision appears on the geographic names print.

### 52. ADEQUACY OF COMPILATION

The map compilation, in general, is adequate and will be complete after field edit data has been applied.

### 53. MAP ACCURACY

In general, the accuracy of the map is good.

Minor corrections of the placement of contours were made throughout the area.

### 54. RECOMMENDATIONS

None.

### 55. EXAMINATION OF PROOF COPY

It is believed that Mr. Stewart Harris, land surveyor of Pungo, N.C., is best qualified to examine a proof copy of this map.

Reference to item 48 - Geographic Names List - Compilation Report

All geographic names which were to be investigated have been properly shown on the Geographic Names print.

56. HORIZONTAL CONTROL

Reference to item 4 - Field Inspection Report

Three third-order triangulation intersection stations were established, namely, Bayview Tank, Rumley Marsh Light and Durham Creek Light.

*Does not meet 3rd order specifications  
-Temporary*

*Shown with  
3rd order control  
symbol: O  
R*

57. WHARVES AND SHORELINE STRUCTURES

Reference to item 9 - Field Inspection Report

Numerous shoreline structures have been noted on the field edit sheet that were completely ignored during time of original field inspection.

58. OFFSHORE DETAILS

Reference to item 10 - Field Inspection Report

Note to Hydrographer.

There are numerous fish traps (stakes) and duck blinds (stakes) along both shores of the Pamlico River. *Not located by field parties but probably of a temporary nature.*

59. LANDMARKS AND AIDS TO NAVIGATION

Reference to item 11 - Field Inspection Report

All landmarks and aids to navigation shown on Chart #537, for this area, are in existence.

60. JUNCTIONS

Reference to item 39 - Compilation Report

A satisfactory junction has been made with quadrangle T-8988 to the south, T-8968 to the north; junctions with T-8978 on the west and T-8980 on the east will be made at a later date.

Submitted by:

*James E. Hundley*  
James E. Hundley,  
Cartographer

Approved by:

*Harry F. Garber*  
Harry F. Garber  
Chief of Party

DEPARTMENT OF COMMERCE  
U. S. COAST AND GEODETIC SURVEY

PHOTOGRAMMETRIC REVIEW SECTION

**TO BE CHARTED**

**STRIKE OUT ONE**

**Washington, D. C.**

Washington, D. C.

12 May, 1961

I recommend that the following objects which have ~~been~~ been inspected from seaward to determine their value as landmarks be charted on ~~(attached form)~~ the charts indicated.

The positions given have been checked after listing by

**Richard A. Reece**

**Tampa Photogrammetric Office**

**E. R. McCarthy** *Chief of Party.*

[illegible]

This form shall be prepared in accordance with Hydrographic Manual, pages 800 to 805, and shall be used for recording data for navigation, if redetermined, shall be reported on this form. The data should be reported on individual field survey sheets. Information under each column heading should be given.

Hydrographic Manual, pages 800 to 804. Positions of charted landmarks and *nonfloating* objects should be considered for the charts of the area and not by *floating* objects. The data should be in this form.

**DEPARTMENT OF COMMERCE**  
**U. S. COAST AND GEODETIC SURVEY**

PHOTOGRAMMETRIC REVIEWS SECTION

# NONFLOATING AIDS COLLECTOR MARKERS FOR CHARTS

**TO BE CHARTED** } **STRIKE OUT ONE**

Washington, N. C.      28 June      1949

I recommend that the following objects which have ~~(been examined)~~ been inspected from seaward to determine their value as landmarks be charted on ~~(deleted from)~~ the charts indicated.

The positions given have been checked after listing by

**Richard A. Recco**

Tampa Photogrammetric Office  
K. B. McCaskey

**Chief of Party.**

[illegible]

This form shall be prepared in accordance with Hydrographic Manual, pages 800 to 804. Positions of charted landmarks and *nonfloating aids* to navigation, if redetermined, shall be reported on this form. The data should be considered for the charts of the area and not by individual field survey sheets. Information under each column heading should be given.

**TO BE DELETED**

Washington, M. C.

**20 October 1950**

I recommend that the following objects which have ~~(been removed)~~ been inspected from seaward to determine their value as landmarks be ~~deleted from~~ *(deleted from)* the charts indicated.

The positions given have been checked after listing by

**Richard A. Neese, Tampa Photogrammetric  
Office**

**H. P. Garber**

Chief of Party:

This form shall be prepared in accordance with Hydrographic Manual, pages 800 to 804. Positions of charted landmarks and *nonfloating aids* to navigation, if redetermined, shall be reported on this form. The data should be considered for the charts of the area and not by individual field survey sheets. Information under each column heading should be given.

20 October 1950

## NONFLOATING AIDS ORIENTED MARKS FOR CHARTS

The positions given have been checked after listing by **Richard A. Rooco**

**H. F. Garber**

Chief of Party.

This form shall be prepared in accordance with Hydrographic Manual, pages 800 to 804. Positions of charted landmarks and *nonfloating aids* to navigation, if redetermined, shall be reported on this form. The data should be considered for the charts of the area and not by individual field survey sheets. Information under each column heading should be given.



48. GEOGRAPHIC NAME LIST

- ✓ ADAMS CREEK
- ✓ ARCHBELL GUT
- ✓ ARCHBELL POINT

Athens Chapel (on map)

- ✓ BACK CREEK
- ✓ BARRIS CREEK
- ✓ BATH
- ✓ BATH CREEK
- ✓ BATH TOWNSHIP
- ✓ BAYSIDE SCHOOL
- ✓ BAYVIEW
- ✓ BAYVIEW CHURCH
- ✓ BEACHAM SLOUGH
- ✓ BEAR GRASS POINT
- ✓ BEASLEY POINT
- ✓ BEAUFORT COUNTY
- ✓ BIG BAY
- ✓ BOGUS POINT
- ✓ BONNERS POINT
- ✓ BOYD CREEK (added)
- ✓ BRICK HOUSE COVE
- ✓ BROWN RUN

- ✓ CARTER CREEK
- ✓ CATNIP POINT
- ✓ CORE POINT
- ✓ CORE POINT (Community)
- ✓ CORE POINT CHAPEL
- ✓ CORE POINT SHOAL
- ✓ CRADLE GUT
- ✓ CRAWFORD MILL RUN
- ✓ CUPLER SLOUGHS

Cool Point (added)

- ✓ DUCK CREEK
- ✓ DURHAM CREEK
- ✓ DURHAM CREEK POINT

- ✓ EBORN POINT

- ✓ FRY POINT

Free Will Baptist Church (from Field)

- ✓ GAR GUT
- ✓ GARRISON POINT
- ✓ GLEBE CREEK
- ✓ GUM POINT

- ✓ HANDYS POINT
- ✓ HAWKINS LANDING
- ✓ HICKORY POINT ROAD
- ✓ HORSE POINT



48. GEOGRAPHIC NAME LIST (Continued)✓ JACKSON SWAMP ✓✓ KILBY ISLAND ✓✓ LEE CREEK ✓✓ LONG POINT ✓✓ MIDGETTE POINT ✓✓ MILL GUT ✓✓ MIXON CREEK (note enlarged application) ✓✓ MONEY POINT✓ MYRTLE BRANCH Too small to show ~~page~~✓ NORTH CAROLINA✓ PAMLICO RIVER✓ PLUM POINT✓ PLUM POINT GUT✓ PORTER CREEK✓ REEDY BRANCH CHURCH (to be located by F.E.)✓ RESPESS SHORE✓ RICHLAND TOWNSHIP✓ RUMLEY MARSH✓ SANDY POINT✓ SHELL LANDING✓ SLADE GUT✓ ST. THOMAS CHURCH✓ STATE NO. 92✓ STEVENS CHURCH✓ SULLIVAN POINT✓ TAYLOR BRANCH✓ TEACHS GUT✓ WHITE POST

(one word per 1950 B.F.N. decision)

Names underlined in red  
are approved — after Field  
Edit. 8-24-51  
L. HECK



Review Report T-8979  
Topographic Map Manuscript  
30 August 1951

62. Comparison with Registered Topo Surveys: For the areas in common, this survey supersedes:

T-1210 (1871)	1:20,000	T-6409 (1935)	1:10,000	
T-1212 (1870)	"	T-6410	"	"
T-6408		T-6416	"	"
		T-6464	"	" for

nautical charting purposes.

63. Comparison with maps of other agencies:

None

64. Comparison with Contemporary Hydro Surveys:

None

65. Comparison with Nautical Charts:

No. 537 6/11/51 1:40,000

The overhead cable and submarine cable at Bath should be charted. This survey should be applied to the chart <sup>done 4/3/53</sup> when it is reconstructed, changes and additions made during review are shown in red ink on the manuscript.

66. Aids and Landmarks:

Aids and landmarks are listed on Form 567. See copies following Field Edit Report.

67. Adequacy of Results:

This map complies with national map accuracy standards.

68. Overlay etc:

An overlay has been prepared showing road classifications, control etc. A list of control names as they are to be shown on the published map has also been prepared. This map will be edited and published by the U. S. Geological Survey.

Reviewed by:

Jack L. Rihn  
Jack L. Rihn, Cartographer

Approved by:

S. V. Guppish 3/10/53  
Chief, Review Section  
Division of Photogrammetry

O. S. Reading  
Chief, Div. of Photogrammetry

*[Handwritten initials]*

McMonister  
Chief, Nautical Chart Branch  
Division of Charts *670*

Carl O. Heaton  
Chief, Division of Coastal  
Surveys *227*

# HISTORY OF HYDROGRAPHIC INFORMATION

T-8979 - North Carolina

Hydrography was applied to the manuscript of this quadrangle in accordance with Division of Photogrammetry request of 12 September 1951, and with general specifications of 18 May 1949.

The depths are in feet at mean low water and originate with the following surveys and charts:

## USC&GS Hydrographic Surveys

H-5918	(1935)	1:10,000
H-5941	(1935)	1:10,000
H-5950	(1935)	1:10,000
H-5961	(1935)	1:10,000

## USC&GS Nautical Chart

537 (1951) 1:40,000

Bottom contours are shown at 6, 12 and 18 feet.

The hydrography was compiled by R. E. Elkins and checked by G. F. Jordan.

*R. E. Elkins*

R. E. Elkins - 1 October 1951  
Nautical Chart Branch