

9282



Diag. Cht. No. 12297 1-1001-2

Form 504

U. S. COAST AND GEODETIC SURVEY

DEPARTMENT OF COMMERCE

DESCRIPTIVE REPORT

Type of Survey Topographic

Field No. Ph-45 (49) Office No. T-9282

LOCALITY

State North Carolina

General locality Pamlico Sound

Locality Stumpy Point

1945

CHIEF OF PARTY

Harry F. Garber, Chief of Field Party

J. E. Waugh, Tampa Photogrammetric Office

LIBRARY & ARCHIVES

DATE JUNE 22, 1955

B-1870-1 (1)

9282

## DATA RECORD

T-9282

Project No. (II): **PH-45(49)**      Quadrangle Name (IV):Field Office (II): **Edenton, North Carolina**Chief of Party: **Harry F. Garber**Photogrammetric Office (III): **Tampa, Florida**Officer-in-Charge: **J. E. Naugh**Instructions dated (II) (III): **15 September, 1949**Copy filed in Division of  
Photogrammetry (IV)**19 January, 1950 Supplement 1****15 May 1951****" 2****Office Files**Method of Compilation (III): **Graphic**Manuscript Scale (III): **1:20,000**Stereoscopic Plotting Instrument Scale (III): **Inapplicable**Scale Factor (III): **None**Date received in Washington Office (IV): **16 June 52** Date reported to Nautical Chart Branch (IV):**JUN 23 1952**

Applied to Chart No.

Date:

Date registered (IV): **13 Apr 1955**

Publication Scale (IV):

Publication date (IV):

Geographic Datum (III): **N. A. 1927**Vertical Datum (III): **MSL**

Mean sea level except as follows:

Elevations shown as (25) refer to mean high water

Elevations shown as (5) refer to sounding datum

i.e., mean low water or mean lower low water

Reference Station (III): **METROPOLITAN RM 1, 1933**Lat.: **35° 41' 46".113 (1421.2m.)** Long.: **75° 46' 28".475 (715.9 m.)****Adjusted**  
UnadjustedPlane Coordinates (IV): **humbert**State: **N. C.**

Zone:

Y=

X=

Roman numerals indicate whether the item is to be entered by (II) Field Party, (III) Photogrammetric Office,  
or (IV) Washington Office.

When entering names of personnel on this record give the surname and initials, not initials only.



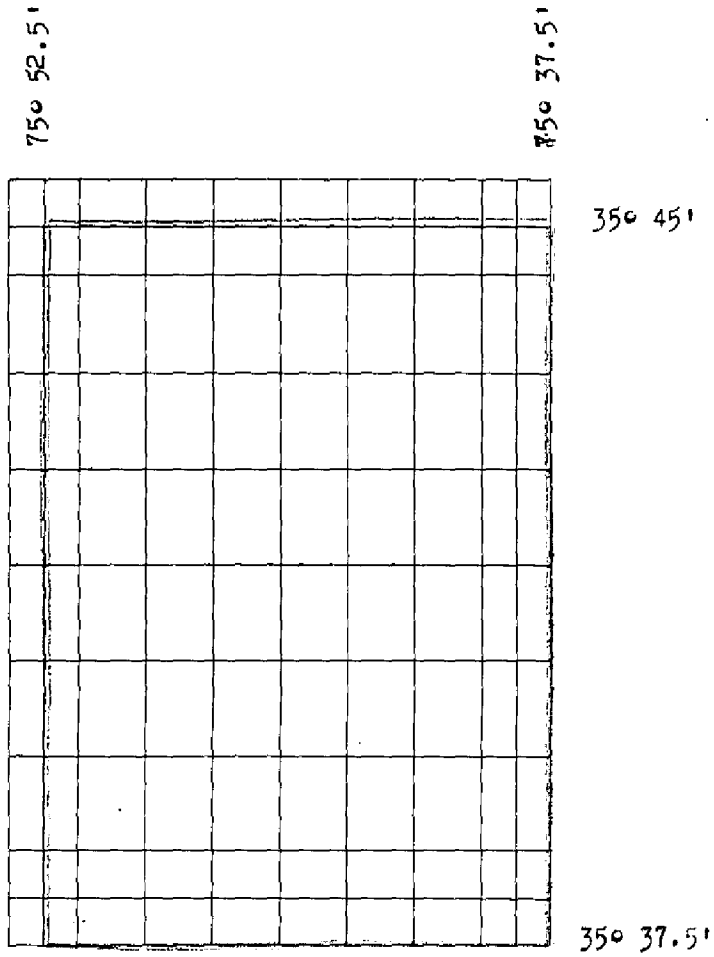

Areas contoured by various personnel  
 (Show name within area)  
 (II) (III)

## DATA RECORD

Field Inspection by (II): **R.L. McGlinchey, Cartographic Survey Aid** Date: **March 1951**  
**R.E. Conway Jr. Cartographic Survey Aid** August 1950

Planetable contouring by (II): *above personnel* Date: *"*

Completion Surveys by (II): *R. L. McGlinchey* Date: *March 1953*

Mean High Water Location (III) (State date and method of location):  
~~Air Photo Compilation~~ ~~August 1950~~  
*identified in field on photographs taken in 1948 and 1949*

Projection and Grids ruled by (IV): **L. B. C. (W.O.)** Date: **12 July 1951**

Projection and Grids checked by (IV): **H. D. W. (W.O.)** Date: **13 July 1951**

Control plotted by (III): **R. J. Pate** Date: **27 July 1951**

Control checked by (III): **I. I. Saperstein** Date: **30 July 1951**

Radial Plot or Stereoscopic Control extension by (III): **M. M. Slavney** Date: **17 Oct. 1951**

Planimetry  
 Stereoscopic Instrument compilation (III): **Inapplicable** Date:  
 Contours Date:

Manuscript delineated by (III): **R. R. Wagner** Date: **18 Jan. 1952**

Photogrammetric Office Review by (III): **J. A. Giles** Date: **1 April 1952**

Elevations on Manuscript  
 checked by ~~///~~ (III): **J. A. Giles** Date: **17 Jan. 1952**



Camera (kind or source) (III): **USC&GS - Nine-lens, 8 $\frac{1}{4}$ " focal length  
Fairchild Cartographic 6" Metrogon lens Camera "0"**  
PHOTOGRAPHS (III)

Number	Date	Time	Scale	Stage of Tide
22110	29 March 1948	11:45	1:20,000	No periodic tide
22111	"	11:46	"	"
22112	"	11:47	"	" Negligible. <i>SHR</i>
48-0-1709	5 Dec. 1949	11:41	"	"
1710	"	11:42	"	"
1711	"	11:43	"	"
1712	"	11:44	"	"
1713	"	11:45	"	"
1714	"	11:46	"	"
1739 to	"	12:19	"	"
1741	"	12:19	"	"
1742	"	12:20	"	"

Tide (III)

Reference Station:  
Subordinate Station:  
Subordinate Station:

~~No periodic tide~~ *SHR*  
*Less than 1/4 foot.*

Ratio of Ranges	Mean Range	Spring Range

Washington Office Review by (IV): *Everett H. Ramey*

Date: *4 Jan 1954*

Final Drafting by (IV):

*ALBury*

Date: *12/21/54*

Drafting verified for reproduction by (IV):

*W. H. Hallum*

Date: *1-10-55*

Proof Edit by (IV):

*Everett H. Ramey*

Date: *25 Feb 1955*

Land Area (Sq. Statute Miles) (III): 54

Shoreline (More than 200 meters to opposite shore) (III): 8

Shoreline (Less than 200 meters to opposite shore) (III): 2

Control Leveling - Miles (II): 11 (Third Order)

Number of Triangulation Stations searched for (II): 4

Recovered: 2

Identified: 2

Number of BMs searched for (II):

Recovered:

Identified:

Number of Recoverable Photo Stations established (III): 2

Number of Temporary Photo Hydro Stations established (III): None

Number of Bench Marks established 13

Recovered 12

Identified 12

Remarks:

**PH-45 (49)**

**NORTH CAROLINA, Vicinity of Albemarle Sound**

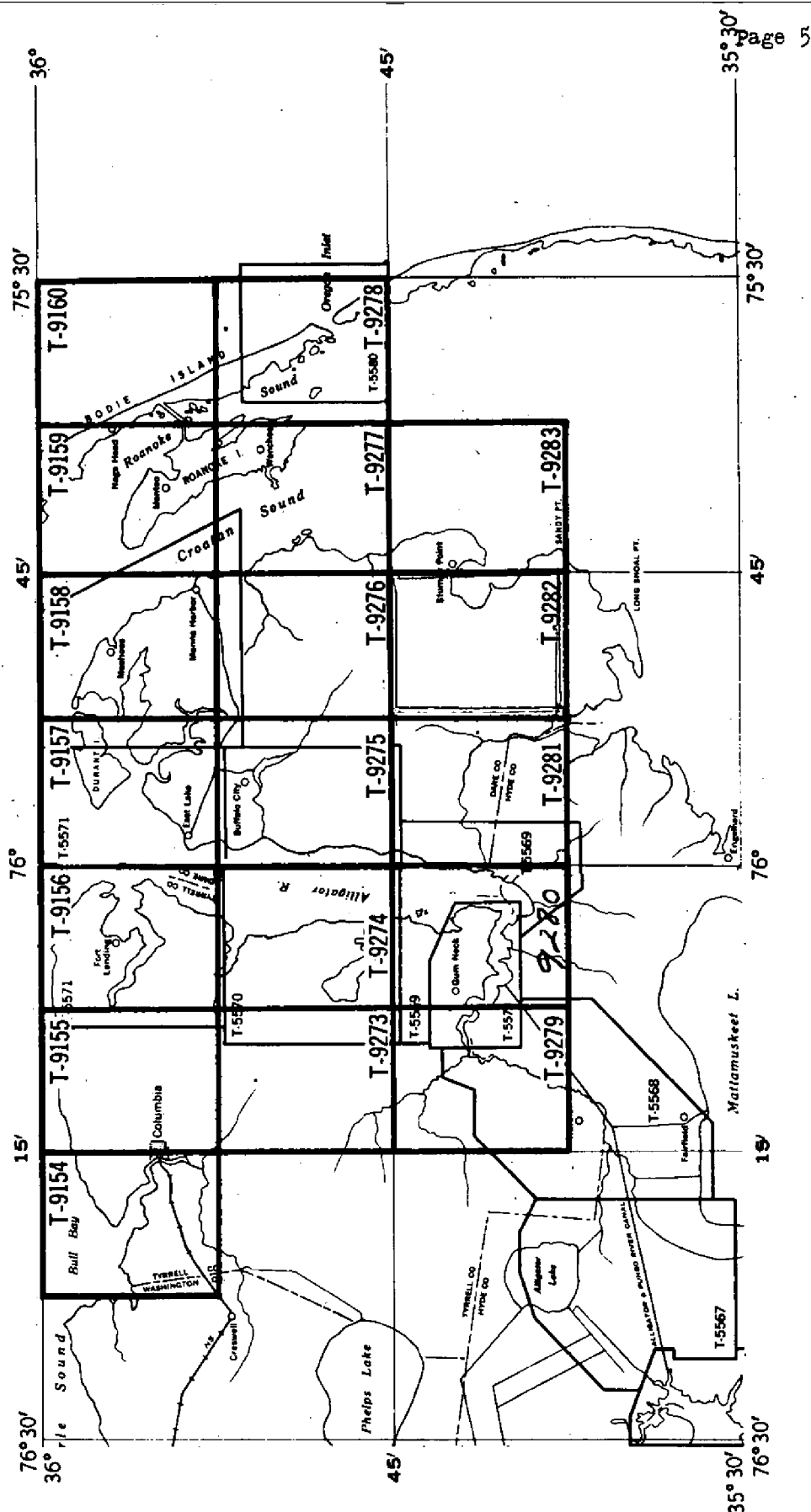



FIELD INSPECTION REPORT

Quadrangle T-9282  
35°-37'-30"/75°-45'-00"  
Project Ph-45(49)

Harry F. Garber, Chief of Party

The field work for this quadrangle was done in accordance with Instructions for Ph-45(49), dated 19 January 1950, and the Director's letter, dated 4 October 1950. Field work was done by the following personnel:

<u>Name and Title</u>	<u>Phase</u>	<u>Date</u>
Ralph G. Holland Topographic Engineer	Horizontal Control and Recovery	May, 1950
Richard L. McGlinchey Cartographic Survey Aid	"	February, 1951
Richard E. Conway, Jr. Cartographic Survey Aid	Shoreline Inspection	August, 1950
John R. Smith Cartographic Survey Aid	Vertical Control	November, 1949

This report is written in accordance with paragraph 724 of the Topographic Manual (Special Publication No. 249).

2. AREAL FIELD INSPECTION

This quadrangle lies in the southernmost part of Dare County, along the western shore of Stumpy Point Bay. U. S. Highway 264, running north and south through the eastern portion of the quadrangle, is the only road. About 90% of the area is woodland and swamp, and 10% water. Fishing and lumbering, done on a small scale, are the only industries. There are no incorporated towns or villages within the quadrangle and only a few dwellings in the northeast area.

Some difficulty was encountered in the interpretation of the photographs in the southern portion of the quadrangle. This is probably due to the fact that the photographs were taken three years

prior to the Field Inspection. Areas showing lighter tones, usually denoting reeds, grass or open areas, now have a heavy growth of bushes and second growth pine. Sufficient classification was done in accessible areas so that the tone interpretation could be carried through those large areas which are inaccessible. No difficulty was encountered in the northern portions of the quadrangle or that area covered by single lens photographs.

The field inspection is believed to be complete.

### 3. HORIZONTAL CONTROL

(a) (1) A traverse line was run along U. S. Highway 264 and three control points established. The traverse was begun at station M1 (USE) and ran southward for about 4 miles to traverse station NSA 13, closing on a sun azimuth. As the companion monument M2 (USE) could not be recovered, the azimuth of the line N1 (USE) - N2 (USE) was carried to station M1 (USE) by observing horizontal angles along the highway. A position check was made at Metropolitan R.M. 1, 1933, along the traverse line with a very small error of closure. No adjustment was made. One sheet, Form 709, listing all stations along this traverse line, is submitted with this report. See § 67

(2) A short traverse line of approximately 8000 feet was run southward from Pipe Station N1 (USE) to sub point No. 2, to establish a fix for photograph 49-0-1742. Complete data for this traverse is submitted on form M-2226-12. See § 67

(b) All stations are of the N.A. 1927 datum.

(c) Stations not established by the U.S. C. & G.S. are:

<u>Station</u>	<u>Agency</u>	<u>Order</u> *	<u>Datum</u>
M1	U.S.E.	Unknown	1927

\* Published as third order. 2/22

(d) A search was made for all known control. Stations reported as "Lost" or "Not Recovered" are:

M2 (USE)  
 Metropolitan, 1933  
 N.C.G.S. 260 (See F. I. Report for T-8976, Ph-20(47))  
 N.C.G.S. 258 (See F. I. Report for T-8976, Ph-20(47))

### 4. VERTICAL CONTROL

A third order level line, originating at Pinetown and closing at <sup>Mackey's</sup> Columbia, was run along U. S. Highway 264 with bench marks established at approximately one mile intervals. This line was adjusted by the Washington Office.



prior to the Field Inspection. Areas showing lighter tones, usually denoting reeds, grass or open areas, now have a heavy growth of bushes and second growth pine. Sufficient classification was done in accessible areas so that the tone interpretation could be carried through those large areas which are inaccessible. No difficulty was encountered in the northern portions of the quadrangle or that area covered by single lens photographs.

The field inspection is believed to be complete.

### 3. HORIZONTAL CONTROL

(a) (1) A traverse line was run along U. S. Highway 264 and three control points established. The traverse was begun at station M1 (USE) and ran southward for about 4 miles to traverse station NSA 13, closing on a sun azimuth. As the companion monument M2 (USE) could not be recovered, the azimuth of the line N1 (USE) - N2 (USE) was carried to station M1 (USE) by observing horizontal angles along the highway. A position check was made at Metropolitan R.M. 1, 1933, along the traverse line with a very small error of closure. No adjustment was made. One sheet, Form 709, listing all stations along this traverse line, is submitted with this report. See 867

(2) A short traverse line of approximately 8000 feet was run southward from Pipe Station N1 (USE) to sub point No. 2, to establish a fix for photograph 49-O-1742. Complete data for this traverse is submitted on form M-2226-12. See 867

(b) All stations are of the N.A. 1927 datum.

(c) Stations not established by the U.S. C. & G.S. are:

<u>Station</u>	<u>Agency</u>	<u>Order</u> *	<u>Datum</u>
M1	U.S.E.	Unknown	1927

\* Published as third order. 2/6/72

(d) A search was made for all known control. Stations reported as "Lost" or "Not Recovered" are:

M2 (USE)  
Metropolitan, 1933  
N.C.G.S. 260 (See F. I. Report for T-8976, Ph-20(47))  
N.C.G.S. 258 (See F. I. Report for T-8976, Ph-20(47))

### 4. VERTICAL CONTROL

A third order level line, originating at Pinetown and closing at <sup>Mackey's</sup> Columbia, was run along U. S. Highway 264 with bench marks established at approximately one mile intervals. This line was adjusted by the Washington Office.



Bench Marks established by this party are:

<u>Name</u>	<u>Agency</u>	<u>Order</u>
U-246, 1949	U. S. C. & G. S.	Third
V-246, 1949	"	"
Z-246, 1949	"	"
A-247, 1949	"	"
B-247, 1949	"	"
C-247, 1949	"	"
D-247, 1949	"	"
Metropolitan R.M. 1	"	"
Metropolitan R.M. 3	"	"
Pipe Station M1 (USE)	"	"
G-247, 1949	"	"
H-247, 1949	"	"
<del>J-247, 1949</del>	<del>"</del>	<del>"</del>
<del>E-247, 1949</del>	<del>"</del>	<del>"</del>

*T-9276  
Tampa.*

Bench marks reported destroyed are:

B-247, 1949

There is no other known vertical control within the quadrangle.

No supplemental elevations were run within the quadrangle.

#### 5. CONTOURS AND DRAINAGE

In accordance with Bureau Letter No. 711 rs, dated 4 October 1950, no attempt was made to establish elevations in the dismal swamps that are so inaccessible. It is recommended that this map be published as a quadrangle type map. Elevations along the roads that are slightly higher than the adjoining land, and elevations in the cultivated areas corroborated by photo interpretation and a visual inspection conclusively prove that none of the land is above five feet, and no five-foot contour exists. (Copy of Bureau Letter 711 rs, dated 4 October 1950 is attached to the report for T-9274.)

*See §34*

Drainage is generally toward the east into Stumpy Point Bay and Pamlico Sound. Numerous ditches and a low area exist in the southwest portion of the quadrangle, indicating some drainage into Long Shoal River. The entire quadrangle is of very low elevation and the water in the canals and ditches is controlled by the wind tides of Pamlico Sound.

#### 6. WOODLAND COVER

This is the subject of a special report covering four quadrangles: T-9275, T-9276, T-9281 and T-9282, submitted by Mr. George E. Varnadoe, Cartographic Engineer, dated 22 June 1951. *Report is included as part of this report*



## 7. SHORELINE AND ALONGSHORE FEATURES

This quadrangle is composed entirely of apparent shoreline. Most all of the shoreline is marsh with a two-foot bluff along portions of the shoreline in Stumpy Point Bay.

There is no periodic tide\* but the wind causes considerable change to the mean high water line. Sustained northerly winds will lower the water line in Stumpy Point Bay by two feet.

\* Tide is less than 1/4 foot. <sup>± 1/2</sup>

There are no docks, piers, landings, or cables within the quadrangle. Wise's Fish House, along the western shore of Stumpy Point Bay, is the most prominent shoreline feature.

## 8. OFFSHORE FEATURE

There were no offshore features noted during the field inspection.

## 9. LANDMARKS AND AIDS

(a) No landmarks for charts are recommended.

(b) No interior landmarks are recommended.

(c) There are no aeronautical aids within the quadrangle.

(d) Three fixed aids to navigation are recommended on form 567, only two of which are within the limits of this quadrangle. The third, Stumpy Point Bay Light, falls in quadrangle T-9283. Two photo points and a traverse station were used in cutting in these aids. As the result of this method, their position was not checked by a field plot. One photo point falling in T-9282 is submitted with this sheet. Sec 37

## 10. BOUNDARIES, MONUMENTS AND LINES

A special report on boundaries, Ph-45, has been submitted by Richard L. McGlinchey, Cartographic Survey Aid. Filed under project data in Div. of Photogrammetry.

One boundary monument, locating the State Fire Tower Reservation, has been located by the photo point method. This small reservation falls just outside the southern limits of this sheet.

Tower destroyed - Feb 1953 (Note by JEH on photo 22111B) . SWK

## 11. OTHER CONTROL

One topographic station, "LAKE, 1950", has been established along the southern shore of Stumpy Point Bay. Form M-2226-12 and Form 524 are submitted.



12. OTHER INTERIOR FEATURES

All roads and buildings have been classified in accordance with paragraphs 5441 and 5446 of the Topographic Manual. Two highway bridges over canals have been delineated on the photographs. These canals are navigable to skiffs only.

13. GEOGRAPHIC NAMES

This will be the subject of a "Special Report" <sup>\*</sup> which will be submitted at a later date.

*\* by Merle W. Smith. Filed in Geographic Names Section, Div. of Charts.*

14. SPECIAL REPORTS AND SUPPLEMENTAL DATA

With the exception of those items listed in paragraphs 10 and 13, there is no other special data for this sheet.

26 March 1951

Submitted by:

*Richard L. McGlinchey*  
Richard L. McGlinchey  
Cartographic Survey Aid

14 June 1951

Approved by:

*Harry F. Garber*  
Harry F. Garber  
Commander, USC&GS  
Chief of Party

SPECIAL REPORT ON WOODLAND COVER  
Project Ph-45(49)  
Quadrangles T-9275, T-9276, T-9281 and T-9282

The area that is covered by this report consists of nearly all of four 7-1/2 minute quadrangles. It is bound between Alligator River on the west, U. S. Highway 264 on the east and south, and U. S. Highway 64 on the north.

Except for these roads and waterways along the perimeter of the area, and one road approximately two miles in length, which extends into the northern section from U. S. Highway 64, the entire area is inaccessible by any mode of transportation except walking.

The area is low, and is composed of approximately seventy per cent swamp, ten per cent marsh, and/or bog, and twenty per cent upland trees.

The swamp trees are Juniper, Cypress, Black Gum, and Bay. The upland trees are predominantly Pine.

The roads are paralleled on one or both sides by canals, which were dug to obtain material for foundation. Other than these canals and two small creeks, there is practically no drainage in the area.

The areas adjacent to the roads and river were inspected on the ground. The interior was inspected from an airplane flying at a low altitude and at a slow speed. (N.B. The air inspection was made in May, 1951, which is the dry season. However, the writer spent approximately three hours flying over the area during the winter and spring of 1950 evaluating timber.) Appropriate notes and labels were applied to distinguish tones and confirm stereoscopic interpretation; hence, the stereoscope was employed to outline the areas of different classifications.

The upland trees are to be found adjacent to the roads in the east and south sections. The swamp extends from Alligator River in the west to this tree line while a large marsh (low spongy bog) lines in the southeast section, and is surrounded by trees. It will be noted that U.S. Highway 264 forms a "U" around the southern portion of this bog.

Fixing the line of demarcation between upland trees and true swamps required a nicety of judgment, as much of the woodland, varying from a narrow strip to a vast expanse, is marginal, being cyclically very wet and very dry, and supports a growth consisting of both swamp and upland trees, although neither growth seems to flourish. It is evident from observation and local information that the upland trees (pine) die during the cyclically wet year, while the swamp growth thrives, and while the swamp trees are

stunted, die or burn during the cyclically dry periods, the pine replenish themselves. This dividing line was governed by the class of vegetation that was predominant, thereby the marginal areas were usually classified as swamp.

22 June 1951  
Submitted by:

George E. Varnadoe  
Cartographic Engineer

25 June 1951  
Approved by:

*Very good report.*  
*EG*

Harry F. Garber  
Commander, USG&GS  
Chief of Party



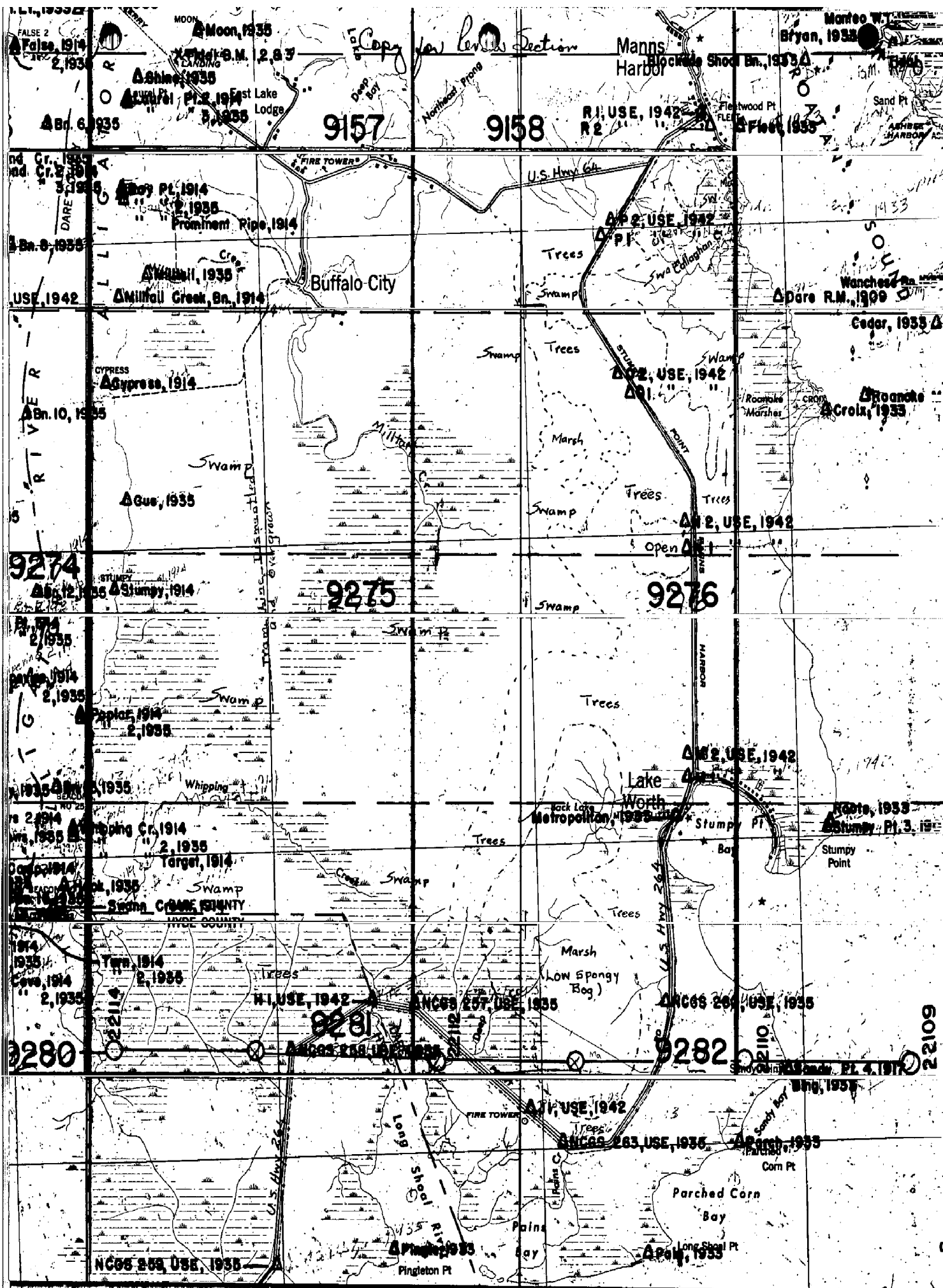

### Photogrammetric Plot Report

This report covers surveys T-9154 through T-9158, T-9273 through T-9276 and T-9279 through T-9283. It is filed as part of the Descriptive Report for T-9158.



MAP T. 9282

PROJECT NO. PH-45(49)

SCALE OF MAP 1:20,000

SCALE FACTOR ..... None

[illegible]

1 FT. = 3048006 METER

COMPUTED BY: **I.I. Saperstein**

DATE 19 Sept. 1951

CHECKED BY: **M. M. Slavney**

DATE:

24 Sept. 1951

M-2388-12



COMPILATION REPORT T-9282

PHOTOGRAMMETRIC PLOT REPORT.

Submitted with T-9158.

31. DELINEATION.

The graphic method was used.

The vegetation line <sup>delineated</sup> delimited by the field inspector was transferred to the manuscript by the use of the projector.

32. CONTROL.

The identification of control points was good. Density and placement were satisfactory.

33. SUPPLEMENTAL DATA.

None used.

34. CONTOURS AND DRAINAGE.

Elevations along the roads indicate a five-foot contour and it has been shown accordingly. Turning points are to be checked by the field editor. See §53

No difficulty was encountered in delineation of drainage.

35. SHORELINE AND ALONGSHORE DETAILS.

The shoreline inspection was adequate. See Item 7.

36. OFFSHORE DETAILS.

No statement.



37. LANDMARKS AND AIDS.

No unusual method was used.

38. CONTROL FOR FUTURE SURVEYS.

One (1) station, "KIND, 1949", was established during the compilation of T-8976, Ph-20(47). Form 524\* was submitted for it at that time. *\* Filed under T-9282.*

The total number of recoverable topographic stations is two (2). They are listed under Item 49.

39. JUNCTIONS.

T-9281 to the west - in agreement.

T-9276 to the north - in agreement.

T-9283 to the east - in agreement.

T-8976, Ph-20(47), to the south, ~~in agreement except for vegetation, to be corrected by the Washington Office.~~ *EHR*

40. HORIZONTAL AND VERTICAL ACCURACY.

No statement.

46. COMPARISON WITH EXISTING MAPS.

Comparison was made with U. S. Corps of Engineers Quadrangle ROANOKE ISLAND, N. C., scale 1:125,000, dated 1942. The two are in good agreement.

*See 562*



47. COMPARISON WITH NAUTICAL CHARTS.

Comparison was made with USC&GS Chart 1229, scale 1:80,000, published December 1942, corrected to 4 December 1950. The two are in good agreement.

*See 865*

ITEMS TO BE APPLIED TO NAUTICAL CHARTS IMMEDIATELY.

None.

ITEMS TO BE CARRIED FORWARD.

None.

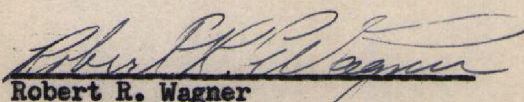
  
Robert R. Wagner  
Carto. Photo. Aid

APPROVED AND FORWARDED:

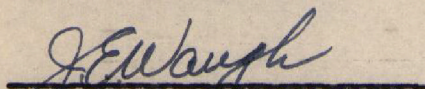
  
J. E. Waugh, Chief of Party



FIELD EDIT REPORT  
Project Ph-45(49)  
Quadrangle T-9282

51. METHODS

The field edit of this quadrangle was accomplished by traversing all roads, via truck, and walking to other areas in which the reviewer requested information, and for a general check on the adequacy of the map compilation.

Corrections and additions were made both by visual inspections and standard surveying methods.

All corrections, additions and deletions have been made on the field edit sheet and the discrepancy print.

A legend appears with the field edit sheet indicating the different color inks used for the various corrections.

The actual field work was accomplished during the second week of February, 1953.

52. ADEQUACY OF COMPILATION

The map compilation is adequate and will be complete after field edit data is applied.

*See 566*

53. MAP ACCURACY

The relative accuracy of all topographic features appears good.

*See 566*

Reference: Item 34, Field Inspection Report.

The turning points of contours along the roads were checked and properly shown in field edit sheet.

54. RECOMMENDATIONS

None.

55. EXAMINATION OF PROOF COPY

It is believed that Mr. Melvin Daniels, Dare County Registrar of Deeds, Manteo, North Carolina, or Mr. David Cox, Jr., Registered Land Surveyor, Hertford, North Carolina, is best qualified to examine a proof copy of this map.



The following Geographic Names were investigated in the field:

BACK LAKE - Name verified and recommended for mapping.

CASEY POINT  
KAZER POINT

KAZER POINT is recommended. The name CASEY and KAZER are mispronunciations of the recommended name.

*L Probably Kazey*

The following persons were consulted in the investigations:

Mr. G. P. Harris	Stumpy Point, N. C.	Fisherman
Mr. J. P. Williams	" " "	"
Mr. C. P. Mann	Manns Harbor, N. C.	"
Mr. G. P. Wise, Jr.	Stumpy Point, N. C.	"

#### 56. JUNCTIONS

Satisfactory junctions have been made with T-9283 on the east, and T-9276 on the north, also, T-9281 on the west. No junction was made with Project Ph-20(47) on the south.\*

\* Junctions with T-8976, Ph-20(47). *ENK*

13 March 1953  
Submitted by:

*Richard L. McGlinchey*  
Richard L. McGlinchey, *1st.*  
Cartographic Survey Aid

25 March 1953  
Approved by:

*Paul Taylor*  
Paul Taylor  
Lt. Comdr., USC&GS  
Chief of Party



50.

## PHOTOGRAMMETRIC OFFICE REVIEW

T. 9282

1. Projection and grids J.G. 2. Title J.G. 3. Manuscript numbers J.G. 4. Manuscript size J.G.

## CONTROL STATIONS

5. Horizontal control stations of third-order or higher accuracy M.M.S. 6. Recoverable horizontal stations of less than third-order accuracy (topographic stations) J.G. 7. Photo hydro stations XX 8. Bench marks J.G. 9. Plotting of sextant fixes J.G. 10. Photogrammetric plot report J.G. 11. Detail points J.G.

## ALONGSHORE AREAS

(Nautical Chart Data)

12. Shoreline J.G. 13. Low-water line XX 14. Rocks, shoals, etc. XX 15. Bridges XX 16. Aids to navigation J.G. 17. Landmarks XX 18. Other alongshore physical features J.G. 19. Other along-shore cultural features J.G.

## PHYSICAL FEATURES

20. Water features J.G. 21. Natural ground cover J.G. 22. Planetable contours J.G. 23. Stereoscopic instrument contours XX 24. Contours in general J.G. 25. Spot elevations J.G. 26. Other physical features J.G.

## CULTURAL FEATURES

27. Roads J.G. 28. Buildings J.G. 29. Railroads XX 30. Other cultural features J.G.

## BOUNDARIES

31. Boundary lines J.G. 32. Public land lines XX

## MISCELLANEOUS

33. Geographic names J.G. 34. Junctions J.G. 35. Legibility of the manuscript J.G. 36. Discrepancy overlay J.G. 37. Descriptive Report J.G. 38. Field inspection photographs J.G. 39. Forms J.G. 40. Jesse A. Giles William A. Rasura

Reviewer

Supervisor, Review Section or Unit

41. Remarks (see attached sheet)

## FIELD COMPLETION ADDITIONS AND CORRECTIONS TO THE MANUSCRIPT

42. Additions and corrections furnished by the field completion survey have been applied to the manuscript. The manuscript is now complete except as noted under item 43.

Compiler

Supervisor

43. Remarks: were applied. ENR

M-2623-12



T-9282. Geographic Names.

- ✓ North Carolina ✓
- ✓ Croatan Township ✓
- ✓ East Lake Township ✓
- ✓ Pamlico Sound ✓
- ✓ U.S. No. 264 ✓
- ✓ Engelhard-Stumpy Point Road (2 places) ✓
- ✓ Stumpy Point-Manns Harbor Road ✓
- ✓ Long Shoal River ✓
- ✓ Deep Creek ✓
- ✓ ~~Ossey Point~~ Kazer Pt. ✓
- ✓ Lake Worth ✓ (settlement)
- ✓ Back Lake ✓
- ✓ Stumpy Point ✓ (settlement)
- ✓ Stumpy Point Bay ✓
- ✓ The Full Gospel Tabernacle ✓
- ✓ Dare County ✓

Names underlined in red are  
approved.

6-24-52  
L. Heck

Names rechecked  
and approved  
12-29-53  
a.j.w.



49. NOTES FOR THE HYDROGRAPHER.

Recoverable topographic stations of use to the hydrographer  
are as follows:

KIND, 1949

LAKE, 1950



TO BE CHARTED  
~~TO BE DELETED~~

**STRIKE OUT ONE**

## NONFLOATING AIDS OR LANDMARKS FOR CHARTS

Tampa Photogrammetric Office, Tampa, Fla. 2 March 1952

I recommend that the following objects which have ~~(not been)~~ been inspected from seaward to determine their value as landmarks be charted on ~~(deleted from)~~ the charts indicated.

The positions given have been checked after listing by

Robert H. Wagner

1875 J. E. Waugh

*Chief of Party.*

J. R. W. W. W.

[illegible]

This form shall be prepared in accordance with Hydrographic Manual, pages 800 to 804. Positions of charted landmarks and *nonfloating aids* to navigation, if redetermined, shall be reported on this form. The data should be considered for the charts of the area and not by



## History of Hydrographic Information for T-9283

Hydrography was added to the map manuscript in accordance with General Specifications of 18 May 1949.

Depth curves and soundings are in feet at mean low water datum and originate with the following:

### Hydrographic surveys:

H-1180	1:20,000	1873
H-1362	1:20,000	1875-77
H-1363	1:40,000	1875-77

### Nautical Chart:

1229 1:80,000 1942 corrected to 53-8/21

Hydrography was compiled by Everett H. Ramey on 24 September 1954 and verified by O. Svendsen on 29 September 1954.

  
Everett H. Ramey



Review Report  
Topographic Map T-9282  
4 January 1954

62. Comparison with Registered Topographic Surveys.-

T-1385      1:20,000      1875

Differences as great as 60 meters exist in shoreline. Many cultural changes have occurred. Survey T-9282 is to supersede the above survey for nautical charting purposes for common areas between the surveys.

63. Comparison with Maps of Other Agencies.-

Roanoke Island, N.C. (C. of E.) 1943, 1:125,000,  
In general agreement.

64. Comparison with Contemporary Hydrographic Surveys.- None

65. Comparison with Nautical Charts.-

1229      1:80,000      1942 corr. to 53      8/24

Differences in shoreline discussed under sub heading 62 also apply to this chart.

66. Adequacy of Results and Future Surveys.- This map meets the National Standards of map accuracy and complies with project instructions. ✓

67. Horizontal Control.- Traverse referred to under sub-heading 3 is less than third-order in accuracy. It was used for controlling the photogrammetric plot, but was not retained on the manuscript. Forms M-2226-12 with positions in plane coordinates are filed in the General Files, Div. of Photogrammetry for these stations.

Reviewed by:

Everett H. Ramey  
Everett H. Ramey

APPROVED

L.C. Lande  
Chief, Review Branch  
Div. of Photogrammetry

H.R. Robinson  
Chief, Nautical Chart Branch  
Division of Charts *GRD*

W.W. Seaton  
Chief, Div. of Photogrammetry

Carl O. Heston  
Chief, Div. of Coastal Surveys

*June 22, 1955*