

9675

Diag. Cht. No. 1116-2.

Form 504

U. S. COAST AND GEODETIC SURVEY

DEPARTMENT OF COMMERCE

DESCRIPTIVE REPORT

Type of Survey Planimetric

Field No. Ph-90 Office No. T-9675

LOCALITY

State Louisiana

General locality Gulf Coast

Locality Bayou Pointe Au Chien

1945 52-57

CHIEF OF PARTY

E.H.Kirsch, Chief of Field Party

H.C.Applequist, Tampa Photo. Office

LIBRARY & ARCHIVES

DATE July 21, 1959

9675

DESCRIPTIVE REPORT - DATA RECORD

T - 9675

Project No. (II): **24200**

Quadrangle Name (IV):

Field Office (II): **Houma, La.**

Chief of Party: **B. H. Kirsch**

Photogrammetric Office (III): **Tampa, Fla.**

Officer-in-Charge: **H. C. Applequist**

Instructions dated (II) (III): **5 Sept. 1952**

Copy filed in Division of

**Supplement #1 25 Sept. 1952**

Photogrammetry (IV)

**Supplement #2 30 Sept. 1952**

Method of Compilation (III): **Graphic**

Manuscript Scale (III): **1:20,000**

OCT 19 1956

Stereoscopic Plotting Instrument Scale (III): **Inapplicable**

Scale Factor (III): **None**

Date received in Washington Office (IV):

Date reported to Nautical Chart Branch (IV):

Applied to Chart No.

Date:

Date registered (IV): **12/16/58**

Publication Scale (IV):

Publication date (IV):

Geographic Datum (III): **N. A. 1927**

Vertical Datum (III): **MHW**

~~Mean low water~~ except as follows:

Elevations shown as (25) refer to mean high water

Elevations shown as (5) refer to sounding datum

i.e., mean low water or mean lower low water

Reference Station (III): **GUPPY 1934**

Lat.: **29°22'30.526 (939.8m.)**

Long.: **90°26'12.059 (325.2m.)**

Adjusted  
~~Unclassified~~

Plane Coordinates (IV):

State:

Zone:

Y=

X=

Roman numerals indicate whether the item is to be entered by (II) Field Party, (III) Photogrammetric Office, or (IV) Washington Office.

When entering names of personnel on this record give the surname and initials, not initials only.

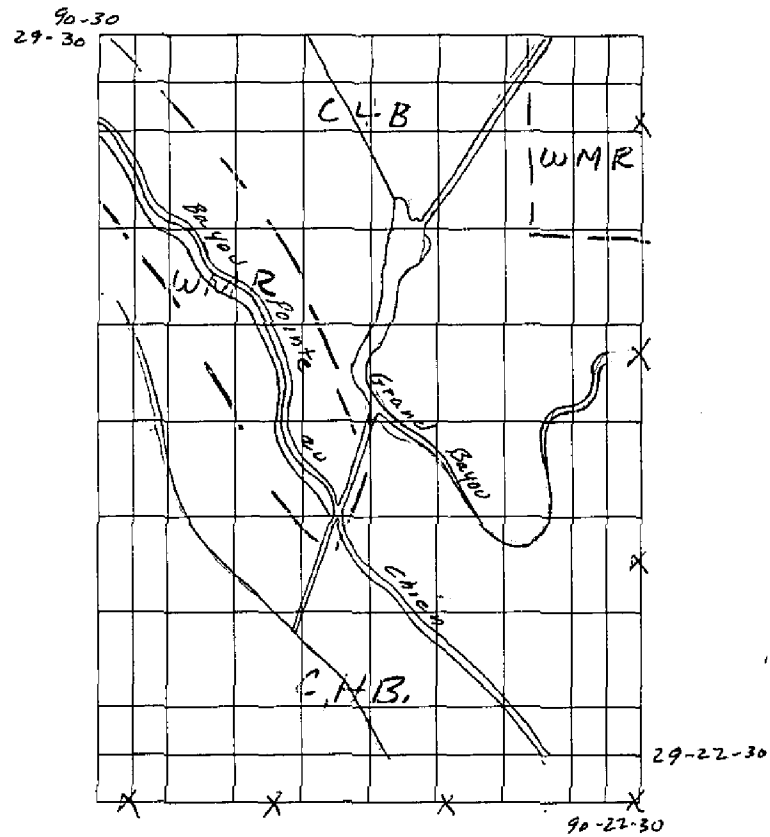

Areas contoured by various personnel  
(Show name within area)  
(II) (III)

DESCRIPTIVE REPORT - DATA RECORD

Field Inspection by (II): **C. H. Baldwin**  
**W. M. Reynolds**

Date: **Dec. 1952 to**  
**Feb. 1953**

Planetable contouring by (II): **Inapplicable**

Date:

Completion Surveys by (II): *Elgan T. Jenkins*

Date: *15 March 1957*

Mean High Water Location (III) (State date and method of location):

**Feb. 1953**  
**Air Photo Compilation**

Projection and Grids ruled by (IV): **J. Thuma (W.O.)**

Date: **27 Aug. 1953**

Projection and Grids checked by (IV): **H. D. Wolfe (W.O.)**

Date: **2 Sept. 1953**

Control plotted by (III): **R. R. Wagner**

Date: **19 Oct. 1954**

Control checked by (III): **R. J. Pate**

Date: **19 Oct. 1954**

Radial Plot on ~~Stereoscopic~~ **M. M. Slavney**  
~~Control extension~~ by (III):

Date: **15 Mar. 1956**

Stereoscopic Instrument compilation (III):  
Planimetry  
Contours **Inapplicable**

Date:

Date:

Manuscript delineated by (III): **R. R. Wagner**

Date: **10 Sept. 1956**

Photogrammetric Office Review by (III): **J. A. Giles**

Date: **14 Sept. 1956**

Elevations on Manuscript  
checked by (I) (III): **None**

Date:

## DESCRIPTIVE REPORT - DATA RECORD

Camera (kind or source) (III):

**C&GS Nine-lens Camera****Navy - MDA Single-lens Camera**

## PHOTOGRAPHS (III)

Number	Date	Time	Scale	Stage of Tide
MDA-23-26,27,28,29	8 Mar. 1952	1840	1:20,000	Inshore
39556	29 Sep. 1952	1046	"	"
39557	"	1047	"	"
39558	"	1049	"	"

*1956 Single-lens photography:**SB-W-4101 to and incl. 4106 23 Oct. 1956 1:30 OT**4137 " " " 4141 "**4180 " " " 4184 "**4240 " " " 4245 "*

Tide (III)

**Inshore**

Reference Station:

Subordinate Station:

Subordinate Station:

Washington Office Review by (IV):

*Josef J. Streifler*

Date:

*Oct. 1958*

Final Drafting by (IV):

Date:

Drafting verified for reproduction by (IV):

Date:

Proof Edit by (IV):

Date:

Land Area (Sq. Statute Miles) (III): **63**Shoreline (More than 200 meters to opposite shore) (III): **16**~~Shoreline (Less than 200 meters to opposite shore) (III):~~Control Leveling - Miles (II): **None**Number of Triangulation Stations searched for (II): **2**Recovered: **2**Identified: **2**Number of BMs searched for (II): **2**Recovered: **1**Identified: **1**Number of Recoverable Photo Stations established (III): **None**Number of Temporary Photo Hydro Stations established (III): **None**

Remarks:



Summary  
to accompany planimetric map T-9675

This is one of 37 planimetric and topographic quadrangles of project Ph-90 (6090). The project covers a part of the Mississippi River delta along the Gulf of Mexico. T-9675 falls south-east of Houma, Louisiana, and includes the center portion of Bayou Pointe au Chien, which divides Lafourche and Terrebonne Parishes.

The land area is almost all marsh, with scattered evidence of the exploration and development of gas and oil. Limited strips of land on both sides of Bayou Pointe au Chien and Bayou St. Jean Charles are under cultivation and practically all dwellings are clustered along afore-mentioned bayous. There is a road 5 connecting these two prominent features, which leads from State Highway No. 665.

All sheets of this project were compiled and scribed at the Tampa District Office. Originally from 1952 photography and 1953 field inspection, they were revised in 1957 to 1958 from 1956 single-lens photography and results of 1957 field edit. Only minor additions and corrections were applied during Washington Office Review to complete the final medium to obtain adequate reproduction of registration copy.

An additional copy will be forwarded to the U. S. Geological Survey to make the latest planimetry and revision of contours available to that agency for the publication of a new topographic quadrangle at the scale of 1:62500 (see instr. 30 Sept. 1952).

A cronar film positive at the compilation scale of 1:20000 and the Descriptive Report will be registered and filed in the Bureau Archives.

Oct. 1958

## 2. AREAL FIELD INSPECTION

The entire area is marsh except for a narrow strip parallel to either side of Bayou Point Au Chien. Small areas of these narrow strips are under cultivation; the chief crop being sugar cane.

Field inspection is believed to be complete and adequate with no items deliberately left for the field editor.

Photographic quality was good with no difficulty in interpretation.

All field work was done on the following photographs: Single Lens Navy MDA-23-026, -027 and -029 and Nine Lens Nos. 39556 through 39558.

## 3. HORIZONTAL CONTROL

No supplemental control was established.

Station TT64L is a U.S. Geological Survey Third-Order traverse station and is also a Coast and Geodetic Survey intersection station.

## 4. VERTICAL CONTROL

No supplemental vertical control was established.

Two third-order U.S. Geological Survey Bench Marks, TT64L and US 3.5 BM were recovered and identified.

## 5. CONTOURS AND DRAINAGE

A visual inspection of contours as shown on published Geological Survey quadrangle of the area was made for necessary revisions. No revisions were needed.

Drainage is adequately covered by the photographs.

## 6. WOODLAND COVER

Adequately covered by the photographs.

## 7. SHORELINE AND ALONGSHORE FEATURES

Shoreline of this area is solely that along the bayous and canals. Some of the shoreline along the bayous is fast and has been indicated as such on the photographs. The remainder of the shoreline is the edge of marsh and has also been indicated where necessary for correct interpretation.

The mean low water line is contiguous with the mean high water line throughout the area.

All alongshore features are adequately covered by the photographs.

8. OFFSHORE FEATURES

There are none.

9. LANDMARKS AND AIDS

There are none.

10. BOUNDARIES, MONUMENTS AND LINES

See "Special Report, Boundaries, Project Ph-90".

For public land lines data see "Special Report, Public Land Lines, Project Ph-90".

11. OTHER CONTROL

None was established.

12. OTHER INTERIOR FEATURES

The only road in this quadrangle is County Road 968 which enters the quadrangle in the northwest corner and parallels Bayou Pointe au Chien for approximately five miles. There is one side road which goes to a small settlement on Bayou St. Jean Charles. All roads, buildings and structures were classified on the photographs according to the instructions.

The Bayou Jean Lacroix Field of the Humble Oil and Refining Company is located in the quadrangle. A map of the field is being furnished which gives positions of several oil wells on the Louisiana State Plane Coordinate System, South Zone (Lambert).

The Lake Bully Camp Field of the Gulf Oil Company is located partially within the quadrangle. All producing wells in the field have been identified on the photographs.

The following data is tabulated for bridges over navigable waters:

<u>Location</u>	<u>Use</u>	<u>Type</u>	<u>Spans</u>	<u>Horizontal Clearance</u>			<u>Vertical Clearance</u>
				<u>Left</u>	<u>Center</u>	<u>Right</u>	<u>above MHW</u>
Unnamed canal Montegut, La	Hwy	Fixed	1	-	17.0 ft	-	14 ft
Pointe au Chien Foot Bayou, Montegut, La.	Pontoon	1	-	-	30.0 ft	-	0 ft
Montegut, La.	Foot	Swing	1	-	35.0 ft	-	2.5 ft

There is also an overhead transmission line across Bayou Pointe au Chien, with a vertical clearance of 36 feet above MHW.



13. GEOGRAPHIC NAMES

See "Special Report, Geographic Names, Project Ph-90."

14. SPECIAL REPORTS AND SUPPLEMENTAL DATA

Letter of Transmittal No. 90-7, "Special Report, Public Land Lines, Project Ph-90", forwarded to Washington Office 29 April 1953.

Letter of Transmittal, Public Land Lines data, forwarded to Washington Office 28 January 1953.

Letter of Transmittal No. 90-8, "Special Report, Geographic Names, Project Ph-90", to be forwarded to Washington Office at a later date.

Letter of Transmittal No. 90-9, "Special Report, Boundaries, Project Ph-90", to be forwarded to Washington Office at a later date.

Map, Bayou Jean Lacroix Field, Humble Oil & Refining Company.

Letter of Transmittal No. 90-21, Data, Quadrangle T-9675(    ),  
forwarded to Washington Office MAY 5 1953

Submitted  
5 May 1953

*William M. Reynolds*  
William M. Reynolds  
Cartographic Survey Aid

Approved & Forwarded

MAY 5 1953

*E. H. Kirsch*  
E. H. Kirsch  
Chief of Party

SCALE FACTOR

1 FT. = 3048006 METER	DATE	10/16/53	CHECKED BY:	J. Steinberg	DATE	10/21/53	COMM. DC-57843
COMPUTED BY:	B. Wilson						

COMPILATION REPORT T-9675

PHOTOGRAMMETRIC PLOT REPORT

Submitted with T-9865

31. DELINEATION

The graphic method was used.

The photographs were of poor scale.

A number of small bridges, shown by the field inspector on MDA-23-26 have been omitted from the manuscript because the bayou is not navigable and is narrow enough to be drafted with a single line.

32. CONTROL

Reference Photogrammetric Plot Report.

33. SUPPLEMENTAL DATA

None used.

34. CONTOURS AND DRAINAGE

Contours are inapplicable.

Drainage was delineated as photographed and indicated by the inspector.

35. SHORELINE AND ALONGSHORE DETAILS.

The shoreline inspection was adequate.

There are no low-water or shoal lines shown.

36. OFFSHORE DETAILS

None

37. LANDMARKS AND AIDS

Reference Item 9.

38. CONTROL FOR FUTURE SURVEYS

There are no topographic stations or photo-hydro control.

39. JUNCTIONS

Junctions have been made with T-9674 to the west, T-9676 to the east and T-9864 to the south. There is no contemporary survey to the north.

40. HORIZONTAL AND VERTICAL ACCURACY

No statement.

41. PUBLIC LAND LINES

The sources of Public Land Lines are General Land Office plats, a survey made by T. Baker Smith of Townships T18S - R20 and 21E; T19S - R20 and 21E; and two survey maps of lands belonging to Delta Securities Company surveyed by Smith in T18S - R19E and T19S - R19E.

The maps of T18S - R19E and T19S - R19E, by Stanolind Oil and Gas Company, do not agree with Delta Securities Company maps in Sections 17, 26, 29 and 31:

The Stanolind Company section lines in these sections agree better with the topography on the G.L.O. plats. However, these sections do not make proper ties when projected across unsurveyed areas to the sections on the west side of the township.

The Delta Company surveyed across the areas that are unsurveyed on the Stanolind Company maps and make good ties.

Since G.L.O. has accepted some of the Smith surveys and they follow some lines on the photographs, the Delta Company maps were used.

In using control on T-9674 working eastward, control on T-9676 working westward and control on T-9864 working north, a distance of about 560 feet short was found on range line between R19 and 20E. This discrepancy should be resolved by the Bureau of Land Management.

On the survey map by Smith, not all the sections are shown in a standard township. Where this was the case and the overall distances were given, the remaining sections were equally divided and shown on the ozalid section line discrepancy print.

46. COMPARISON WITH EXISTING MAPS

Comparison was made with C&GS Planimetric Map T-9296, scale 1:20,000, dated 1932 and USGS Quadrangle LAKE FELICITY, LOUISIANA, scale 1:62,500, edition of 1944. The only changes appear to be new canals dredged by the oil companies.

47. COMPARISON WITH NAUTICAL CHARTS

Comparison was made with C&GS Nautical Chart 1050, scale 1:175,000, published October 1939, corrected to 23 June 1952. The two are in fair agreement. The maps listed under Item 46 appear to be the source of topography and the same differences exist.

ITEMS TO BE APPLIED TO NAUTICAL CHARTS IMMEDIATELY

None.

ITEMS TO BE CARRIED FORWARD

None.

  
Robert R. Wagner  
Carto Photo Aid

APPROVED & FORWARDED

*William A. Rasner*

for H. C. Applequist, Chief of Party

T-9675.

Geographic Names.

Bayou Blue

Bayou Bouillon

Bayou Jean Lacroix

Bayou Pointe au Chien (abbreviate as Pte, not Pt--see title)

Bayou St. Jean Charles

Bayou St. Louis

Bayou Salle

Canal St. Jean Charles

Cutoff Canal (not CutOff)

Grand Bayou

Grand Bayou Canal

Lafourche Parish

Lake Bully Camp

Live Oak School

Louisiana

Lower Pointe au Chien School

Pointe au Chien Church

St. Louis Canal

Terrebonne Parish

Viguerie Canal

On the new Terrebonne Parish Highway Map old No. 968 is now  
No. 665.

Names approved 11-28-66

L. Heck. *L.H.*

## PHOTOGRAMMETRIC OFFICE REVIEW

50.

T. 9675

1. Projection and grids JG 2. Title JG 3. Manuscript numbers JG 4. Manuscript size JG

## CONTROL STATIONS

Classification label

Unclassified

5. Horizontal control stations of third-order or higher accuracy MMS 6. Recoverable horizontal stations of less than third-order accuracy (topographic stations) XX 7. Photo hydro stations XX 8. Bench marks JG  
9. Plotting of sextant fixes XX 10. Photogrammetric plot report JG 11. Detail points JG

## ALONGSHORE AREAS

(Nautical Chart Data)

12. Shoreline JG 13. Low-water line XX 14. Rocks, shoals, etc. XX 15. Bridges JG 16. Aids to navigation XX 17. Landmarks XX 18. Other alongshore physical features JG 19. Other along-shore cultural features JG

## PHYSICAL FEATURES

20. Water features JG 21. Natural ground cover JG 22. Planetable contours XX 23. Stereoscopic instrument contours XX 24. Contours in general XX 25. Spot elevations XX 26. Other physical features JG

## CULTURAL FEATURES

27. Roads JG 28. Buildings JG 29. Railroads XX 30. Other cultural features JG

## BOUNDARIES

31. Boundary lines JG 32. Public land lines JG

## MISCELLANEOUS

33. Geographic names JG 34. Junctions JG 35. Legibility of the manuscript JG 36. Discrepancy overlay JG 37. Descriptive Report JG 38. Field inspection photographs JG 39. Forms JG

40. Jesse A. Giles Reviewer William A. Rasure  
Supervisor, Review Section or Unit  
William A. Rasure

41. Remarks (see attached sheet)

## FIELD COMPLETION ADDITIONS AND CORRECTIONS TO THE MANUSCRIPT

42. Additions and corrections furnished by the field completion survey have been applied to the manuscript. The manuscript is now complete except as noted under item 43.

Compiler

Supervisor

43. Remarks:

M-2623-12



FIELD EDIT REPORT  
MAP T-9675

51. METHODS

Field edit was done accordance with standard accepted practice and instructions as modified by:

(a) Bureau letter 711-lmh to Tampa District Office, subject: Field Edit-Project 24200 (Ph-90), Topographic and planimetric maps-Louisiana Coast, dated 2 January 1957.

(b) Bureau letter 711-lmh to Tampa District Office, subject: Location of Oil Wells-Project 24200 (Ph-90), dated 20 January 1957.

(c) Bureau letter 73-dmm to Chief, Photogrammetric Party No. 1, subject: Field Edit-Project 24200 (Ph-90), Louisiana, dated 20 February 1957.

Additions and corrections have been shown with red ink on the 1956 photographs numbered 56-W-4141, and -4243.

Deletions were all made with green ink on the field edit sheet.

Notes have been made stating the color inks used on the photographs, the field edit sheet and the discrepancy print.

52. ADEQUACY OF COMPILATION

The compilation is near adequate and will be complete with the application of the field edit data and the other identifiable features on the 1956 photography.

53. MAP ACCURACY

No test of any type, for horizontal accuracy, was made of this map.

54. RECOMMENDATIONS

None offered.

55. EXAMINATION OF PROOF COPY

Mr. C. E. Bridges, Chief Civil Engineer, of the Louisiana Land and Exploration Company, P. O. Box 231, Houma, Louisiana has agreed to have his office examine a proof copy of any maps of this project

that may be submitted to him. The Louisiana Land and Exploration Company owns about 25% of the land within the limits of this project and have men that are familiar with the area that patrol this property.

Mr. Bridges office is highly interested in seeing accurate maps published of the area and are willing to have their office and field men examine the maps for any discrepancies that may exist in geographic names and other pertinent details.

Submitted 15 March 1957

*Elgan T. Jenkins*  
Elgan T. Jenkins  
Cartographer

Approved:

*Ira R. Rubottom*  
Ira R. Rubottom  
Chief of Party

Review Report of  
Planimetric Map T-9675  
October 1958

62. COMPARISON WITH REGISTERED TOPOGRAPHIC SURVEYS:

T-5296      1:20000      1934

Additional cultural features (roads and buildings) and many dredged canals since the date of 1934 have made above listed topographic survey obsolete. Subject survey is to supersede T-5296 for nautical charting purposes of common areas.

63. COMPARISON WITH MAPS OF OTHER AGENCIES:

LAKE FELICITY, LA.,      1:62500 Ed. of 1944, U. S. Geological  
Survey

This topographic quadrangle was surveyed in 1939 and indicates differences as listed under afore-going item (No. 62).

64. COMPARISON WITH CONTEMPORARY HYDROGRAPHIC SURVEYS:

None of this area!

65. COMPARISON WITH NAUTICAL CHARTS:

1050      1:175000      Revised to 58 5/12

There are some differences noted between these two surveys: In consideration of the scale difference and the inland position of subject area, these detail differences are not critical. It is suggested, however, that the new road and some of the additional canals be considered for application to this nautical chart at some future time.

66. ADEQUACY OF RESULTS AND FUTURE SURVEYS:

This survey appears accurate and adequate for planimetric map standards.

Reviewed by

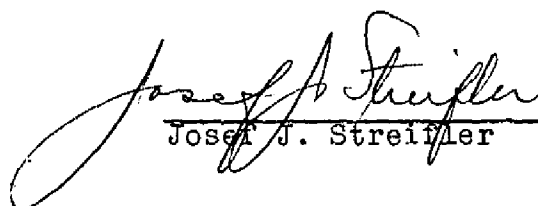
  
Joseph J. Streifler

APPROVED BY:

L. C. Lande  
Chief, Review & Drafting Section  
Photogrammetry Division

Max B. Kelso  
Chief, Nautical Chart Branch  
Charts Division

L. W. Swanson  
Chief, Photogrammetry Division  
14 July 39

W. B. Schull  
Chief, Coastal Surveys Division

## NAUTICAL CHARTS BRANCH

SURVEY NO. T-9675

## Record of Application to Charts

[illegible]

M-2168-1

A basic hydrographic or topographic survey supersedes all information of like nature on the uncorrected chart. Give reasons for deviations, if any, from recommendations made under "Comparison with Charts" in the Review.