

TP-00017

NOAA FORM 76-35

U.S. DEPARTMENT OF COMMERCE
NATIONAL OCEANIC AND ATMOSPHERIC ADMINISTRATION
NATIONAL OCEAN SURVEY

DESCRIPTIVE REPORT

Type of Survey Shoreline
Job No. PH-6912 Map No. TP-00017
Classification No. Edition No. 1
Field Edited Map

LOCALITY

State Florida
General Locality Estero Bay
Locality Imperial River

19 69 TO 19 70

REGISTRY IN ARCHIVES

DATE

MAP NOT INSPECTED IN QUALITY CONTROL PRIOR
TO REGISTRATION

NOAA FORM 76-36A (3-72)		U. S. DEPARTMENT OF COMMERCE NATIONAL OCEANIC AND ATMOSPHERIC ADMIN.	
DESCRIPTIVE REPORT - DATA RECORD		TYPE OF SURVEY <input checked="" type="checkbox"/> ORIGINAL <input type="checkbox"/> RESURVEY <input type="checkbox"/> REVISED	
PHOTOGRAMMETRIC OFFICE Coastal Mapping Division (Norfolk)		SURVEY TP. <u>00017</u> MAP EDITION NO. (1) MAP CLASS <u>FINAL(F.E.)</u> JOB PH. <u>6912</u>	
OFFICER-IN-CHARGE Jeffrey G. Carlen, CDR		LAST PRECEDING MAP EDITION TYPE OF SURVEY <input type="checkbox"/> ORIGINAL <input type="checkbox"/> RESURVEY <input type="checkbox"/> REVISED JOB PH. _____ MAP CLASS _____ SURVEY DATES: 19__ TO 19__	
I. INSTRUCTIONS DATED			
1. OFFICE		2. FIELD	
June 13, 1969 June 24, 1969 Aug. 8, 1969 Sept. 8, 1969 Oct. 21, 1969		April 28, 1969 March 11, 1970	
II. DATUMS			
1. HORIZONTAL: <input checked="" type="checkbox"/> 1927 NORTH AMERICAN		OTHER (Specify)	
2. VERTICAL: <input checked="" type="checkbox"/> MEAN HIGH-WATER <input checked="" type="checkbox"/> MEAN LOW-WATER <input type="checkbox"/> MEAN LOWER LOW-WATER <input type="checkbox"/> MEAN SEA LEVEL		OTHER (Specify)	
3. MAP PROJECTION Polyconic		4. GRID(S) STATE <u>Florida</u> ZONE <u>West</u>	
5. SCALE 1:10,000		STATE _____ ZONE _____	
III. HISTORY OF OFFICE OPERATIONS			
OPERATIONS		NAME	DATE
1. AEROTRIANGULATION BY METHOD: <u>Analytic</u> LANDMARKS AND AIDS BY		<u>Robert Kelly</u>	<u>Aug. 1969</u>
2. CONTROL AND BRIDGE POINTS PLOTTED BY METHOD: <u>Coradomat</u> CHECKED BY			
3. STEREOSCOPIC INSTRUMENT PLANIMETRY BY COMPILATION CHECKED BY INSTRUMENT: <u>Wild B-8</u> CONTOURS BY SCALE: <u>1:20,000</u> CHECKED BY		<u>A.L. Shands</u> <u>C.H. Bishop</u> <u>NA</u> <u>NA</u>	<u>Jan. 1970</u> <u>Feb. 1970</u>
4. MANUSCRIPT DELINEATION PLANIMETRY BY CHECKED BY METHOD: <u>Smooth ink drafting</u> CONTOURS BY CHECKED BY SCALE: <u>1:10,000</u> HYDRO SUPPORT DATA BY CHECKED BY		<u>B.L. Barge</u> <u>C.H. Bishop</u> <u>NA</u> <u>NA</u> <u>B.L. Barge</u> <u>C.H. Bishop</u>	<u>Jan. 1970</u> <u>Feb. 1970</u> <u>Jan. 1970</u> <u>Feb. 1970</u>
5. OFFICE INSPECTION PRIOR TO FIELD EDIT BY		<u>C.H. Bishop</u>	<u>Feb. 1970</u>
6. APPLICATION OF FIELD EDIT DATA BY		<u>A.L. Shands</u>	<u>Sept. 1971</u>
7. COMPILATION SECTION REVIEW BY		<u>R.R. White</u>	<u>Sept. 1971</u>
8. FINAL REVIEW BY		<u>C. Bishop - R. White</u>	<u>2/70-9/71</u>
9. DATA FORWARDED TO PHOTOGRAMMETRIC BRANCH BY		<u>Billy H. Barnes</u>	<u>July, 1975</u>
10. DATA EXAMINED IN PHOTOGRAMMETRIC BRANCH BY			
11. MAP REGISTERED - COASTAL SURVEY SECTION BY		<u>N. Francis</u>	<u>9/24/75</u>

TP-00017
COMPILATION SOURCES

1. COMPILATION PHOTOGRAPHY

CAMERA(S) Wild RC-8 "L"		TYPES OF PHOTOGRAPHY LEGEND X (C) COLOR (P) PANCHROMATIC X (I) INFRARED		TIME REFERENCE	
TIDE STAGE REFERENCE St. Petersburg, Fl. <input checked="" type="checkbox"/> PREDICTED TIDES (Carlos Point) <input type="checkbox"/> REFERENCE STATION RECORDS <input type="checkbox"/> TIDE CONTROLLED PHOTOGRAPHY				ZONE Eastern MERIDIAN 75th	<input checked="" type="checkbox"/> STANDARD <input type="checkbox"/> DAYLIGHT
NUMBER AND TYPE	DATE	TIME	SCALE	STAGE OF TIDE	
69L(I) 9308R & 9309R	6/1/69	07:56	1:20,000	2.5 ft. above MLW	
69L(I) 9316R & 9317R	6/1/69	08:05	1:20,000	2.5 ft. above MLW	
69L(C) 9350 - 9352	6/1/69	08:21	1:20,000	2.7 ft. above MLW	
69L(C) 9358	6/1/69	08:31	1:20,000	2.7 ft. above MLW	
69L(C) 9494 - 9497	6/4/69	08:00	1:40,000	1.8 ft. above MLW	

REMARKS All photo time has been converted from Eastern Daylight Time to Eastern Standard Time.

2. SOURCE OF MEAN HIGH-WATER LINE:

Photographs dated June 4, 1969 and field edit photos taken May 31, 1969.

3. SOURCE OF MEAN LOW-WATER OR MEAN LOWER LOW-WATER LINE:

None compiled.

4. CONTEMPORARY HYDROGRAPHIC SURVEYS (List only those surveys that are sources for photogrammetric survey information.)

SURVEY NUMBER	DATE(S)	SURVEY COPY USED	SURVEY NUMBER	DATE(S)	SURVEY COPY USED

5. FINAL JUNCTIONS

NORTH	EAST	SOUTH	WEST
No Survey	No Survey	TP-00018	TP-00016

REMARKS

TP-00017
HISTORY OF FIELD OPERATIONSI. ☒ FIELD INSPECTION OPERATION☐ FIELD EDIT OPERATION

OPERATION	NAME	DATE
1. CHIEF OF FIELD PARTY	W.H. Shearouse	May 1969
2. HORIZONTAL CONTROL	RECOVERED BY W.H. Shearouse ESTABLISHED BY NA PRE-MARKED OR IDENTIFIED BY W.H. Shearouse	May 1969
3. VERTICAL CONTROL	RECOVERED BY NA ESTABLISHED BY NA PRE-MARKED OR IDENTIFIED BY NA	
4. LANDMARKS AND AIDS TO NAVIGATION	RECOVERED (Triangulation Stations) BY NA LOCATED (Field Methods) BY NA IDENTIFIED BY NA	
5. GEOGRAPHIC NAMES INVESTIGATION	TYPE OF INVESTIGATION <input type="checkbox"/> COMPLETE <input type="checkbox"/> SPECIFIC NAMES ONLY BY <input checked="" type="checkbox"/> NO INVESTIGATION	
6. PHOTO INSPECTION	CLARIFICATION OF DETAILS BY NA	
7. BOUNDARIES AND LIMITS	SURVEYED OR IDENTIFIED BY NA	

II. SOURCE DATA

1. HORIZONTAL CONTROL IDENTIFIED

2. VERTICAL CONTROL IDENTIFIED

NA

PHOTO NUMBER	STATION NAME	PHOTO NUMBER	STATION DESIGNATION
69L(C) 9485	AIR, 1928		

3. PHOTO NUMBERS (Clarification of details)

NA

4. LANDMARKS AND AIDS TO NAVIGATION IDENTIFIED

NA

PHOTO NUMBER	OBJECT NAME	PHOTO NUMBER	OBJECT NAME

5. GEOGRAPHIC NAMES: ☐ REPORT ☒ NONE6. BOUNDARY AND LIMITS: ☐ REPORT ☒ NONE

7. SUPPLEMENTAL MAPS AND PLANS

NA

8. OTHER FIELD RECORDS (Sketch books, etc. DO NOT list data submitted to the Geodesy Division)

C&GS Form 152

TP-00017
HISTORY OF FIELD OPERATIONSI. ☐ FIELD INSPECTION OPERATION☒ FIELD EDIT OPERATION

OPERATION	NAME	DATE
1. CHIEF OF FIELD PARTY	Joseph K. Wilson	July, 1970
2. HORIZONTAL CONTROL	RECOVERED BY Richard E. Kesselring	July, 1970
	ESTABLISHED BY NA	
	PRE-MARKED OR IDENTIFIED BY NA	
3. VERTICAL CONTROL	RECOVERED BY NA	
	ESTABLISHED BY NA	
	PRE-MARKED OR IDENTIFIED BY NA	
4. LANDMARKS AND AIDS TO NAVIGATION	RECOVERED (Triangulation Stations) BY NA	
	LOCATED (Field Methods) BY Richard E. Kesselring	7/3/70
	IDENTIFIED BY Richard E. Kesselring	7/3/70
5. GEOGRAPHIC NAMES INVESTIGATION	TYPE OF INVESTIGATION <input type="checkbox"/> COMPLETE <input type="checkbox"/> SPECIFIC NAMES ONLY BY <input checked="" type="checkbox"/> NO INVESTIGATION	NA
6. PHOTO INSPECTION	CLARIFICATION OF DETAILS BY NA	
7. BOUNDARIES AND LIMITS	SURVEYED OR IDENTIFIED BY NA	

II. SOURCE DATA

1. HORIZONTAL CONTROL IDENTIFIED

NA

2. VERTICAL CONTROL IDENTIFIED

NA

PHOTO NUMBER	STATION NAME	PHOTO NUMBER	STATION DESIGNATION

3. PHOTO NUMBERS (Clarification of details)

NA

4. LANDMARKS AND AIDS TO NAVIGATION IDENTIFIED

PHOTO NUMBER	OBJECT NAME	PHOTO NUMBER	OBJECT NAME
69L(c)9363	MICROWAVE TOWER Tower located by triangulation		

5. GEOGRAPHIC NAMES: ☐ REPORT ☒ NONE6. BOUNDARY AND LIMITS: ☐ REPORT ☒ NONE

7. SUPPLEMENTAL MAPS AND PLANS

None

8. OTHER FIELD RECORDS (Sketch books, etc. DO NOT list data submitted to the Geodesy Division)

Form 567	1 Form 266
Form 157	1 Form 269c
Form 744b	1 Sketch

TP-00017
RECORD OF SURVEY USE

I. MANUSCRIPT COPIES

COMPILATION STAGES			DATE MANUSCRIPT FORWARDED	
DATA COMPILED	DATE	REMARKS	MARINE CHARTS	HYDRO SUPPORT
Compilation complete pending field edit	Feb. 1970	Superseded	Feb. 1970	Feb. 1970
Field Edit applied Compilation complete	Sept. 1971	Class I Manuscript Superseded		
Final Review	Aug., 1975		Sept. 1975	

II. LANDMARKS AND AIDS TO NAVIGATION

1. REPORTS TO MARINE CHART DIVISION, NAUTICAL DATA BRANCH

NUMBER	CHART LETTER NUMBER ASSIGNED	DATE FORWARDED	REMARKS

2. ☐ REPORT TO MARINE CHART DIVISION, COAST PILOT BRANCH. DATE FORWARDED: _____
3. ☐ REPORT TO AERONAUTICAL CHART DIVISION, AERONAUTICAL DATA SECTION. DATE FORWARDED: _____

III. FEDERAL RECORDS CENTER DATA

1. ☐ BRIDGING PHOTOGRAPHS; ☐ DUPLICATE BRIDGING REPORT; ☐ COMPUTER READOUTS.
2. ☐ CONTROL STATION IDENTIFICATION CARDS; ☐ FORM NOS 567 SUBMITTED BY FIELD PARTIES.
3. ☐ SOURCE DATA (except for Geographic Names Report) AS LISTED IN SECTION II, NOAA FORM 76-36C.
ACCOUNT FOR EXCEPTIONS:
4. ☐ DATA TO FEDERAL RECORDS CENTER. DATE FORWARDED: _____

IV. SURVEY EDITIONS (This section shall be completed each time a new map edition is registered)

SECOND EDITION	SURVEY NUMBER TP - _____ (2)	JOB NUMBER PH - _____	TYPE OF SURVEY <input type="checkbox"/> REVISED <input type="checkbox"/> RESURVEY
	DATE OF PHOTOGRAPHY	DATE OF FIELD EDIT	MAP CLASS <input type="checkbox"/> II. <input type="checkbox"/> III. <input type="checkbox"/> IV. <input type="checkbox"/> V. <input type="checkbox"/> FINAL
THIRD EDITION	SURVEY NUMBER TP - _____ (3)	JOB NUMBER PH - _____	TYPE OF SURVEY <input type="checkbox"/> REVISED <input type="checkbox"/> RESURVEY
	DATE OF PHOTOGRAPHY	DATE OF FIELD EDIT	MAP CLASS <input type="checkbox"/> II. <input type="checkbox"/> III. <input type="checkbox"/> IV. <input type="checkbox"/> V. <input type="checkbox"/> FINAL
FOURTH EDITION	SURVEY NUMBER TP - _____ (4)	JOB NUMBER PH - _____	TYPE OF SURVEY <input type="checkbox"/> REVISED <input type="checkbox"/> RESURVEY
	DATE OF PHOTOGRAPHY	DATE OF FIELD EDIT	MAP CLASS <input type="checkbox"/> II. <input type="checkbox"/> III. <input type="checkbox"/> IV. <input type="checkbox"/> V. <input type="checkbox"/> FINAL

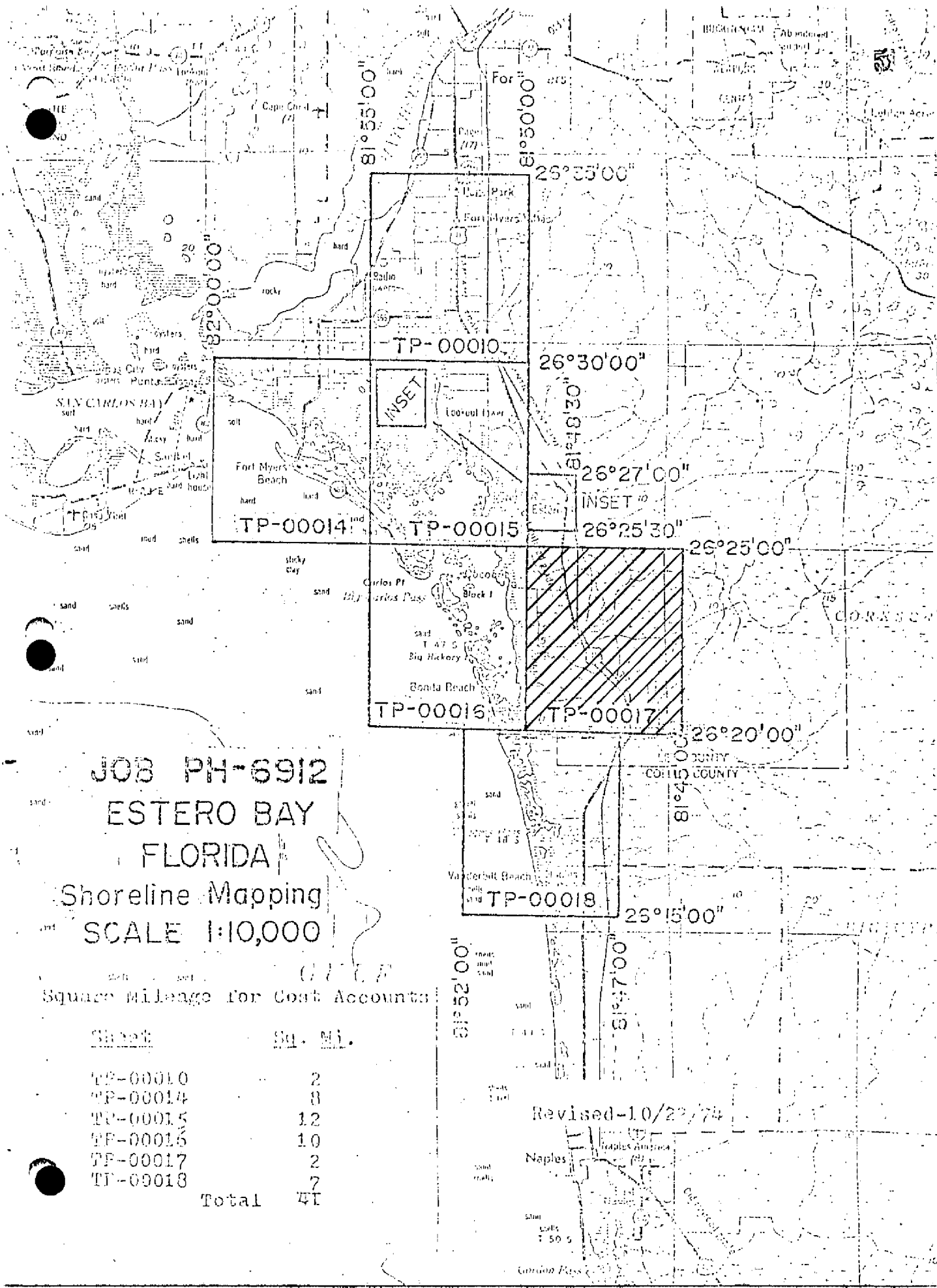

JOB PH-6912
ESTERO BAY
FLORIDA

Shoreline Mapping
 SCALE 1:10,000

Square Mileage for Cost Accounts:

Sheet	Sq. Mi.
TP-00010	2
TP-00014	8
TP-00015	12
TP-00016	10
TP-00017	2
TP-00018	7
Total	41

Revised-10/22/74

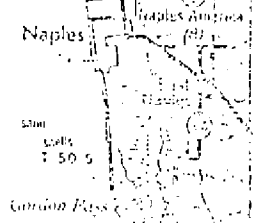

SUMMARY TO ACCOMPANY
DESCRIPTIVE REPORT TP-00017

This 1:10,000 scale shoreline manuscript is one of six maps which comprise Project PH-6912, Estero Bay, FL. The job diagram shows its location in the project.

The field work done prior to compilation consisted of premarking horizontal control that was required for bridging.

Bridging was done in the Rockville office by analytical methods in Aug., 1969 using 1:40,000 scale color photography dated June, 1969.

Compilation was done at the Atlantic Marine Center in Dec., 1969 using the Wild B-8 Plotter with 1:40,000 scale color photography dated June, 1969.

Field edit was done at the same time as hydrography in Sept., 1970.

Final review was done at the Atlantic Marine Center in Aug., 1975.

The original manuscript was a stabilene sheet 5 minutes in latitude and 5 minutes in longitude.

A stable base copy and a negative of the final reviewed manuscript were forwarded for record and registry.

FIELD INSPECTION REPORT

PH-6912

TP-00017

There was no field inspection prior to compilation.

Photogrammetric Plot Report

Estero Bay, Florida

Job PH-6912

August, 1969

21. Area Covered

This report covers T-sheets TP-00010, TP-00014 through TP-00018 of Estero Bay, Florida.

22. Method

Two bridges were run to provide horizontal control for graphic compilation. The C-8 and C-5 were used for instrumentation. Photographs 69-L(c)-9478 through 9487 and 9493 through 9503 were used in the bridging. In the adjustment of Strip 1 on the IBM 1620, 5 field identified control stations and 12 vertical control points were used. Strip 2 adjustment on the IBM 1620 used 4 field identified control stations and 12 vertical control points.

23. Adequacy of Control

The horizontal control provided, complied with the instructions and was adequate except for Estero Bay North Base. It is believed that Estero Bay North Base was misread in Strip 1 since it held in Strip 2.

All other control held well within the accuracy required by National Standards of Map Accuracy at 1:10,000 scale.

24. Supplemental Data

None

25. Photography

Photography was adequate as to coverage overlay and definition. The 1:20,000 scale color and infrared photography were ratioed for compilation.

Submitted by,

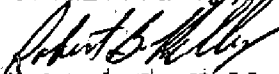
Robert B. Kelly

Approved by,

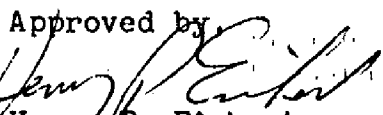
Henry P. Eichert
Chief, Aerotriangulation
Section

DESCRIPTIVE REPORT CONTROL RECORD

MAP NO.	JOB NO.	GEODETIC DATUM	ORIGINATING ACTIVITY		
TP-00017	PH-6912	N.A. 1927	Coastal Mapping Section - AMC		
STATION NAME	SOURCE OF INFORMATION (Index)	AEROTRI-ANGULATION POINT NUMBER	COORDINATES IN FEET STATE FLORIDA ZONE West	GEOGRAPHIC POSITION ϕ LATITUDE λ LONGITUDE	REMARKS Forward Back
AIR, 1928	G.P. pg. 885, P.C. pg. 72	85100	x= 562,868.77 y= 744,242.20	ϕ 26° 22' 52.164" λ 81° 48' 28.690"	1603.3 (241.2) 795.3 (867.9)
			x=	ϕ	
			y=	λ	
			x=	ϕ	
			y=	λ	
			x=	ϕ	
			y=	λ	
			x=	ϕ	
			y=	λ	
			x=	ϕ	
			y=	λ	
			x=	ϕ	
			y=	λ	
			x=	ϕ	
			y=	λ	
			x=	ϕ	
			y=	λ	
			x=	ϕ	
			y=	λ	
COMPUTED BY	A.C. Rauck, Jr.	DATE 9/4/69	COMPUTATION CHECKED BY B.L. Barge	DATE 1/2/70	
LISTED BY		DATE	LISTING CHECKED BY	DATE	
HAND PLOTTING BY		DATE	HAND PLOTTING CHECKED BY	DATE	

COMPILATION REPORT

TP-00017

Project PH-6912

GENERAL STATEMENT

Due to a malfunction of the camera, there were no fiducial marks on the bridging plates, the 1:20,000 scale hydro support photography or the 1:20,000 scale infrared photographs. Centers were put on the hydro support and infrared ratios, using a template. The accuracy of this method is questionable.

The centers are shown on both the photographs and the manuscript with broken circles and are considered approximate. No points should be located on the manuscript by the radial line method using these centers, nor should the centers be used for radially locating signals in the field.

COMPILATION REPORT

TP-00017

PH-6912

31. DELINEATION

Delineation was done by the Wild B-8 plotter and graphic methods. Shoreline pass points, the mean high water line, and interior details were compiled by use of the B-8. Some of the vegetation, and any features missed during instrument compilation were compiled graphically. 1:40,000 scale color photography was used as bridging photography. Points were dropped common to the 1:20,000 scale color and infrared photography which ^{were} processed for hydro support.

Photographic coverage was adequate.

32. CONTROL

See "Photogrammetric Plot Report", ESTERO BAY, FLORIDA, dated August, 1969.

33. SUPPLEMENTAL DATA

None

34. CONTOURS AND DRAINAGE

Contours are inapplicable.

Drainage was delineated from office interpretation of the photographs.

35. SHORELINE AND ALONGSHORE DETAILS

Shoreline and alongshore details were delineated from office interpretation of the photographs.

36. OFFSHORE DETAILS

None

37. LANDMARKS AND AIDS

Form 76-40 was forwarded to the Washington office.

38. CONTROL FOR FUTURE SURVEYS:

None

39. JUNCTIONS

Junctions were made with TP-00016 to the west and TP-00018 to the south. There are no contemporary surveys to the east or north.

40. HORIZONTAL AND VERTICAL ACCURACY

No statement

41. FIELD EDIT

Field edit was adequate. All questions asked were answered. Those items to be deleted were clearly marked. One nautical LDMK was recommended for plotting.

46. COMPARISON WITH EXISTING MAPS

A comparison was made with U.S.G.S. Quadrangles ESTERO, FL and BONITA SPRINGS, FL, scale 1:24,000, dated 1958.

47. COMPARISON WITH NAUTICAL CHARTS

Comparison has been made with C&GS Chart No. 1255, 11th edition, scale 1:80,000, dated Sept. 23, 1968 and C&GS Chart No. 856-SC, 7th edition, dated October, 1969, scale 1:40,000.

ITEMS TO BE APPLIED TO NAUTICAL CHARTS IMMEDIATELY

None

ITEMS TO BE CARRIED FORWARD

None

Submitted:

Albert C. Rauck, Jr. For Bernice Barge
B.L. Barge, Carto. Tech, Jan. 27, 1970

Approved:

Albert C. Rauck, Jr.
Albert C. Rauck, Jr.
Chief, Coastal Mapping Section, AMC

21 April 1975

GEOGRAPHIC NAMES

FINAL NAME SHEET

PH-6912 (Florida)

TP-00017

Bonita Springs
Estero Bay Shores
Imperial River
Imperial Shores
Leitner Creek
Oak Creek
Seaboard Coast Line (RR)
Spring Creek

Approved by:

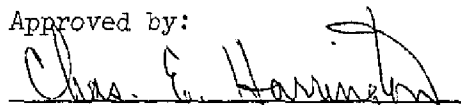

Chas. E. Harrington
Staff Geographer-C51x2

JOB PH-6912
ESTERO BAY,FLORIDA

T-Sheets: TP-000009,TP-00010,TP-00014 thru TP-00018

49- NOTES FOR THE HYDROGRAPHER AND FIELD EDITOR.

This special note is called to your attention. It concerns the absence of fiducial marks at the sides and corners of the infrared and color ratios submitted for your use.

The following ratios do not have fiducial marks,therefore their centers are shown by a double dashed circle. These ratios shall not be used to radially intersect positions of hydrographic signals.Pass points along the shoreline have been spaced closer than usual in order that you may by direct careful pricking, locate signals if required.

COLOR

69L(c)-9338 thru 9371

INFRARED

69L-9264R thru 9284R
69L-9296R " 9312R
69L-9314R " 9329R

REPEAT: DO NOT USE THE ABOVE LISTED RATIOS FOR RADIAL LOCATION OF SIGNALS.

The following listed color ratios: 69L(c)-9238 thru 9259,do have double solid centers fixed by fiducial marks, are specially processed, and may be used for radial intersection of signals.

NOAA FORM 75-74
(2-74)U.S. DEPARTMENT OF COMMERCE
NOAA
NATIONAL OCEAN SURVEY

PHOTOGRAMMETRIC OFFICE REVIEW

TP-00017

1. PROJECTION AND GRIDS Coradomat	2. TITLE CHB	3. MANUSCRIPT NUMBERS CHB	4. MANUSCRIPT SIZE
CONTROL STATIONS			
5. HORIZONTAL CONTROL STATIONS OF THIRD-ORDER OR HIGHER ACCURACY Coradomat Auto Plotter	6. RECOVERABLE HORIZONTAL STATIONS OF LESS THAN THIRD-ORDER ACCURACY (Topographic stations) X X		7. PHOTO HYDRO STATIONS X X
8. BENCH MARKS X X	9. PLOTTING OF SEXTANT FIXES X X	10. PHOTOGRAMMETRIC PLOT REPORT Bridge W.O.	11. DETAIL POINTS X X
ALONGSHORE AREAS (Nautical Chart Data)			
12. SHORELINE CHB	13. LOW-WATER LINE X X	14. ROCKS, SHOALS, ETC. X X	15. BRIDGES CHB
16. AIDS TO NAVIGATION	17. LANDMARKS	18. OTHER ALONGSHORE PHYSICAL FEATURES	19. OTHER ALONGSHORE CULTURAL FEATURES
PHYSICAL FEATURES			
20. WATER FEATURES CHB	21. NATURAL GROUND COVER X X		22. PLANETABLE CONTOURS X X
23. STEREOSCOPIC INSTRUMENT CONTOURS X X	24. CONTOURS IN GENERAL X X	25. SPOT ELEVATIONS X X	26. OTHER PHYSICAL FEATURES X X
CULTURAL FEATURES			
27. ROADS CHB	28. BUILDINGS CHB	29. RAILROADS CHB	30. OTHER CULTURAL FEATURES
BOUNDARIES			
31. BOUNDARY LINES X X		32. PUBLIC LAND LINES X X	
MISCELLANEOUS			
33. GEOGRAPHIC NAMES	34. JUNCTIONS		35. LEGIBILITY OF THE MANUSCRIPT
36. DISCREPANCY OVERLAY	37. DESCRIPTIVE REPORT	38. FIELD INSPECTION PHOTOGRAPHS	39. FORMS
40. REVIEWER		SUPERVISOR, REVIEW SECTION OR UNIT	
41. REMARKS (See attached sheet)			
FIELD COMPLETION ADDITIONS AND CORRECTIONS TO THE MANUSCRIPT			
42. Additions and corrections furnished by the field completion survey have been applied to the manuscript. The manuscript is now complete except as noted under item 43.			
COMPILER A.L. Shands	Date 9/21/71	SUPERVISOR	
Reviewer: R.R. White	9/28/71		
43. REMARKS Field Edit Applied From: Field Edit Ozalid 69L-(C)-9350 69L-(C)-9352 69L-(C)-9358			

52. ADEQUACY OF COMPILATION

Compilation was adequate. A few minor shoreline changes were indicated; most of which concerned, overlooked bulkheads and bulkhead limits. Some of the mangrove shoreline was drafted too smooth. In the Imperial River, overhanging trees were mapped as shoreline and three overhanging trees were compiled as "piers". Several piers and boat slips were not mapped and some boat houses were overlooked. One small canal, with a tiny islet at the mouth, was not compiled. Two overhead cable crossings, at lat. $26^{\circ} 20.6'$, long. $81^{\circ} 47.8'$ were omitted, as were an overhead cable at the Seaboard Coastline Railroad bridge and U. S. Highway 41 crossing of the Imperial River.

All changes or corrections were indicated on the field edit ozalid and cross-referenced to the appropriate photograph. Deletions were dealt with on the field edit ozalid.

All boat ramps indicated on this map are private unless otherwise noted.

54. RECOMMENDATIONS

None.

55. EXAMINATION OF PROOF COPY

Geographic Names

Verbal instructions were given the field editor to omit a geographic names investigation. Geographic names will be the subject of a special report to be submitted at a later date.

56. LANDMARKS AND NON-FLOATING AIDS FOR NAVIGATION

One nautical landmark, a "microwave tower", at lat. $26^{\circ} 23.6'$ long. $81^{\circ} 49.5'$, is recommended for charting. It was listed on form 567 and cross-referenced on form 152.

The microwave tower is visible on photograph 69L9c)9363. If possible, its position should be checked photogrammetrically against the field position, as it was located by intersection from three points on an open-end traverse.

There are no fixed aids to navigation within the limits of this map.

57. ROCKS, REEFS AND SHOALS

There are no rocks, reefs or shoals, as defined, within the limits of this map.

58. PHOTOGRAPHY

Photography consisted of 1:10,000 ratio color photographs. The photography was good.

59. DISPOSITION OF DATA

The field edit ozalid, the field edit photographs, the processed color office prints and the matte finish infrared photos, along with all pertinent data, were forwarded to the Director, Atlantic Marine Center. Two film ozalids, one containing photo-hydro signals, and copies of form 567 were transmitted to the hydrographic field party.

Richard E. Kesselring
Richard E. Kesselring
Surveying Technician

September 18, 1970

RESPONSIBLE PERSONNEL	
TYPE OF ACTION	NAME
OBJECTS INSPECTED FROM SEAWARD	Richard E. Kesseling
POSITIONS DETERMINED AND/OR VERIFIED	Richard E. Kesseling
FORMS ORIGINATED BY QUALITY CONTROL AND REVIEW GROUP AND FINAL REVIEW ACTIVITIES	Richard E. Kesseling
INSTRUCTIONS FOR ENTRIES UNDER 'METHOD AND DATE OF LOCATION'	
(Consult Photogrammetric Instructions No. 64.)	
OFFICE I. OFFICE IDENTIFIED AND LOCATED OBJECTS Enter the number and date (including month, day, and year) of the photograph used to identify and locate the object. EXAMPLE: 75E(C)6042 8-12-75	FIELD (Cont'd) B. Photogrammetric field positions* require entry of method of location or verification, date of field work and number of the photograph used to locate or identify the object. EXAMPLE: P-8-V 8-12-75 74L(C)2982
FIELD I. NEW POSITION DETERMINED OR VERIFIED Enter the applicable data by symbols as follows: F - Field L - Located V - Verified 1 - Triangulation 2 - Traverse 3 - Intersection 4 - Resection P - Photogrammetric Vis - Visually 5 - Field identified 6 - Theodolite 7 - Planetable 8 - Sextant A. Field positions* require entry of method of location and date of field work. EXAMPLE: F-2-6-L 8-12-75	III. TRIANGULATION STATION RECOVERED When a landmark or aid which is also a triangulation station is recovered, enter 'Triang. Rec.' with date of recovery. EXAMPLE: Triang. Rec. 8-12-75 II. POSITION VERIFIED VISUALLY ON PHOTOGRAPH Enter 'V-Vis.' and date. EXAMPLE: V-Vis. 8-12-75 **PHOTOGRAMMETRIC FIELD POSITIONS are dependent entirely, or in part, upon control established by photogrammetric methods.
*FIELD POSITIONS are determined by field observations based entirely upon ground survey methods.	

NOAA FORM 76-40
(8-74)

Replaces C&GS Form 567.

NONFLOATING AIDS OR LANDMARKS FOR CHARTS

U.S. DEPARTMENT OF COMMERCE
NATIONAL OCEANIC AND ATMOSPHERIC ADMINISTRATION

ORIGINATING ACTIVITY

- ☐ HYDROGRAPHIC PARTY
- ☐ GEODETIC PARTY
- ☒ PHOTO FIELD PARTY
- ☐ COMPILATION ACTIVITY
- ☐ FINAL REVIEWER
- ☐ QUALITY CONTROL & REVIEW GRP.
- ☐ COAST PILOT BRANCH

(See reverse for responsible personnel)

DATE

Aug. 1970

LOCALITY

Estero Bay

STATE

Florida

REPORTING UNIT
(Field Party, Ship or Office)

Photo Party 62

☒ TO BE CHARTED
☐ TO BE REVISED
☐ TO BE DELETED

The following objects HAVE ☒ BEEN INSPECTED FROM SEAWARD TO DETERMINE THEIR VALUE AS LANDMARKS.

OPR PROJECT NO.

JOB NUMBER

PH-6912

SURVEY NUMBER

T000017

DATUM

N.A. 1927

POSITION

LATITUDE	LONGITUDE
° / ' " D.M. Meters	° / ' " D.P. Meters

26 23 35.769 81 49 31.533
1100.8 874.0

DESCRIPTION
(Record reason for deletion of landmark or aid to navigation.
Show triangulation station names, where applicable, in parentheses.)

Red and white, steel, microwave tower, 255(265) feet

CHARTING NAME

MICROWAVE TOWER

METHOD AND DATE OF LOCATION
(See instructions on reverse side)

FIELD

F-2-6-L
7/3/70

CHARTS
AFFECTED

111427
1255

REVIEW REPORT TP-00017

SHORELINE

August, 1975

61. GENERAL STATEMENT:

See Summary, which is page six of this Descriptive Report.

A comparison print showing differences noted in paragraphs 62 through 65 is bound with the original of this report.

62. COMPARISON WITH REGISTERED TOPOGRAPHIC SURVEYS:

A comparison was made with T-11419 and T-11420, dated 1961, scale 1:10,000. Differences are shown in blue on the comparison print.

In the areas compared, TP-00017 supersedes T-11419 and T-11420 for nautical chart construction purposes. These are the latest registered prior surveys of the area.

63. COMPARISON WITH MAPS OF OTHER AGENCIES:

A comparison was made with U.S.G.S. Quadrangle ESTERO, FL and BONITA SPRINGS, FL, scale 1:24,000, dated 1958.

The main difference noted was at Bonita Springs at the head of the Imperial River. The quadrangle shows an intermittent stream running from Bonita Springs to the northeast where TP-00017 shows a perennial stream running from Bonita Springs to the eastsoutheast. TP-00017 is correct. Differences are shown in brown on the comparison print.

64. COMPARISON WITH CONTEMPORARY HYDROGRAPHIC SURVEYS:

A comparison was made with the original boat sheets for surveys H-9148 (HFP-745-10-2-70) and H-9149 (HFP-745-10-3-70). Shoreline on the boat sheets is from the Class III (Incomplete) manuscript. Some changes were made on the Final Reviewed manuscript by field edit. This accounts for shoreline differences between the manuscript and the boat sheet. Two boat ramps were identified on the boat sheet that were not on the manuscript. One of these could be seen on the photography and was added to the manuscript. The other boat ramp could not be seen on the photos and was not added to the manuscript. Differences are noted in purple on the comparison print.

65. COMPARISON WITH NAUTICAL CHARTS:

The area covered by this map is within the limits of NOS Chart 11426, scale 1:80,000, 17th edition, dated July 1974 and NOS Chart 11427, scale 1:40,000, 12th edition, dated Aug. 1974. A visual comparison was made with each chart. The only difference noted was a fifth east-west canal shown in Estero Bay Shores which did not exist at the time of the 1969 photography. It was not mapped.

The easternmost section (or head) of the Imperial River was not covered on either of these charts.

66. ADEQUACY OF RESULTS AND FUTURE SURVEYS:

This map complies with the Project Instructions and meets Bureau requirements and the National Standards of Map Accuracy.

Reviewed by:

Billy H. Barnes

Billy H. Barnes
Cartographer
August, 1975

Approved for forwarding:

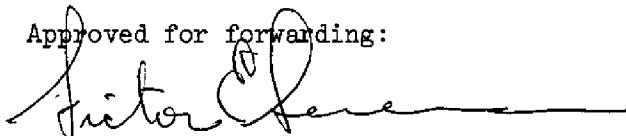

Victor E. Serena
Chief, Photogrammetric Branch, AMC

Approved:

Chief, Photogrammetric Branch

Chief, Coastal Mapping Division

TP-00017
1:10,000

26°20'30"

26°20'

81°45'00"

20

x=580,000 FT.

NATIONAL OCEAN SURVEY

SHORELINE MANUSCRIPT

TP-00017

ESTERO BAY

COMPARISON PRINT
Brown=USGS

81°45'30"

x=575,000 FT. 81°46'00"

46'30"

Intermittent
stream

Bonita Springs

△ Recoverable horizontal control station of third-order or higher accuracy

The heavy shoreline defines the mean high water line

The light shoreline defines the outer limits of vegetation visible above

approximate mean high water

TP-00017 21
1:10,000

26°21'00"

COMPARISON PRINT
Blue = T-11420 (1965)
Brown = USGS

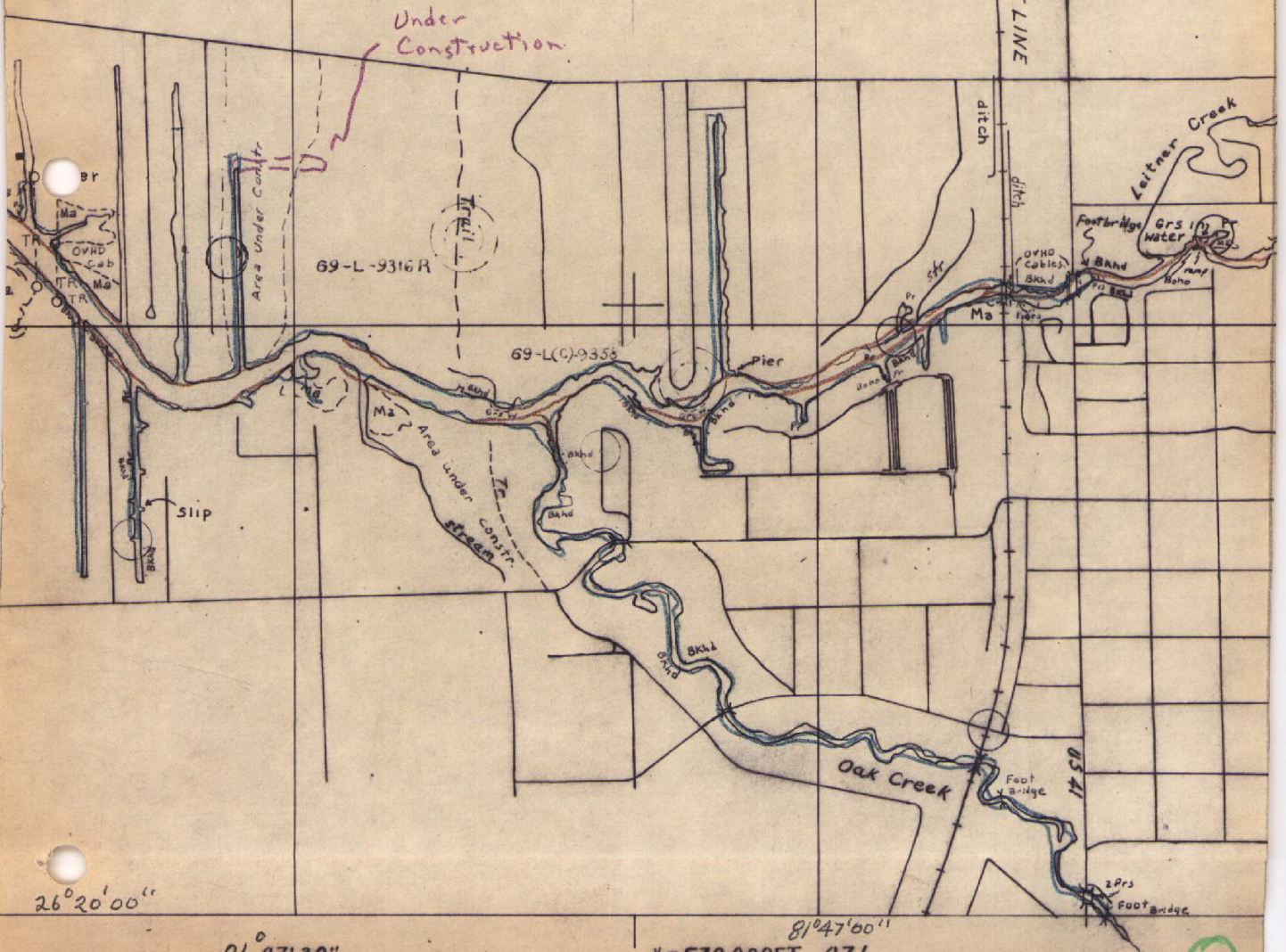

26°20'00"

81°47'30"

81°47'00"
X=570,000FT. 47'

2

TP-00017
1:10,000
22

COMPARISON PRINT
Blue= T-11420 (1965)
Red= Chart 11427
Brown=USGS

NOTE:

"The photogrammetric location and delineation of features offshore from the mean high-water line on this survey may not be complete or final. The contemporary reviewed hydrographic survey of the area where available, should be consulted for the final delineation."

26° 21' 00"

Trail Trail

69-L-9309R

End of chart coverage

26° 20' 30"

69-L(C)-9352

River

Mangrove

Canal

26° 20' 00"

49'

81° 48' 30"

x=565,000FT.

81° 48' 00"

3

COMPARISON PRINT
Blue= T-11420 (1965)
Red = Chart 11427
Purple= H9149 (1970)
Brown=USGS

23

69-L(C)-9351

TP-00017
1:10,000

y=730,000 FT

26° 20' 30"

26° 20' 00"

81° 50' 00" x=555,000 FT.

81° 49' 30"

x=560,000 FT.

INDEX TO ADJOINING

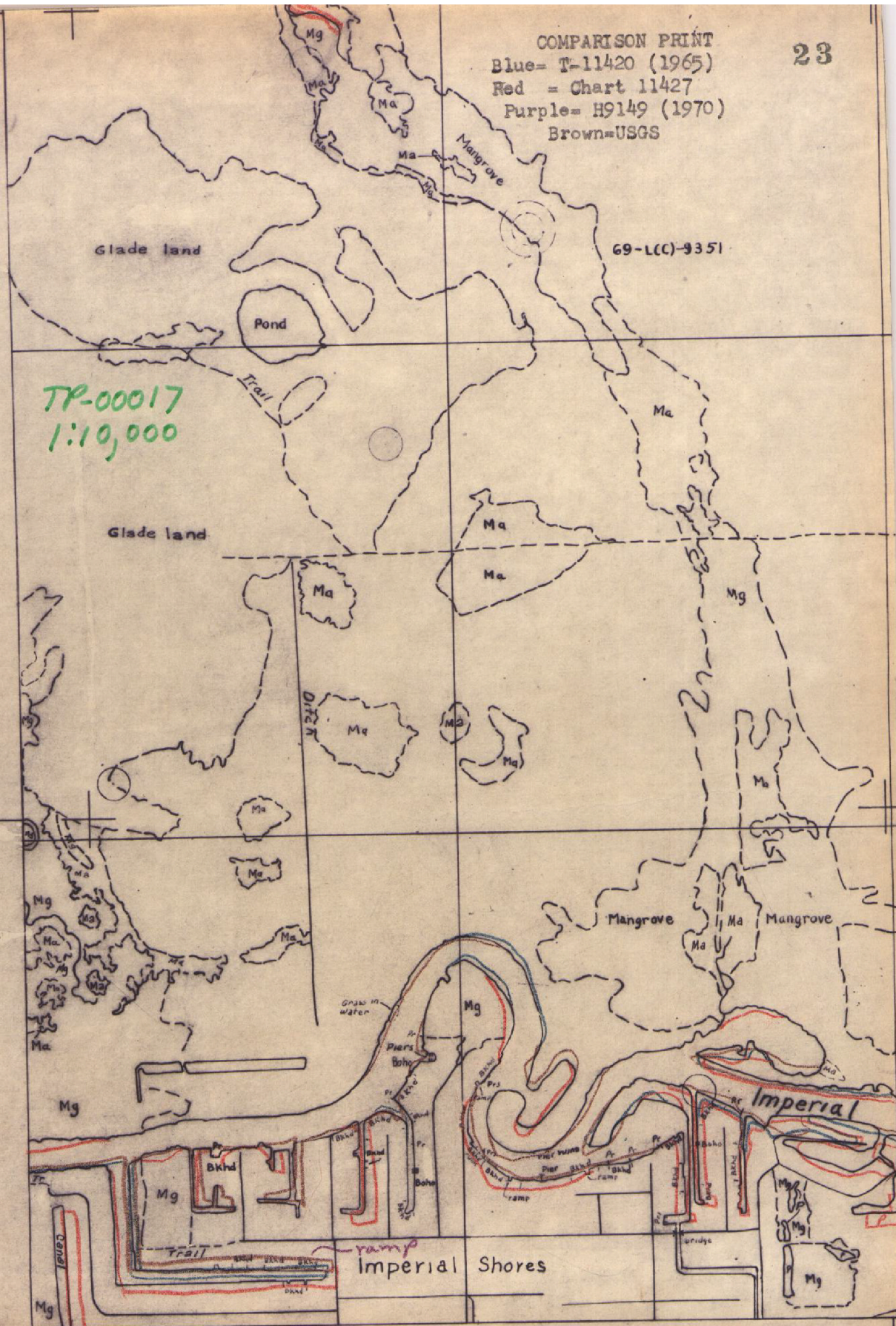

TP-00017
1:10,000

24

COMPARISON PRINT
Blue= T-11420
Red = Chart 11427
Brown=USGS

81° 49'

69-L-9308R



69-L-9307R

Y=740,000FT.

26° 22'

69-L(C)9350

26° 21' 30"

81° 50' 00"

Y=735,000FT.

TP-00017
1:10,000

COMPARISON PRINT
Blue= T-11419 and T-11420 (1965)
Red = Chart 11427
Brown =USGS

① MICROWAVE TOWER
ht = 255(265) ft.

26° 23' 30"

81° 50' 00''

 $81^{\circ} 49' 30''$

23'

$$y = 745,000 \text{ FT}$$

(JOINS SHEET TP-00016)

26⁰ 22' 30"

No canal is visible on 1970 photography

⑥