

TP-00271

TP-00271

NOAA FORM 76-35

U.S. DEPARTMENT OF COMMERCE  
NATIONAL OCEANIC AND ATMOSPHERIC ADMINISTRATION  
NATIONAL OCEAN SURVEY

## DESCRIPTIVE REPORT

Type of Survey ..... Shoreline .....

Job No. PH-7101 ..... Map No. TP-00271 .....

Classification No. .... Edition No. 1 .....

Field Edited Map

## LOCALITY

State ... South Carolina and Georgia .....

General Locality ... Charleston to Savannah .....

Locality ... EDISTO RIVER .....

---

19 70 TO 19 74

---

## REGISTRY IN ARCHIVES

DATE .....

MAP NOT INSPECTED IN QUALITY CONTROL PRIOR  
TO REGISTRATION

NOAA FORM 76-36A (3-72)		U. S. DEPARTMENT OF COMMERCE NATIONAL OCEANIC AND ATMOSPHERIC ADMIN.		TYPE OF SURVEY <input checked="" type="checkbox"/> ORIGINAL <input type="checkbox"/> RESURVEY <input type="checkbox"/> REVISED		SURVEY TP-00271 MAP EDITION NO. (1) MAP CLASS Final(F.E.) JOB PH-7101	
DESCRIPTIVE REPORT - DATA RECORD				LAST PRECEDING MAP EDITION			
				TYPE OF SURVEY <input type="checkbox"/> ORIGINAL <input type="checkbox"/> RESURVEY <input type="checkbox"/> REVISED		JOB PH- MAP CLASS SURVEY DATES: 19 TO 19	
PHOTOGRAMMETRIC OFFICE Coastal Mapping Division (Norfolk)				OFFICER-IN-CHARGE Jeffrey G. Carlen, Cdr.			
I. INSTRUCTIONS DATED							
1. OFFICE				2. FIELD			
Aerotriangulation May, 1972				Sept., 1970			
Compilation Sept., 1973							
II. DATUMS							
1. HORIZONTAL: <input checked="" type="checkbox"/> 1927 NORTH AMERICAN				OTHER (Specify)			
2. VERTICAL: <input checked="" type="checkbox"/> MEAN HIGH-WATER <input checked="" type="checkbox"/> MEAN LOW-WATER <input type="checkbox"/> MEAN LOWER LOW-WATER <input type="checkbox"/> MEAN SEA LEVEL				OTHER (Specify)			
3. MAP PROJECTION Polyconic				4. GRID(S) STATE South Carolina ZONE South			
5. SCALE 1:20,000				STATE ZONE			
III. HISTORY OF OFFICE OPERATIONS							
OPERATIONS				NAME		DATE	
1. AEROTRIANGULATION BY METHOD: Analytic LANDMARKS AND AIDS BY				R.B. Kelly		Dec. 1973	
2. CONTROL AND BRIDGE POINTS PLOTTED BY METHOD: <i>Coradomat</i> CHECKED BY							
3. STEREOSCOPIC INSTRUMENT PLANIMETRY BY COMPILATION CHECKED BY				Lowell O. Neterer, Jr.		Dec. 1973	
INSTRUMENT: Wild B-8				R.R. White		Dec. 1973	
SCALE: 1:20,000				NA			
4. MANUSCRIPT DELINEATION PLANIMETRY BY METHOD: Smooth ink tracing of reduction of 1:10,000 scale TP-00276 CHECKED BY				Lowell O. Neterer, Jr.		Jan, 1974	
SCALE: 1:20,000				R.R. White		Jan, 1974	
HYDRO SUPPORT DATA BY				NA			
CHECKED BY				NA			
5. OFFICE INSPECTION PRIOR TO FIELD EDIT BY				Frank Margiotta		Aug. 1974	
6. APPLICATION OF FIELD EDIT DATA BY				A.L. Shands		May, 1974	
CHECKED BY				F. Margiotta		Aug. 1974	
7. COMPILATION SECTION REVIEW BY				F. Margiotta		Aug. 1974	
8. FINAL REVIEW BY				Billy H. Barnes		Nov. 1975	
9. DATA FORWARDED TO PHOTOGRAMMETRIC BRANCH BY				Billy H. Barnes		March 3, 1976	
10. DATA EXAMINED IN PHOTOGRAMMETRIC BRANCH BY							
11. MAP REGISTERED - COASTAL SURVEY SECTION BY				R.T. CATBE		JUN 1976	

NOAA FORM 76-36C  
(3-72)

TP-00271

U. S. DEPARTMENT OF COMMERCE  
NATIONAL OCEANIC AND ATMOSPHERIC ADMINISTRATION  
NATIONAL OCEAN SURVEY

## HISTORY OF FIELD OPERATIONS

I. ☒ FIELD INSPECTION OPERATION☐ FIELD EDIT OPERATION

OPERATION	NAME	DATE
1. CHIEF OF FIELD PARTY	J.K. Wilson	10/27/70 6/14/71
2. HORIZONTAL CONTROL	RECOVERED BY R.E. Kesselring	10/27/70 6/14/71
	ESTABLISHED BY J.K. Wilson	6/14/71
	PRE-MARKED OR IDENTIFIED BY R.E. Kesselring	10/27/70 6/14/71
3. VERTICAL CONTROL	RECOVERED BY NA	
	ESTABLISHED BY NA	
	PRE-MARKED OR IDENTIFIED BY NA	
4. LANDMARKS AND AIDS TO NAVIGATION	RECOVERED (Triangulation Stations) BY None	
	LOCATED (Field Methods) BY None	
	IDENTIFIED BY None	
5. GEOGRAPHIC NAMES INVESTIGATION	TYPE OF INVESTIGATION <input type="checkbox"/> COMPLETE <input type="checkbox"/> SPECIFIC NAMES ONLY <input checked="" type="checkbox"/> NO INVESTIGATION	None
6. PHOTO INSPECTION	CLARIFICATION OF DETAILS BY	
7. BOUNDARIES AND LIMITS	SURVEYED OR IDENTIFIED BY NA	

## II. SOURCE DATA

1. HORIZONTAL CONTROL IDENTIFIED		2. VERTICAL CONTROL IDENTIFIED	
		NA	
PHOTO NUMBER	STATION NAME	PHOTO NUMBER	STATION DESIGNATION
70L(C)9860A	LAND, 1971		
70L(C)9862A	SPANISH WELLS		
3. PHOTO NUMBERS (Clarification of details)			
4. LANDMARKS AND AIDS TO NAVIGATION IDENTIFIED			
None			
PHOTO NUMBER	OBJECT NAME	PHOTO NUMBER	OBJECT NAME
5. GEOGRAPHIC NAMES: <input type="checkbox"/> REPORT <input checked="" type="checkbox"/> NONE		6. BOUNDARY AND LIMITS: <input type="checkbox"/> REPORT <input checked="" type="checkbox"/> NONE	
7. SUPPLEMENTAL MAPS AND PLANS			
8. OTHER FIELD RECORDS (Sketch books, etc. DO NOT list data submitted to the Geodesy Division)			
3-Forms 152			
1- Contact print 70L(c)9860A			
1-Form 251			

NOAA FORM 76-36C  
(3-72)

NOAA FORM 76-36D  
(3-72)

TP-00271

U. S. DEPARTMENT OF COMMERCE  
NATIONAL OCEANIC AND ATMOSPHERIC ADMINISTRATION

## RECORD OF SURVEY USE

## I. MANUSCRIPT COPIES

COMPILATION STAGES			DATE MANUSCRIPT FORWARDED	
DATA COMPILED	DATE	REMARKS	MARINE CHARTS	HYDRO SUPPORT
Manuscript complete pending field edit	1/ /74	Class III Manuscript superseded	2/4/74	12/24/73 Field edit
Field edit applied Compilation complete	5/ /74	Class I Manuscript Superseded	9/10/74	
Final Review	11/ /75		1/30/76	

## II. LANDMARKS AND AIDS TO NAVIGATION

## 1. REPORTS TO MARINE CHART DIVISION, NAUTICAL DATA BRANCH

NUMBER	CHART LETTER NUMBER ASSIGNED	DATE FORWARDED	REMARKS
	1160-74	9/5/74	Aids to Navigation

2. ☐ REPORT TO MARINE CHART DIVISION, COAST PILOT BRANCH. DATE FORWARDED: 9/5/74
3. ☐ REPORT TO AERONAUTICAL CHART DIVISION, AERONAUTICAL DATA SECTION. DATE FORWARDED: \_\_\_\_\_

## III. FEDERAL RECORDS CENTER DATA

1. ☒ BRIDGING PHOTOGRAPHS; ☒ DUPLICATE BRIDGING REPORT; ☒ COMPUTER READOUTS.
2. ☒ CONTROL STATION IDENTIFICATION CARDS; ☒ FORM NOS <sup>71-40</sup> 567 SUBMITTED BY FIELD PARTIES.
3. ☒ SOURCE DATA (except for Geographic Names Report) AS LISTED IN SECTION II, NOAA FORM 76-36C.  
ACCOUNT FOR EXCEPTIONS:
4. ☐ DATA TO FEDERAL RECORDS CENTER. DATE FORWARDED: \_\_\_\_\_

## IV. SURVEY EDITIONS (This section shall be completed each time a new map edition is registered)

SECOND EDITION	SURVEY NUMBER TP - _____ (2)	JOB NUMBER PH - _____	TYPE OF SURVEY <input type="checkbox"/> REVISED <input type="checkbox"/> RESURVEY MAP CLASS <input type="checkbox"/> II. <input type="checkbox"/> III. <input type="checkbox"/> IV. <input type="checkbox"/> V. <input type="checkbox"/> FINAL
	DATE OF PHOTOGRAPHY	DATE OF FIELD EDIT	
THIRD EDITION	SURVEY NUMBER TP - _____ (3)	JOB NUMBER PH - _____	TYPE OF SURVEY <input type="checkbox"/> REVISED <input type="checkbox"/> RESURVEY MAP CLASS <input type="checkbox"/> II. <input type="checkbox"/> III. <input type="checkbox"/> IV. <input type="checkbox"/> V. <input type="checkbox"/> FINAL
	DATE OF PHOTOGRAPHY	DATE OF FIELD EDIT	
FOURTH EDITION	SURVEY NUMBER TP - _____ (4)	JOB NUMBER PH - _____	TYPE OF SURVEY <input type="checkbox"/> REVISED <input type="checkbox"/> RESURVEY MAP CLASS <input type="checkbox"/> II. <input type="checkbox"/> III. <input type="checkbox"/> IV. <input type="checkbox"/> V. <input type="checkbox"/> FINAL
	DATE OF PHOTOGRAPHY	DATE OF FIELD EDIT	

JOB PH-7101

# CHARLESTON to SAVANNAH So. CAROLINA to GEORGIA SHORELINE MAPPING

SCALE 1:10,000 & 1:20,000

Official Mileage  
for Cost Accounts

Sheet No. - Area Sq. Mi.

TP-00267	8
TP-00268	7
TP-00269	9
TP-00270	1
TP-00271	10
TP-00272	4
TP-00273	1
TP-00274	3
TP-00275	3
TP-00276	3
TP-00277	12
TP-00278	4
TP-00279	3

Total 68

Revised 1/4/74

SUMMARY TO ACCOMPANY.

DESCRIPTIVE REPORT TP-00271

This map is a tracing of a photo-reduction of map TP-00276.  
The Summary for TP-00276 is applicable to this map

Photogrammetric Plot Report  
Charleston to Savannah  
South Carolina and Georgia  
Job PH - 710T

21. Area Covered

This report covers nine 1:20,000 sheets, TP-00267, TP-00268, TP-00269, TP-00270, TP-00271, TP-00272, TP-00273, TP-00277, TP-00279 and four 1:10,000 sheets, TP-00274, TP-00275, TP-00276, and TP-00278 from Kiawah River, South Carolina, to Tybee Island, Georgia.

22. Method

Eight strips 1:40,000 scale color photography were bridged by analytic aerotriangulation methods and adjusted to ground on South Carolina South State Plane coordinate system. Bridge points were used on 1:30,000 scale infrared photography for ratioing photographs to be used in compiling the Mean Low- and Mean High-Water Line. Ratio prints of infrared photography covering Mean Low- and Mean High-Water were ordered. (One each of cronapaque). Tie points were used to augment datum between strips. Data for plotting manuscripts for compilation were assembled for ruling and plotting by the Coradomat and Calcomp.

23. Adequacy of Control

The horizontal control provided was adequate except for Fusky (USE) 1932 sub stations A and C, which held in strip one and did not hold in strip two, because of poor image points. Also, Chan, 1933, substation A and C did not hold in strip four because of poor image points.

All other control held within the accuracy required by National Standards of Map Accuracy at 1:20,000 and 1:10,000 scale.

24. Supplemental Data

U.S. Geological Survey quadrangles were used to provide elevations for vertical adjustments of bridges.

25. Photography

RC-8 color film positives were adequate as to coverage, overlay, and definition.

Submitted by,

Robert B. Kelly

Approved and forwarded:

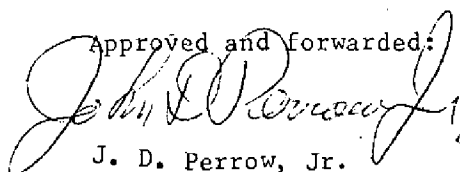

J. D. Perrow, Jr.

Chief, Aerotriangulation Section

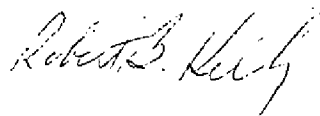



PH-7101  
Charleston to Savannah

NOTE TO COMPILER

Foreshore Cross Section points listed below were omitted during bridging. Points should be dropped during compilation.

Section II	68-01
Section VII	69-01
Section VIII	69-02
Section IX	73-01
Section XIII	79-01

CHARLESTON to SAVANNAH  
SO. CAROLINA to GEORGIA  
SHORELINE MAPPING

SCALE 1:10,000&1:20,000

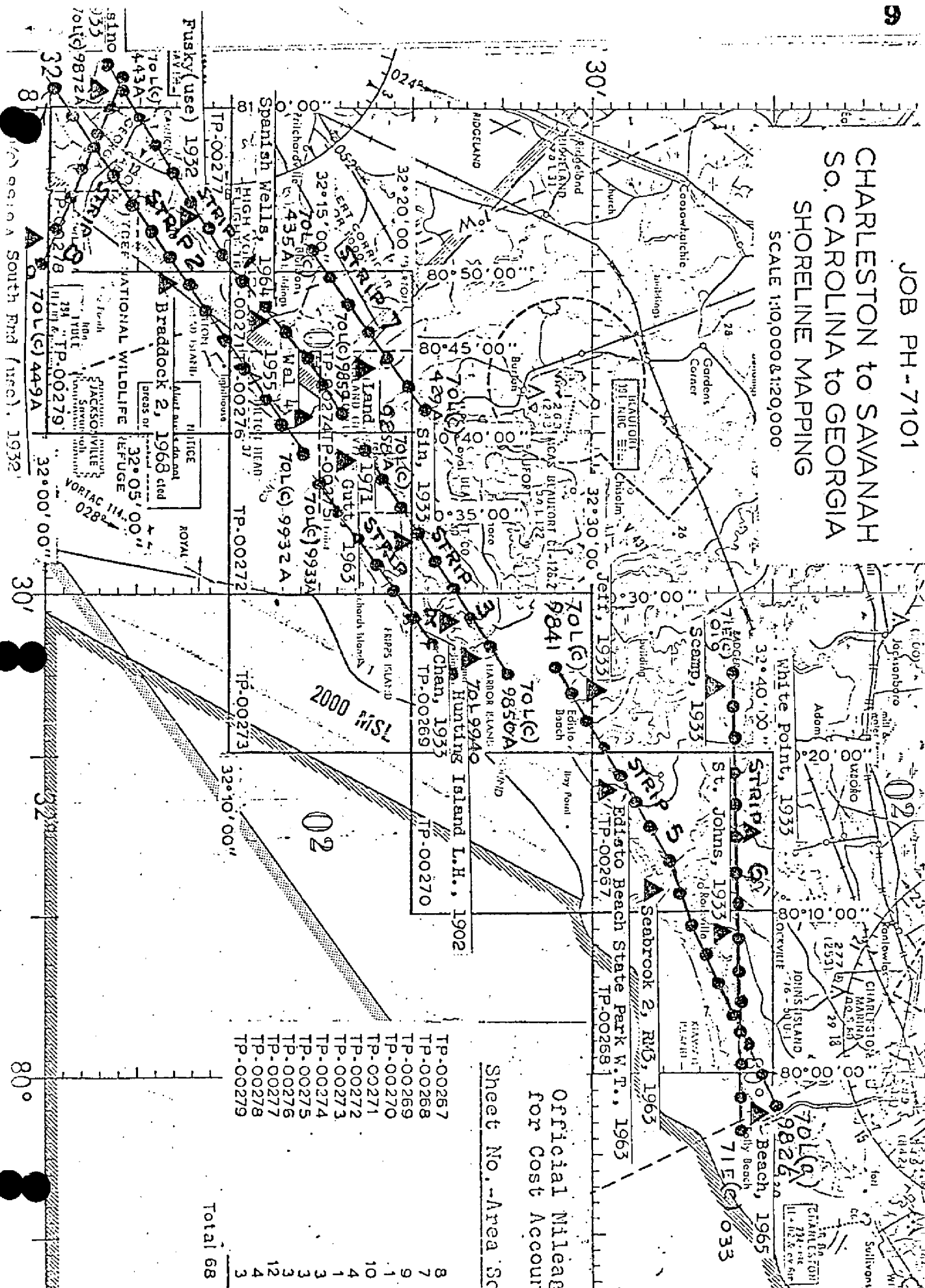

Official Mileage  
for Cost Account

Sheet No. - Area Sq

**Total 68**

## DESCRIPTIVE REPORT CONTROL RECORD

MAP NO.	JOB NO.	STATION NAME	SOURCE OF INFORMATION (Index)	AEROTRI-ANGULATION POINT NUMBER	GEODEIC DATUM		ORIGINATING ACTIVITY		
					STATE	ZONE	COORDINATES IN FEET	REMARKS	
TP-00271	PH-7101				N.A. 1927				
					South Carolina				
					South				
WAL 4, 1955		Quad. 320-803, P. 413 STA 1016			X=	φ 32° 14'	06.609"	✓	
					Y=	λ 80° 40'	39.925"	✓	
SPANISH WELLS, 1964		Quad. 320-803 Pg. 423			X=	φ 32° 11'	31.09188"	✓	
					Y=	λ 80° 46'	56.36410"	✓	
LAND, 1971		Bridge Form 164 No. 2 Pg. 2			X= 2,086,135.64	φ			
					Y= 158,112.24	λ			
HILTON HEAD B(USE) 1955		S.C. Vol. III Pg. 418			X=	φ 32° 13'	21.38196"	✓	
					Y=	λ 80° 40'	15.41025"	✓	
					X=	φ			
					Y=	λ			
					X=	φ			
					Y=	λ			
					X=	φ			
					Y=	λ			
					X=	φ			
					Y=	λ			
					X=	φ			
					Y=	λ			
					X=	φ			
					Y=	λ			
COMPUTED BY	B.H. Barnes				COMPUTATION CHECKED BY	Charles H. Bishop		✓	DATE 11/12/75
LISTED BY					LISTING CHECKED BY				DATE
HAND PLOTTING BY					HAND PLOTTING CHECKED BY				DATE

## COMPILATION REPORT

TP-00271

31. DELINEATION

The compilation was done by tracing a photo-reduction of the 1:10,000, scale sheet TP-00276, on to this manuscript.

32. - 36.

See Compilation Report for TP-00276.

37. LANDMARKS AND AIDS

Copies of Form 76-40 for 1 non-floating aid to navigation and 1 landmark were forwarded to the Rockville, MD office on Aug. 22, 1974 and March 25, 1974, respectively.

38. - 47.

See Compilation Report for TP-00276.

Submitted by:

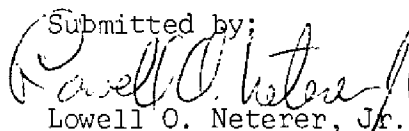

Lowell O. Neterer, Jr.

Carto. Technician, Jan. 23, 1974

Approved:



Albert C. Rauck, Jr.

Chief, Coastal Mapping Section, AMC

19 August 1975

## GEOGRAPHIC NAMES

## FINAL NAME SHEET

PH-7101 (Charleston, S. C. to Savannah, Ga.)

TP-00271

Atlantic Ocean

Fish Haul Creek

Folly Field

Hilton Head

Hilton Head Island

Port Royal Plantation

Port Royal Sound

The Folly

Approved by

Chas. E. Harrington  
Staff Geographer-C51x2

NOAA FORM 75-74 (2-74)		U.S. DEPARTMENT OF COMMERCE NOAA NATIONAL OCEAN SURVEY	
<b>PHOTOGRAMMETRIC OFFICE REVIEW</b>			
TP-00271			
1. PROJECTION AND GRIDS  FPM	2. TITLE  FPM	3. MANUSCRIPT NUMBERS  FPM	4. MANUSCRIPT SIZE  FPM
<b>CONTROL STATIONS</b>			
5. HORIZONTAL CONTROL STATIONS OF THIRD-ORDER OR HIGHER ACCURACY  FPM	6. RECOVERABLE HORIZONTAL STATIONS OF LESS THAN THIRD-ORDER ACCURACY (Topographic stations)  NA		7. PHOTO HYDRO STATIONS  
8. BENCH MARKS  NA	9. PLOTTING OF SEXTANT FIXES  	10. PHOTOGRAMMETRIC PLOT REPORT  FPM	11. DETAIL POINTS  FPM
<b>ALONGSHORE AREAS (Nautical Chart Data)</b>			
12. SHORELINE  FPM	13. LOW-WATER LINE  FPM	14. ROCKS, SHOALS, ETC.  FPM	15. BRIDGES  FPM
16. AIDS TO NAVIGATION  FPM	17. LANDMARKS  FPM	18. OTHER ALONGSHORE PHYSICAL FEATURES  FPM	19. OTHER ALONGSHORE CULTURAL FEATURES  FPM
<b>PHYSICAL FEATURES</b>			
20. WATER FEATURES  FPM	21. NATURAL GROUND COVER  NA		22. PLANETABLE CONTOURS  NA
23. STEREOSCOPIC INSTRUMENT CONTOURS  NA	24. CONTOURS IN GENERAL  NA	25. SPOT ELEVATIONS  NA	26. OTHER PHYSICAL FEATURES  FPM
<b>CULTURAL FEATURES</b>			
27. ROADS  FPM	28. BUILDINGS  FPM	29. RAILROADS  FPM	30. OTHER CULTURAL FEATURES  FPM
<b>BOUNDARIES</b>			
31. BOUNDARY LINES  NA		32. PUBLIC LAND LINES  NA	
<b>MISCELLANEOUS</b>			
33. GEOGRAPHIC NAMES  FPM	34. JUNCTIONS  FPM		35. LEGIBILITY OF THE MANUSCRIPT  FPM
36. DISCREPANCY OVERLAY  FPM	37. DESCRIPTIVE REPORT  FPM	38. FIELD INSPECTION PHOTOGRAPHS  FPM	39. FORMS  FPM
40. REVIEWER  F. Margiotta Aug. 1974		SUPERVISOR, REVIEW SECTION OR UNIT  <i>Albert C. Rauck, Jr.</i>	
41. REMARKS (See attached sheet)			
<b>FIELD COMPLETION ADDITIONS AND CORRECTIONS TO THE MANUSCRIPT</b>			
42. Additions and corrections furnished by the field completion survey have been applied to the manuscript. The manuscript is now complete except as noted under item 43.			
COMPILER A.L. Shands May 2, 1974 F. Margiotta Aug. 1974		SUPERVISOR <i>Albert C. Rauck, Jr.</i> A.C. Rauck, Jr.	
43. REMARKS  All edit accomplished on TP-00276 at 1:10,000 scale and transferred to this manuscript using the vertical projector.			

## FORESHORE CROSS-SECTIONS

CHARLESTON, SOUTH CAROLINA TO SAVANNAH, GEORGIA

JOB PH-7101

Sixteen foreshore cross-sections were taken between Folly Island, South Carolina, and Tybee Island, Georgia, a linear distance of approximately seventy miles. Twelve sections were positioned from triangulation and/or traverse stations and two sections, II and XIII, were located from photo points with sun azimuths. Section IX was located from a triangulation station using a photo point for an azimuth and section VII was run parallel to a relatively long pier.

Vertical control for sections I thru VI, VIII and IX was taken from the tide staff at Edisto Beach, South Carolina. Section VII was based on a temporary tide staff installed at Harbor River Entrance, South Carolina, and a temporary tide staff placed at Skull Creek(North Entrance) provided the control for sections X and XI. The remaining sections were based on the tide staff at Savannah River Entrance, Georgia.

The procedure, in establishing the TTM's used to control the individual sections, was to take a level reading on a recoverable object for use as a TTM, record it as a foresight, and then send the rodman into the water where the rod was used as a combination tide staff/level rod. After observing the water level on the rod for a period sufficient to determine a mean reading, a level reading was taken. The water level reading was subtracted from the level reading and the result entered in the field book as a backsight. Immediately, the instrument was moved, a new water level reading determined and another level reading obtained. Again the two were subtracted and the result entered as a foresight. The rodman was then sent back to the TTM to close the loop. The entries in the field book show this procedure reversed. This was done to avoid confusion as there didn't appear to be any adequate method of showing the actual procedure. The remainder of the operation was straightforward leveling with an angle and distance to the mean high and low water lines thrown in.

Time differences for each section were calculated in advance to eliminate any datum correction; for example, if a minus time were indicated for a particular section, then the water level readings on the tide staff/level rod would be obtained first and the man on the controlling tide staff informed of the time of the readings. The tide staff man would then wait the calculated length of time for the section involved before reading the controlling tide staff. For plus times, the procedure was reversed. Information was exchanged between the controlling tide staffs and the individual sections via radio. At sections I and XII, no radio communications were available. For these two sections, the controlling tide staff was read and recorded at fifteen minute intervals and the height of the water at the time of the water level readings computed at a later time.

As no specific instructions were given to the contrary, cross-section shots were taken of the foreshore at twenty, thirty, and sometimes, fifty foot intervals, depending on the length of the section. Whether they are necessary, or even wanted, is not known, but as they only took about five to ten minutes extra for each section, they were included anyway.

One typical section and three atypical sections were plotted to give the compiler an idea of what was done and to show the method of location. These sections, the field book, pricking cards, sun azimuths, color contact photographs and charts showing the individual section locations are included with this report.

*Richard E. Kesselring*

Richard E. Kesselring  
Survey Tech.  
May 3, 1971



[illegible]



## REVIEW REPORT TP-00271

## SHORELINE

November 1975

The Review Report for map TP-00276 at a scale of 1:10,000 is also applicable to this map.

Reviewed by:

*Billy H. Barnes*

Billy H. Barnes  
Cartographer  
November, 1975

Approved for forwarding:

*Victor E. Serena*  
Victor E. Serena  
Chief, Photogrammetric Branch, AMC

Approved:

Chief, Photogrammetric Branch

Chief, Coastal Mapping Div.