

ORIGINAL

TP-00705

ORIGINAL

TP-00705

NOAA FORM 76-35

U.S. DEPARTMENT OF COMMERCE
NATIONAL OCEANIC AND ATMOSPHERIC ADMINISTRATION
NATIONAL OCEAN SURVEY

DESCRIPTIVE REPORT

Type of Survey Shoreline

Job No. CM-7219 Map No. TP-00705

Classification No. Edition No. ... 1

Field Edited Map

LOCALITY

State North Carolina

General Locality Cape Fear to Cape Lookout

Locality Cape Fear

1972 TO 1973

REGISTRY IN ARCHIVES

DATE

NOAA FORM 76-36A (3-72)		U. S. DEPARTMENT OF COMMERCE NATIONAL OCEANIC AND ATMOSPHERIC ADMIN.		TYPE OF SURVEY <input checked="" type="checkbox"/> ORIGINAL <input type="checkbox"/> RESURVEY <input type="checkbox"/> REVISED		SURVEY TP-00705 MAP EDITION NO. (1) MAP CLASS JOB MM CM-7219	
DESCRIPTIVE REPORT - DATA RECORD PHOTOGRAMMETRIC OFFICE Coastal Mapping Division, Norfolk, VA OFFICER-IN-CHARGE Jeffrey G. Carlen, CDR, NOAA				LAST PRECEDING MAP EDITION TYPE OF SURVEY <input type="checkbox"/> ORIGINAL <input type="checkbox"/> RESURVEY <input type="checkbox"/> REVISED			
				JOB PH- MAP CLASS SURVEY DATES: 19__ TO 19__			
I. INSTRUCTIONS DATED							
1. OFFICE				2. FIELD			
Dec 4, 1972 Aerotriangulation Apr 4, 1973 Compilation Apr 6, 1973 Amend. 1				Sep 15, 1972 Sep 28, 1973 Amend. 1 Sep 21, 1973			
II. DATUMS							
1. HORIZONTAL: <input checked="" type="checkbox"/> 1927 NORTH AMERICAN				OTHER (Specify)			
2. VERTICAL: <input checked="" type="checkbox"/> MEAN HIGH-WATER <input checked="" type="checkbox"/> MEAN LOW-WATER <input type="checkbox"/> MEAN LOWER LOW-WATER <input type="checkbox"/> MEAN SEA LEVEL				OTHER (Specify)			
3. MAP PROJECTION Polyconic				4. GRID(S) STATE North Carolina ZONE			
5. SCALE 1:20,000				STATE ZONE			
III. HISTORY OF OFFICE OPERATIONS							
OPERATIONS				NAME		DATE	
1. AEROTRIANGULATION BY METHOD: Stereoplanigraph LANDMARKS AND AIDS BY				J.E. Schad		Mar 21, 73	
2. CONTROL AND BRIDGE POINTS PLOTTED BY METHOD: Calcomp. CHECKED BY						Mar, 73	
3. STEREOSCOPIC INSTRUMENT PLANIMETRY BY COMPILATION CHECKED BY				F. Margiotta		Mar, 73	
INSTRUMENT: Wild B-8				L.O. Neterer		Mar, 73	
SCALE: 1:20,000 (See item 31)				NA			
4. MANUSCRIPT DELINEATION PLANIMETRY BY CHECKED BY				L.B. Foltz		Apr, 73	
METHOD: (See item 31)				A.L. Shands		Apr, 73	
SCALE: 1:20,000				NA			
HYDRO SUPPORT DATA BY				NA			
5. OFFICE INSPECTION PRIOR TO FIELD EDIT BY				A.L. Shands		Apr, 73	
6. APPLICATION OF FIELD EDIT DATA BY				Charles Parker		Apr, 75	
7. COMPILATION SECTION REVIEW BY				Frank Margiotta		Apr, 75	
8. FINAL REVIEW BY				Frank Margiotta		Apr, 75	
9. DATA FORWARDED TO PHOTOGRAMMETRIC BRANCH BY				C.H. Bishop		Jun, 76	
10. DATA EXAMINED IN PHOTOGRAMMETRIC BRANCH BY							
11. MAP REGISTERED - COASTAL SURVEY SECTION BY				R.T. CATOR		APR 1976	

NOAA FORM 76-36B
(3-72)U. S. DEPARTMENT OF COMMERCE
NATIONAL OCEANIC AND ATMOSPHERIC ADMINISTRATION
NATIONAL OCEAN SURVEYCOMPILATION SOURCES
TP-00705

1. COMPILATION PHOTOGRAPHY

CAMERA(S) Wild RC-8 "E", RC-10 "C"		TYPES OF PHOTOGRAPHY LEGEND		TIME REFERENCE	
TIDE STAGE REFERENCE Charleston		(C) COLOR X		ZONE	XX STANDARD
<input checked="" type="checkbox"/> PREDICTED TIDES Cape Fear		(P) PANCHROMATIC		Eastern	
<input type="checkbox"/> REFERENCE STATION RECORDS		(I) INFRARED X		MERIDIAN	<input type="checkbox"/> DAYLIGHT
<input checked="" type="checkbox"/> TIDE CONTROLLED PHOTOGRAPHY				75th	

NUMBER AND TYPE	DATE	TIME	SCALE	STAGE OF TIDE
* 72E(C) 6738 thru 6739	Oct 20, 72	13:50	1:40,000	2.0 ft. above MLW
** 73C(C)(1)-4955	Oct 18, 73	13:40	1:60,000	+0.2 ft. of MHW
*** 73C(C)(1) 6126-6127	Nov 11, 73	13:51	1:60,000	+0.2 ft. of MLW

NOTE: Also see photographs listed on Form 76-36b.1. for TP-00683 (Job CM-7218).

REMARKS* Bridge and compilation photos
 ** Tide coordinated photos at MHW and MLW, based on predicted tides.

2. SOURCE OF MEAN HIGH-WATER LINE:

The mean high water line was compiled from office interpretation of the 1972 color photography listed under 1. above and updated graphically by use of the 1973 tide coordinated* infrared photographs taken at MHW when they became available.

* See 1 above

3. SOURCE OF MEAN LOW-WATER OR MEAN LOWER LOW-WATER LINE:

The mean low water line was compiled graphically from office interpretation of the tide coordinated* infrared photographs listed in 1 above.

* See 1 above

4. CONTEMPORARY HYDROGRAPHIC SURVEYS (List only those surveys that are sources for photogrammetric survey information.)

SURVEY NUMBER	DATE(S)	SURVEY COPY USED	SURVEY NUMBER	DATE(S)	SURVEY COPY USED

5. FINAL JUNCTIONS

NORTH	EAST	SOUTH	WEST
TP-00704	No Survey	No Survey	CM-7218 TP-00682

REMARKS

TP-00705 is a copy of 1:10,000 scale map TP-00683 (Job CM-7218)

NOAA FORM 76-36C
(3-72)

TP-00705

U. S. DEPARTMENT OF COMMERCE
NATIONAL OCEANIC AND ATMOSPHERIC ADMINISTRATION
NATIONAL OCEAN SURVEY

HISTORY OF FIELD OPERATIONS

1. ☒ FIELD INSPECTION OPERATION☐ FIELD EDIT OPERATION

OPERATION	NAME	DATE
1. CHIEF OF FIELD PARTY	R. S. Tibbetts	Oct. 1972
2. HORIZONTAL CONTROL	RECOVERED BY	R. E. Kesselring
	ESTABLISHED BY	NA
	PRE-MARKED OR IDENTIFIED BY	R. E. Kesselring
3. VERTICAL CONTROL	RECOVERED BY	NA
	ESTABLISHED BY	NA
	PRE-MARKED OR IDENTIFIED BY	NA
4. LANDMARKS AND AIDS TO NAVIGATION	RECOVERED (Triangulation Stations) BY	None
	LOCATED (Field Methods) BY	None
	IDENTIFIED BY	None
5. GEOGRAPHIC NAMES INVESTIGATION	TYPE OF INVESTIGATION	
	<input type="checkbox"/> COMPLETE	
	<input type="checkbox"/> SPECIFIC NAMES ONLY	NA
	<input type="checkbox"/> NO INVESTIGATION	
6. PHOTO INSPECTION	CLARIFICATION OF DETAILS BY	NA
7. BOUNDARIES AND LIMITS	SURVEYED OR IDENTIFIED BY	NA

II. SOURCE DATA

1. HORIZONTAL CONTROL IDENTIFIED

Premark

2. VERTICAL CONTROL IDENTIFIED

PHOTO NUMBER	STATION NAME	PHOTO NUMBER	STATION DESIGNATION
	Baldhead Lighthouse 1851 (West of TP-00705)		

3. PHOTO NUMBERS (Clarification of details)

None

4. LANDMARKS AND AIDS TO NAVIGATION IDENTIFIED

None

PHOTO NUMBER	OBJECT NAME	PHOTO NUMBER	OBJECT NAME

5. GEOGRAPHIC NAMES: ☐ REPORT ☒ NONE6. BOUNDARY AND LIMITS: ☐ REPORT ☒ NONE

7. SUPPLEMENTAL MAPS AND PLANS

None

8. OTHER FIELD RECORDS (Sketch books, etc. DO NOT list data submitted to the Geodesy Division)

- 1 Form 76-53 Control Station Identification
- 1 Form MA-100 Tellurometer Observations
- 1 Form 266 Observation of Sun for Azimuth and Time
- 1 Form 269c Computation of Altitude and Time Azimuth

NOAA FORM 76-36C
(3-72)

TP-00705
HISTORY OF FIELD OPERATIONSI. ☐ FIELD INSPECTION OPERATION☒ FIELD EDIT OPERATION

OPERATION	NAME	DATE
1. CHIEF OF FIELD PARTY	R. S. Tibbetts	1973
2. HORIZONTAL CONTROL	RECOVERED BY NA	
	ESTABLISHED BY NA	
	PRE-MARKED OR IDENTIFIED BY NA	
3. VERTICAL CONTROL	RECOVERED BY NA	
	ESTABLISHED BY NA	
	PRE-MARKED OR IDENTIFIED BY NA	
4. LANDMARKS AND AIDS TO NAVIGATION	RECOVERED (Triangulation Stations) BY NA	
	LOCATED (Field Methods) BY NA	
	IDENTIFIED BY NA	
5. GEOGRAPHIC NAMES INVESTIGATION	TYPE OF INVESTIGATION <input type="checkbox"/> COMPLETE <input checked="" type="checkbox"/> SPECIFIC NAMES ONLY BY R. D. Black <input type="checkbox"/> NO INVESTIGATION	Oct. 1973
6. PHOTO INSPECTION	CLARIFICATION OF DETAILS BY R. D. Black	Oct. 1973
7. BOUNDARIES AND LIMITS	SURVEYED OR IDENTIFIED BY NA	

II. SOURCE DATA

1. HORIZONTAL CONTROL IDENTIFIED

None

2. VERTICAL CONTROL IDENTIFIED

None

PHOTO NUMBER	STATION NAME	PHOTO NUMBER	STATION DESIGNATION

3. PHOTO NUMBERS (Clarification of details)

72 E(C) 6838

4. LANDMARKS AND AIDS TO NAVIGATION IDENTIFIED

None

PHOTO NUMBER	OBJECT NAME	PHOTO NUMBER	OBJECT NAME

5. GEOGRAPHIC NAMES:

☐ REPORT☒ NONE

6. BOUNDARY AND LIMITS:

☐ REPORT☒ NONE

7. SUPPLEMENTAL MAPS AND PLANS

None

8. OTHER FIELD RECORDS (Sketch books, etc. DO NOT list data submitted to the Geodesy Division)

1 Field Edit Report

1 Field Edit Ozalid

NOAA FORM 76-36D
(3-72)U. S. DEPARTMENT OF COMMERCE
NATIONAL OCEANIC AND ATMOSPHERIC ADMINISTRATIONTP-00705
RECORD OF SURVEY USE

I. MANUSCRIPT COPIES

COMPILATION STAGES			DATE MANUSCRIPT FORWARDED	
DATA COMPILED	DATE	REMARKS	MARINE CHARTS	HYDRO SUPPORT
Compilation complete pending field edit	Apr, 1973	Class III manuscript Superseded	None	Apr 30, 73
Compilation complete field edit applied	Apr. 1975	Class I manuscript	6/3/75	
Final Review	Jun, 1976			

II. LANDMARKS AND AIDS TO NAVIGATION None

1. REPORTS TO MARINE CHART DIVISION, NAUTICAL DATA BRANCH

NUMBER	CHART LETTER NUMBER ASSIGNED	DATE FORWARDED	REMARKS

2. ☐ REPORT TO MARINE CHART DIVISION, COAST PILOT BRANCH. DATE FORWARDED: _____3. ☐ REPORT TO AERONAUTICAL CHART DIVISION, AERONAUTICAL DATA SECTION. DATE FORWARDED: _____

III. FEDERAL RECORDS CENTER DATA

1. ☒ BRIDGING PHOTOGRAPHS; ☒ DUPLICATE BRIDGING REPORT; ☐ COMPUTER READOUTS.
 2. ☒ CONTROL STATION IDENTIFICATION CARDS; ☐ FORM NOS 567 SUBMITTED BY FIELD PARTIES.
 3. ☒ SOURCE DATA (except for Geographic Names Report) AS LISTED IN SECTION II, NOAA FORM 76-36C.
 ACCOUNT FOR EXCEPTIONS:

4. ☐ DATA TO FEDERAL RECORDS CENTER. DATE FORWARDED: _____

IV. SURVEY EDITIONS (This section shall be completed each time a new map edition is registered)

SECOND EDITION	SURVEY NUMBER TP - _____ (2)	JOB NUMBER PH - _____	TYPE OF SURVEY <input type="checkbox"/> REVISED <input type="checkbox"/> RESURVEY MAP CLASS <input type="checkbox"/> II. <input type="checkbox"/> III. <input type="checkbox"/> IV. <input type="checkbox"/> V. <input type="checkbox"/> FINAL
	DATE OF PHOTOGRAPHY	DATE OF FIELD EDIT	
THIRD EDITION	SURVEY NUMBER TP - _____ (3)	JOB NUMBER PH - _____	TYPE OF SURVEY <input type="checkbox"/> REVISED <input type="checkbox"/> RESURVEY MAP CLASS <input type="checkbox"/> II. <input type="checkbox"/> III. <input type="checkbox"/> IV. <input type="checkbox"/> V. <input type="checkbox"/> FINAL
	DATE OF PHOTOGRAPHY	DATE OF FIELD EDIT	
FOURTH EDITION	SURVEY NUMBER TP - _____ (4)	JOB NUMBER PH - _____	TYPE OF SURVEY <input type="checkbox"/> REVISED <input type="checkbox"/> RESURVEY MAP CLASS <input type="checkbox"/> II. <input type="checkbox"/> III. <input type="checkbox"/> IV. <input type="checkbox"/> V. <input type="checkbox"/> FINAL
	DATE OF PHOTOGRAPHY	DATE OF FIELD EDIT	

JOINS JOB CM-7305

ASTAL

Official Mileage for Cost Account:

Sheet No.	Sq. Miles
TP-00684	2
TP-00685	4
TP-00686	4
TP-00687	4
TP-00688	4
TP-00689	4
TP-00690	1
TP-00691	3
TP-00692	1
TP-00693	1
TP-00694	1
TP-00695	1
TP-00696	1
TP-00697	1
TP-00698	1
TP-00699	1
TP-00700	1
TP-00701	1
TP-00702	1
TP-00703	1
TP-00704	1
TP-00705	2

WA
W

PART 1 & PART 2
JOB CM-7219
CAPE FEAR TO CAPE LOOKOUT
NORTH CAROLINA
SHORELINE MAPPING
SCALE 1:20,000
REVISED 8-29-72 KWW
Revised 11-1-73 J.F.V.

33°45'00" 2

JOINS JOB CM-7218

SUMMARY TO ACCOMPANY

DESCRIPTIVE REPORTS TP-00692 and TP-00697 through TP-00705

Project CM-7219 is one of several projects that comprise the Southern Coastal Plains Expedition (SCOPE). It is a 1:20,000 scale shoreline mapping project which contains eighteen maps. Except for Map TP-00705, the maps referred to in this summary are not standard shoreline surveys because compilation was limited to the ocean shoreline only, per Instructions - OFFICE - Job CM-7219, Part II, Cape Fear to Cape Lookout, North Carolina, Shoreline Mapping, dated 4/4/73, Items 4.03 and 4.04. The entire area of TP-00705 was mapped; it was copied from a reduction of 1:10,000 scale Map TP-00683 (Job CM-7218) which covers the same area.

This summary is for Part II of the project. It covers the area between New River Inlet and Cape Fear.

Field work prior to compilation consisted of recovery and premarking horizontal control required for bridging and the obtaining of beach profiles. These profiles were not made within the time limit specified in instructions dated September 28, 1972 and were too widely spaced. Therefore, they were considered of no value and were not used as a source for mean high or mean low water lines.

Bridging was done in the Rockville Office in March 1973 using the Zeiss C-8 stereoplanigraph with 1:40,000 scale photography dated October 20, 1972. See Photogrammetric Plot Report following this summary.

Compilation was done at the Atlantic Marine Center in April and May 1973, using the 1972 bridging photography for compilation of interior details and initial compilation of the mean high water line. Later, at the time field edit was applied and the tide coordinated infrared photography (based on predicted tides) was available, the mean high water line was corrected where necessary, to agree with the photographs taken at MHW and the mean low water line was delineated graphically from the MLW photographs.

Field edit was done in May and July 1974, except for the area covered by TP-00705, which was edited in August 1973.

Final review was done at the Atlantic Marine Center in March through June 1976.

The original manuscripts were stabilene sheets $7\frac{1}{2}$ minutes in latitude by $7\frac{1}{2}$ minutes in longitude.

A cronaflex positive copy and a negative of each final reviewed map were forwarded for record and registry.

Photogrammetric Plot Report
Job CM-7219
Cape Fear - Cape Lookout, North Carolina
Part II
March 21, 1973

21. Area Covered

The area covered in this report extends along the North Carolina shoreline from Cape Fear to the vicinity of New River Inlet. Included in this area are 11 T-sheets: TP-00692; TP-00696 thru TP-00705; all are at 1:20,000 scale.

22. Method

Two strips of 1:40,000 color photography were bridged on the Zeiss C-8 stereoplanigraph and adjusted by the IBM computer. The two strips were used to obtain pass point positions for the models and to determine the scale ratio for strips #4, #5, and #6.

Compilation points were positioned on strip #5 to set photos 72E(c) 6756 thru 6760.

Strip #1 (72E(c) 6722 thru 6739) was adjusted on four field identified triangulation stations with five office identified stations as checks.

Strip #2 (72E(c) 6706 thru 6720) was adjusted on five triangulation stations, three tie points and three triangulation stations were used as checks. All horizontal tie points were averaged. T-sheets were ruled on North Carolina plane coordinates and plotted on the Coradomat.

23. Adequacy of Control

Horizontal control complied with project instruction and held within the National Map Accuracy Standard.

24. Supplemental Data

All vertical control needed for adjustment was taken from USGS quadrangles and are approximate mean sea level. The vertical points obtained by bridging are not necessarily true values.

25. Photography

Photography was adequate as to overlap, definition, and coverage.

Respectfully submitted

James E. Schad
James E. Schad

Approved by:

John D. Perrow, Jr.
John D. Perrow, Jr.
Chief, Aerotriangulation Section

Notes to Compiler
 Job. CM-7219
 Cape Fear - Cape Lookout, North Carolina

The shoreline area from the vicinity of Mason Inlet to New Topsoil Inlet (TP-00700) must be compiled from strip #5 (72E(c)6756 thru 6760) either by setting the models or by graphic methods. In order to control this area, "900" series points were determined from bridging strip #2.

Beach cross section points, which were field identified on black/white contact print, have been horizontally positioned from bridging strips #1 and #2 and are identified with "400" series numbers.

Strip # 1	Photo number	Field number
	25401	01-02 (68E 3232)
	25400	03-03 (68E 3232)
	26400	01-01 (68E 3419)
	31400	02-01 (68E 3428)
Strip #2	10400	00-01 (68E 3244)
	14400	97-01 (68E 3249)
	16400	97-02 (68E 3252)
	r8400	98-02 (68E 3270)
	19400	98-01 (68E 3272)

Rather of strips 4, 5 and 6 were ordered
JOS

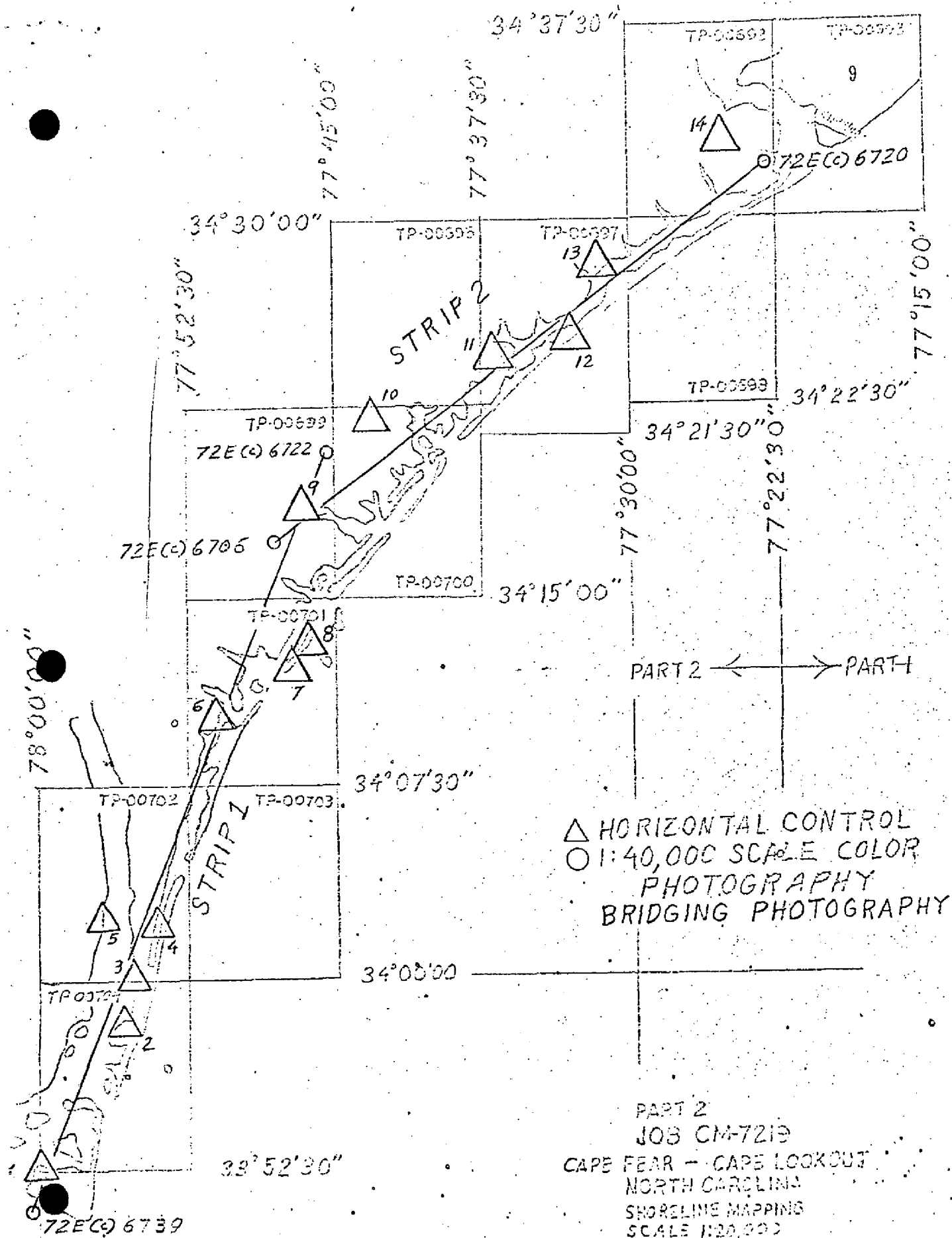

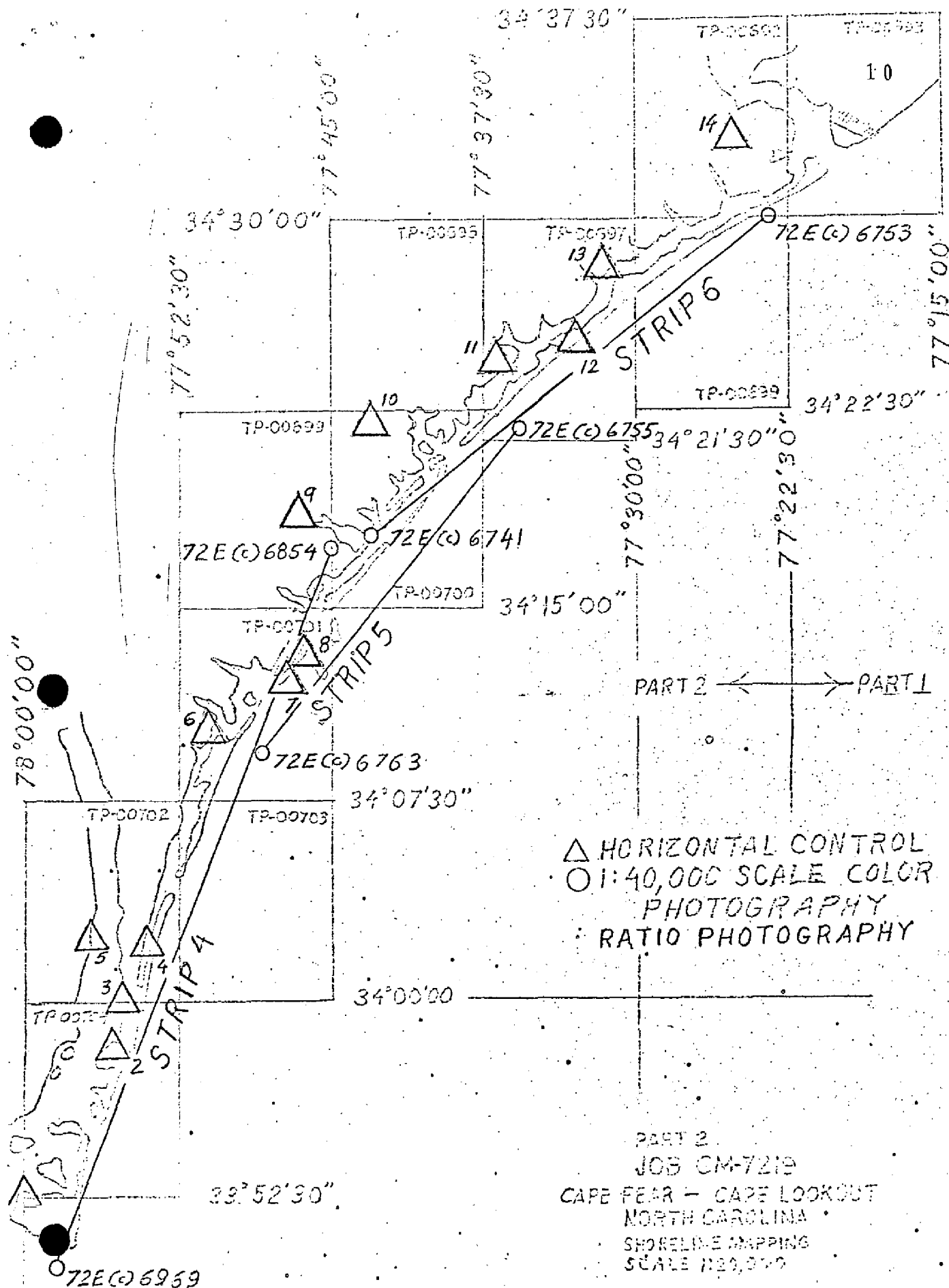

JOB CM-7219

KEY TO HORIZONTAL CONTROL
USE FOR BRIDGING.

1. BALD HEAD LIGHTHOUSE, 1851
2. FEDERAL POINT, 1913
3. KURE BEACH W.T., 1913
4. CAROLINA BEACH MUN. W.T., 1968
5. RUINS, 1917
6. MASON, 1918
7. WRIGHTSVILLE BEACH SOUTH MUN. W.T., 1962
8. WRIGHTSVILLE BEACH NORTH MUN. W.T., 1962
9. KIRKLAND, 1932
10. HAMPSTEAD 2, 1947
11. ATKINSON, 1914
12. SEARS LANDING, TANK 1943
13. BETHEA, 1932
14. GRANT, 1932

COMPILATION REPORT

TP-00705

31. DELINEATION

This map was compiled at a 1:10,000 scale as TP-00683 (Job CM-7218). It was delineated by tracing a 1:20,000 scale reduction of TP-00683 onto the projection for TP-00705. No compilation of this area was done at 1:20,000 scale. See the Descriptive Report for TP-00683 (Job CM-7218).

32. CONTROL

See Photogrammetric Plot Report, dated March 21, 1973.

33. SUPPLEMENTAL DATA

None.

34. CONTOURS AND DRAINAGE

Contours are inapplicable. Drainage was delineated from office interpretation of the photographs.

35. SHORELINE AND ALONGSHORE DETAILS

All details were traced from a 1:20,000 scale reduction of TP-00683 (Job CM-7218).

36. OFFSHORE DETAILS

None.

37. LANDMARKS AND AIDS

None.

38. CONTROL FOR FUTURE SURVEYS

None.

39. JUNCTIONS

See Form 76-36b, item No. 5, of the descriptive report.

40. HORIZONTAL AND VERTICAL ACCURACY

No statement.

46. COMPARISON WITH EXISTING MAPS

A comparison was made with the following U.S. Geological Survey quadrangle: Cape Fear, N.C., scale 1:24,000, dated 1942.

47. COMPARISON WITH NAUTICAL CHARTS

A comparison was made with the following National Ocean Survey charts: 1235, scale 1:80,000, 9th edition, dated May 11, 1971, and 426, scale 1:40,000, 11th edition, dated June 3, 1972.

ITEMS TO BE APPLIED TO NAUTICAL CHARTS IMMEDIATELY

None.

ITEMS TO BE CARRIED FORWARD

None.

Submitted by:

Albert C. Rauck, Jr. For

L.B. Foltz
Cartographic Aid
April 19, 1972

Approved:

Albert C. Rauck, Jr.

Albert C. Rauck, Jr.
Chief, Coastal Mapping Section, AMC

ADDENDUM TO COMPILATION REPORT

TP-00705

FIELD EDIT

Field edit was applied to the 1:10,000 scale manuscript of TP-00683 (Job CM-7218), photographically reduced to 1:10,000 scale, and traced to the manuscript of TP-00705. The mean high water line compiled from the 1972 color photographs was verified by comparison with the 1973 tide coordinated* color infrared photographs taken at mean high water, and corrected where necessary. The mean low water line was added at this time. See Form 76-36b.

Charles Parker
Cartographic Aid
April, 1975

*Based on predicted tides

16 Oct. 1975

GEOGRAPHIC NAMES

FINAL NAME SHEET

CM-7219 (Cape Fear to Cape Lookout, N.C.)

TP-00705

Atlantic Ocean

Bald Head Creek

Bald Head Island

Bluff Island

Cape Creek

Cape Fear

Deep Creek

East Beach

Fishing Creek

Frying Pan Shoals

Long Bay

Middle Island

Onslow Bay

Smith Island

Yellow Bluff

Approved by

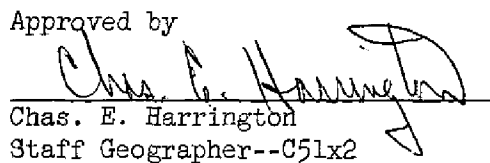
Chas. E. Harrington

Staff Geographer--C51x2

NOAA FORM 75-74
(2-74)U.S. DEPARTMENT OF COMMERCE
NOAA
NATIONAL OCEAN SURVEY

PHOTOGRAMMETRIC OFFICE REVIEW

TP-00705

1. PROJECTION AND GRIDS ALS	2. TITLE ALS	3. MANUSCRIPT NUMBERS ALS	4. MANUSCRIPT SIZE ALS
CONTROL STATIONS			
5. HORIZONTAL CONTROL STATIONS OF THIRD-ORDER OR HIGHER ACCURACY ALS	6. RECOVERABLE HORIZONTAL STATIONS OF LESS THAN THIRD-ORDER ACCURACY (Topographic stations) XX		7. PHOTO HYDRO STATIONS XX
8. BENCH MARKS XX	9. PLOTTING OF SEXTANT FIXES XX	10. PHOTOGRAMMETRIC PLOT REPORT ALS	11. DETAIL POINTS ALS
ALONGSHORE AREAS (Nautical Chart Data)			
12. SHORELINE ALS	13. LOW-WATER LINE XX	14. ROCKS, SHOALS, ETC. ALS	15. BRIDGES XX
16. AIDS TO NAVIGATION XX	17. LANDMARKS XX	18. OTHER ALONGSHORE PHYSICAL FEATURES ALS	19. OTHER ALONGSHORE CULTURAL FEATURES XX
PHYSICAL FEATURES			
20. WATER FEATURES XX	21. NATURAL GROUND COVER NA		22. PLANETABLE CONTOURS NA
23. STEREOSCOPIC INSTRUMENT CONTOURS NA	24. CONTOURS IN GENERAL NA	25. SPOT ELEVATIONS NA	26. OTHER PHYSICAL FEATURES XX
CULTURAL FEATURES			
27. ROADS ALS	28. BUILDINGS ALS	29. RAILROADS XX	30. OTHER CULTURAL FEATURES XX
BOUNDARIES			
31. BOUNDARY LINES NA		32. PUBLIC LAND LINES NA	
MISCELLANEOUS			
33. GEOGRAPHIC NAMES ACR	34. JUNCTIONS ALS		35. LEGIBILITY OF THE MANUSCRIPT
36. DISCREPANCY OVERLAY ALS	37. DESCRIPTIVE REPORT ACR	38. FIELD INSPECTION PHOTOGRAPHS XX	39. FORMS ACR
40. REVIEWER <i>A.L. Shands</i> A.L. Shands 4/19/73		SUPERVISOR, REVIEW SECTION OR UNIT <i>Albert C. Rauck, Jr.</i> Albert C. Rauck, Jr.	
41. REMARKS (See attached sheet)			
FIELD COMPLETION ADDITIONS AND CORRECTIONS TO THE MANUSCRIPT			
42. Additions and corrections furnished by the field completion survey have been applied to the manuscript. The manuscript is now complete except as noted under item 43.			
COMPILER <i>Charles Parker</i> Charles Parker <i>Frank Margiotta</i> Frank Margiotta		SUPERVISOR <i>Albert C. Rauck, Jr.</i> Albert C. Rauck, Jr.	
43. REMARKS Field edit applied graphically by use of manuscript (TP-00683) reduction made from 1:10,000 to 1:20,000 scale and applied to this manuscript (TP-00705)			



**U.S. DEPARTMENT OF COMMERCE
National Oceanic and Atmospheric Administration**

Photo Party 62
P.O. Box 3044
Wilmington, N.C. 28401

Date: 12 Dec. 1973

Reply to
Attn of: Chief, Photo Party 62

Subject: Field Edit Report
TP-00705
Cape Fear
To: Coastal Mapping Compilation Section CAM 521

51. Methods

All deletions, additions, corrections and answers to office questions are referred to on the "FIELD EDIT OZALID - Field Copy". All field edit writing is in purple ink, except that deletions are in green ink.

Roads of photo E-6868 were inadvertently classified as per page 424 of Topographic Manual Part II.

- * MHWL measurements were made with a tape from hydrographic control stations, see attachments to Field Edit Report for TP-00683.

52. Accuracy of compilation

The compilation will be complete and adequate when field edit information is included.

53. Map accuracy

No accuracy tests were made.

54. Recommendations

None.

55. Examination of proof copy

Mr.- Jerry R. Mitchell of Wm. F. Freeman Associates has done a great deal of land surveying in this area. He recommends that what is now named Smith Island on the charts be named ~~Smith~~ Bald Head Island. His mailing address and phone number are: Mr. Jerry R. Mitchell
Wm. F. Freeman Associates
P.O. Box 2103
High Point, N.C. 27261

Phone: 885-4031

- * These measurements, made in the summer of 1973, are superseded by tide coordinated infrared photography taken at MHW, based on predicted tides, in October 1973.

Charles H Bishop
Final Review
6-14-76

Also intimately acquainted with the island is Mr. David Wakefield
Carolina Cape Fear Corporation
P.O. Box 6
Southport, North Carolina 28461

phone: 919-457-6763

56. Field editors

Field edit of this manuscript was done by Lt.(jg) R. David Black and Mr. Joel J. Marin. Work was supervised by Mr. Robert S. Tibbetts, Chief Photo Party 62. If there are any questions concerning this field edit, please contact Chief, Photo Party 62 at the address above, or phone FTS 919-763-9544 or commercial 919-763-9971 Ext. 544.

R. David Black
R. David Black
Lt.(jg) NOAA

STATION NAME	X coordinate	Y coordinate	Distance to MHWL
B1	2,301,211.23	41,451.06	23 ft. —
B2	2,302,103.14	40,811.87	29 ft. —
B3	2,303,474.70	40,167.99	93 ft. —
B4	2,304,568.30	39,653.96	22 ft. —
B5	2,305,959.25	39,221.89	80 ft. —
B6	2,307,244.91	38,706.45	19 ft. —
B7	2,308,617.68	38,252.26	91 ft. —
B8	2,309,988.38	37,650.15	137 ft. —
B9	2,311,291.43	36,901.99	69 ft. —
B10	2,312,273.19	36,431.30	149 ft. —
B11	2,313,682.47	35,420.53	27 ft. —
B12	2,315,322.68	35,831.75	272 ft. —
BUZZARD 1962	2,316,552.56 ^{1.90}	48,813.65 ³⁷	225 ft. —
VUB	2,317,465.48	53,275.61 ¹³	239 ft. —
MARK	2,315,542.29	40,396.33	145 ft. —
BAT	2,320,178.43	64,752.77	
COW	2,320,579.69	66,154.67	
ACE	2,319,759.41	63,347.88	
DUN	2,319,146.63	58,932.30	47 ft. —
RED	2,319,925.21	61,855.34	
OL1	2,319,596.47	60,621.14	10 ft. —
POL	2,317,961.30	55,879.23	290 ft. —
OL2	2,318,549.95	57,395.42	264 ft. —

STATION NAME

x coordinate

y coordinate

Distance
to MHWL

312	2,315,183.06	34,852.77	12 ft.
OL 3	2,317,294.00	52,162.36	163 ft.
OL 4	2,316,826.94	49,853.38	183 ft.
RAT	2,317,092.71	50,858.36	138 ft.
SIG	2,315,893.75	42,992.72	115 ft.
321	2,316,396.68	47,487.87	142 ft.
320	2,316,180.03	45,637.72	91 ft.
319	2,316,013.12	44,212.33	158 ft.
PR1	2,317,576.03	54,360.36	346 ft.
317	2,315,744.54	41,694.72	91 ft.
315	2,315,470.21	39,049.89	210 ft.
314	2,315,422.39	37,306.50	227 ft.

REVIEW REPORT TP-00705

SHORELINE

June 21, 1976

61. GENERAL STATEMENT:

Since this map is a copy of 1:10,000 scale Map TP-00683 (Job CM-7218), that map was reviewed first. Then TP-00705 was reviewed to verify that it is in complete agreement with TP-00683. See Summary, which is page 6 of this Descriptive Report.

A comparison print, showing differences noted in Paragraph 62, 63, 64, and 65, is bound with the original of this report.

62. COMPARISON WITH REGISTERED TOPOGRAPHIC SURVEYS:

A comparison of the ocean shoreline was made with a copy of Survey T-8203, 1:20,000 scale, dated 1942. Significant differences are shown on the comparison print in blue.

In the area compared, TP-00705 and TP-00683 (from which TP-00705 was copied) supersede T-8203 for nautical chart construction purposes. T-8203 is the latest registered prior survey of the area.

63. COMPARISON WITH MAPS OF OTHER AGENCIES:

A comparison of the ocean shoreline was made with U.S.G.S. Quadrangle CAPE FEAR, N.C., 1:24,000 scale, dated 1946. The mean high water line on the U.S.G.S. quadrangle coincides with the mean high water line on T-8203 and is shown on the comparison print with the same blue line.

64. COMPARISON WITH CONTEMPORARY HYDROGRAPHIC SURVEYS:

A comparison was made with a copy of the verified smooth sheet for Survey H-9398 (PE-20-3-73). Significant differences are shown on the comparison print in purple.

65. COMPARISON WITH NAUTICAL CHARTS:

A comparison was made with Chart 11537, 1:40,000 scale, 14th edition, dated March 8, 1975. Significant shoreline differences are shown in red on the comparison print.

66. ADEQUACY OF RESULTS AND FUTURE SURVEYS:

This map complies with Instructions - OFFICE - Job CM-7219, Cape Fear to Cape Lookout, North Carolina, Shoreline Mapping, except that more interior detail was mapped than required. The map meets requirements for Bureau Standards and National Standards of Map Accuracy.

Submitted:

Charles H. Bishop

Charles H. Bishop
Cartographer
June 21, 1976

Approved for forwarding:

Joseph W. Vonasek

Joseph W. Vonasek
Chief, Photogrammetric Branch, AMC

Approved:

J. H. Blankenhorn
Sr A. K. Heywood

Chief, Photogrammetric Branch JB

Walter D. Simmons

Chief, Coastal Mapping Division

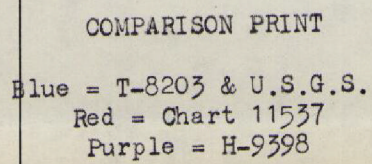

TP-00705
1:20,000

COMPARISON PRINT

Blue = T-8203
 and
 U.S.G.S.
 Red = Chart 11537
 Purple = H-9398

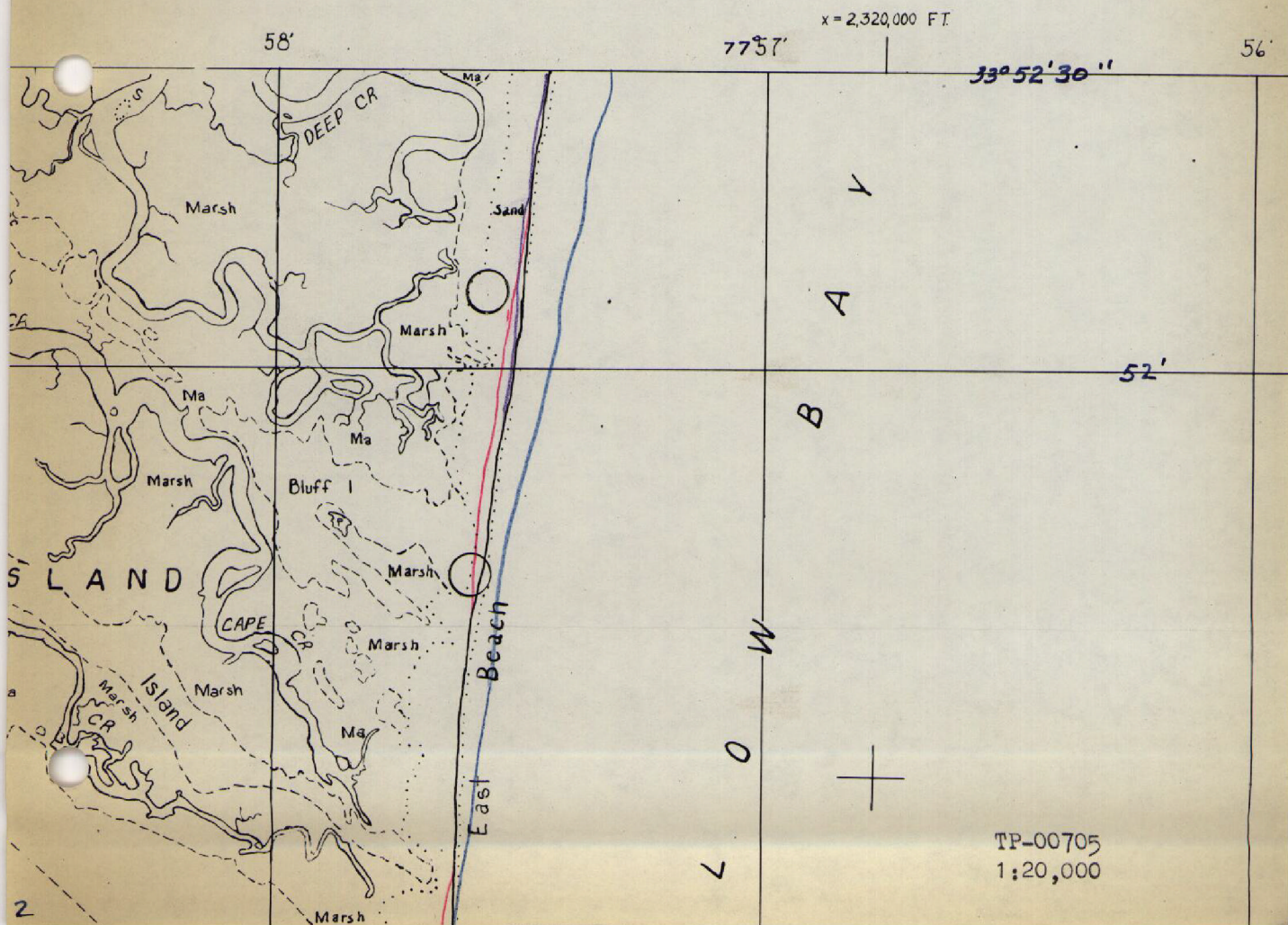

26

 $77^{\circ} 57'$

Blue = T-8203
and
U.S.G.S.
Red = Chart 11537
Purple = H-9398

50'

49'

TP-00705
1:20,000

CAPE
FEAR

Subject to
Frequent Change

Fr ying

Breakers

54021

par

5hoad

Shoals

LIMIT

~~11~~
OF

STEREO

COVERAGE

Wreck not visible on photos,
not on H-9398, and not
observed ^{directly} by field editor.

Breakers

Breaker

1

T

Island

△

4

C

3

