

10315

Diag. Cht. No. 1240-2.

Form 504

U. S. DEPARTMENT OF COMMERCE
COAST AND GEODETIC SURVEY

DESCRIPTIVE REPORT

Type of Survey Planimetric

Field No. Ph-154 Office No. T-10315

LOCALITY

State South Carolina

General locality St. Helena Sound

Locality Fripp Inlet

1955

CHIEF OF PARTY

J.E. Waugh, Chief of Field Party
W.F. Deane, Balto. District Officer

LIBRARY & ARCHIVES

DATE November 17, 1961

USCOMM-DC 5087

10315

DATA RECORD

T - 10315

Ph-154

Project No. (II): *PABA* Quadrangle Name (IV):

Field Office (II): *Burton, S. C.*

Chief of Party: *J. E. Waugh*

Photogrammetric Office (III): *Baltimore, Md.*

Officer-in-Charge: *William F. Deane*

Instructions dated (II) (III): *16 August 1955 (Field and Office)*

Copy filed in Division of
Photogrammetry (IV)

Method of Compilation (III): *Graphic*

Manuscript Scale (III): *1:10,000*

Stereoscopic Plotting Instrument Scale (III):

Scale Factor (III): *None*

Date received in Washington Office (IV):

Date reported to Nautical Chart Branch (IV):

Applied to Chart No.

Date:

Date registered (IV): *17 Feb 1960*

Publication Scale (IV):

Publication date (IV):

Geographic Datum (III): *N.A. 1927*

Vertical Datum (III): *M. H. W.*

Mean sea level except as follows:
Elevations shown as (25) refer to mean high water
Elevations shown as (5) refer to sounding datum
i.e., mean low water or mean lower low water

Reference Station (III): *CHAN, 1933*

Lat.: *32° 21' 45.050" (1387.7 m)* Long.: *80° 29' 09.979" (260.9 m)*

Adjusted
Adjusted

Plane Coordinates (IV):

State: *South Carolina* Zone: *South*

Y=

X=

Roman numerals indicate whether the item is to be entered by (II) Field Party, (III) Photogrammetric Office,
or (IV) Washington Office.

When entering names of personnel on this record give the surname and initials, not initials only.

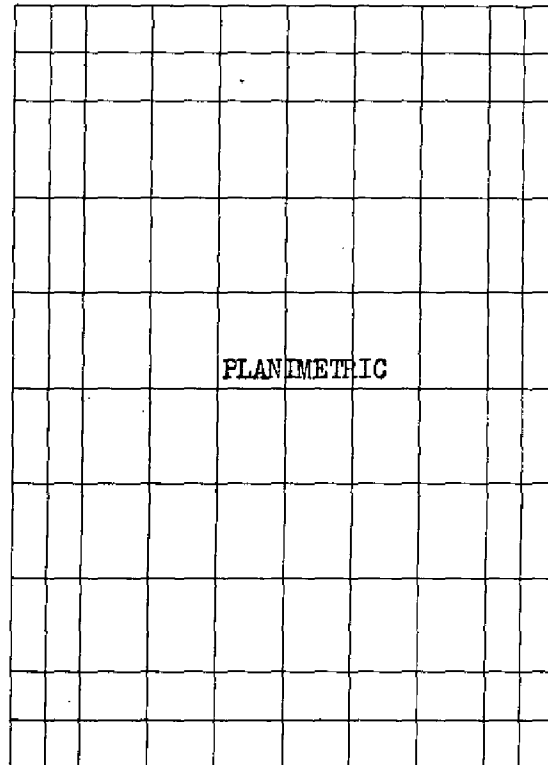

Areas contoured by various personnel
(Show name within area)
(II) (III)

DATA RECORD

Field Inspection by (II): M. C. Moody Date: Sept. 1955
J. S. Winter Sept. 1955

Planetable contouring by (II): Date:

Completion Surveys by (II): Date:

Mean High Water Location (III) (State date and method of location):

Photographs dated March 1955 and November 1955, supplemented
by field inspection.

Projection and Grids ruled by (IV): A. Riley Date: 8/19/55

Projection and Grids checked by (IV): A. Riley Date: 8/19/55

Control plotted by (III): Frank M. Wisiecki Date: 10/31/55

Control checked by (III): Albert Queen Date: 11/1/55

Radial Plot ~~by Stereoscopic~~ Date: 11/ 8/55
~~Control extension~~ by (III): E. L. Williams

Planimetry Date:

Stereoscopic Instrument compilation (III):
Contours Date:

Manuscript delineated by (III): Ruth M. Whitson Date: 8/8/58

Photogrammetric Office Review by (III): H. R. Rudolph Date: 10/58

Elevations on Manuscript
checked by (II) (III): Date:

Camera (kind or source) (III): C&GS Nine-lens

Number	Date	Time	Scale	Stage of Tide
49324 thru 49326	3/23/55	1443	1:10,000	0.2' above MLW
52235 thru 52237	11/21/55	1035	"	5.2' " "
52242	11/21/55	1047	"	5.4' " "

Tide (III)
From Predicted Tides

Reference Station: Savannah River Entrance, S. C.
Subordinate Station: Fripp Inlet, Hunting Island
Subordinate Station:

Ratio of Ranges	Mean Range	Spring Range
	6.7	8.1
	6.2	7.3

Washington Office Review by (IV):

D.K. Stinson

Date: Aug 1959

Final Drafting by (IV):

Date:

Drafting verified for reproduction by (IV):

Date:

Proof Edit by (IV):

Date:

Land Area (Sq. Statute Miles) (III): 8
Shoreline (More than 200 meters to opposite shore) (III): 16
Shoreline (Less than 200 meters to opposite shore) (III): 23
Control Leveling - Miles (II):
Number of Triangulation Stations searched for (II): 5 Recovered: 3 Identified: 3
Number of BMs searched for (II): 2 Recovered: 0 Identified:
Number of Recoverable Photo Stations established (III):
Number of Temporary Photo Hydro Stations established (III):

Remarks:

Number of Third-Order Stations established: 3 Identified: 1
Number of Recoverable Topographic Stations established: 2

SHORELINE MAPPING PROJECT 6154

ST. HELENA SOUND TO PORT ROYAL SOUND; S. CAROLINA

5

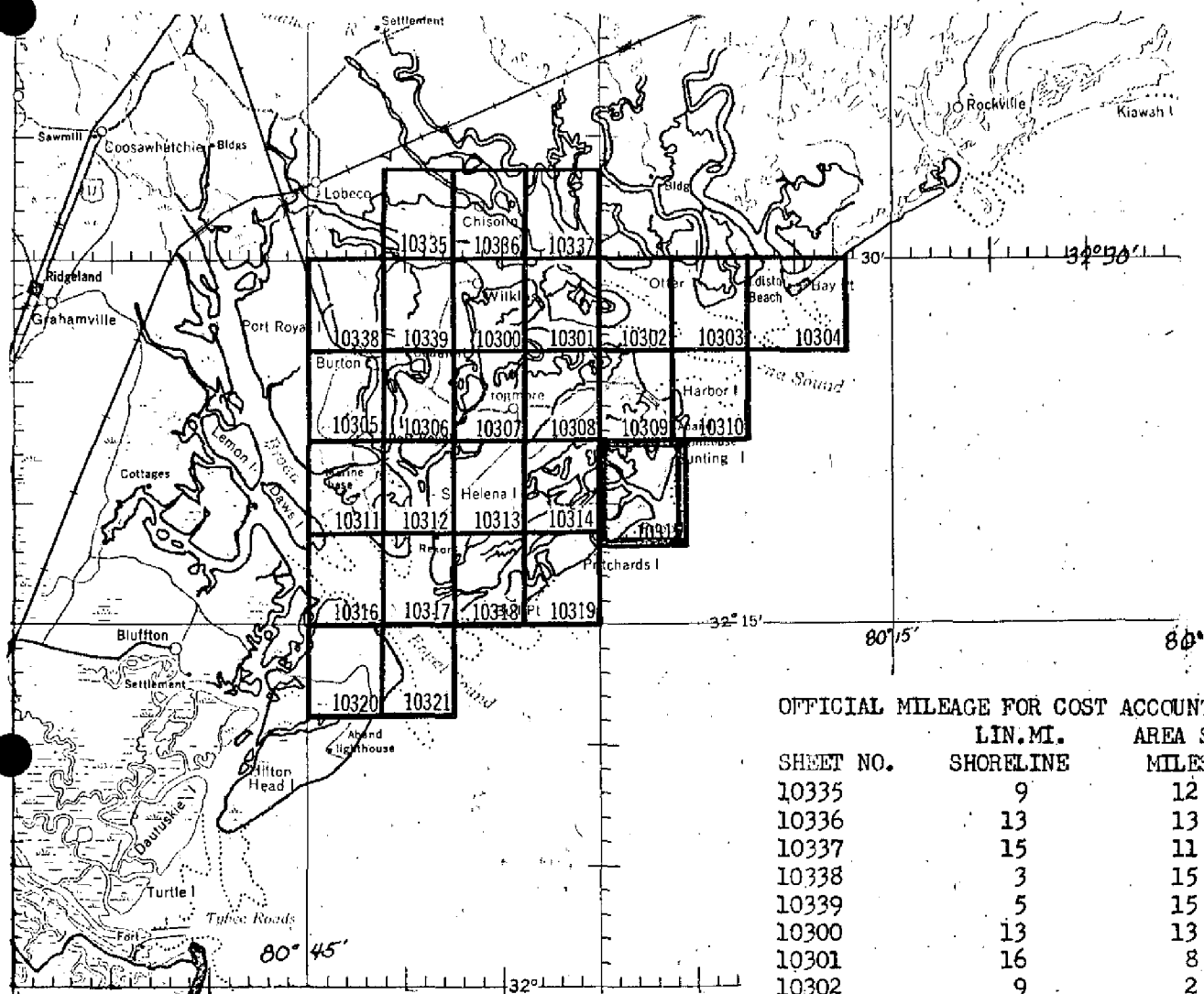

OFFICIAL MILEAGE FOR COST ACCOUNTS

SHEET NO.	LIN. MI. SHORELINE	AREA SQ. MILES
10335	9	12
10336	13	13
10337	15	11
10338	3	15
10339	5	15
10300	13	13
10301	16	8
10302	9	2
10303	9	3
10304	7	3
10305	6	15
10306	13	13
10307	8	14
10308	3	15
10309	13	11
10310	3	1
10311	9	12
10312	16	12
10313	6	15
10314	13	13
10315	13	8
10316	9	2
10317	8	4
10318	13	9
10319	9	4
10320	4	15
10321	5	1

TOTALS 250

259

FIELD INSPECTION REPORT
Project 6154

MAPS
T-10302, T-10303, T-10304,
T-10309, T-10310, T-10315

2. AREAL FIELD INSPECTION

The area comprising these maps lies in and around St. Helena Sound, along and adjacent to the outer coast. Portions of Edisto Island, Pine Island, Otter Island, Hutchinson Island, Ashe Island, Morgan Island, St. Helena Island, Fripp Island, and all of Hunting and Harbor Islands fall within the limits of these sheets.

A part of Maps T-10302, T-10303 and T-10304 (the area north of St. Helena Sound) are a portion of Topographic Mapping Project 6081 (Quadrangles T-11123 and T-11124). These quadrangles were completed in 1955 by this party, therefore, field work was not duplicated during the course of operations for this project.

An alternate route of the Intracoastal Waterway runs through Maps T-10302, T-10303, T-10309 and T-10315. U. S. Highway 21 connects Hunting Island with Beaufort. Hunting Island is owned and operated by the South Carolina State Park System. There are no railroads within the area.

The land area is sparsely settled and is composed of numerous small farms. Truck farming and fishing are the chief occupations.

The quality of the photographs was in general very good. The photographs were flown at or near the time of low water, which enabled the field inspector to delineate many of the mud flats, shoal and shallow areas.

There are three distinct photographic tones near the tidal marshes. The very dark tones are marsh. The white tones are sand. The tones which are light grey, are mud.

Swamp limits and inshore limits of marsh have been outlined on the photographs in red. There are no cypress swamps in this area. The predominating swamp trees are gum and bay.

Field inspection notes appear on 1:10,000 scale, nine-lens photographs Nos.: 49324 thru 49327; 49329; 49358 thru 49361; 49397; 49398; and 49406 thru 49409.

3. HORIZONTAL CONTROL

All Fixed Aids to Navigation were located by triangulation, with the exception of MARSH ISLAND SPIT LIGHT. Three of the fixed aids were identified on the photographs for control of the radial plot.

Two new third-order stations were established in Map T-10315 (INLET 2, 1955 and SHELL, 1955). The finial of the light at the center of the draw span over Harbor River (Map T-10309) was located by triangulation.

Triangulation stations TREE, 1934 (Map T-10310), and EGG 4, 1933 (Map T-10309) were not recovered. The establishment and identification of new stations in the vicinity was not required. (See letter from Chief Photogrammetry Division to CDR J. E. Waugh, dated 20 September 1955, 73-mkl.)

Triangulation station PALMETTO, 1933 (Map T-10309) has been shown as doubtful on the control station identification card. This station is a tree and was positively verified by triangulation. It is marked doubtful only because of the height of the tree.

A temporary point was established by triangulation near station INLET 2, 1955. A sub-point for TEMPORARY, 1955 is enclosed with the control data.

Triangulation stations in the area north of St. Helena Sound, which is a part of Topographic Mapping Project 6081 (Quadrangles T-11123 and T-11124), were not re-identified and in most cases a new recovery note was not written. (For data concerning this area, see Field Inspection Reports for Quadrangles T-11123 and T-11124.)

The following stations are reported as "Lost":

T-10302

BEK, 1934
FLASH, 1933
GREEN BEACON, 1933
GUS, 1934
HUTCHINSON, 1857
HUTCHINSON 2, 1933

T-10303

ASH, 1914
COMBAHEE BEACON, 1933
RED BEACON, 1933
SOUND, 1933

T-10309

BUTCHERS ISLAND, 1857
EGG 4, 1933
WHARF, 1933

T-10310

TREE, 1934

T-10315

FRY, 1933
INLET, 1933

4. VERTICAL CONTROL

All tidal bench marks, within the area of these maps, were searched for and reported on Form 685.

5. CONTOURS AND DRAINAGE

Contouring is inapplicable to this project.

Drainage for the area is, in most cases, tidal, except for a few ditches which drain swamp, marsh and cultivated land.

6. WOODLAND COVER

The woodland cover has been classified in accordance with requirements for topographic maps, reference 5433, Topographic Manual, Part II.

7. SHORELINE AND ALONGSHORE FEATURES

The mean high-water line was located along the ocean beach by measurements to identifiable objects on the photographs, and/or by plane table methods for the areas near inlets and points which have rapid changes. Other portions of the mean high-water line were symbolized by visual inspection. (See Field Inspection Reports for Quadrangles T-11123 and T-11124, Project 6081, for the areas north of St. Helena Sound.)

An approximate low-water line has been shown in example areas along the outer beach and in numerous areas near the tidal marshes. The limits of shoal and shallow areas has been shown in many cases.

There are no bluffs or cliffs of landmark value within the area.

There are three submarine cables in Map T-10309. Two cross Harbor River alongside the bridge on U. S. Highway 21, and one crosses Johnson Creek alongside U. S. Highway 21.

All other shoreline structures are adequately covered by the field inspection photographs.

8. OFFSHORE FEATURES

The foreshore of the Ashepoo, Combahee, Harbor, Morgan, and

South Edisto Rivers is generally mud. There are a few places where it is sand, or sand and mud. The foreshore along the outside coast and the entrance to St. Helena Sound is for the most part sand.

The mean low-water line has been shown with an approximate symbol. (See Headings 2 and 7 of this report.)

Two piles were located near EGG BANK PASSAGE DAYBEACONS A 4 and A 5. (See back of photograph 49406.)

9. LANDMARKS AND AIDS

Two nautical landmarks, which had been previously charted, are recommended. These landmarks are: TOWER (Aband. L.H.), and WINDMILL - both of which are located in Map T-10309. TOWER is the same as HUNTING ISLAND LIGHTHOUSE, 1902. WINDMILL is plotted on Survey T-5187 (1933) as triangulation station WINDMILL 1933. No Geographic Position was furnished the field party.

There are no interior landmarks recommended. There are no aeronautical aids.

Fixed Aids to Navigation were located by triangulation, with one exception, as explained in Heading 3 of this report.

10. BOUNDARIES, MONUMENTS AND LINES

There are two areas within these maps which require boundary data. They are namely: Hunting Island State Park, and the county line between Beaufort and Colleton Counties. These boundaries have been outlined on the photographs. For further information, see "Special Boundary Report, Project 6081", submitted on 28 April 1955, and the Special Boundary Report for this project.

11. OTHER CONTROL

The following recoverable topographic stations were established:

<u>T-10303</u>	<u>T-10304</u>	<u>T-10309</u>	<u>T-10310</u>	<u>T-10315</u>
ACHE, 1954	ISLE, 1954	ZEAL, 1955	MALE, 1955	FIRE, 1955
LITE, 1954	PIPE, 1954			RAMP, 1955
TRAY, 1954	SEAT, 1954			
	SHED, 1954			
	WELL, 1954			

12. OTHER INTERIOR FEATURES

All roads and buildings were classified in accordance with Project Instructions. There are no airports or landing fields within the area.

The following bridge clearances and cable crossings are tabulated in accordance with Project Instructions. The measurements of the clearances, as determined by the field party in 1955, are listed on the first line. The second line lists those shown in the U. S. Engineers List of Bridges Over Navigable Waters of the United States:

	<u>Vertical Clearance</u>	<u>Horizontal Clearance</u>
Harbor River	15.6 ft.	60.7 ft. East Draw - 61.7 ft. West Draw
Swing Bridge	15.0 ft.	64.0 ft. East Draw - 64.0 ft. West Draw
Johnson Creek	8.1 ft.	37.3 ft.
Fixed Bridge	6.0 ft.	36.0 ft.

Johnson Creek Overhead Power Cable is 17.5 ft. above mean high-water.

13. GEOGRAPHIC NAMES

See Special Report, Geographic Names, for this project.

14. SPECIAL REPORTS AND SUPPLEMENTAL DATA

Special Report on Displaced Fixed Aids to Navigation, forwarded to the Director in Pkg. No. 55-35, dated 19 September 1955.

Data for Map T-11123, Project 6081, forwarded to the Baltimore District Officer in Pkg. Nos. 55-29 and 55-30, dated 26 August 1955.

Data for Map T-11124, Project 6081, forwarded to the Baltimore District Officer in Pkg. No. 55-26, dated 25 August 1955, and Pkg. No. 55-33, dated 1 September 1955.

Original copies of Form 526 for Project 6081 were forwarded to the Director in Pkg. No. 54-56, dated 12 November 1954.

Coast Pilot Notes, Project 6081, forwarded to the Director
on 27 May 1954.

Special Reports to be submitted for the project as a whole:

Boundaries
Geographic Names
Coast Pilot
Triangulation for Supplemental Control
Cards for recovery of Geodetic Control

Submitted by:

18 OCT 1955

Joseph K. Wilson
Joseph K. Wilson
Cartographer

Approved & Forwarded:

18 OCT 1955

J. E. Waugh
J. E. Waugh
CDR, C & GS
Chief of Party

PHOTOGRAMMETRIC PLOT REPORT
Project No. 6154
Survey Nos. T-10300 thru T-10302
T-10309 and T-10310
T-10315
T-10336 and T-10337

21. AREA COVERED

This radial plot covers the area of surveys T-10300, T-10301, T-10302, T-10309, T-10310, T-10315, T-10336 and T-10337. These are planimetric surveys along Coosaw River and St. Helena Sound, South Carolina.

22. METHOD - RADIAL PLOT

Map manuscripts and base grids:

Vinylite sheets with polyconic projections in black and South Carolina State Grid, South Zone, in red were furnished by the Washington office.

Vinylite sheets with 5,000 foot grids were used as base sheets.

All control points and substitute points were plotted using the beam compass and meter bar method. All identified control was transferred to the base sheets by matching common grid lines.

A sketch showing the layout of surveys, distribution of control and photograph centers, and a list of control stations are attached to this report.

Photographs:

Forty-four (44) nine-lens photographs at a scale of 1:10,000, taken in 1955 and two (2) nine-lens photographs at a scale of 1:10,000 taken in 1952 were used in the plot. They are numbered as follows:

35750 and 35751
49263 through 49265
49323 through 49328
49358 through 49364
49393 through 49399
49406 through 49411
49444 through 49449
49479 through 49485
49526 through 49531

Templets:

Vinylite templets were made from all photographs, using a master templet to correct for film and paper distortion, and chamber displacements.

22. METHOD - RADIAL PLOT (cont'd)

Closure and adjustment to control: (cont'd)

The radial plot was assembled in two sections. The first section covered the areas of sheets T-10302, T-10309, T-10310, and T-10315, with extensions to reach surrounding control. Along the north side of T-10302, where there is only a small break in the land area, templets used in the adjoining radial plot for survey T-11123, Project 6081 were laid first, holding control points established in that plot. Photographs 49406 through 49411, the flight reaching the most control points was then laid, followed by the flight to the SE and the flights to the NW, tying into the adjoining plot for Project 6081. The second section of the plot was an extension of the first to cover the areas of sheets T-10300, T-10301, T-10336, and T-10337, with extensions to reach surrounding control.

Station WHARF RM No. 1, 1933, could not be held in the plot. (See item 23).

Transfer of Points:

The position of all pass points, photo points and photo centers were pricked directly on the map manuscript by superimposing the manuscript on the completed plot and matching common grid lines.

23. ADEQUACY OF CONTROL

The density and distribution of control was adequate.

The following control could not be held in the radial plot:

WHARF, 1933 RM 1 - The radially plotted position of the substitute point falls approximately 1.0 mm to the N of the plotted position. The identification on the photographs is positive and no explanation for failing to hold this sub. pt. can be given by this office.

PALMETTO, 1933 - This station is a lone tree. On photographs 49326, 49327 and 49317, the upper portion of the tree was visible, but the location of the base could not be determined. The trunk of the tree was pricked on these photographs, and the station was held in the radial plot. On all other photographs the field identification was transferred stereoscopically. The station could not be held in the radial plot on any of these photographs. This station was marked doubtful in the field because of the height of the tree.

BOLD, 1934 - The substitute point was a palmetto, identified on a 1952 photograph. It was held on photograph 35751. A attempt was made to transfer the point to the 1955 photographs, but the transferred point could not be held. Transfer was unsuccessful because of complete change in the photographic detail in the immediate vicinity.

In sheet T-10309, station WINDMILL, 1955 was established by radial plot as a landmark for charts. The position established is doubtful as the image of the windmill on the photographs was very faint and blended with the surrounding detail.

24. SUPPLEMENTAL DATA

No graphic control surveys were used: in this radial plot.

25. PHOTOGRAPHY

The photographic coverage and definition of the photographs were adequate. Some difficulty was experienced in laying the radial plot because of missing fiducial marks. Some were in light struck areas and others were in portions of chambers that printed blank. All were along the outer edge of the photographs. The following fiducial marks were missing: One mark in chamber No. 4 in photographs 49479, 49480, 49481 and 49483. One mark in chamber No. 4 and one mark in chamber No. 5 on photographs, 49483, 49485. One mark in chamber No. 4 and one mark in chamber No. 8 on photographs 49482 and 49484. Two marks in chamber No. 1 on photograph 49447. Two marks in chamber No. 3 on photograph 49446.

The following photographs are tilted: 35751, 49396, 49397, 49445, 49446, 49447, 49449, 49482, 49485 and 49530. It was not considered necessary to have these photographs rectified in order to hold them in the plot: graph.

Respectfully submitted
4 January 1956

B. Frank Lampton, Jr.

B. Frank Lampton,
Carto. Photo. Aid

LIST OF CONTROL STATIONS
Project 6154

No.	Name	Identification
1.	CHISOLM SPIRE, 1933	Direct
2.	SANDERS, 1933	Sub. Pt.
3.	PIGEON, 1933	Sub. Pt.
4.	OYSTER FACTORY TALL STACK, 1933	Direct
5.	FIELD, 1934	Sub. Pt.
6.	CAT, 1934	Sub. Pt.
7.	CHISOLM, 1932	Sub. Pt.
8.	REPEAL, 1934	Sub. Pt.
9.	HORSE, 1933	Direct
10.	AINSLIE, 1933	Sub. Pt.
11.	AUSTIN, 1933	Sub. Pt.
12.	SAMS, 1933	Sub. Pt.
13.	COOSAW, 1933	Sub. Pt.
14.	LOVE, 1933	Sub. Pt.
15.	LUCY, 1933	Sub. Pt.
16.	HOPE, 1933	Sub. Pt.
17.	LADY, 1933	Sub. Pt.
18.	CORRA, 1933	Sub. Pt.
19.	BF-516, S.C. Geod. S., 1934	Sub. Pt.
20.	BOLD, 1934	Sub. Pt.
21.	HANGMAN 3, 1955	Not ident.
22.	HANGMAN 2, 1933	Sub. Pt.
23.	ASHEPOO - COOSAW CUTOFF LT. 184, 1955	Direct
24.	PARROT 2, 1933	Sub. Pt.
25.	SAW, 1933	Sub. Pt.
26.	GAN, 1933	Sub. Pt.
27.	VIL, 1933	Not. ident.
28.	HELENA, 1933	Sub. Pt.
29.	CHERRY HILL KNOLL, 1856	Sub. Pt.
30.	PINE, 1933	Sub. Pt.
31.	STORY 2, 1933	Sub. Pt.
32.	(600 FT. LEFT) USE, 2494 + 30.43, 1941	Sub. Pt.
33.	HUTCHINSON 2, 1933, RM 2	Sub. Pt.
34.	CENTRAL, 1933	Sub. Pt.
35.	POD, 1934	Not Ident.
36.	MOR 3, 1933	Sub. Pt.
37.	COFFIN, 1933	Sub. Pt.
38.	PELICAN BANK DAYBEACON A2, 1955	Direct
39.	EGG BANK PASSAGE DAYBEACON A4, 1955	Direct
40.	EGG BANK PASSAGE DAYBEACON A5, 1955	Not Ident.

LIST OF CONTROL STATIONS
Project 6154 (cont'd)

No.	Name	Identification
41.	EGG BANK PASSAGE DAYBEACON A7, 1955	Direct
42.	EGG BANK PASSAGE DAYBEACON A9	Direct
43.	EGG BANK PASSAGE DAYBEACON A11	Direct
44.	BOR, 1933	Sub. Pt.
45.	WHARF, 1933, RM 1	Sub. Pt.
46.	HARBOR RIVER DAYBEACON A13, 1955	Direct
47.	PALMETTO, 1933	Direct
48.	MID, 1933	Sub. Pt.
49.	HUNTING ISLAND LIGHT HOUSE, 1902	Direct
50.	HARBOR RIVER DAYBEACON A14	Direct
51.	CHAN, 1933	Sub. Pt.
52.	BOG ISLAND, 1857	Sub. Pt.
53.	SHELL, 1955.	Not ident.
54.	WEE, 1933	Sub. Pt.
55.	INLET 2, 1955	Not ident.
56.	TEMPORARY, 1955	Sub. Pt.
57.	JEFF, 1933	Sub. Pt.
58.	ASH, 1914	Direct
59.	COMBAHEE BANK LIGHT, 1955	Direct
60.	PELICAN BANK DAYBEACON A1, 1955	Direct

LAYOUT SKETCH

PROJECT 6184

Survey No. T-10329, T-10337, T-10300,
T-10301, T-10302, T-10309, T-10310,
and T-10315

- OFFICE PHOTOGRAPHS
- ▲ CONTROL STATION Identified
- △ CONTROL STATION Not Identified
- CONTROL STATION Not held in plot

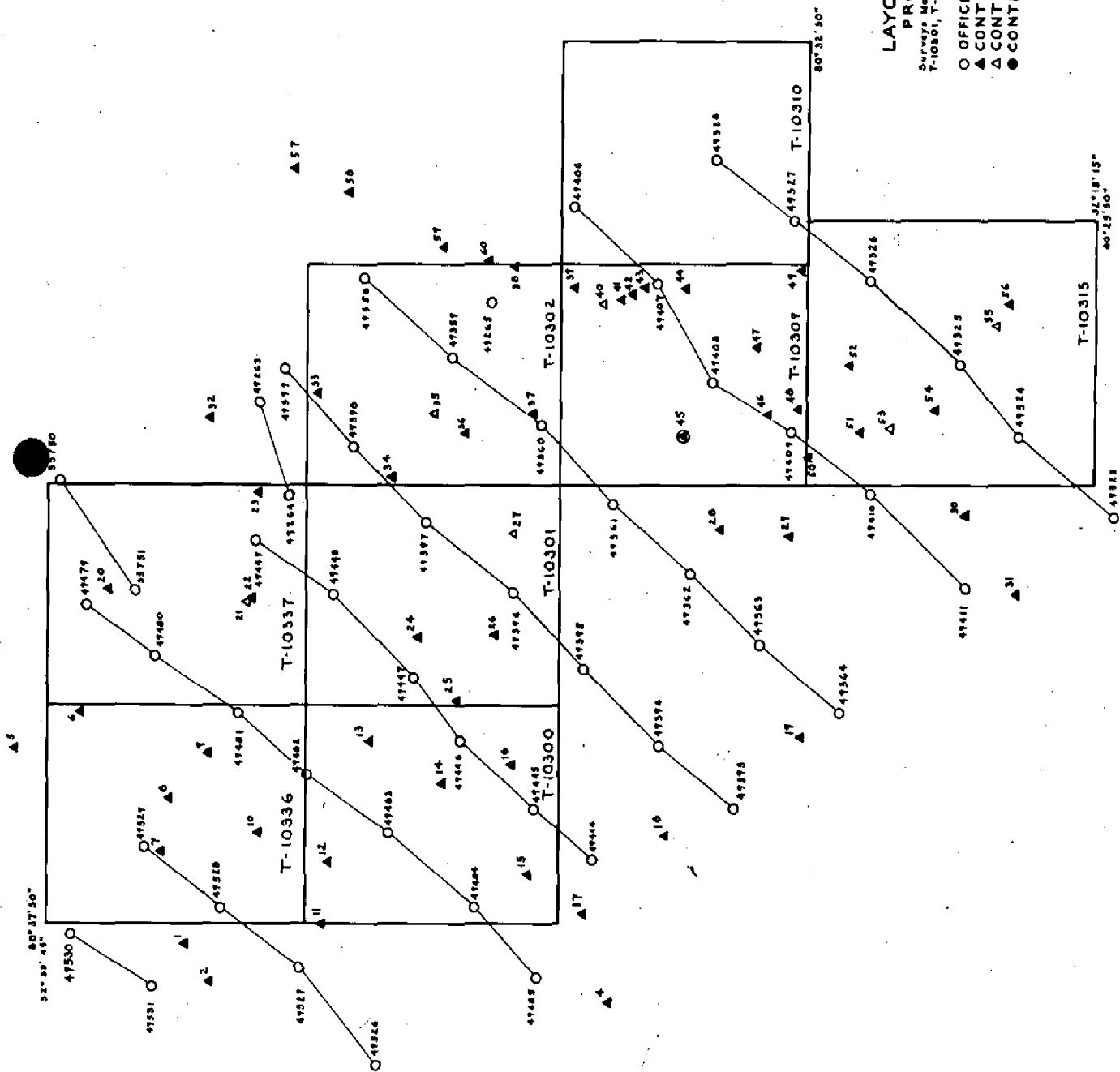

U.S. DEPARTMENT OF COMMERCE
COAST AND GEODETIC SURVEY
DESCRIPTIVE REPORT
CONTROL RECORD

MAP T. 10315

PROJECT NO. Ph-154

SCALE OF MAP 1:10,000

SCALE FACTOR

STATION	SOURCE OF INFORMATION (INDEX)	DATUM	LATITUDE OR ψ -COORDINATE LONGITUDE OR x -COORDINATE		DISTANCE FROM GRID IN FEET. OR PROJECTION LINE IN METERS		DATUM CORRECTION	N.A. 1927 - DATUM DISTANCE FROM GRID OR PROJECTION LINE IN METERS		FACTOR DISTANCE FROM GRID OR PROJECTION LINE IN METERS	
			•	"	FORWARD	(BACK)		FORWARD	(BACK)	FORWARD	(BACK)
STORY RIVER, 1955 DAYEN. "A 16"	Field Comp.	NA 1927	32	20	55.194			1700.1	(148.1)		
			80	28	58.221			1522.4	(46.5)		
BOG ISLAND, 1857	G-1669 p. 59	"	32	21	51.648			1590.9	(257.3)		
			80	28	05.500			143.8	(1424.9)		
Sub. Pt. BOG ISLAND, 1857		"	32	21				1578.7	(269.5)		
			80	28				183.6	(1385.1)		
CHAN, 1933	G-1669 p. 65	"	32	21	45.050			1387.7	(460.5)		
			80	29	09.979			260.9	(1307.8)		
Sub. Pt. CHAN, 1933		"	32	21				1410.4	(437.8)		
			80	29				325.1	(1243.6)		
WEE, 1933	G-1669 p. 65	"	32	20	40.144			1236.6	(611.6)		
			80	28	46.826			1224.5	(344.5)		
Sub. Pt. WEE, 1933		"	32	20				1244.0	(604.2)		
			80	28				1200.6	(368.4)		
TEMPORARY, 1955	Field Comp.	"	32	19	25.649			790.1	(1058.1)		
			80	27	07.188			188.0	(1381.4)		
Sub. Pt. TEMPORARY, 1955		"	32	19				709.6	(1138.6)		
			80	27				235.2	(1334.2)		
INLET 2, 1955	Field Comp.	"	32	19	39.966			1231.1	(617.1)		
			80	27	22.730			594.5	(974.8)		
SHELL, 1955	Field Comp.	"	32	21	31.689			976.1	(872.1)		
			80	29	03.515			91.9	(1476.9)		

1 FT. = 3048006 METER

COMPUTED BY

J. C. Oregon

DATE

10/18/55

CHECKED BY: H. R. Rudolph

DATE

18 October 1955

COMM-DC-57843

COMPILATION REPORT
T-10315

31. DELINEATION

Graphic methods were used to delineate this survey.

Field inspection was adequate.

32. CONTROL

Horizontal control with reference to identification, density, and placement was considered adequate.

33. SUPPLEMENTAL DATA

- A. Special Report - Boundaries, Project 154. Boundary data for Hunting Island State Park.
- B. A field annotated copy of AMS Quadrangle, St. Helena Sound, South Carolina, edition 1948, scale 1:50,000 for Geographic Names.

34. CONTOURS AND DRAINAGE

Contours: Not applicable.

Drainage: No comment.

35. SHORELINE AND ALONGSHORE DETAILS

Shoreline inspection was adequate.

The MHWL along Fripp Island from the mouth of Old House Creek to topographic station RAMP, 1955 and also along the south tip of Hunting Island in the vicinity of topographic station FIRE, 1955 was delineated as located by planetable on 30 September 1955.

The low-water lines were based on field inspection supplemented by office interpretation of low-water photographs.

36. OFFSHORE DETAILS

No comment.

37. LANDMARKS AND AIDS

There are no landmarks or aids to navigation within the area of this survey.

38. CONTROL FOR FUTURE SURVEYS

Forms 524 were submitted October 1955 for use in Hydrographic Surveys for two (2) Recoverable Topographic Stations:

RAMP, 1955

FIRE, 1955

39. JUNCTIONS

Junctions have been made and are in agreement with Surveys T-10310 and T-10309 to the north and with T-10319 and T-10314 to the west. There are all water areas to the east and to the south of this map manuscript.

40. HORIZONTAL AND VERTICAL ACCURACY

No comment.

41 - 45. Not applicable.

46. COMPARISON WITH EXISTING MAPS

This survey has been compared with the AMS quadrangle St. Helena Sound, S. C., scale 1:50,000, edition of 1948; and T-5187, St. Helena Sound, Harbor River, S. C., scale 1:20,000 from photographs dated 1933.

47. COMPARISON WITH NAUTICAL CHARTS

This survey has been compared with chart 793, scale 1:40,000, edition of 14 September 1937, corrected to 16 June 1956.

Items to be applied to nautical charts immediately: None.

Items to be carried forward: None.

Respectfully submitted
8 August 1958

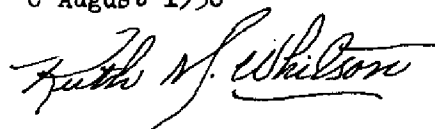

Ruth M. Whitson
Carto. Photo. Aid

Approved and forwarded

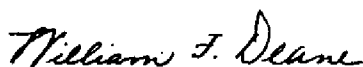
William F. Deane,
CDR C&GS
Baltimore District Officer

48. GEOGRAPHIC NAME LIST

Atlantic Ocean

Beaufort County

Fripps Inlet

Fripps Island

Harbor Island

Hunting Island

Hunting Island State Park

Hunting Island Beach

Intra Coastal Waterway

Johnson Creek

St. Helena Sound (Title)

Story River

Old House Creek

George M. Ball
GEOGRAPHIC NAMES SECTION
27 AUGUST 1959

PHOTOGRAMMETRIC OFFICE REVIEW

T. 10315

1. Projection and grids H.R.R. 2. Title H.R.R. 3. Manuscript numbers H.R.R. 4. Manuscript size H.R.R.

CONTROL STATIONS

4a. Classification label H.R.R.

5. Horizontal control stations of third-order or higher accuracy H.R.R. 6. Recoverable horizontal stations of less than third-order accuracy (topographic stations) H.R.R. 7. Photo-hydro stations 8. Bench marks
9. Plotting of sextant fixes 10. Photogrammetric plot report H.R.R. 11. Detail points H.R.R.

ALONGSHORE AREAS

(Nautical Chart Data)

12. Shoreline H.R.R. 13. Low-water line H.R.R. 14. Rocks, shoals, etc. H.R.R. 15. Bridges 16. Aids to navigation H.R.R. 17. Landmarks 18. Other alongshore physical features H.R.R. 19. Other along-shore cultural features H.R.R.

PHYSICAL FEATURES

20. Water features H.R.R. 21. Natural ground cover H.R.R. 22. Planetable contours 23. Stereoscopic instrument contours 24. Contours in general 25. Spot elevations 26. Other physical features H.R.R.

CULTURAL FEATURES

27. Roads H.R.R. 28. Buildings H.R.R. 29. Railroads 30. Other cultural features H.R.R.

BOUNDARIES

31. Boundary lines H.R.R. 32. Public land lines

MISCELLANEOUS

33. Geographic names H.R.R. 34. Junctions H.R.R. 35. Legibility of the manuscript H.R.R. 36. Discrepancy overlay 37. Descriptive Report H.R.R. 38. Field inspection photographs H.R.R. 39. Forms H.R.R.

40. Harry R. Rudolph
Reviewer

Joseph Steinberg
Supervisor, Review Section of Unit

41. Remarks (see attached sheet)

FIELD COMPLETION ADDITIONS AND CORRECTIONS TO THE MANUSCRIPT

42. Additions and corrections furnished by the field completion survey have been applied to the manuscript. The manuscript is now complete except as noted under item 43.

Compiler

Supervisor

43. Remarks:

U.S. DEPARTMENT OF COMMERCE
COAST AND GEODETIC SURVEY

NONFLOATING AIDS OR LANDMARKS FOR CHARTS

TO BE CHARTED ~~NO/BE/DELETED/~~ STRIKE OUT ONE

Burton, South Carolina 10 October, 1955

I recommend that the following objects which have ~~been~~ been inspected from seaward to determine their value as landmarks be charted on ~~charts~~ the charts indicated.

The positions given have been checked after listing by J. E. Waugh

/s/ J. E. Waugh

Chief of Party.

STATE SOUTH CAROLINA				POSITION				METHOD OF LOCATION AND SURVEY	DATE OF LOCATION	HARBOR CHART	INSHORE CHART	OFFSHORE CHART	CHARTS AFFECTED
CHARTING NAME	DESCRIPTION	SIGNAL NAME	LATITUDE *		LONGITUDE *		DATUM						
			° ' "	D.M. METERS	° ' "	D.P. METERS							
DAYBN A 16	Story River Daybeacon A 16, 1955		32	20	55.194	58.221	NA	T-10315 Triang.	1955	x	x		793, 1214

This form shall be prepared in accordance with Hydrographic Manual, pages 800 to 804. Positions of charted landmarks and *nonfloating* aids to navigation, if redetermined, shall be reported on this form. The data should be considered for the charts of the area and not by individual field survey sheets. Information under each column heading should be given.

* TABULATE SECONDS AND METERS

Refer to Descriptive Report T-10306
for a Review Report covering this manuscript

Reviewed by

A. K. Woodward
A. K. Woodward

Approved by

L. C. Lande
L. C. Lande
Chief, Review Section

G. B. Mast
Chief, Coastal Surveys
Division

Asst. Chief, Operations Division

L. F. Woodcock
Asst. L. F. Woodcock, Chief
Photogrammetry Division

J. E. Waugh 11/27/61
Chief, Chart Division
National Oceanic and Atmospheric Administration
Bureau of Oceanography

NAUTICAL CHARTS BRANCH

SURVEY NO. T-10315

Record of Application to Charts

[illegible]

M-2168-1

A basic hydrographic or topographic survey supersedes all information of like nature on the uncorrected chart. Give reasons for deviations, if any, from recommendations made under "Comparison with Charts" in the Review.